

Chrome Configuration

1. Click on form you wish to open
2. The PDF will appear at the bottom left of your screen

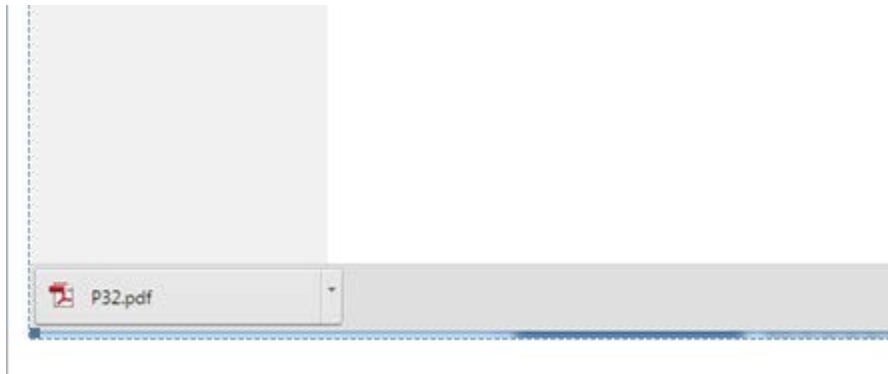

1. Click on the drop down arrow
2. Select "Always open with system viewer" or "Open with system viewer"

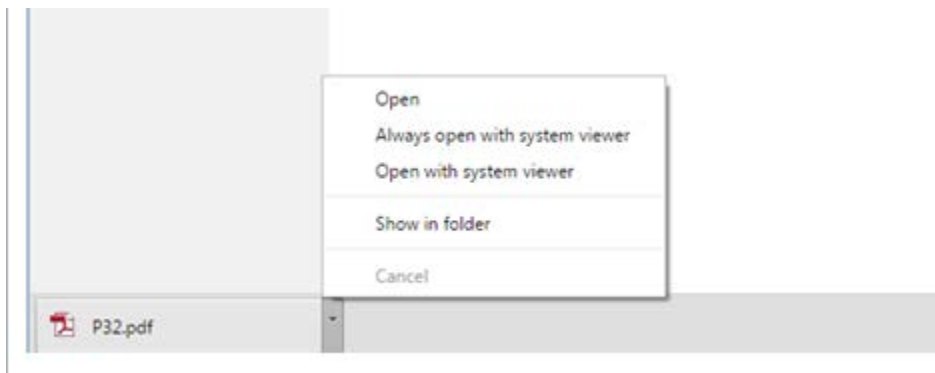

See Firefox configuration on the next page.

Firefox Configuration

1. Click on the form you wish to open
2. Select save or open
3. Click OK

