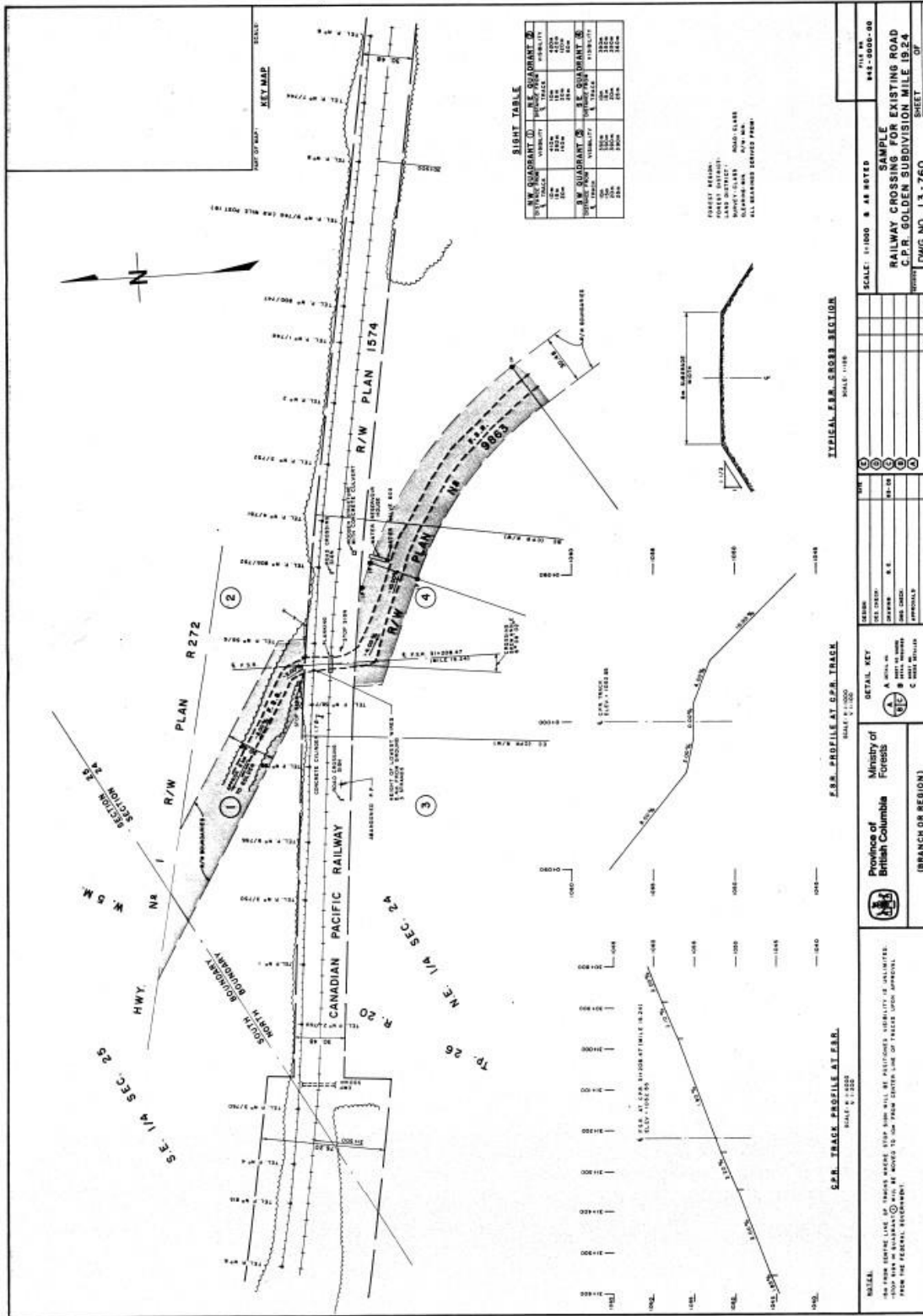

Figure 3-9 Dwg. No. 13-760 Sample Railway Crossing for Existing Road



SIGHT TABLE

R/W QUADRANT OR TRAIL	CORRECTION	TRAJECTORY	
		ANGLE	LENGTH
SW QUADRANT OR TRAIL		120	150
SE QUADRANT OR TRAIL		130	160
NW QUADRANT OR TRAIL		140	170
NE QUADRANT OR TRAIL		150	180
		160	190
		170	200

Province of British Columbia
Ministry of Forests

(BRANCH OR REGION)

DETAILED KEY
 (1) TO BE MAINTAINED
 (2) TO BE MAINTAINED
 (3) TO BE MAINTAINED
 (4) TO BE MAINTAINED

E.M.M. PROFILE AT C.P.R. TRACK
SCALE: 1:1000

E.M.M. PROFILE AT E.M.M.
SCALE: 1:1000

TYPICAL E.M.M. CROSS SECTION
SCALE: 1:100

SCALE: 1:1000 & AS NOTED
 \$42-000-00

SAMPLE
 RAILWAY CROSSING FOR EXISTING ROAD
 C.P.R. GOLDEN SUBDIVISION MILE 19.24

DWG. NO. 13-760

SHEET _____ OF _____

NOTE:
 ALL WORK SHOWN ON THIS PLAN IS BASED ON THE PROVISIONAL SURVEY DATA AND IS SUBJECT TO VERIFICATION BY THE FIELD SURVEYORS.
 THE PROPOSED LINE OF TRENCH MARKS SHOWN WILL BE PROTECTED BY RAILROADS IN ALL PLACES.
 THIS PLAN IS SUBMITTED TO YOU FOR APPROVAL AND IS NOT TO BE USED FOR ANY OTHER PURPOSE WITHOUT THE WRITTEN APPROVAL OF THE ENGINEER.