

P. & N. G. GROUP 94 - A - 14

BLOCK L

Unsurveyed

Crown

Land

PROPOSED  
160m X 150m  
CAMPSITE  
IN EXISTING  
CLEARING  
(2.40 ha)

Tree Cover:  
Alder to 5cm Diameter  
Willow to 5cm Diameter  
Scattered Poplar to  
10cm Diameter

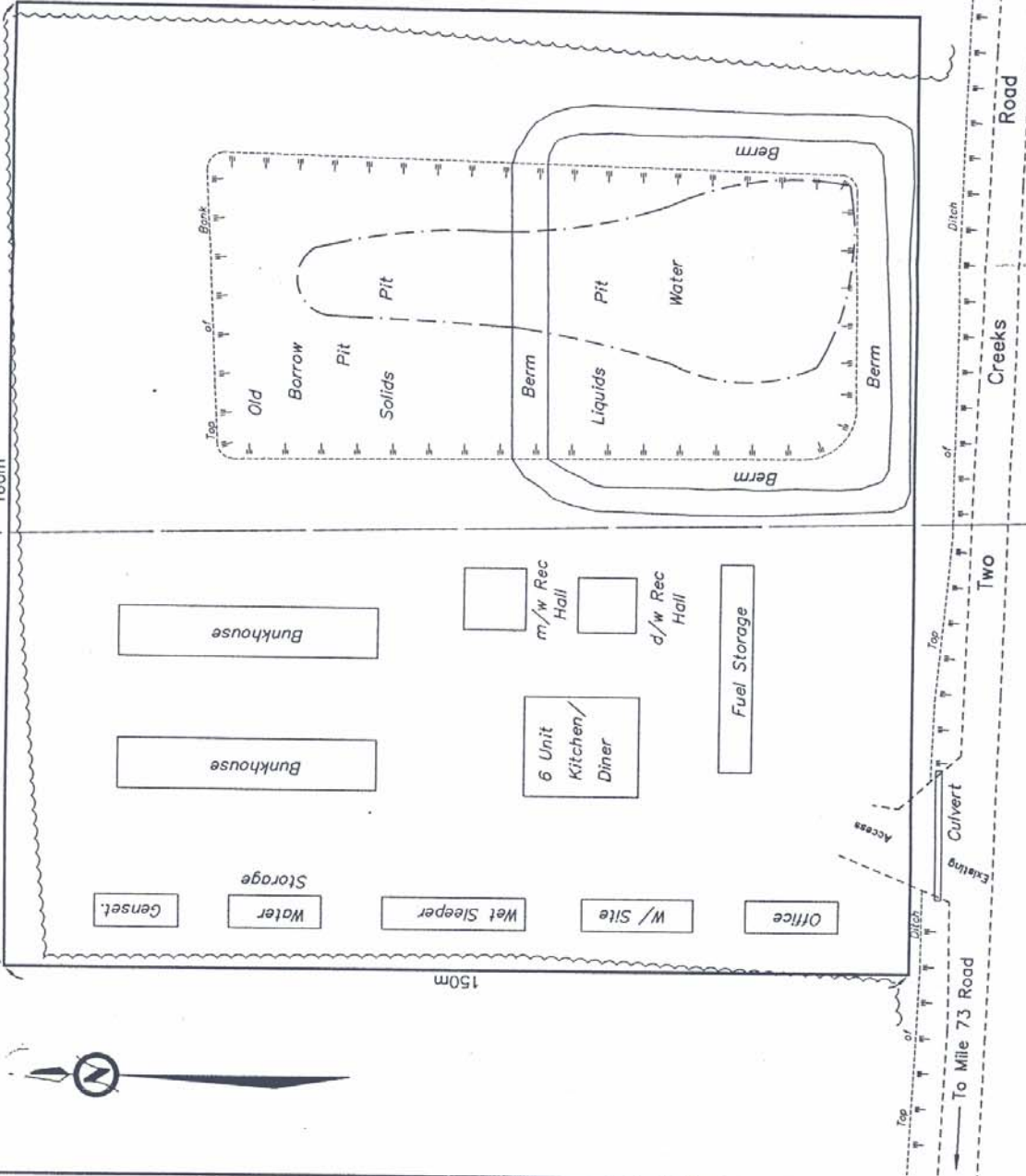

NO	REVISIONS	BY	DATE

NOTES:  
All underground facilities shown were located with electronic locators and may be subject to error. Actual locations should be verified independently by the contractor in field prior to any crossings.  
Bushline shown thus: ~~~~~  
Top of Bank shown thus: - - - - -  
Edge of Road shown thus: - - - - -  
Edge of Water shown thus: - - - - -

FORT ST. JOHN, B.C.

SKETCH PLAN SHOWING FACILITIES FOR  
PROP. PERMANENT CAMPSITE IN EXISTING  
CLEARING a-44-L/b-43-L, 94-A-14

DATE: AUG 20, 2002	SCALE	REV.
WILKESBY DAWSON SURVEY GROUP 10720 - 100th Avenue, Fort St. John, B.C. V1J 1Z3 Ph. (250)787-0300 Fax (250)787-1811	JOB NO:	0

