

Communication Site

(Oct 21, 2002)

Mapping Requirements

Provide a **Site Specific map** and **Site General map** on 8 ½" x 11" or 8 ½" x 14" or 11" x 17" paper only.

Submit a **Site General** map at 1:20,000 scale as indicated in the sample mapping. The purpose of this map is to indicate the general location of the site and illustrate the boundary lines. If the application area is a surveyed lot, provide a copy of the Survey plan. If the application area is not a surveyed lot then provide the length, in meters, and compass bearing, 0° to 360°, of each line of the application site boundary [metes and bounds description]. The Point of Commencement for the application area must be tied to a known point such as a geographic land feature or a corner pin of a surveyed lot, that must be shown on the Site General Map and identifiable on our reference maps. Please provide a legal description for the area [i.e. the site is located within Section 22, Nanaimo District]. A **Site Specific map** [Management Plan] is a detailed version of the Site General map showing the boundary lines [noting metes and bounds] at a scale [i.e. 1:2,000, 1:5,000, 1:10,000 scale] that illustrates the location of all improvements [i.e. buildings, access roads] within the application area. **Applications with incomplete mapping will not be accepted.**

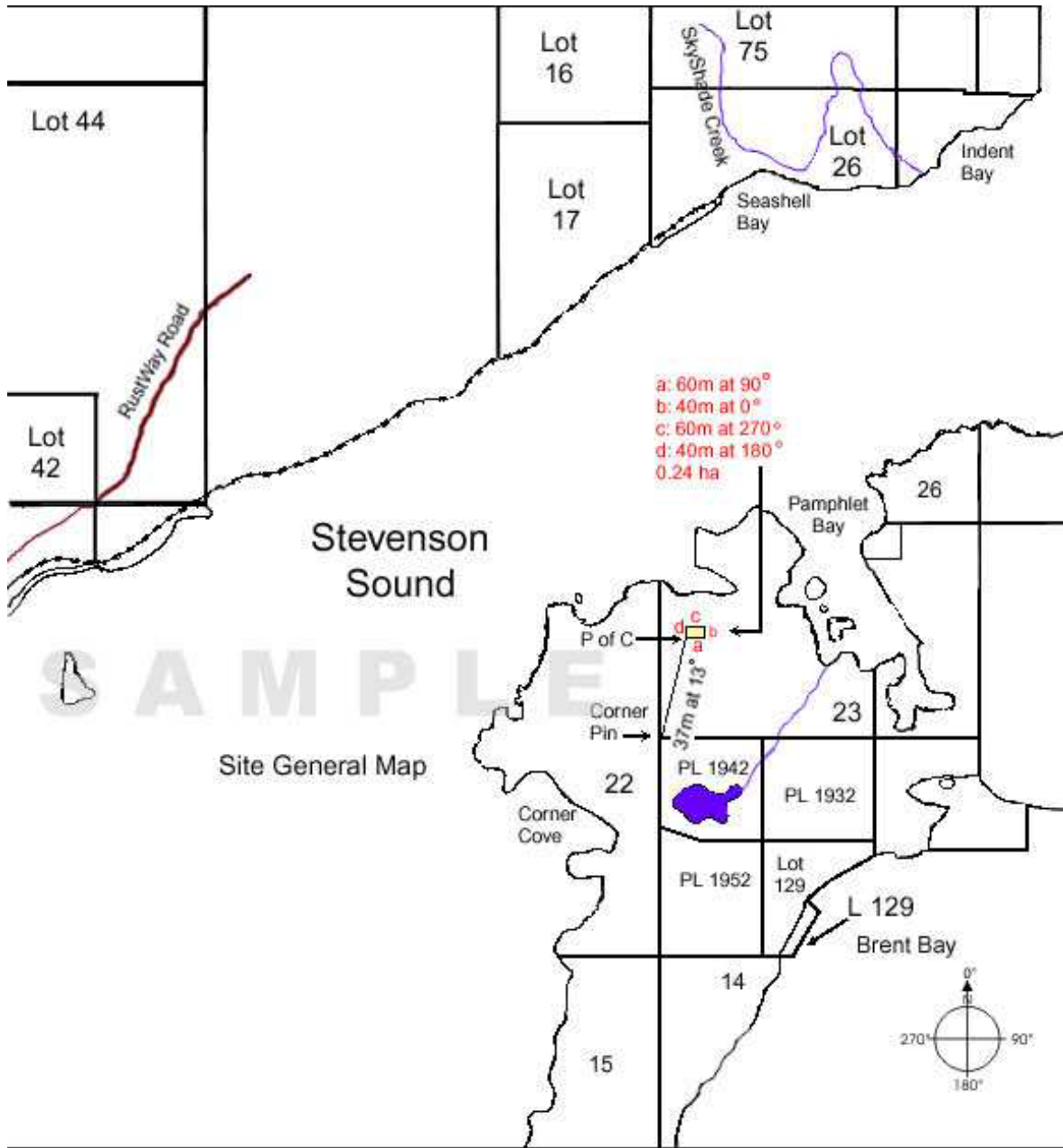

Site General Map

SCALE 1:20000

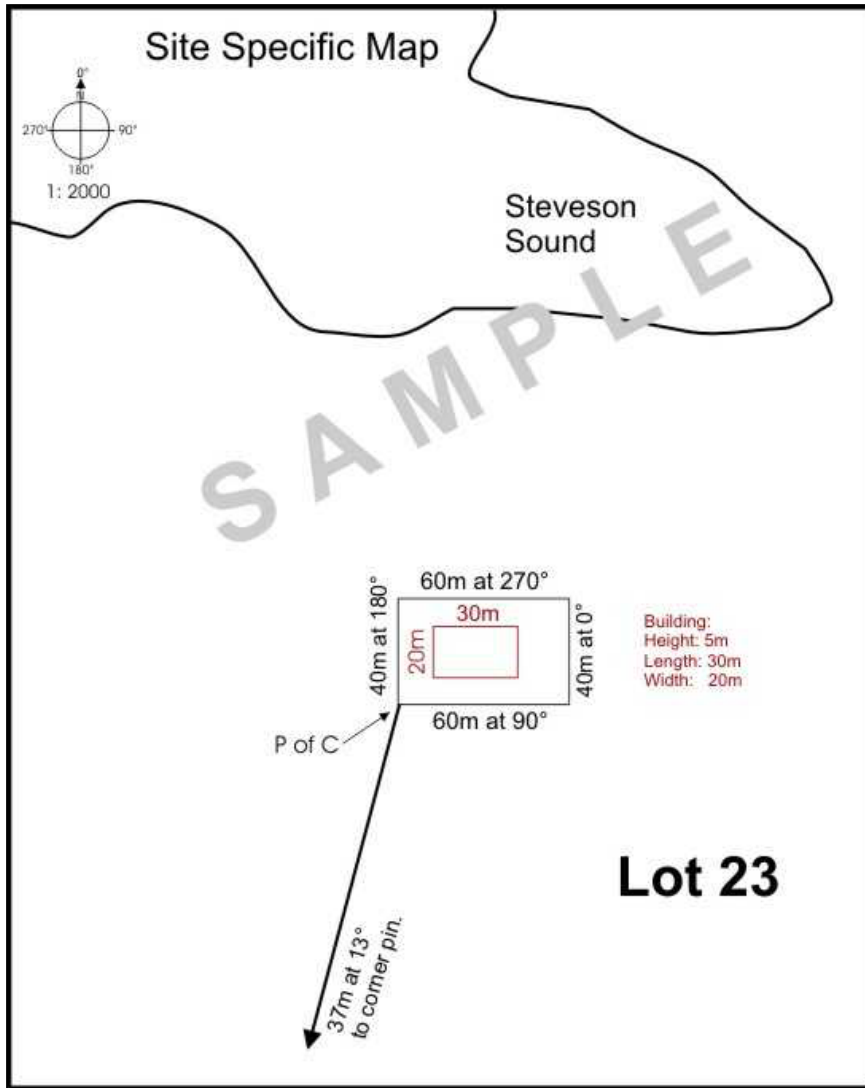

General Site map metes and bounds description

Begin at the northeast corner of Lot 44, Nanaimo District then go 372 m @ 13° to the Point of Commencement [PofC]

Then go 60 m @ 90° Then go 40 m @ 0°

Then go 60 m @ 270° Then go 40 m @ 180°

Containing a total of 0.24 ha