

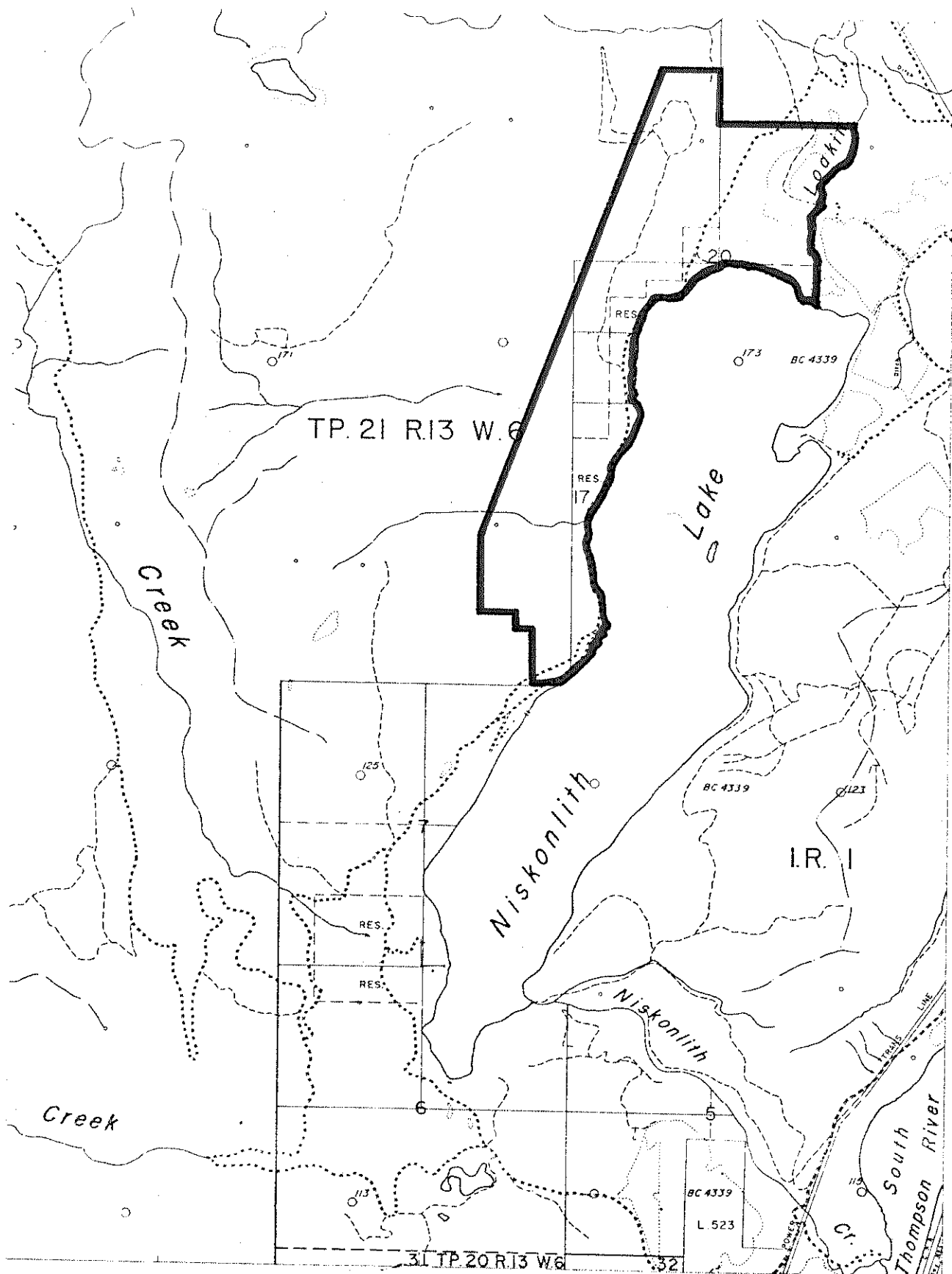

DEPARTMENT OF MINES AND PETROLEUM RESOURCES  
VICTORIA



50°45'  
119°45'00"

KAMLOOPS	MINING DIVISION
K.D.Y.D.	LAND DISTRICT
MINERAL MAP NO.(S)	82L/13W
SCALE:	1/2 MILE = 1 INCH
M.T.D.R.; DRAWN BY: N. BEATTIE,	6-5-74.