

PROVINCE OF BRITISH COLUMBIA

Ministry of Forests

IN THE MATTER OF TREE FARM LICENCE NUMBER 44

INSTRUMENT NUMBER 5

Amendment

WHEREAS the lands described hereinafter are within Tree Farm Licence Number 44 and are found to be suitable for a higher economic use rather than that of the growing of forest crops;

And whereas the Licensee has requested the withdrawal of the aforementioned lands from the Schedule "A" of the said Tree Farm Licence;

Therefore pursuant to Section 33.1 of the Forest Act, the following lands are herewith withdrawn from the lands described in Schedule "A" of the said Tree Farm Licence Number 44; namely, that portion of Block 763, Alberni Land District being more particularly shown outlined in bold black on the plan attached hereto, and the said lands so withdrawn are and shall be henceforth no longer part of or subject to the said Tree Farm Licence Number 44.

Dated at the City of Victoria in the Province of British Columbia this 15th day of November, 1988.

Minister of Forests

Attachment



Province of
British Columbia
Ministry of
Forests and Lands

MAP OF **INSTRUMENT No. 5**
TO T.F.L. 44

EXHIBIT 'A'

T.M.	Zone	East	North	Reg	Compt	L
Grid	10373000	05450000	007018			
FOREST REGION	01 VANCOUVER		LAND DISTRICT 01 ALBERNIE			
DISTRICT	17 Pt ALBERNIE		OUTLINE			

Date 88-10-06
Ref. Map 92 FSE W1/2 A
Base Used Co. Map 892 F-017
Scale 1: 4 000
Area 10.16 hectares ±

Type OT	MANAGEMENT UNIT	Number	TIMBER SUPPLY AREA	PULPWOOD AGREEMENT	CASCADES
Number 44		Block			East
Block		Sub-B			West C

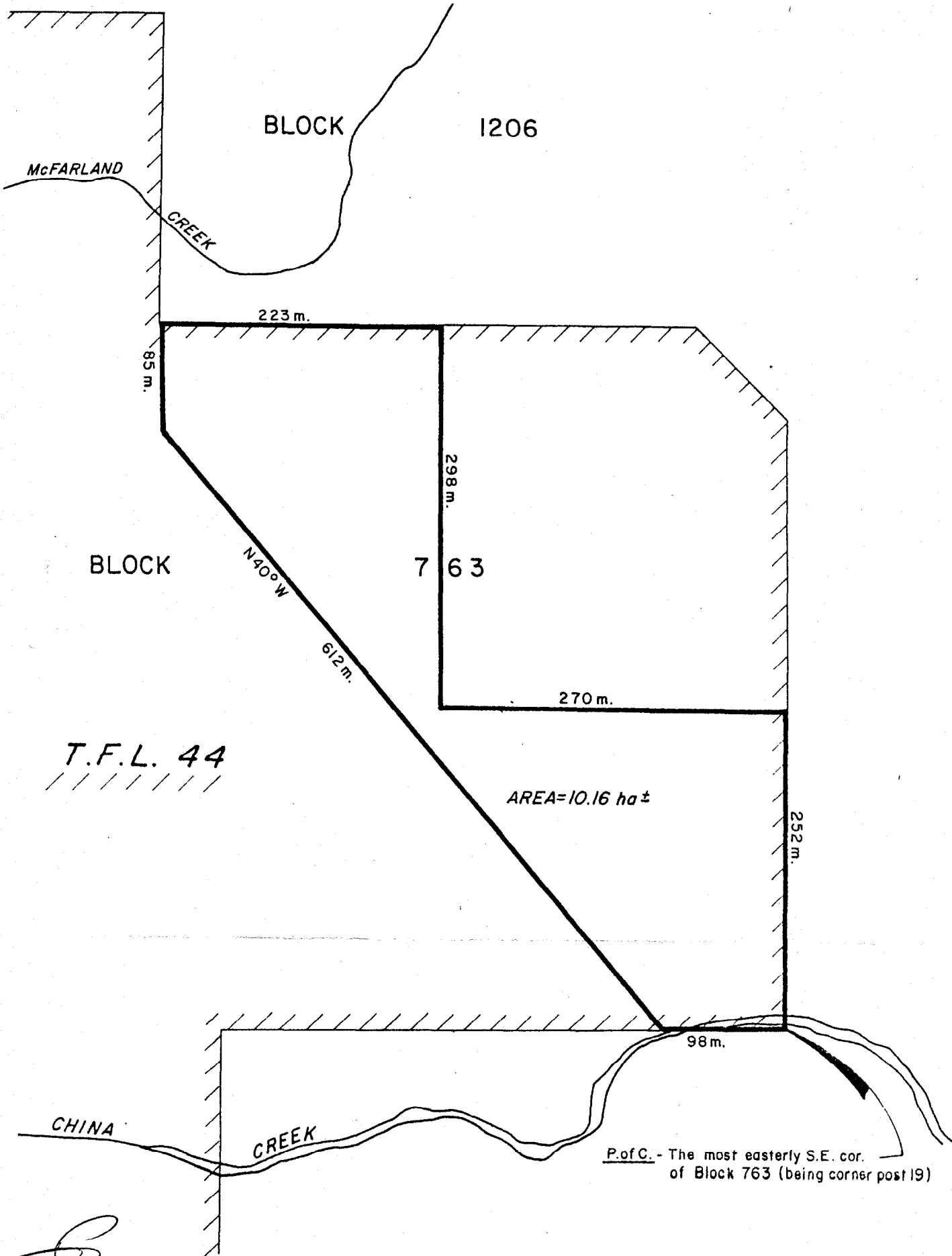

Drawn by *R.W.*