

COPY

PROVINCE OF BRITISH COLUMBIA
Ministry of Forests and Lands

IN THE MATTER OF TREE FARM LICENSE NUMBER 44
INSTRUMENT NUMBER 4
AMENDMENT

This Amendment made as of March 31, 1987

BETWEEN:

HER MAJESTY THE QUEEN IN RIGHT OF THE PROVINCE OF BRITISH COLUMBIA, represented by the Minister of Forests and Lands, Parliament Buildings, Victoria, British Columbia, V8V 1X4

(herein called the "Licensor")

OF THE FIRST PART

AND:

MACMILLAN BLOEDEL LIMITED, a body corporate, amalgamated under the laws of the province of British Columbia under certificate of incorporation No. 247324, and having its registered office at 2600 - 1075 West Georgia Street, Vancouver, British Columbia, V6E 3R9

(herein called the "Licensee")

OF THE SECOND PART

WHEREAS:

- A. Pursuant to the *West Coast National Park Act*, the Licensor and the Licensee have entered into an exchange agreement dated the 9th day of December, 1986, as amended, (the "Exchange Agreement"); and
- B. Pursuant to the Exchange Agreement, the Licensor and the Licensee have agreed to amend TFL 44 to account for certain exchanges of land in TFL 44 which is within the boundaries of Pacific Rim National Park, for other land which is outside the boundaries of Pacific Rim National Park.

NOW THEREFORE THIS INDENTURE WITNESSES THAT pursuant to the *West Coast National Park Act* the parties hereto agree as follows.

ARTICLE I

DEFINITIONS

1.01 In this Agreement and the recitals:

- (a) "Pacific Rim National Park" means the park created under the *West Coast National Park Agreement*, the *National Parks Act (Canada)* and the *West Coast National Park Act*; and
- (b) "TFL 44" means tree farm license No. 44, made between the Licensor and the Licensee as of August 1, 1984.

ARTICLE II

AMENDMENT OF SCHEDULE "A" OF TFL 44

- 2.01 The lands described in Schedule "A" hereto are herewith withdrawn from the lands described in Schedule "A" of TFL 44.
- 2.02 The lands described in Schedule "B" hereto are herewith incorporated into Schedule "A" of TFL 44 and the said lands so incorporated are and shall be henceforth part of and subject to TFL 44.
- 2.03 The timber licenses and partial timber licenses described in Schedule "C" hereto are herewith withdrawn from the lands described in Schedule "A" of TFL 44.
- 2.04 Timber license TO885 is herewith incorporated into Schedule "A" of TFL 44 and the said timber license so incorporated is and shall be henceforth part of and subject to TFL 44.

ARTICLE III

AMENDMENT OF SCHEDULE "B" OF TFL 44

- 3.01 The lands described in Schedule "D" hereto are herewith withdrawn from the lands described in Schedule "B" of TFL 44.
- 3.02 The lands described in Schedule "E" hereto are herewith incorporated into Schedule "B" of TFL 44 and the said lands so incorporated are and shall be henceforth part of and subject to TFL 44.

ARTICLE IV

INTERPRETATION**4.01 Statutes**

A reference to a statute in this Agreement means a statute of the Province of British Columbia unless otherwise stated and includes every amendment to it, every regulation made under it and any enactment passed in substitution therefor or in replacement thereof.

4.02 References

Unless the context otherwise requires, any reference to "this Agreement" means this instrument and all of the Schedules attached to it and any reference to any section or subsection by number is a reference to the appropriate section or subsection in this Agreement.

4.03 Headings

The headings or captions in this Agreement are inserted for convenience only and do not form a part of this Agreement and in no way define, limit, alter or enlarge the scope or meaning of any provision of this Agreement.

4.04 Schedules

Each Schedule attached to this Agreement is an integral part of this Agreement as if set out at length in the body of this Agreement.

4.05 Entire Agreement

This Agreement constitutes the entire agreement between the parties with respect to the subject matter of this Agreement and there are no representations or warranties, express or implied, statutory or otherwise and no agreements collateral to this Agreement other than as expressly set forth or referred to in this Agreement.

4.06 Further Acts and Assurances

Each of the parties will, upon the reasonable request of the other, make, do, execute or cause to be made, done or executed all further and other lawful acts, deeds, things, devices, documents, instruments and assurances whatever for the better or more perfect and absolute performance of the terms and conditions of this Agreement.

4.07 Severability

If any provision of this Agreement or the application thereof to any person or circumstance is invalid or unenforceable to any extent, the remainder of this Agreement and the application of such provision

to any other person or circumstance will not be affected or impaired thereby and will be valid and enforceable to the extent permitted by law.

4.08 No Waiver

No waiver by either party of a breach or default by the other party in the observance, performance or compliance of any of its obligations under this Agreement will be effective unless it is in writing and no such waiver will be deemed or construed to be a waiver of any other breach or default and failure or delay on the part of either party to complain of an act or failure of the other party or to declare such other party in default, irrespective of how long such failure or delay continues, will not constitute a waiver by such party of any of its rights against the other party.

4.09 Governing Law

This Agreement will be governed by and construed and interpreted in accordance with the laws of the Province of British Columbia.

IN WITNESS WHEREOF the parties have executed this Agreement as of the 31st day of March, 1987.

SIGNED, SEALED AND DELIVERED)
by a duly authorized representative)
of the Minister of Forests and Lands)
on behalf of Her Majesty the Queen)
in Right of the Province of British)
Columbia in the presence of:)

Tracey P. Gibb
TRACEY P. GIBB
BARRISTER & SOLICITOR
609 BROUGHTON ST.
VICTORIA, B.C. V8V 1X4

(Witness)

Alan D. Gray
Duly authorized representative

THE COMMON SEAL of)
MacMillan Bloedel Limited)
was hereunto affixed in)
the presence of:)

John I. ...
(Name)

SENIOR VICE-PRESIDENT
(Title or Relationship to Company)

George ...
(Name)

SECRETARY
(Title or Relationship to Company)

(c/s)

SCHEDULE "A"

MB Land

<u>Legal Description</u>	<u>Certificate of Title</u>
Lot 161, Clayoquot District	J68910
Lot 397, Clayoquot District, Plan D.D. 76839-I	J98590
South Western 1/4 of Lot 406, Clayoquot District	J74510
Lot 1, District Lot 467, Clayoquot District, Plan 44818	S17746
Lot 1, Sections 69 and 70, ^{and 71,} Alberni District (situated in Clayoquot District), Plan 44820	S17748
Lot 1, Section 9, Township 1, Barclay District, Plan 44819	S17747
✓ Lot 410, Barclay District, (Alberni Assessment District)	J68920
✓ Lot 411-A, Barclay District	J99886
✓ Lot 537, Barclay District	J99882
✓ Lot 650, Barclay District	J98581

SCHEDULE "B"

Replacement Land

Lot A, District Lots 164 and 253, Alberni District, Plan 44810

District Lot 45, Barclay District

Block A, Section 2 and Block A, Section 11, Township 2, Barclay District

Block A, Section 16, Township 1, Barclay District

Block A, District Lot 130, Alberni District

SCHEDULE "C"

Part I - M.B. Timber Licences

1. "T0340" - described as follows;

All of Indian Island, Clayoquot Land District except Lot 1680, Indian Reserve No. 30 "Indian Island".

Containing 158 hectares, more or less, as shown outlined in bold black on Appendix I attached hereto.

2. "T0732" - described as follows;

Fractional northwest quarter of Section 4, Township 1, Barclay Land District.

Containing 57 hectares, more or less, as shown outlined in bold black on Appendix II attached hereto.

Part II - M.B. Partial Timber Licences

3. "T0579 Block 3" - described as follows;

Commencing at the northeast corner of Lot 140, Clayoquot Land District; thence westerly along the northerly boundary of said Lot 140 201 metres; thence north 402 metres to the northerly boundary of Lot 143; thence easterly and southerly along the northerly and easterly boundaries of said Lot 143 to the point of commencement.

Containing 8 hectares, more or less, as shown outlined in bold black on Appendix III attached hereto.

4. "T0579 Block 4" - described as follows;

Lot 184, Clayoquot Land District.

Containing 15 hectares, more or less, as shown outlined in bold black on Appendix IV attached hereto.

5. "That portion of T0579 Block 1" - described as follows;

Block A

Commencing at the northeast corner of Lot 161, Clayoquot Land District; thence south 77 degrees 40 minutes east 1.150 kilometres;

thence south 1.990 kilometres to the northerly boundary of Lot 1403; thence westerly along the northerly boundaries of Lots 1403 and 1402 to the northwest corner of said Lot 1402; thence north 245 metres to the southeast corner of Lot 150; thence northerly along the easterly boundaries of Lots 150 and 157 to the southwest corner of Lot 1471; thence easterly, northerly and westerly along the southerly, easterly and northerly boundaries of said Lot 1471 to the easterly boundary of aforesaid Lot 161; thence northerly along the easterly boundary of said Lot 161 to the point of commencement.

Block B

Commencing at the southwest corner of Lot 1472, Clayoquot Land District; thence south 180 metres; thence north 77 degrees 40 minutes west 860 metres; thence east 850 metres to the point of commencement.

Containing 96 hectares, more or less, being part of the active area of T0579 Block 1 as shown cross-hatched within the area outlined in bold black on Appendix V attached hereto.

6. "That portion of T0738 Block 3" - described as follows;

Commencing at a point 3.010 kilometres north and 1.690 kilometres west of the northwest corner of Indian Reserve No. 8, "Homitan", Barclay Land District; thence east 600 metres; thence south 41 degrees east 1.100 kilometres; thence south 780 metres; thence west 976 metres, more or less, to the high-water mark of Hitchie Lake on the southeasterly shore thereof; thence in a general northeasterly and southwesterly direction along the high-water mark of said Hitchie Lake on the southeasterly and northwesterly shores thereof to a point 1.400 kilometres north and 1.590 kilometres west of the northwest corner of aforesaid Indian Reserve No. 8; thence west 325 metres; thence north 1.405 kilometres, more or less, to the northwesterly boundary of the watershed of aforesaid Hitchie Lake; thence in a general northeasterly direction along the northwesterly boundary of the watershed of said Hitchie Lake to the point of commencement.

Containing 209 hectares, more or less, as shown outlined in bold black on Appendix VI attached hereto.

7. That portion of T0785 Block 5" - described as follows;

Commencing at a point 2.805 kilometres north and 1.940 kilometres west of the northwest corner of Indian Reserve No. 8, "Homitan", Barclay Land District; thence south 1.405 kilometres; thence west 1.420 kilometres, more or less, to the northwesterly boundary of the watershed of Hitchie Lake; thence in a general

northeasterly direction along the northwesterly boundary of the watershed of said Hitchie Lake to the point of commencement.

Containing 120 hectares, more or less, as shown outlined in bold black and Appendix VII attached hereto.

Save and excepting all that foreshore and land covered by water within the above described areas.

SCHEDULE "D"

Schedule "B" TFL 44 Land

MB PRODUCTIVE LAND

1. "Wickaninnish Bay" - Commencing at the southeast corner of Lot 150, Clayoquot Land District; thence south to the northwest corner of Lot 1402; thence southerly along the westerly boundary of said Lot 1402 to the northeast corner of Lot 142; thence westerly along the northerly boundaries of Lots 142 and 143 to the southeast corner of Lot 147; thence northerly along the easterly boundary of said Lot 147 to the northeast corner thereof; thence easterly along the southerly boundaries of Lots 151 and 150 to the point of commencement. Containing 32 hectares, more or less, as shown outlined in bold black on Appendix I attached hereto.

2. "Grice Bay" -

Block A

Commencing at the northeast corner of Lot 161, Clayoquot Land District; thence south 77 degrees 40 minutes east 1.150 kilometres; thence south 1.990 kilometres to the northerly boundary of Lot 1403; thence westerly along the northerly boundaries of Lots 1403 and 1402 to the northwest corner of said Lot 1402; thence north 245 metres to the southeast corner of Lot 150; thence northerly along the easterly boundaries of Lots 150 and 157 to the southwest corner of Lot 1471; thence easterly, northerly and westerly along the southerly, easterly and northerly boundaries of said Lot 1471 to the easterly boundary of aforesaid Lot 161; thence northerly along the easterly boundary of said Lot 161 to the point of commencement.

Block B

Commencing at the southwest corner of Lot 1472, Clayoquot Land District; thence south 180 metres; thence north 77 degrees 40 minutes west 860 metres; thence east 850 metres to the point of commencement.

Containing 110 hectares, more or less, being part of the inactive area of T0579, Block 1 as shown cross-hatched within the area outlined in bold black on Appendix II attached hereto.

3. "Cheewhat Lake" - Commencing at the southwest corner of Indian Reserve No. 9 "O-yees", Renfrew Land District, being a point on the high-water mark of Nitinat Lake on the southeasterly shore thereof; thence easterly along the southerly boundary of said Indian Reserve

No. 9 "O-yees" to the southeast corner thereof; thence south 1.006 kilometres; thence east 783 metres; thence south 198 metres to the northwest corner of Block A of Lot 756; thence easterly along the northerly boundary of Block A of said Lot 756 201 metres; thence south 210 metres, more or less, to the high-water mark of Cheewhat Lake on the northerly shore thereof; thence in a general southerly, easterly and northerly direction along the high-water mark of said Cheewhat Lake on the westerly, southerly and easterly shores thereof to a point 402 metres north and 980 metres west of the southeast corner of Block B of aforesaid Lot 756; thence east 780 metres; thence south 44 degrees 30 minutes west 325 metres; thence south 26 degrees west 325 metres; thence south 9 degrees west 390 metres; thence south 49 degrees 30 seconds west 1.075 kilometres; thence south 2 degrees east 755 metres; thence south 50 degrees west 755 metres; thence southwesterly in a straight line to the northeast corner of Lot 56; thence southerly, westerly and northerly along the easterly, southerly and westerly boundaries of said Lot 56 to the northwest corner thereof; thence northerly and westerly along the easterly and northerly boundaries of Lot 58 to the northwest corner thereof; thence northerly along the westerly boundary of Block D of Lot 746 to the high-water mark of Nitinat Lake on the southeasterly shore thereof; thence in a general northeasterly direction along the high-water mark of said Nitinat Lake on the southeasterly shore thereof to the point of commencement. Containing 1 647 hectares, more or less, as shown outlined in bold black on Appendix III attached hereto.

Excluding thereout Indian Reserve No. 5 "Sarque" Renfrew Land District.

4. "Carmanah Point" - Commencing at a point on the easterly boundary of Lot 726, Renfrew Land District, said point being 760 metres south of the northeast corner thereof; thence southwesterly in a straight line to the northeast corner of Section 50; thence southeasterly in a straight line to a point on the easterly boundary of Lot 727, said point being 762 metres south of the northeast corner thereof; thence due east to the high-water mark of Carmanah Creek on the right bank thereof; thence in a general southerly direction along the high-water mark of said Carmanah Creek on the right bank thereof to a point 305 metres south and 230 metres east of the northeast corner of Lot 729; thence southeasterly in a straight line to the most northerly northeast corner of Lot 732; thence southerly and easterly along the easterly and northerly boundaries of said Lot 732 to the most easterly northeast corner thereof; thence easterly, southerly, westerly and southerly along the northerly, easterly, southerly and easterly boundaries of Lot

734 to the high-water mark of the Pacific Ocean; thence in a general northwesterly direction along the high-water mark of said Pacific Ocean to the easterly boundary of Indian Reserve No. 3 "Cullite"; thence northerly, westerly and southerly along the easterly, northerly westerly boundaries of said Indian Reserve No. 3 to the high-water mark of said Pacific Ocean; thence in a general northwesterly direction along the high-water mark of said Pacific Ocean to the easterly boundary of Indian Reserve No. 6 "Carmanah"; thence northerly and westerly along the easterly and northerly boundaries of said Indian Reserve No. 6 to the northwest corner thereof; thence westerly along the northerly boundaries of Lots 96 and 728 to the high-water mark of aforesaid Pacific Ocean; thence in a general northwesterly direction along the high-water mark of said Pacific Ocean to the southerly boundary of aforesaid Lot 726; thence easterly and northerly along the southerly and easterly boundaries of said Lot 726 to the point of commencement. Containing 775 hectares, more or less, as shown outlined in bold black on Appendix IV attached hereto.

5. "Tsusiat Lake" - Commencing at a point on the northwesterly boundary of the watershed of Tsusiat Lake, also being a point 500 metres north of the southwest corner of Lot 527, Barclay Land District; thence northerly along the westerly boundary of said Lot 527 380 metres to the northwest corner thereof; thence easterly along the northerly boundary of said Lot 527 650 metres, more or less, to the northwesterly boundary of the watershed of aforesaid Tsusiat Lake; thence in a general southwesterly direction along the northwesterly boundary of the watershed of said Tsusiat Lake to the point of commencement. Containing 11 hectares, more or less, as shown outlined in bold black on Appendix V attached hereto.

Save and excepting thereout all that foreshore and land covered by water within the above described areas.

SCHEDULE "E"

REPLACEMENT SCHEDULE "B" TFL 44 PRODUCTIVE LAND

Parcel Definition and Legal Description of Lands

1. "Klanawa River" - Commencing at the northwest corner of Lot 288, Barclay Land District; thence easterly along the northerly boundary of said Lot 288 to the northeast corner thereof; thence south 86 degrees east 479 metres; thence east 1.597 kilometres; thence south 1.623 kilometres; thence north 66 degrees west 4.035 kilometres to the point of commencement.

Containing 301 hectares, more or less, as shown outlined in bold black on Appendix I attached hereto.

2. "Darling River" - Commencing at a point 804 metres west of the northeast corner of Lot 282, Barclay Land District; thence easterly along the northerly boundaries of Lots 282 and 284 to the northeast corner of said Lot 284; thence southerly along the easterly boundary of said Lot 284 to the southwest corner of Lot 525; thence west 152 metres; thence north 61 degrees west 1.670 kilometres; thence north 72 degrees west 680 metres; thence north 40 degrees west 240 metres to the point of commencement.

Containing 155 hectares, more or less, as shown outlined in bold black on Appendix II attached hereto.

3. "Caycuse River" - Commencing at a point 402 metres east of the southeast corner of the southeast quarter of Section 5, Township 1, Renfrew Land District; thence east 1.609 kilometres; thence south 1.609 kilometres; thence west 1.609 kilometres; thence north 1.609 kilometres to the point of commencement.

Containing 255 hectares, more or less, as shown outlined in bold black on Appendix III attached hereto.

4. "Black Lake" -

Block 1

Lot 274, Barclay Land District

Block 2

Commencing at the southeast corner of Lot 661, Barclay Land

District, being a point on the high-water mark of Black Lake on the westerly shore thereof; thence westerly along the southerly boundaries of Lots 661, 660 and 662 to the northwest corner of Lot 273; thence northeasterly in a straight line to the northwest corner of said Lot 660; thence northeasterly in a straight line to the northeast corner of Lot 656; thence northerly and easterly along the westerly and northerly boundaries of the northeast quarter of Section 4, Township 1, Barclay Land District to the northeast corner thereof; thence northerly, easterly and southerly along the westerly, northerly and easterly boundaries of the west half of Section 10, Township 1 to the southeast corner thereof; thence southerly along the easterly boundaries of the northwest quarter of Section 3, Township 1, Lot 658 and Lot 663 to the southeast corner of said Lot 663; thence westerly along the southerly boundary of said Lot 663 to the high-water mark of aforesaid Black Lake on the easterly shore thereof; thence in a general northerly, westerly and southerly direction along the high-water mark of said Black Lake on the easterly, northerly and westerly shores thereof to the point commencement.

Containing a total of 724 hectares, more or less, as shown outlined in bold black on Appendix IV attached hereto.

5. "Calamity Lake" -

Block 1

Southeast quarter of Section 29, Township 1, Barclay Land District.

Block 2

Commencing at the intersection of the easterly boundary of the west half of Section 27, Township 1, Barclay Land District and the high-water mark of Sugsaw Lake on the southeasterly shore thereof; thence southerly along the easterly boundary of the west half of said Section 27 to the southeast corner thereof; thence southerly and westerly along the easterly and southerly boundaries of the northwest quarter of Section 22 to the southwest corner thereof; thence southerly along the easterly boundary of the southeast quarter of Section 21 to the southeast corner thereof; thence southerly and westerly along the easterly and southerly boundaries of Legal Subdivision 16 of Section 16 to the southwest corner thereof; thence southerly along the easterly boundaries of Legal Subdivisions 10, 7 and 2 of said Section 16 to the southeast corner of said Legal Subdivision 2; thence westerly and northerly along the southerly and westerly boundaries of the west half of the southeast quarter of said Section 16 to the northwest corner thereof; thence westerly and northerly along the southerly and westerly boundaries

of the northwest quarter of said Section 16 to northwest corner thereof; thence northerly and easterly along the westerly and northerly boundaries of Legal Subdivisions 4 and 6 of Section 21 to the northeast corner of said Legal Subdivision 6; thence northerly along the westerly boundary of the northeast quarter of said Section 21 to southerly boundary of Indian Reserve No. 4 'Sachsa'; thence easterly, northerly, westerly, northerly and westerly along the southerly, easterly, northerly, easterly and northerly boundaries of said Indian Reserve No. 4 to the westerly boundary of the east half of fractional Section 28; thence northerly, easterly and southerly along the westerly, northerly and easterly boundaries of the east half of said fractional Section 28 to a point on the high-water mark of aforesaid Sugsaw Lake on the westerly shore thereof; thence in a general southeasterly and northeasterly direction along the high-water mark of said Sugsaw Lake on the southwesterly and southeasterly shores thereof to the point of commencement.

Containing a total of 654 hectares, more or less, as shown outlined in bold black on Appendix V attached hereto.

6. "Kootowis River" - Deleted

7. "Snug Basin" - Lot 4, Clayoquot Land District. Containing 83 hectares, more or less, as shown outlined in bold black on Appendix VII attached hereto.

8. "Two Rivers Arm" - Lot 951, Clayoquot Land District. Containing 78 hectares, more or less, as shown outlined in bold black on Appendix VIII attached hereto.

9. "Sproat Lake" - Lot 952, Clayoquot Land District. Containing 49 hectares, more or less, as shown outlined in bold black on Appendix IX attached hereto.

Excluding thereout Highway No. 4, Plan 2750 R.W.; 9.1 metre Pole Line right of way, Plan 552 R.W.

10. "Great Central Lake" - Commencing at the northeast corner of Lot 733, Clayoquot Land District, being a point on the high-water mark of Great Central Lake on the southerly shore thereof; thence southerly and westerly along the easterly and southerly boundaries of said Lot 733 to the southwest corner thereof; thence south 805 metres; thence east 1.406 kilometres to the westerly boundary of Lot 70; thence northerly along the westerly boundary of said Lot 70 to

the most westerly northwest corner thereof; thence easterly along the northerly boundary of said Lot 70 563 metres; thence north 1.319 kilometres, more or less, to the high-water mark of aforesaid Great Central Lake on the southerly shore thereof; thence in a general westerly direction along the high-water mark of said Great Central Lake on the southerly shore thereof to the point of commencement.

Containing 225 hectares, more or less, as shown outlined in bold black on Appendix X attached hereto.

11. "Esary Lake" - Block 186, Alberni Land District. Containing 363 hectares, more or less, as shown outlined in bold black on Appendix XI attached hereto.

12. "MacTush Creek" - Commencing at the northeast corner of Lot 670, Clayoquot Land District, being a point on the high-water mark of Alberni Inlet on the westerly shore thereof; thence westerly along the northerly boundary of said Lot 670 578 metres; thence north 497 metres; thence west 1.609 kilometres; thence north 3.219 kilometres; thence east 1.609 kilometres; thence south 402 metres; thence east 1.022 kilometres, more or less, to the high-water mark of aforesaid Alberni Inlet on the westerly shore thereof; thence in a general southerly direction along the high-water mark of said Alberni Inlet on the westerly shore thereof to the point of commencement.

Containing 777 hectares, more or less, as shown outlined in bold black on Appendix XII attached hereto.

13. "Kennedy River" - Commencing at a point 2.201 kilometres north and 2.217 kilometres west of the most northerly corner of Lot 293, Clayoquot Land District, said point being on the westerly boundary of the watershed of Kennedy River; thence east 845 metres; thence north 405 metres; thence east 302 metres; thence north 503 metres; thence east 1.006 kilometres; thence north 101 metres; thence east 905 metres; thence north 604 metres; thence east 905 metres; thence north 302 metres; thence east 604 metres; thence south 604 metres; thence west 161 metres; thence south 201 metres; thence west 805 metres; thence south 402 metres; thence west 805 metres; thence south 402 metres; thence west 402 metres; thence south 402 metres; thence west 805 metres; thence south 805 metres; thence east 805 metres; thence south 402 metres; thence west 1.127 kilometres; thence south 503 metres; thence west 1.187 kilometres; thence north 503 metres; thence east 604 metres; thence north 604 metres; thence west 664 metres, more or less, to the westerly boundary of the watershed of aforesaid Kennedy River; thence in a general northerly

direction along the westerly boundary of the watershed of said Kennedy River to the point of commencement.

Containing 525 hectares, more or less, as shown outlined in bold black on Appendix XIII attached hereto.

Save and excepting thereout all that foreshore and land covered by water within the above described areas.



Province of British Columbia
Ministry of Forests and Lands
FOREST SERVICE

EXHIBIT A

Date March 31, 1987
Ref. Map 92.C/NE-W.1/2
Base Field book L.282-284(Corr)
Scale 1 : 20 000

Map Of

Outlined Area (383 ac) 155 hectares ± Forest Region 01 Vancouver

U.T.M. Grid

Zone	East	North	Reg.	Compt.	L
103510005399500006013A					

 District Port Alberni
Land District 02 Barclay

MANAGEMENT UNIT		TIMBER SUPPLY AREA		Pulpwood Agreement	Cascades	
Type	0	Number	32 Nootka			East
Number	57 Nootka	Block	51 Barkley		West	
Block		Sub-B				

Schedule E of M.B.

Appendix II - 'Darling River'

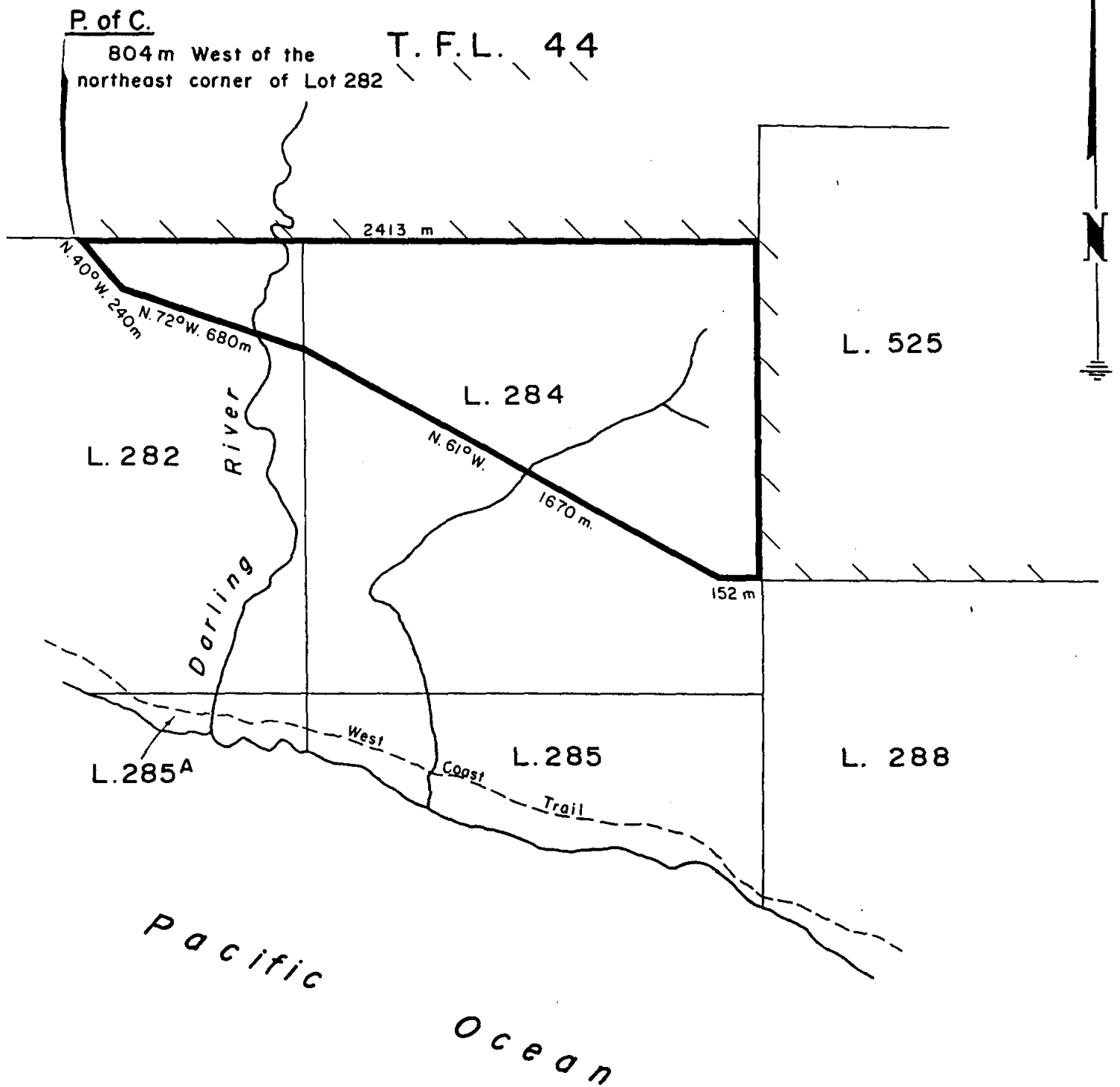



Province of
British Columbia
Ministry of Forests
and Lands

EXHIBIT 'A'

MAF

U.T.M. Zone	East			North			Reg	Compt.	L												
Grid	1	0	3	7	9	5	0	0	5	4	0	7	5	0	0	0	6	0	0	8	F

FOREST REGION 01 Vancouver
LAND DISTRICT 46 Renfrew
DISTRICT 7 Port Alberni
OUTLINE > _____

Date .. March 31, 1987.....
Ref. Map .. 92C/NE-W 1/2.....
Base .. 92C087.....
Scale 1: .. 20 000.....
Area (630ac) ... 255 hectares

Type	MANAGEMENT UNIT 0	Number	TIMBER SUPPLY AREA 32	NOOTKA	PULPWOOD AGREEMENT	CASCADES
Number	57 NOOTKA	Block	51	BARKLEY		East
Block		Sub-B				West C

Schedule E of M.B.

Appendix III - 'Caycuse River'

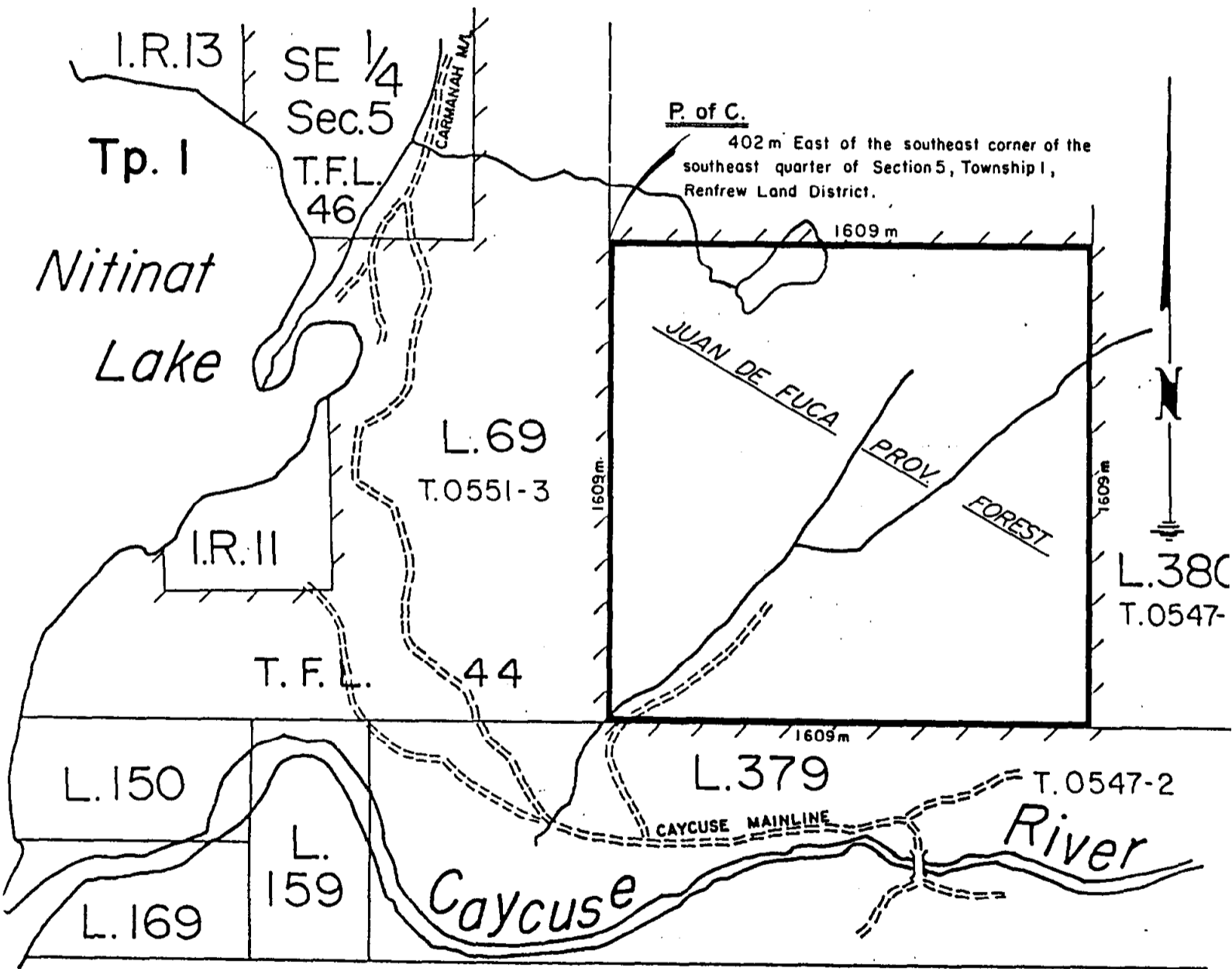

Drawn by _____
Amended 86-08-07 R.B.



Province of
British Columbia
Ministry of Forests
and Lands

MAP 0

U.T.M.	Zone	East	North	Reg	Compt	1
Grid	10540400	3460000	06013	A		

FOREST REGION - 01 Vancouver

LAND DISTRICT - 02 Barclay

DISTRICT - 7 Port Alberni

OUTLINE - _____

EXHIBIT 'A'

Date ... March 31, 1987

Ref Map ... 92C/NE-W/2

Base ... 92C075

Scale 1:31,680

Area ... 724 hectares (1789 ac)

Type	MANAGEMENT UNIT O	Number	TIMBER SUPPLY AREA 32 NOOTKA	PULPWOOD AGREEMENT	CASCADE S
Name	57 NOOTKA	Block	51 BARKLEY		East
Block		Sub-B			West C

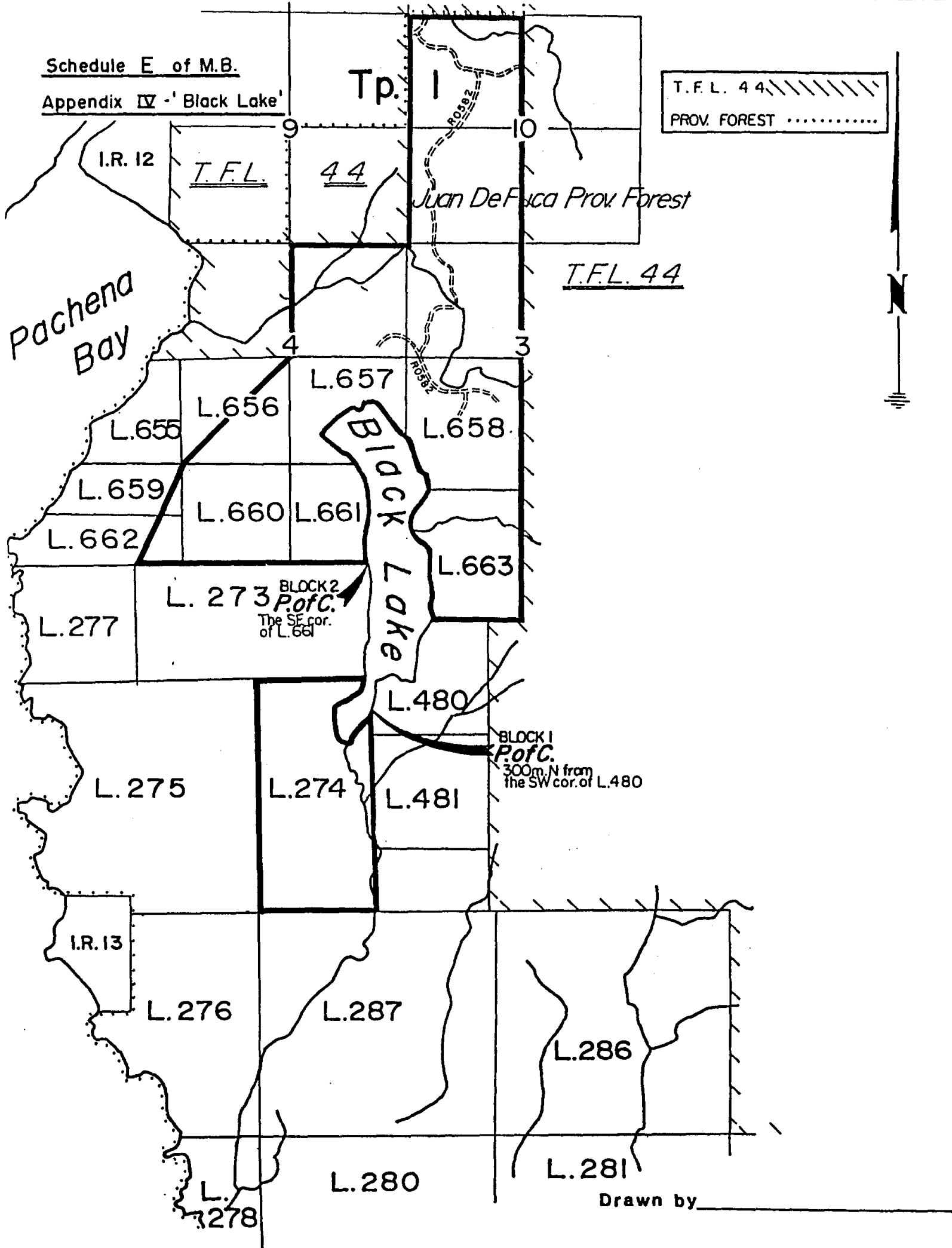

Drawn by _____



Province of
British Columbia
Ministry of Forests
and Lands

MAP OF ▶

U.T.M.	Zone	East	North	Reg	Compt.	L
Grid	10346000	05410000	006013	D		

FOREST REGION ▶ 01 Vancouver
LAND DISTRICT ▶ 02 Barclay
DISTRICT ▶ 7 Port Alberni
OUTLINE ▶ _____

EXHIBIT 'A'
Date March 31, 1987...
Ref. Map 92C/NE-W1/2...
Base " "
Scale 1: 31680
Area 654 hectare:
(1616 ac)

Type	MANAGEMENT UNIT 0	Number	TIMBER SUPPLY AREA NOOTKA 32	PULPWOOD AGREEMENT	CASCADES
Number	57 NOOTKA	Block	BARKLEY 51		East
Block		Sub-B			West C

Schedule E of M.B.

Appendix V - 'Calamity Lake'

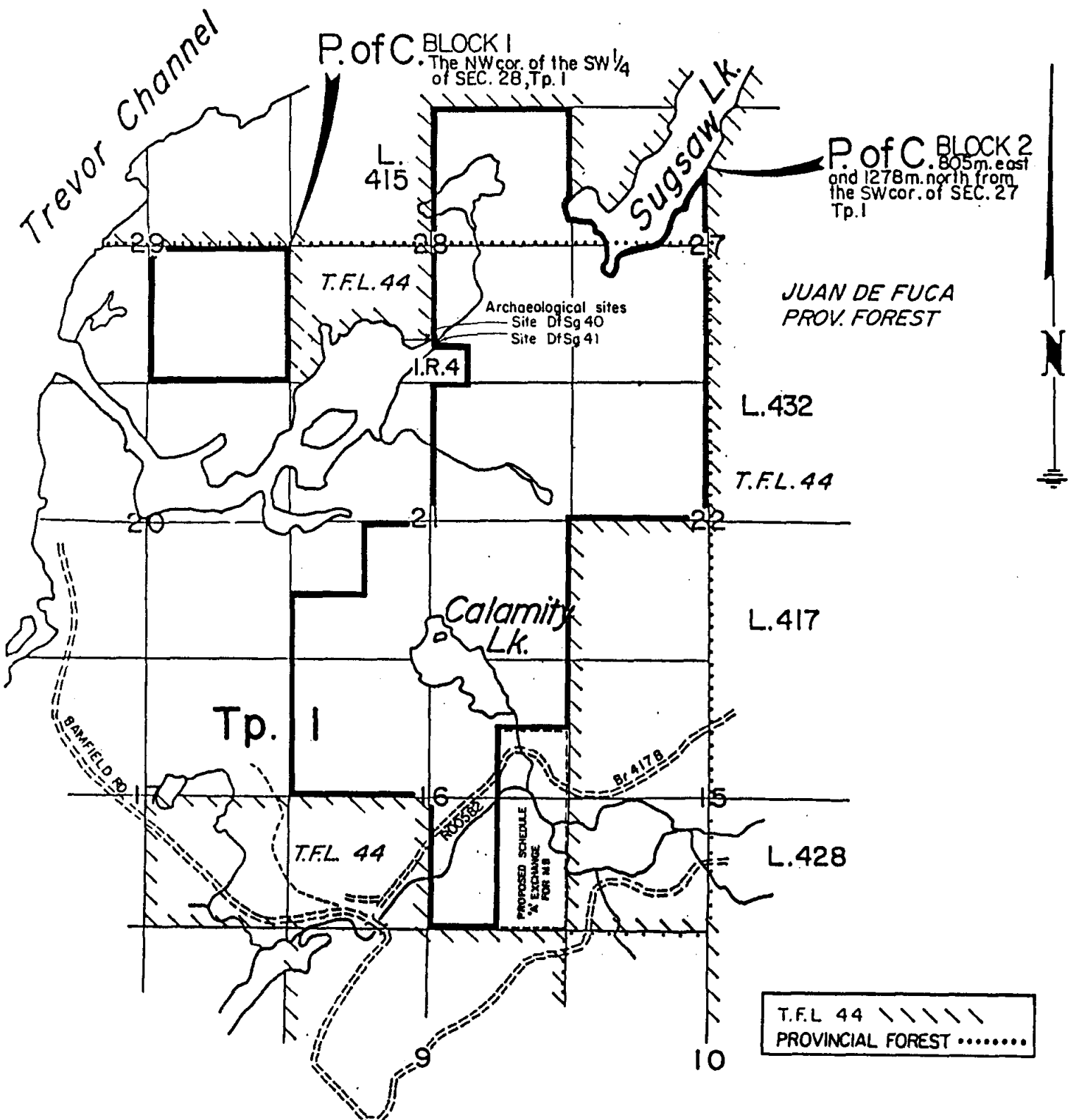

Drawn by _____



Province of
British Columbia
Ministry of Forests
and Lands

EXHIBIT 'A'

MAP

U.T.M.	Zone	East	North	Reg	Compl.	L
Grid	10352000	54325000	0500050007	A		

FOREST REGION ▶ 01 Vancouver LAND DISTRICT ▶ 09 Clayoquot

DISTRICT ▶ 7 Port Alberni OUTLINE ▶ _____

Date ... March 31, 1987
Ref. Map ... 92F/SW-E 1/2
Base ... 92F005
Scale 1: ... 20 000
Area ... 83 hectares
(205 ac)

Type	MANAGEMENT UNIT 0	Number	TIMBER SUPPLY AREA NOOTKA 32	PULPWOOD AGREEMENT	CASCADES
Number	57 NOOTKA	Block	BARKLEY 51		East
Block		Sub-B			West C

Schedule E of M.B.

Appendix VII - 'Snug Basin'

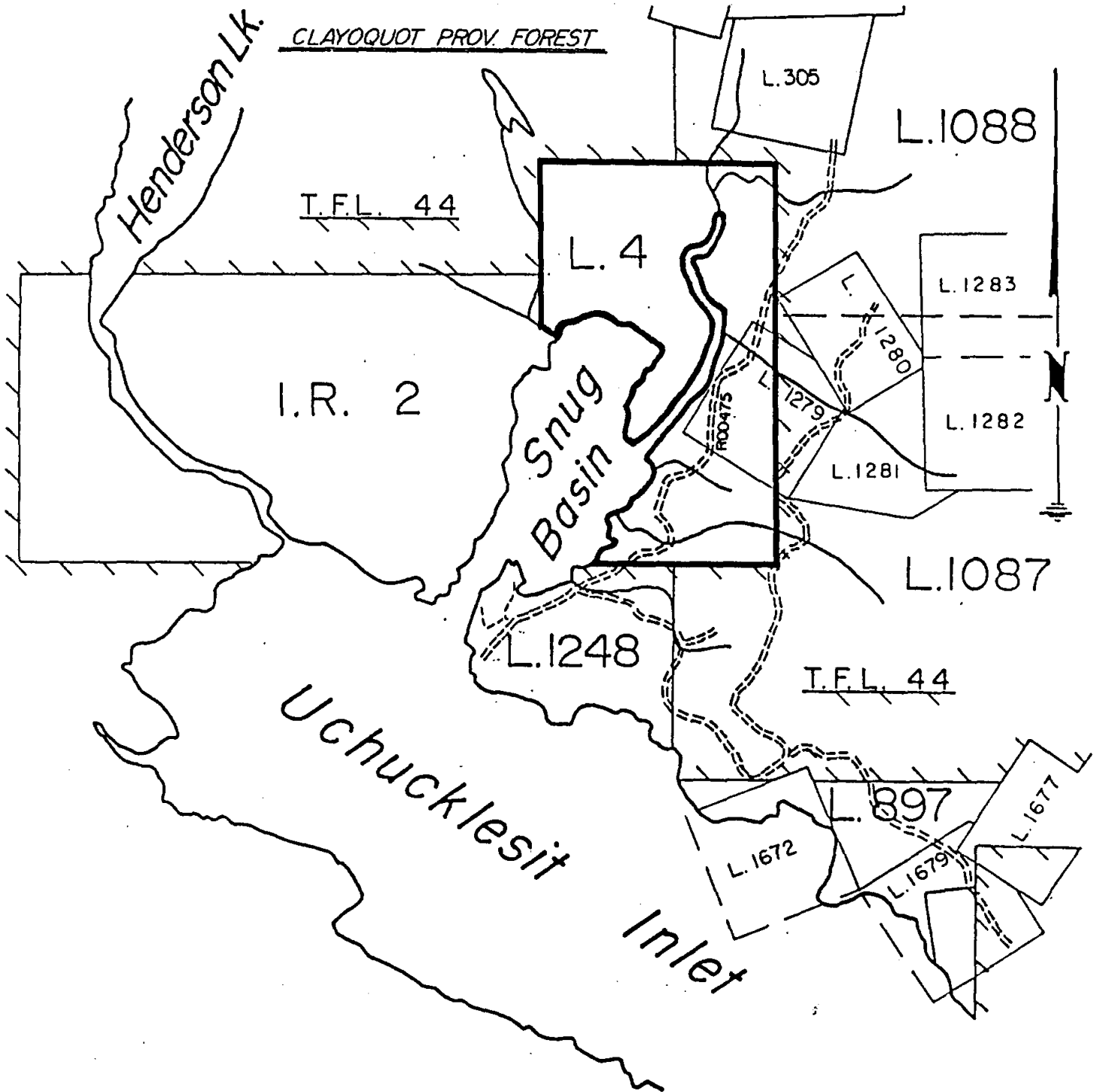

Drawn by _____



Province of
British Columbia
Ministry of Forests
and Lands

EXHIBIT 'A'

MAP C

U.T.M.	Zone	East					North					Reg	Compl.	L					
Grid	10	3	5	5	7	0	0	5	4	5	8	0	0	0	5	0	0	4	A

FOREST REGION ▶ 01 Vancouver LAND DISTRICT ▶ 09 Clayoquot

DISTRICT ▶ 7 Port Alberni OUTLINE ▶ _____

Date ... March 31, 1987
 Ref. Map ... 92F/7
 Base ... 92F026
 Scale 1: 20,000
 Area ... 78 hectares
 (193 ac)

Type	MANAGEMENT UNIT 0	Number	TIMBER SUPPLY AREA NOOTKA 32	PULPWOOD AGREEMENT	CASCADES
Number	NOOTKA 57	Block	BARKLEY 51		East
Block		Sub-B			West C

Schedule E of M.B.

Appendix VIII - 'Two Rivers Arm'

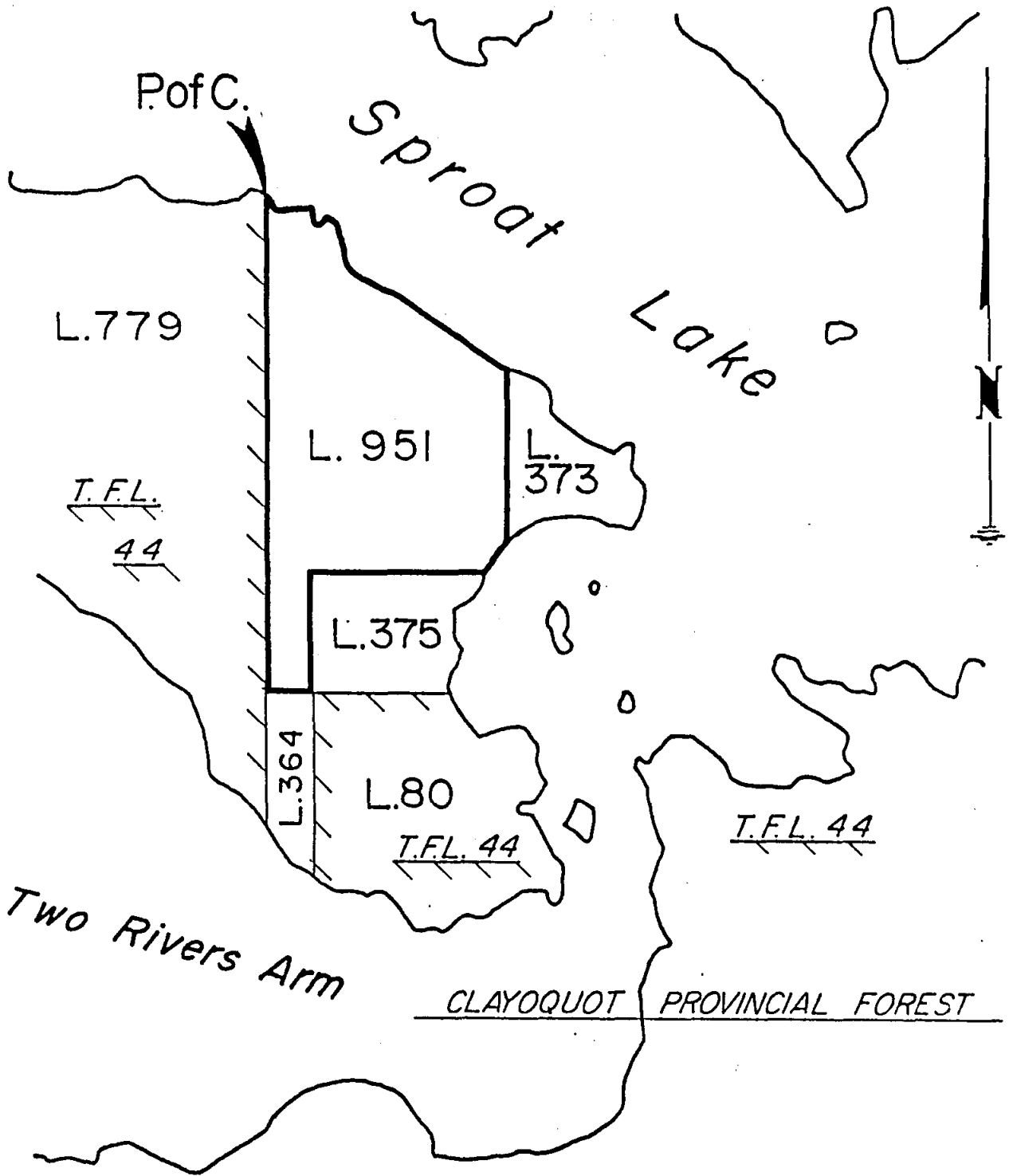

Drawn by _____



Province of
British Columbia
Ministry of Forests
and Lands

EXHIBIT 'A'

MAP																				
U.T.M.	Zone	East				North				Reg	Compt.	L								
Grid	1	0	3	5	4	0	0	0	5	4	6	1	0	0	0	5	0	0	4	B
FOREST REGION ▶ 01 Vancouver										LAND DISTRICT ▶ 09 Clayoquot										
DISTRICT ▶ 7 Port Alberni										OUTLINE ▶										

Date .. March 31, 1987
 Ref. Map .. 92F/7
 Base .. 92F026
 Scale 1: 20 000
 Area .. 49 .. hectares
 (121 ac)

Type	MANAGEMENT UNIT O	Number	TIMBER SUPPLY AREA 32 NOOTKA		PULPWOOD AGREEMENT	CASCADES
Number	57 NOOTKA	Block	51	BARKLEY		East
Block		Sub-B				West C

Schedule E of M.B.

Appendix IX - 'Sproat Lake'

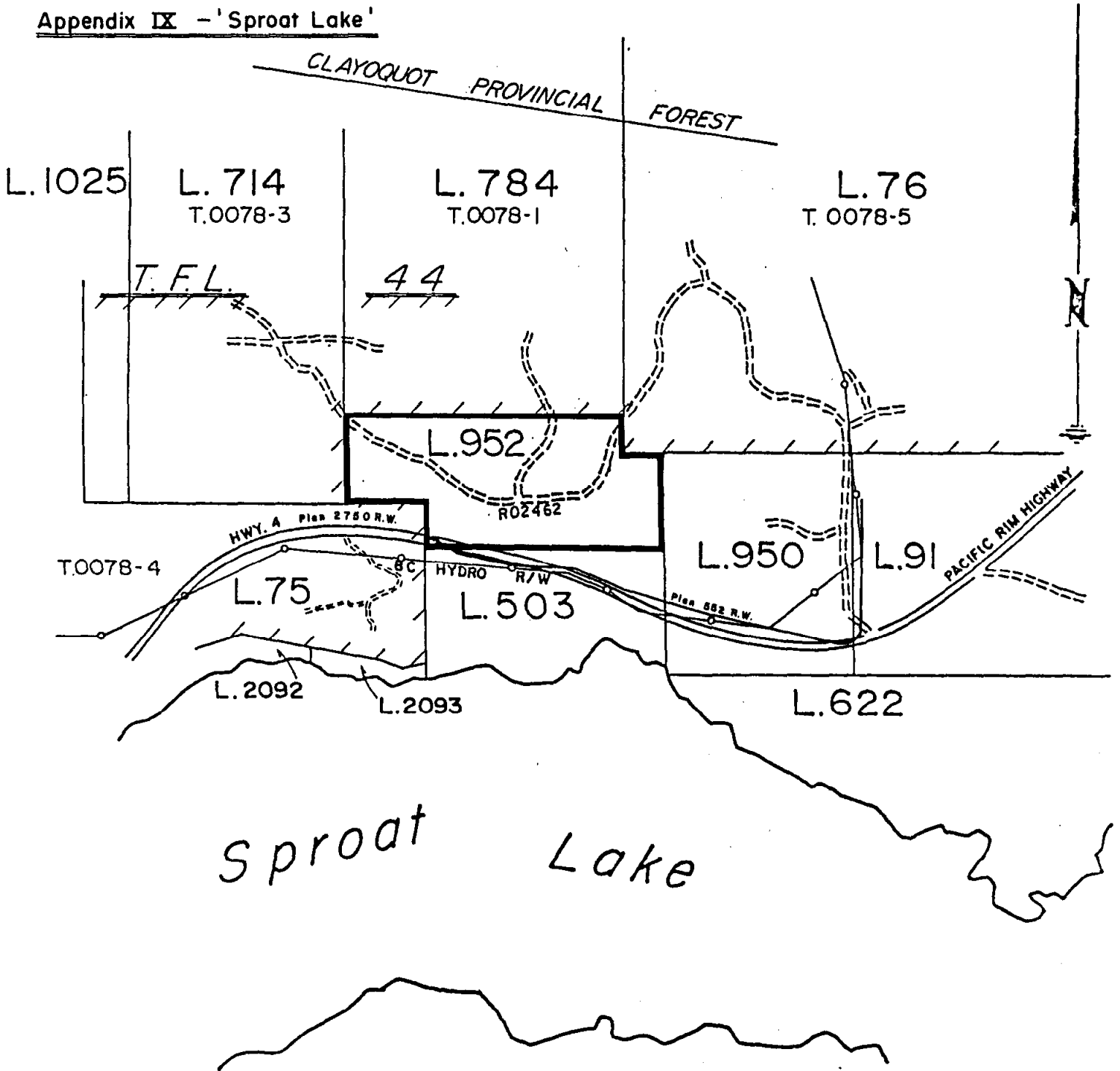

Excluding thereout;
 Highway N° 4, Plan 2750 R.W.
 9.1m Pole Line right-of-way, Plan 552 R.W.



Province of
British Columbia
Ministry of Forests and Lands
Forest Service

MAP C

U.T.M. Zone	East				North				Reg	Compt.	L										
Grid	1	0	3	4	1	0	0	0	5	4	6	9	0	0	0	0	5	0	0	3	A

FOREST REGION ▶ 01 Vancouver

LAND DISTRICT ▶ 09 Clayoquot

DISTRICT ▶ 7 Port Alberni

OUTLINE ▶

EXHIBIT 'A'

Date ... March 31, 1987

Ref. Map ... 92F/SW-E/2

Base ... 92F035

Scale | 20000

Area ... 225 hectares (556 ac)

Type	MANAGEMENT UNIT 0	Number	TIMBER SUPPLY AREA NOOTKA 32	PULPWOOD AGREEMENT	CASCADES
Number	57 NOOTKA	Block	BARKLEY 51		East
Block		Sub-B			West C

Schedule E of M.B.

Appendix X - 'Great Central Lake'

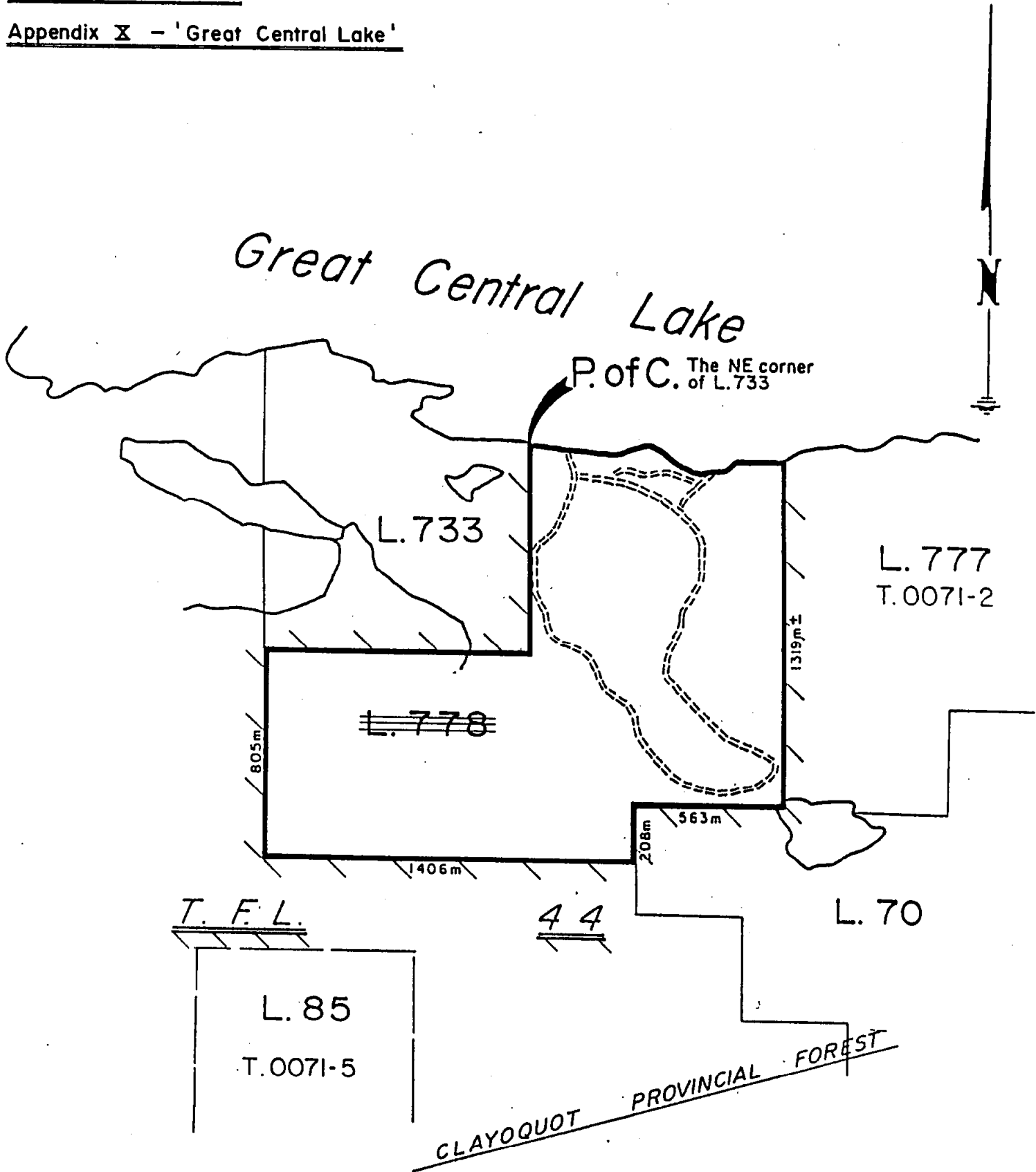

Drawn by _____



Province of
British Columbia
Ministry of Forests
and Lands

Zone	East	North	Reg	Compt.	L
1	0	3	7	1	0
0	0	0	5	4	6
5	0	0	0	0	0
0	0	0	0	7	0
1	3	8			

FOREST REGION ▶ OI Vancouver
LAND DISTRICT ▶ OI Alberni
DISTRICT ▶ 7 Port Alberni
OUTLINE ▶

EXHIBIT 'A'
Date March 31, 1987
Rel. Map 92 F/7
Base 92 F037
Scale 1:20000
Area 363 hectares
(897 ac)

Type	MANAGEMENT UNIT E & N	Number	TIMBER SUPPLY AREA 28 QUADRA	PULPWOOD AGREEMENT	CASCADES
Number		Block	42 NANAIMO		East
Block		Sub-B			West C

Schedule E of M.B.

Appendix XI - 'Esary Lake'

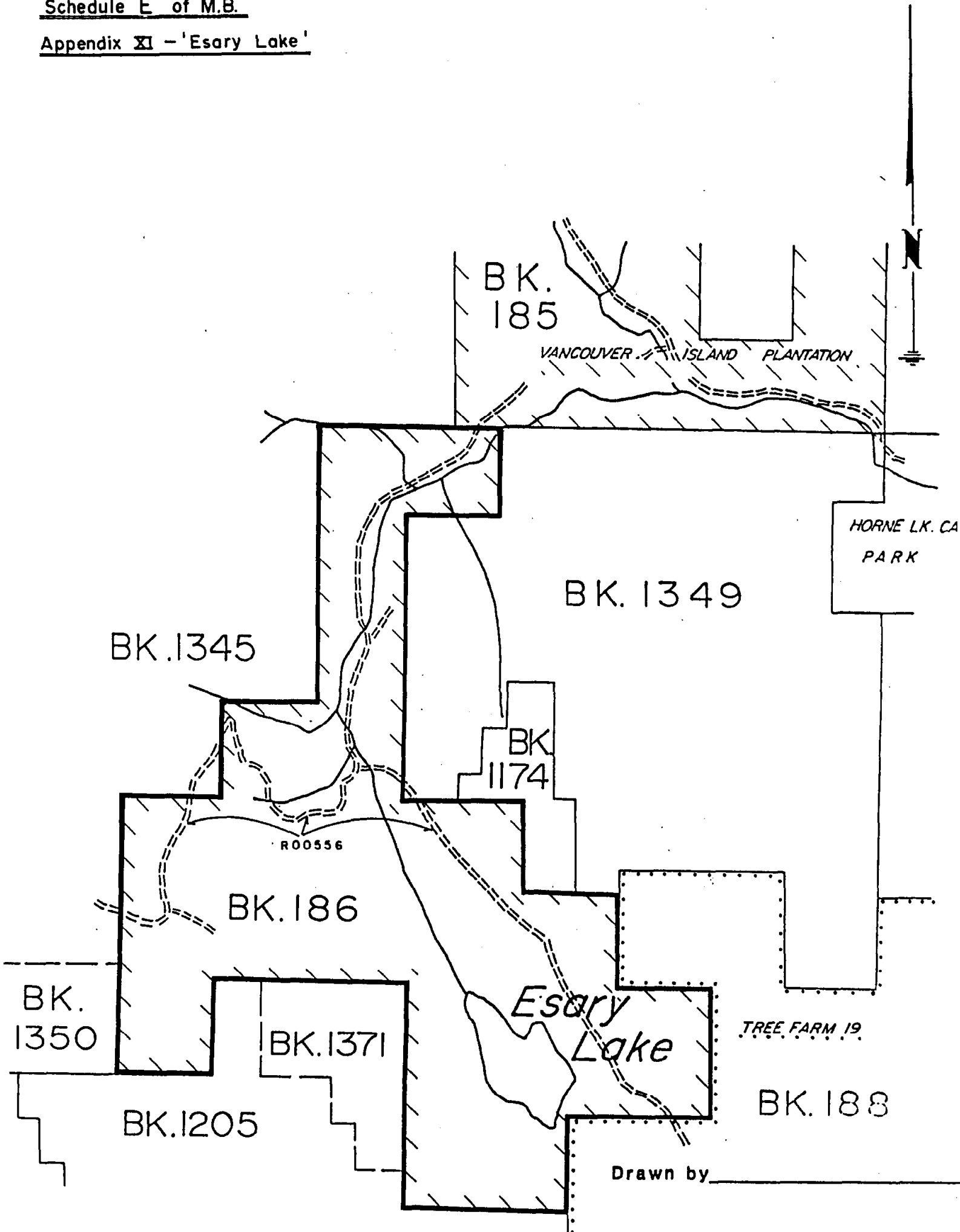



Province of
British Columbia
Ministry of Forests
and Lands

MA

U.T.M.	Zone	East	North	Reg	Compt.	L
Grid	103670000	5444000	0050100	0	0	0

FOREST REGION ▶ 01 Alberni
LAND DISTRICT ▶ 09 Clayoquot
DISTRICT ▶ 7 Port Alberni
OUTLINE ▶ _____

EXHIBIT 'A'

Date March 31, 1987.
Ref Map 92F/2
Base 92F016
Scale 1: 20000
Area 777 hectares
(1920 ac)

Type	MANAGEMENT UNIT O	Number	TIMBER SUPPLY AREA NOOTKA 32	PULPWOOD AGREEMENT	CASCADFS
Number	57 NOOTKA	Block	BARKLEY 51		East
Block		Sub-B			West C

Schedule E of M.B.

Appendix XII - 'Mac Tush Creek'

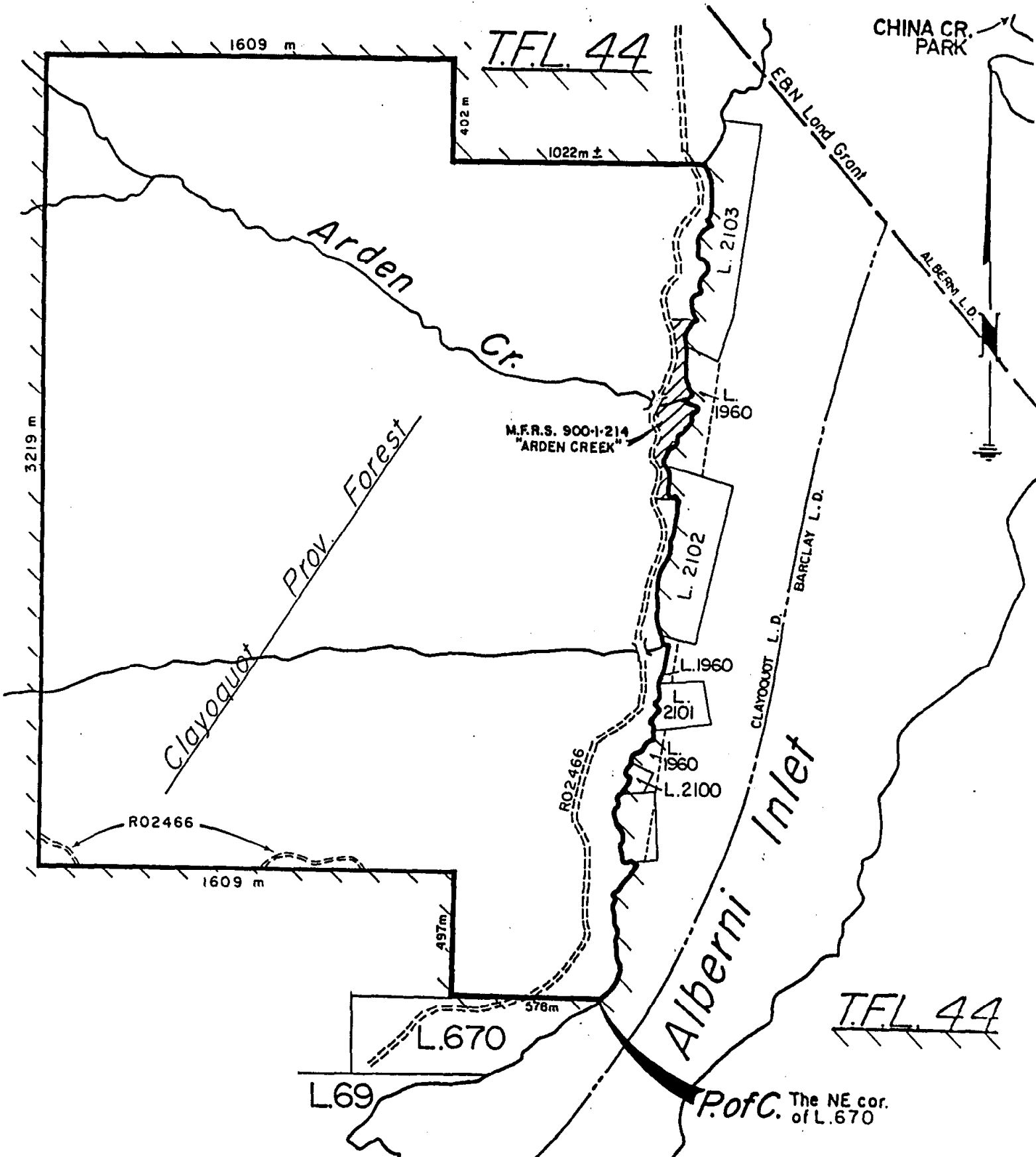

Drawn by _____



Province of British Columbia
Ministry of Forests and Lands
FOREST SERVICE

EXHIBIT A

Date March 31, 1987
Ref. Map 92 F / SW - W1/2
Base 92 F / 002, 012
Scale 1 : 20 000

Map Of

Outlined Area (390 ac) 158 hectares ± Forest Region Vancouver

U.T.M. Grid

Zone	East	North	Reg.	Compt.	L
10298500	5444500	0050100	05	01	0B

 District Port Alberni
Land District Clayoquot

MANAGEMENT UNIT		TIMBER SUPPLY AREA		Pulpwood Agreement	Cascades	
Type	T	Number	Arrowsmith			East
Number		Block		West		
Block		Sub-B				

Schedule C of M.B.
Appendix I - 'T0340'

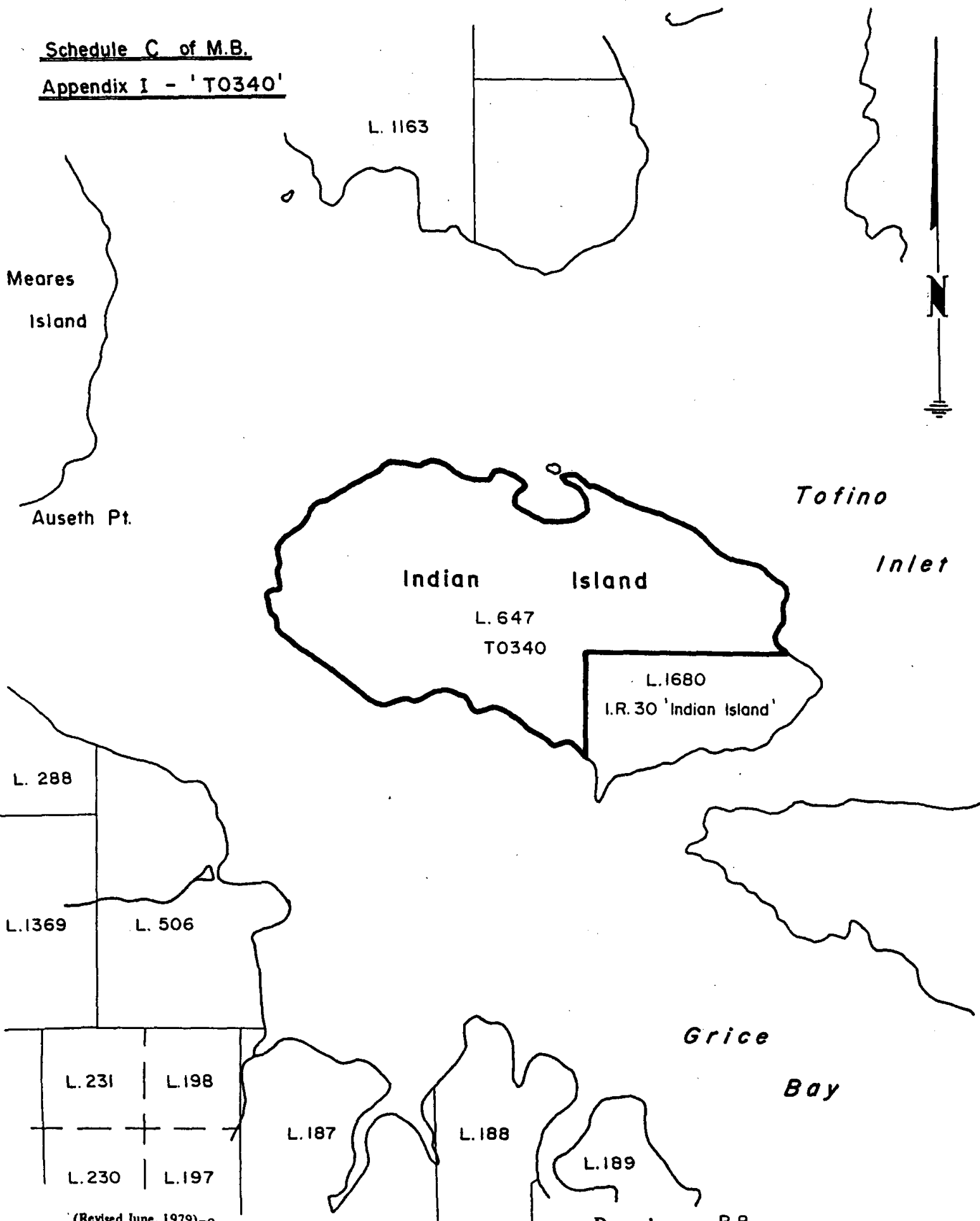

(Revised June, 1979)-o

Drawn by.....R.B.



Province of British Columbia
Ministry of Forests and Lands
FOREST SERVICE

EXHIBIT A

Date March 31, 1987
Ref. Map 92C/NE-W1/2-C
Base 92C-075
Scale 1 : 20 000

Map Of

Outlined Area (141 ac) 57 hectares ± Forest Region 01 - VANCOUVER

U.T.M. Zone East North Reg. Compt. L District 17 - PORT ALBERNI

Grid 1 0 3 4 5 0 6 0 5 4 0 6 0 9 0 0 6 0 1 3 E Land District BARCLAY

MANAGEMENT UNIT		TIMBER SUPPLY AREA		Pulpwood Agreement	Cascades	
Type	T	Number			East	West
Number	44	Block				
Block	2	Sub-B				J

Schedule C of M.B.

Appendix II - 'T0732'

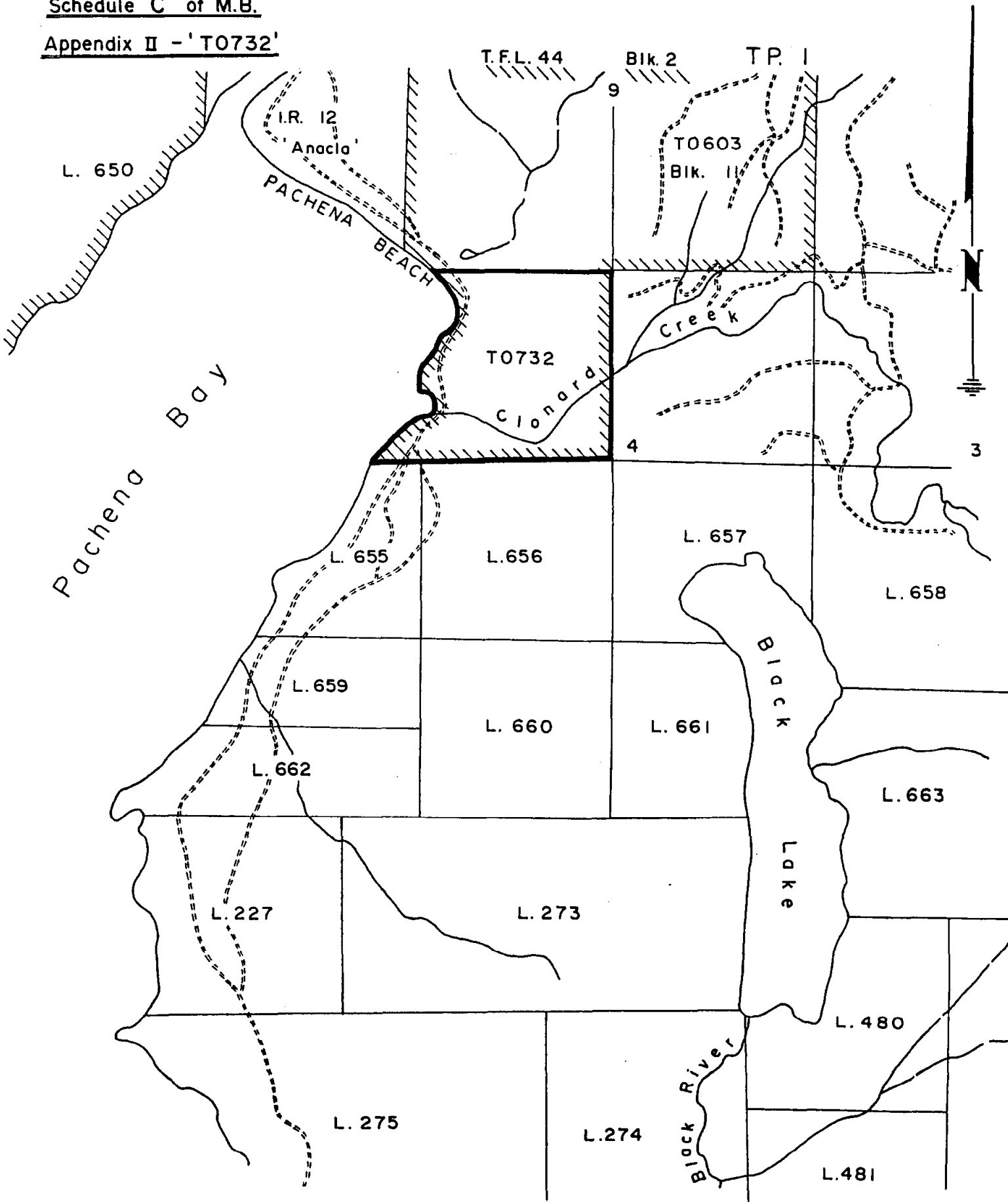



Province of British Columbia
Ministry of Forests and Lands
FOREST SERVICE

EXHIBIT A

Date March 31, 1987

Ref. Map 92 F/SW-W1/2

Base 92 F-002

Scale 1 : 20 000

Map Of

Outlined Area (20 ac) 8 hectares ±

Forest Region 01 - VANCOUVER

District 17 - PORT ALBERNI

Land District CLAYOQUOT

U.T.M. Zone	East	North	Reg.	Compt.	L
Grid	10301500	5439000	005010E		

MANAGEMENT UNIT		TIMBER SUPPLY AREA		Pulpwood Agreement	Cascades	
Type	T	Number			East	West
Number	44	Block				
Block	5	Sub-B				✓

Schedule C of M.B.

Appendix III - 'T0579 Block 3'

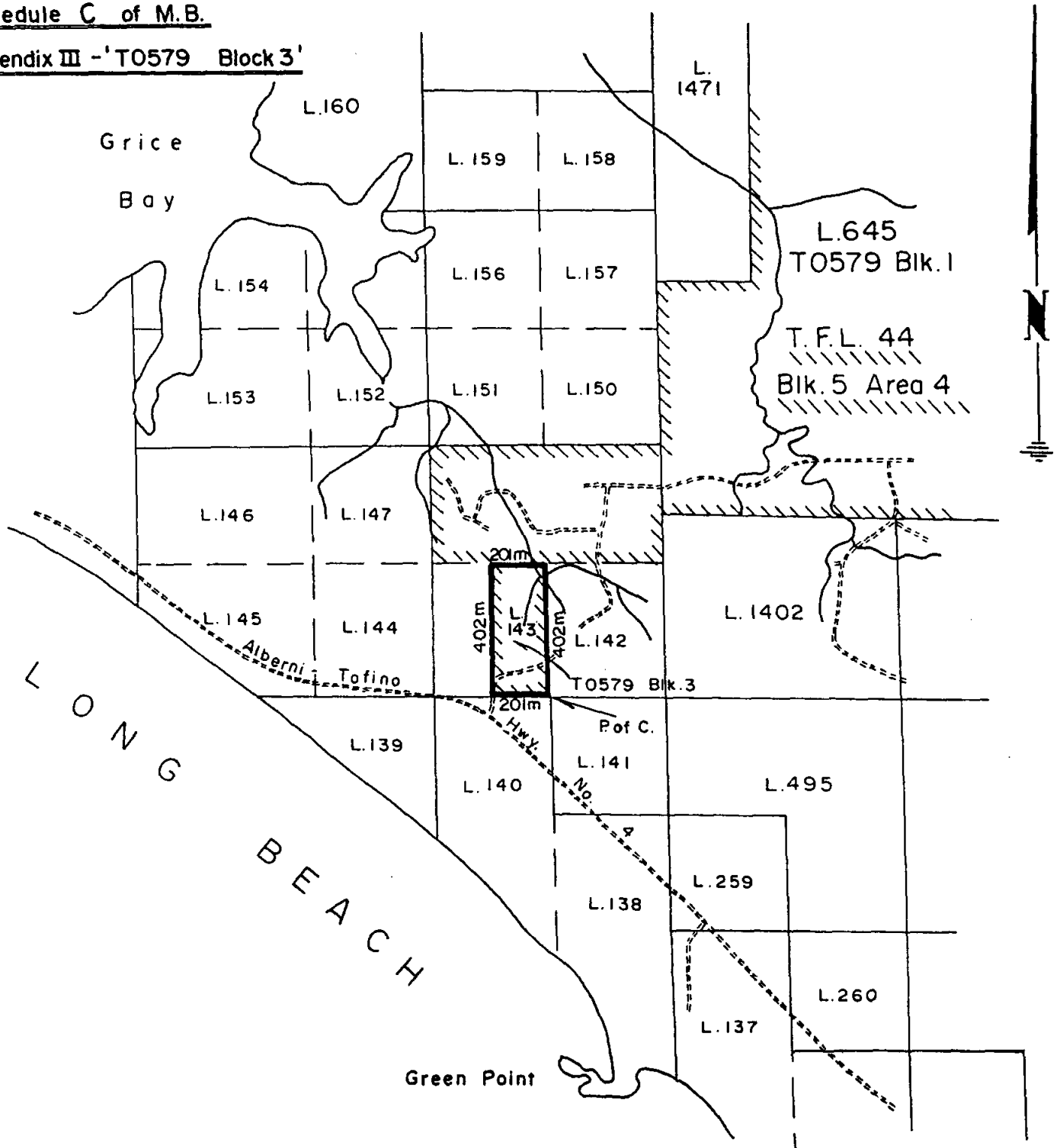



Province of British Columbia
Ministry of Forests and Lands
FOREST SERVICE

EXHIBIT A

Date March 31, 1987

Ref. Map 92F/SW-W1/2

Base 92F-002

Scale 1 : 20 000

Map Of

Outlined Area (37ac) 15 hectares ± Forest Region OI - VANCOUVER

U.T.M. Zone East North Reg. Compt. L District 17 - PORT ALBERNI

Grid 1 0 2 9 9 5 5 0 5 4 4 1 2 0 0 0 5 0 1 0 8 Land District CLAYOQUOT

MANAGEMENT UNIT		TIMBER SUPPLY AREA		Pulpwood Agreement	Cascades	
Type	T	Number			East	West
Number	44	Block				
Block	5	Sub-B				✓

Schedule C of M.B.

Appendix IV - 'T0579 Block 4'

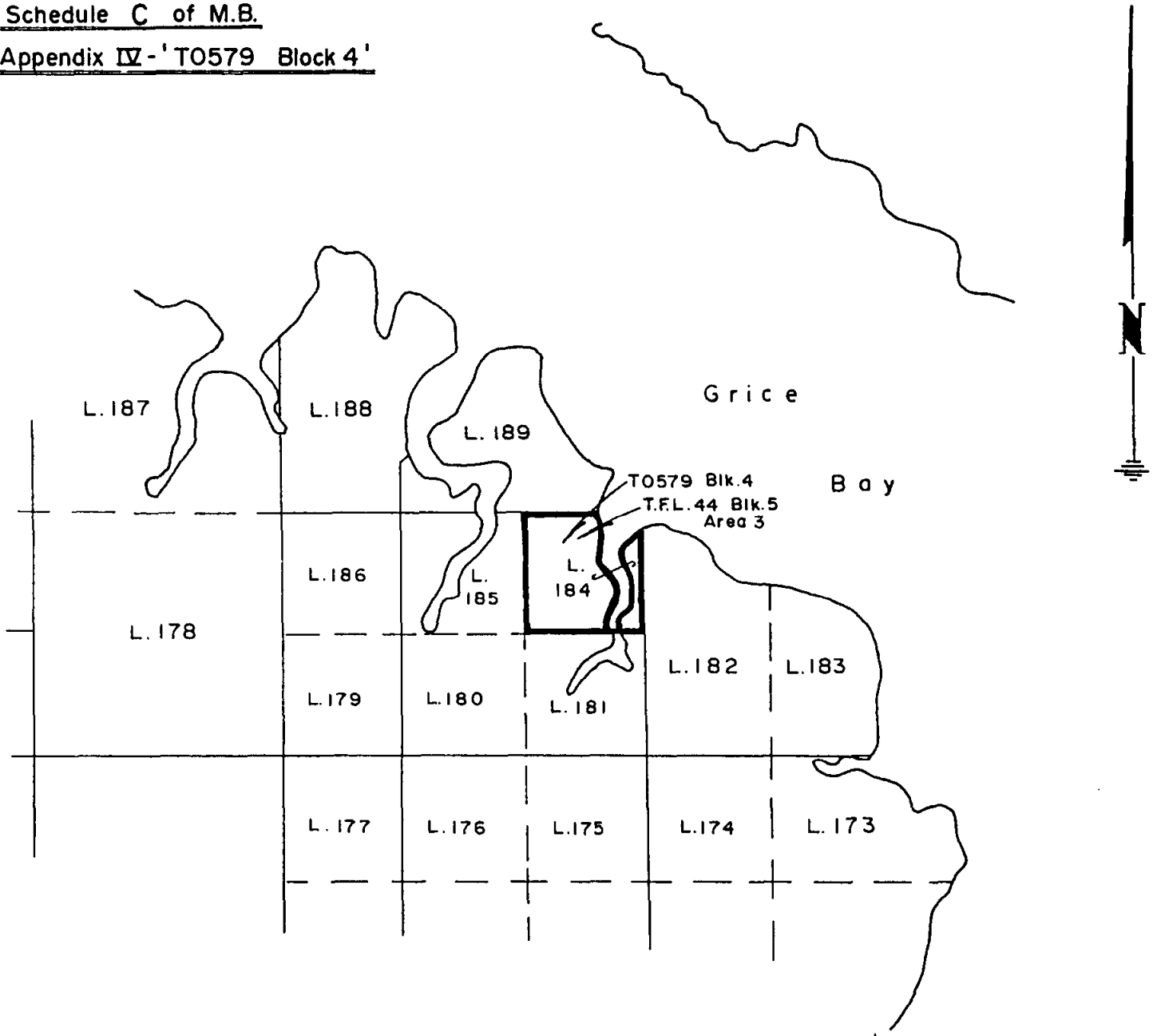



Province of British Columbia
Ministry of Forests and Lands
FOREST SERVICE

EXHIBIT A

Date March 31, 1987
Ref. Map 92C/NE-W1/2-D
Base 92C 077-087 Planime
Scale 1 : 20 000

Map Of

Outlined Area (516 ac) 209 hectares ± Forest Region 01 - VANCOUVER

U.T.M. Zone East North Reg. Compt. L District 16 - DUNCAN
Grid 1 0 3 6 7 0 0 0 5 4 0 5 5 0 0 0 6 0 1 1 a Land District BARCLAY

MANAGEMENT UNIT		TIMBER SUPPLY AREA		Pulpwood Agreement	Cascades	
Type	T	Number	Block		East	West
Number	44	Block				
Block	2	Sub-B				✓

Schedule C of M.B.

Appendix VI - 'part of T0738 Block 3'

Area subject to survey

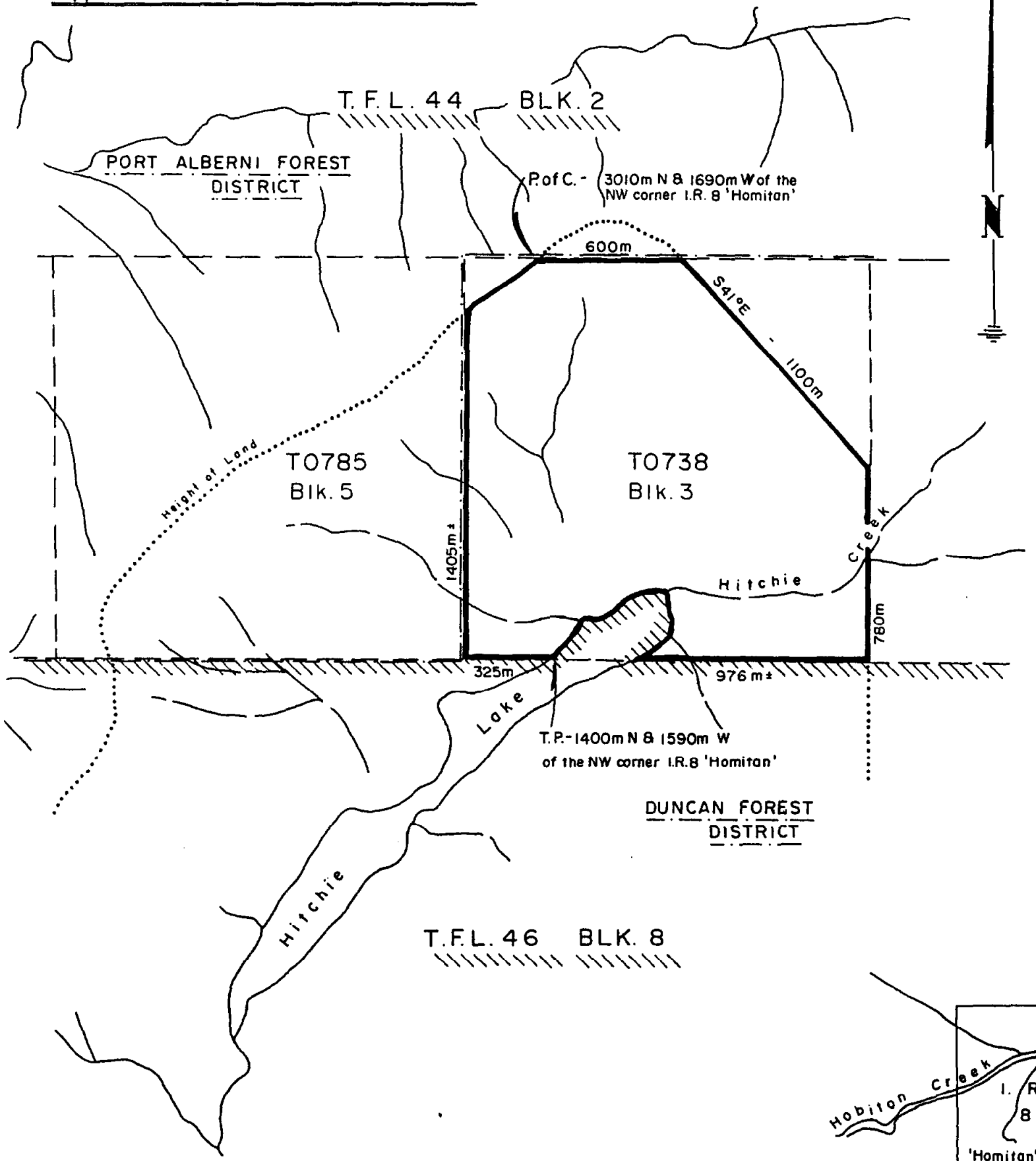



Province of British Columbia
Ministry of Forests and Lands
FOREST SERVICE

EXHIBIT A

Date March 31, 1987
Ref. Map 92C/NE-W1/2-D
Base 92C 077-087 Planime
Scale 1 : 20 000

Map Of

Outlined Area (297ac) 120 hectares ± Forest Region O1 - VANCOUVER

U.T.M. Zone	East	North	Reg.	Compt.	L
Grid	1 0 3 6 7 0 0 0	5 4 0 5 5 0 0 0	0 6 0	1 2	c

District 17 - PORT ALBERNI
Land District BARCLAY

MANAGEMENT UNIT		TIMBER SUPPLY AREA		Pulpwood Agreement	Cascades	
Type	T	Number			East	West
Number	44	Block				
Block	2	Sub-B				✓

Schedule C of M.B.

Appendix VII - 'part of T0785 Block 5'

Area subject to survey

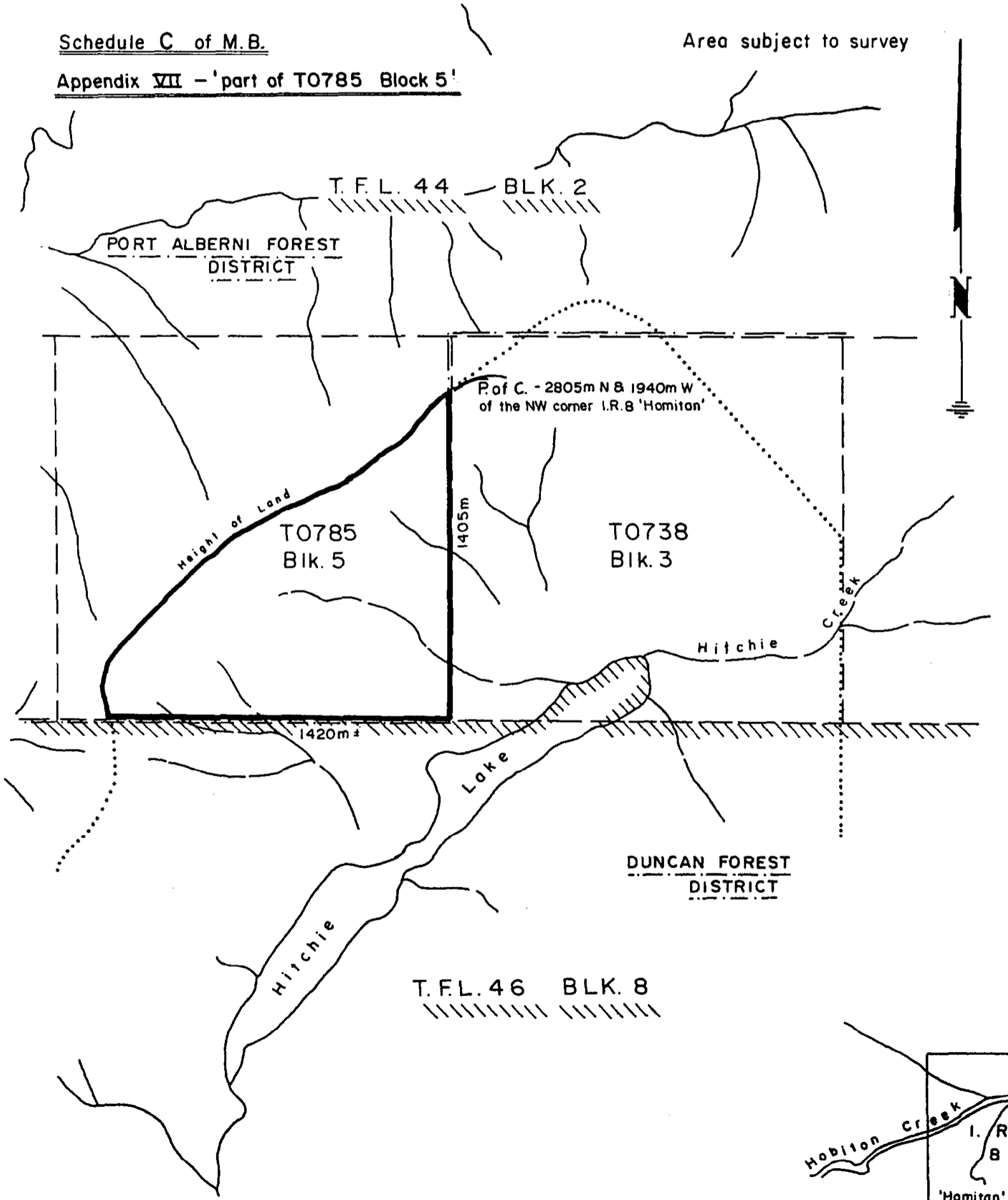



Province of British Columbia
Ministry of Forests and Lands
FOREST SERVICE

EXHIBIT A

Date March 31, 1987
Ref. Map 92 F SW W 1/2
Base PLAN 92 F 002
Scale 1 : 20 000

Map Of _____

Outlined _____ Area (80 ac.) 32 hectares ± Forest Region 01 VANCOUVER

U.T.M. Grid

Zone	East			North			Reg.	Compt.	L									
10	3	0	1	0	0	0	5	4	3	8	0	0	0	0	5	0	1	0

 District 17 PORT ALBERNI
Land District 09 CLAYOQUOT

MANAGEMENT UNIT		TIMBER SUPPLY AREA		Pulpwood Agreement	Cascades	
Type	OT	Number				East
Number	44	Block			West	C
Block		Sub-B				

Schedule D of M.B.

Appendix I - 'Wickaninnish Bay'

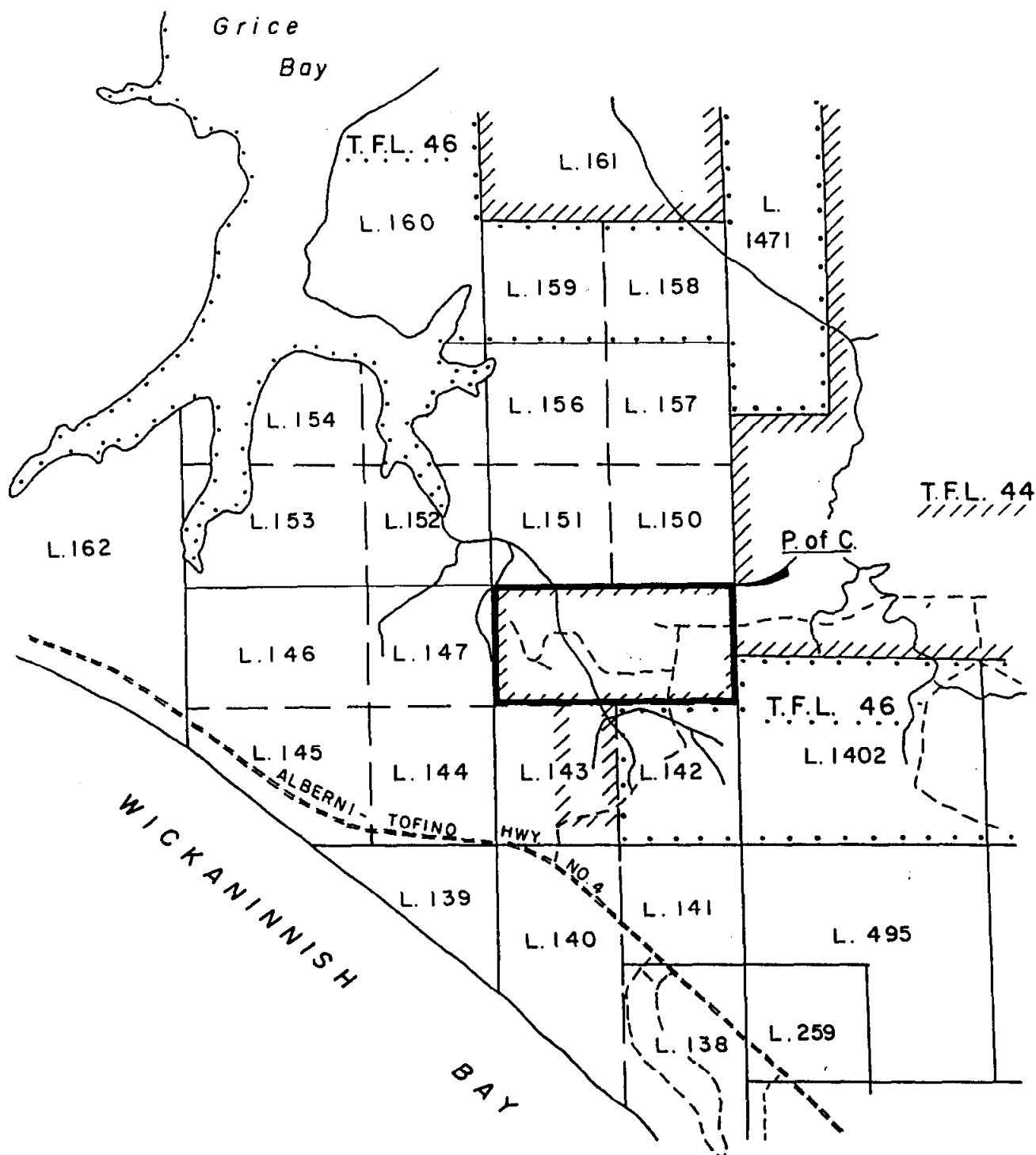



Province of British Columbia
Ministry of Forests and Lands
FOREST SERVICE

EXHIBIT A

Date March 31, 1987
Ref. Map 92 F/SW-WI/2
Base 92 F - 002 Planimetric
Scale 1 : 20 000

Map Of

Outlined  Area (272 ac) 110 hectares ±

Forest Region 01 - VANCOUVER

U.T.M. Zone	East	North	Reg.	Compl.	L
10301800	05441200	0050108			

District 07 - PORT ALBERNI

Land District CLAYOQUOT

MANAGEMENT UNIT		TIMBER SUPPLY AREA		Pulpwood Agreement	Cascades	
Type	T	Number				East
Number	44	Block			West	✓
Block	5	Sub-B				

Schedule D of M.B.

Appendix II - 'Grice Bay'

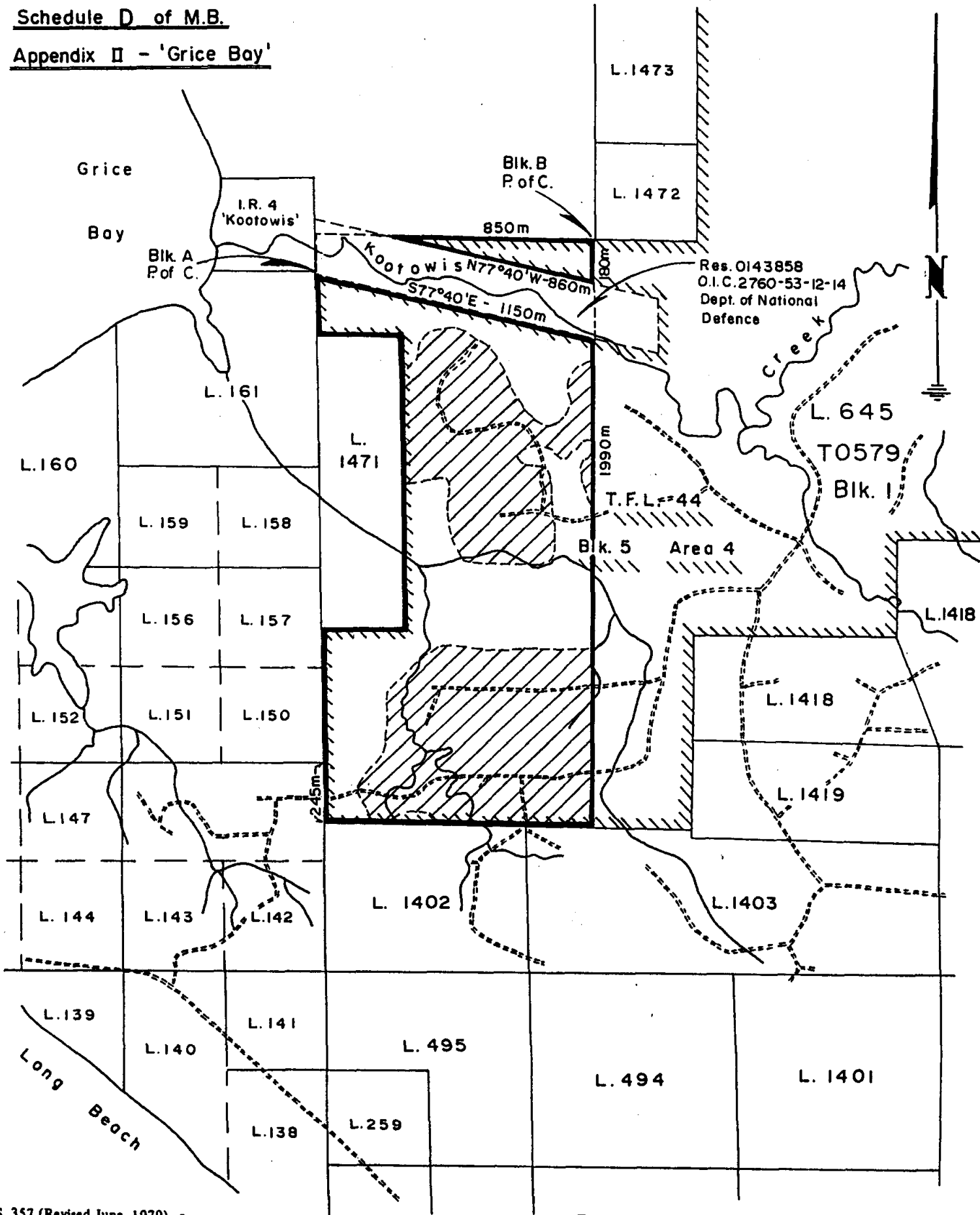

Date March 31, 1987
 Ref. Map 92.C.NE.W/2.B
 Base PLAN 92.C.051.057
 Scale 1:20,000

(P39)
 Province of British Columbia
 Ministry of Forests and Lands
 FOREST SERVICE

Map Of _____

Outlined _____ Area (1915 A/L) 775 hectares ± Forest Section 01 VANCOUVER
 UTM Zone 10S East 372000 North 5318700 Reg. Comp. 1 District 16 DUNCAN, 17 PORT ALBERNI
 Grid 10S3720005318700060606A Lead District 46 RENFREW

MANAGEMENT UNIT		TIMBER SUPPLY AREA		Proposed Agreement		Cascades	
Type	Number	Number	Area	East	West	East	West
OT	44	54-8					

Schedule D of MB
 Appendix IV - "Carmonah Point"

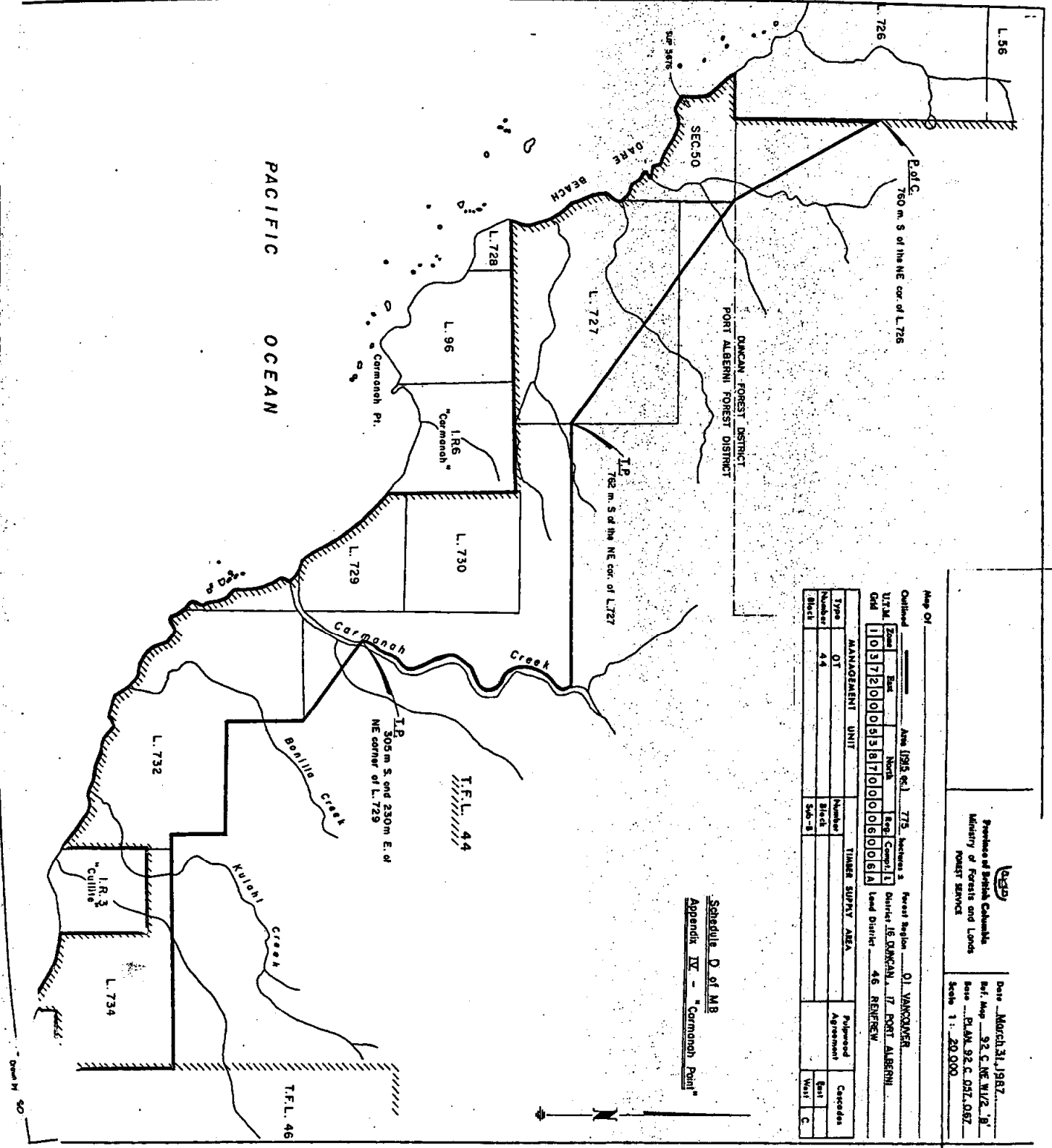

Province of British Columbia
Ministry of Forests and Lands
Forest Service

Forest Region: Q1 Vancouver
District: Port Alberni Duncan

MANAGEMENT UNIT		TIMBER SUPPLY AREA		Pulpwood Agreement	Cedeas	
Type	Number	Block	Sub-Block		East	West

EXHIBIT A
Date: March 31, 1987
Ref. Map: 92 C / NE - W1/2 - B
Base: 92 C - 066 - 067, 077
Scale: 1:20,000
Area: (4070 ac) 1647 hectares ±

Lead District: Ranfurly
Outline: _____

U.T.M. Zone	East	North	Reg	Comp.	L
10	370000	5393000			

Schedule D of M.B.
Appendix III - 'Cheewhat Lake'

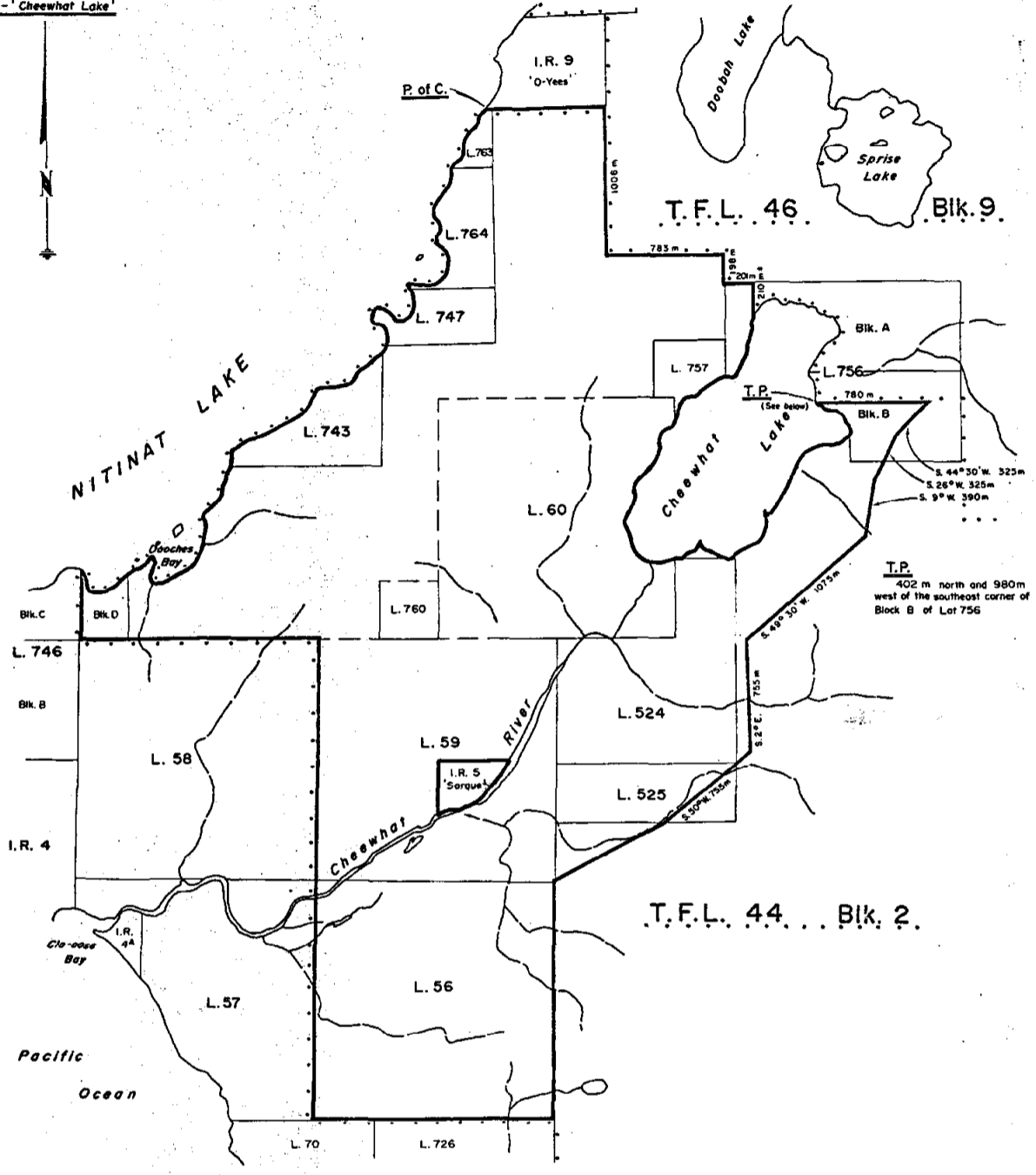

Drawn by: R.B.