

PROVINCE OF BRITISH COLUMBIA

Ministry of Forests

COPY

IN THE MATTER OF TREE FARM LICENCE NUMBER 43

INSTRUMENT NUMBER 8

BETWEEN:

THE MINISTER OF FORESTS OF BRITISH COLUMBIA on
behalf of HER MAJESTY THE QUEEN IN RIGHT OF THE
PROVINCE OF BRITISH COLUMBIA

(the "Licensor")

OF THE FIRST PART

AND:

SCOTT PAPER LIMITED
P.O. BOX 3600
VANCOUVER, BRITISH COLUMBIA

(the "Licensee")

OF THE SECOND PART

WHEREAS:

The Licensor and Licensee have entered into Tree Farm
Licence No. 43 (the "TFL"), dated January 1, 1985,
pursuant to Section 27 of the Forest Act of
British Columbia; and

The parties have mutually agreed to amend the said
Agreement pursuant to Section 33.1(e) of the Forest Act:

THIS INDENTURE WITNESSES that, in consideration of
One dollar (\$1.00) and other good and valuable
consideration paid by the Licensee to the Licensor
(the receipt and sufficiency of which the Licensor
acknowledges), the parties agree as follows:

That Schedule "B" of the said agreement be and is
hereby amended to include all those tracts of
Schedule "C" lands situated in Range, 2, Coast
Land District being more particularly shown in
hatched line on the sketch attached hereto:

Total of 220 ha+

That the parties hereto subject to the terms of this
Indenture confirm in all other respects the said Agreement
dated January 1, 1985.

This Indenture shall be binding upon the Minister and his
successors in office and the Licensee, its successors and
permitted assigns.

IN WITNESS TO THIS INDENTURE, it has been signed on behalf
of the Crown and it has been executed by the Licensee.

SIGNED, SEALED AND)
DELIVERED by the)
HONOURABLE MINISTER)
OF FORESTS, on)
behalf of the Crown,)
in the presence of:)
.....)
.....)

ORIGINAL SIGNED BY MINISTER

JUN 24 1992

Honourable Dan Miller

THE COMMON SEAL of the)
Licensee was affixed in)
the presence of:)
.....)
.....)

Dated at Victoria, British Columbia this day of 1992



Province of British Columbia
Ministry of Forests
FOREST SERVICE

EXHIBIT A

Date 91-10-23
Ref. Map 92M/SE-B (1010-020)
Base T.F.L. KEY MAP
Scale 1: 63360

Map of INSTRUMENT No. 8 TO T.F.L. No. 43

Outlined Area 220 hectares ± Forest Region 01 - VANCOUVER
U.T.M. Zone East North Reg. Compt. L District 19 - PORT MCNEILL
Grid 09698000565900050010 Land District RANGE 2 COAST

MANAGEMENT UNIT		TIMBER SUPPLY AREA		Pulpwood Agreement	Cascades	
Type	Number	Block	Sub-B		East	West
T	43					✓
3						

REMAINING SCHEDULE 'C' LAND OF TFL 43 BEING ADDED TO SCHEDULE 'B'

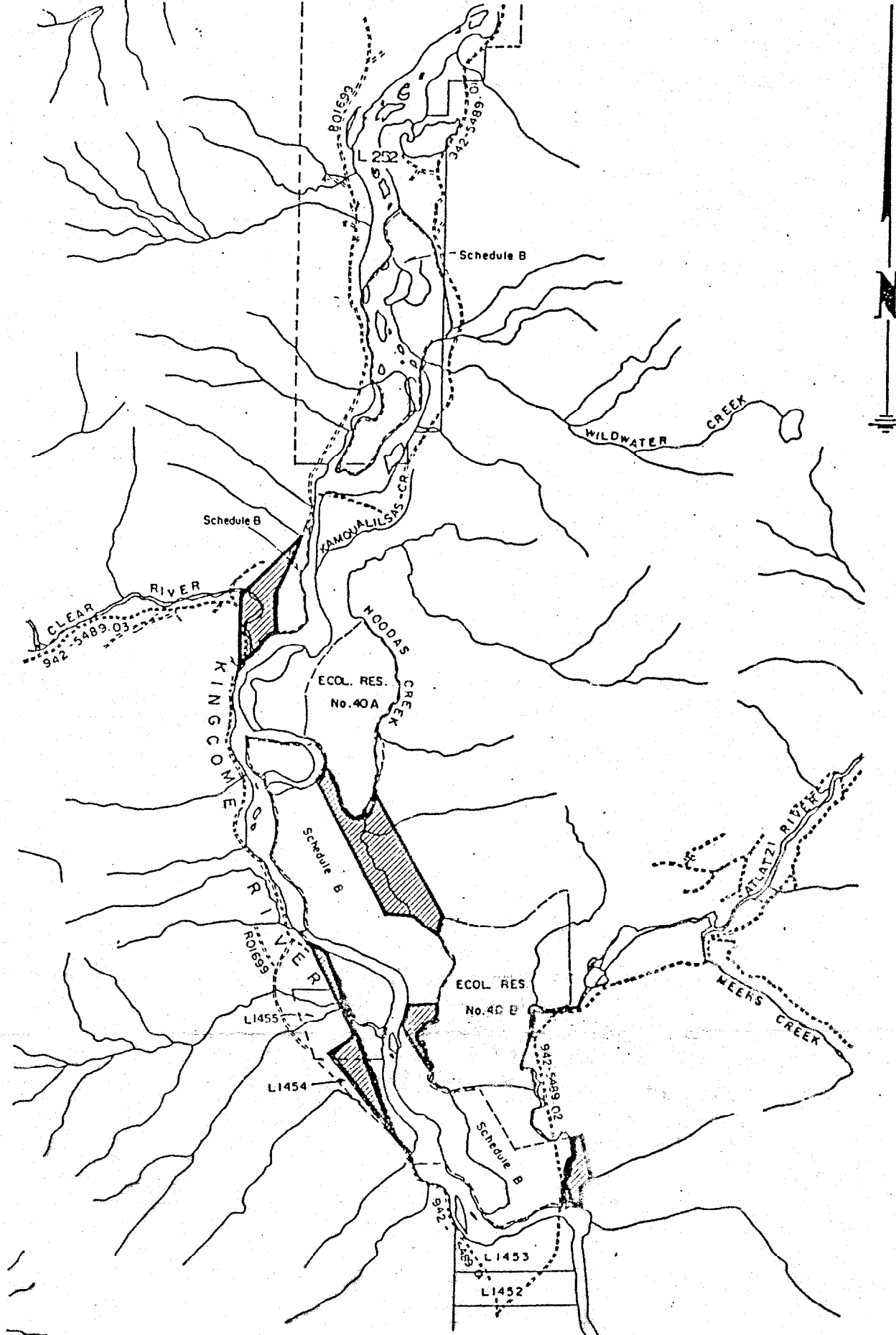

Drawn by _____