

COPY

PROVINCE OF BRITISH COLUMBIA  
Department of Lands, Forests, and Water Resources  
FOREST SERVICE

IN THE MATTER OF TREE FARM LICENCE NUMBER 41  
AMENDMENT NUMBER 2

Whereas the lands described hereinafter are within Tree Farm Licence Number 41 and are found to be more suitable for forest experimental purposes than the growing of forest crops;

And whereas the withdrawal of the aforementioned lands does not exceed the total of one percent of the licence area to the extent provided in Clause 9 of the Tree Farm Licence;

Therefore pursuant to Subsection (14) of Section 36 of the Forest Act being Chapter 153 of the Revised Statutes of British Columbia 1960, and pursuant to Clause 9 of the said Tree Farm Licence, the following lands are herewith withdrawn from the lands described in Schedule "B" of the said Tree Farm Licence; namely, all that parcel or tract of land being more particularly shown in bold black on the sketch attached hereto and described as follows:

"Those parts of Lots 6201, 6215 and 6216, Range Five Coast District, lying West of Highway 25, and that part of Lot 6200, Range Five Coast District, lying West of Department of Highways gravel pit, containing 128 acres, more or less."

and the said lands so withdrawn are and shall be henceforth no longer subject to or form any part of the said Tree Farm Licence Number 41.

Dated at the City of Victoria in the Province of British Columbia this . . . 9<sup>th</sup> . . . day of . . . AUGUST . . . , 1968.

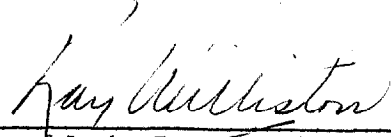
  
Minister of Lands, Forests, and Water Resources

FOREST SERVICE

Amendment No.2; T.F.L.41

R.5 Coast District

Scale:

20 chs.

= 1 inch

Outlined thus —

Area 128 Acres

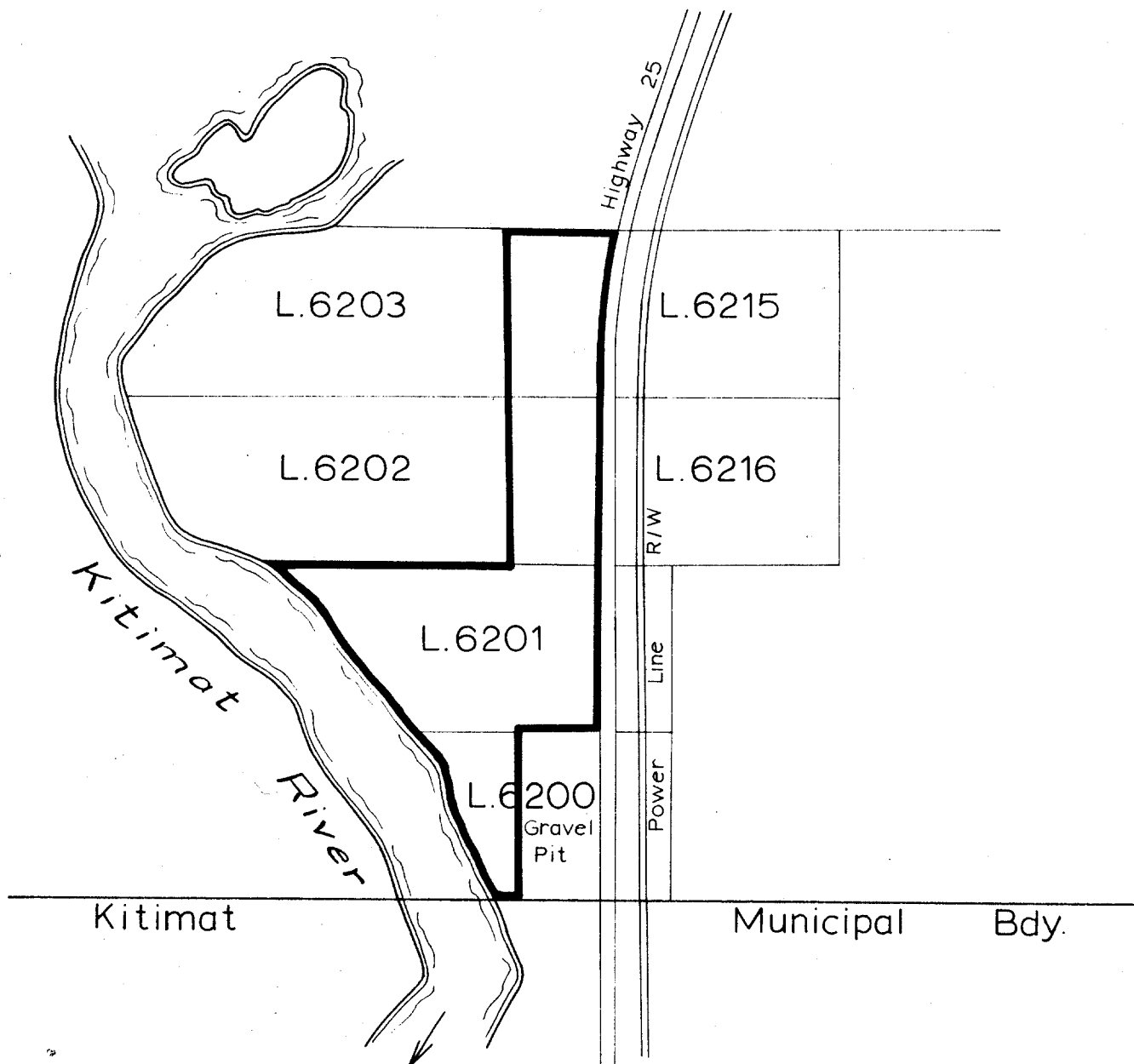

| Lot No | Field Book | Pace or hole | Date Surveyed |
|--------|------------|--------------|---------------|
|--------|------------|--------------|---------------|

Reference Map 103 I/SE (b-3) Plan File

Sketch for Made by C.P.E.S.

Department of Lands, Forests, and Water Resources.

I.S. Drafting Room, Victoria, B.C., July 23 1968