

COPY

PROVINCE OF BRITISH COLUMBIA

Ministry of Forests

---

IN THE MATTER OF TREE FARM LICENCE NUMBER 39

INSTRUMENT NUMBER 129

Amendment

---

Whereas the lands described hereinafter are within Tree Farm Licence Number 39 and are found to be suitable for a higher economic use than the growing of forest crops;

And whereas the withdrawal of the aforementioned lands together with any lands previously withdrawn does not diminish the productive capacity of the licence area beyond the statutory limits;

Therefore pursuant to Section 53(1)(b)(ii) of the Forest Act, the following lands are herewith withdrawn from the lands described in Schedule "B" of the said Tree Farm Licence Number 39; namely, all that parcel or tract of land described in Schedule "A", and shown in bold black on the plan attached hereto; and the said lands so withdrawn are and shall be henceforth no longer subject to or form any part of the said Tree Farm Licence Number 39.

Dated at the City of Victoria in the Province of British Columbia this . . 18<sup>th</sup> . . day of . . August . . . . . , 1983.

  
Minister of Forests

SCHEDULE A

TREE FARM LICENCE NUMBER 39

Commencing at a point on the high-water mark of Powell Lake on the easterly shore thereof, said point being 260 metres north and 380 metres west of the most northerly northwest corner of Lot 7073 Group 1 New Westminster Land District; thence north 45 degrees east 540 metres; thence south 45 degrees east 620 metres, more or less, to the high-water mark of an unnamed creek on the right bank thereof, said unnamed creek flowing into Haywire Bay at a point 160 metres north and 330 metres east of the most northerly northwest corner of said Lot 7073; thence in a general southwesterly direction along the high-water mark of said unnamed creek on the right bank thereof, to the high-water mark of said Haywire Bay on the northerly shore thereof; thence in a general westerly direction along the high-water mark of said Haywire Bay on the northerly shore thereof to the high-water mark of aforesaid Powell Lake on the easterly shore thereof; thence in a general northerly direction along the high-water mark of said Powell Lake on the easterly shore thereof, to the point of commencement.



Province of British Columbia  
 Ministry of Forests  
 FOREST SERVICE

Date August 5, 1983  
 Ref. Map 92 F/15(h)  
 Base 92 F 088 & 098  
 Scale 1 : 20 000

Map Of **Instrument No.129 to Tree Farm Licence No.39 ( Deletion )**

Outlined Area 24,600 hectares ± Forest Region 01 Vancouver

U.T.M. Grid  

Zone	East					North					Reg.	Compt.	L						
1	0	3	9	1	0	0	0	5	5	2	9	0	0	0	2	9	0	2	4

 District 15 Powell River  
 Land District New Westminster

MANAGEMENT UNIT		TIMBER SUPPLY AREA		Pulpwood Agreement	Cascades	
Type	T	Number	28			East
Number	39	Block	47	West		/
Block	I	Sub-B				

( Proposed Haywire Bay Park Site )

PofC. - 260m north and 380m west of the most northerly northwest corner of L.7073.

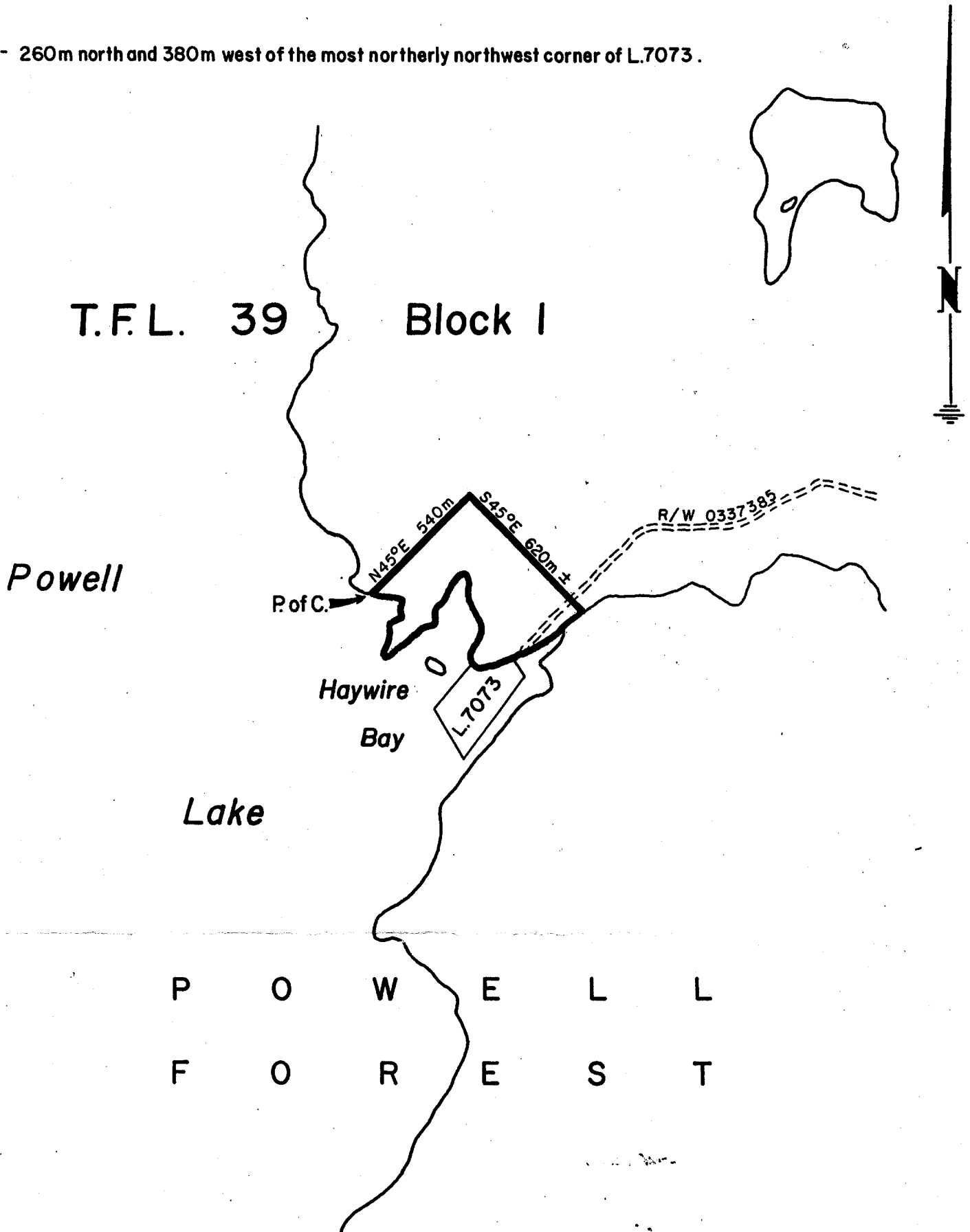

P O W E L L  
 F O R E S T