

COPY

PROVINCE OF BRITISH COLUMBIA

Ministry of Forests

IN THE MATTER OF TREE FARM LICENCE NUMBER 39

INSTRUMENT NUMBER 128

Amendment

Whereas the lands described hereinafter are within Tree Farm Licence Number 39 and are found to be suitable for a higher economic use than the growing of forest crops;

And whereas the Licensee has requested the withdrawal of the aforementioned lands from Schedule "A" of the said Tree Farm Licence;

Therefore pursuant to clause 1.04(a) of the said Tree Farm Licence, the following lands are herewith withdrawn from the lands described in Schedule "A" of the said Tree Farm Licence Number 39; namely, those parcels or tracts of land being more particularly shown in bold black on the plan attached hereto and described as follows:

"That portion of Block 3 of Lot 3009, New Westminster Land District, Plan 4797, shown in bold black on the attached plan and containing 0.1196 ha",

and the said lands so withdrawn are and shall be henceforth no longer part of or subject to the said Tree-farm Licence Number 39.

Dated at the City of Victoria in the Province of British Columbia this . . . 11th . . . day of July , 1983.

Minister of Forests



Province of British Columbia
Ministry of Forests
FOREST SERVICE

EXHIBIT A

Date JUNE 9, 1983
Ref. Map 92F/NE
Base 92F/16W
Scale 1 : 31,680

Map Of INSTRUMENT NO. 128 DELETION FROM TREE FARM LICENCE 39

Outlined Area .1196 hectares ± Forest Region VANCOUVER

U.T.M. Zone	East	North	Reg.	Compt.	L	District
10407900055140000			290060			POWELL RIVER
Grid						Land District
						NEW WESTMINSTER

MANAGEMENT UNIT		TIMBER SUPPLY AREA		Pulpwood Agreement	Cascades	
Type	Number	Block			East	West
						✓

POWELL FOREST

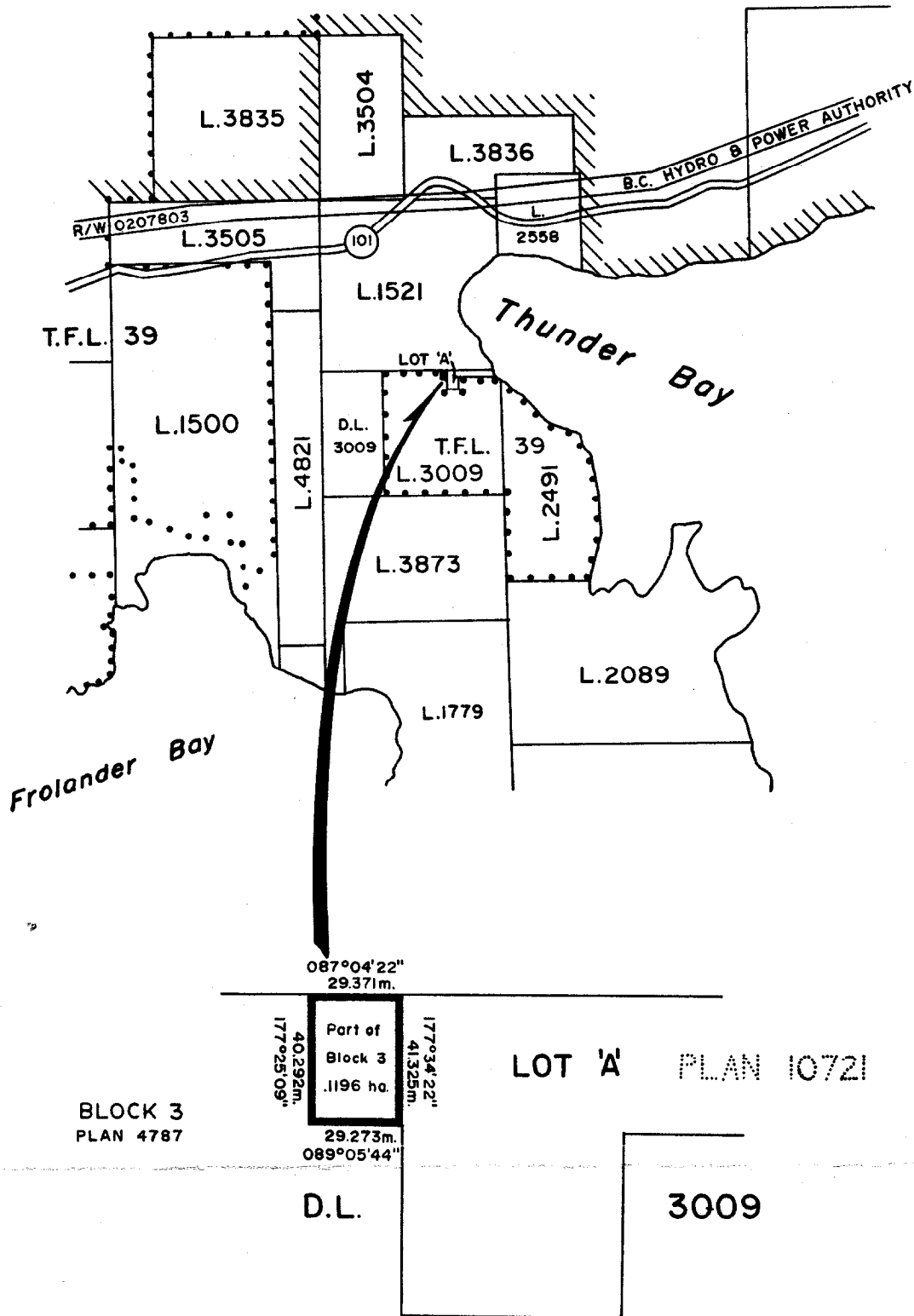

Blow-up Scale 1:2000