

COPY

PROVINCE OF BRITISH COLUMBIA

Ministry of Forests

IN THE MATTER OF TREE FARM LICENCE NUMBER 39

INSTRUMENT NUMBER 126

Amendment

Whereas the lands described hereinafter are within Tree Farm Licence Number 39 and are found to be suitable for a higher economic use than the growing of forest crops;

And whereas the withdrawal of the aforementioned lands together with any lands previously withdrawn does not diminish the productive capacity of the licence area beyond the statutory limits;

Therefore pursuant to section 53 (1)(b)(i) of the Forest Act, the following lands are herewith withdrawn from the lands described in Schedule "B" of the said Tree Farm Licence Number 39; namely, all that parcel or tract of land being more particularly shown in bold black on the plan attached hereto, and the said lands so withdrawn are and shall be henceforth no longer subject to or form any part of the said Tree Farm Licence Number 39.

Dated at the City of Victoria in the Province of British Columbia this . . . 14th . . . day of March, 1983.

Minister of Forests



Province of British Columbia
Ministry of Forests
Forest Service

Map of Instrument No. 126 to Tree Farm Licence 39

EXHIBIT A

Date..... February 22, 1983
Ref. Map..... 92L/11E, 10W
Base..... 92L-11-a
Scale 1:..... as shown
Area..... 227..... hectares ±

MANAGEMENT UNIT		TIMBER SUPPLY AREA		Pulpwood Agreement	Cascades	
Type	OT	Number	01			East
Number		Block			West	✓
Block		Sub-B				

Forest Region VANCOUVER
District

Land District RUPERT
Outline

U.T.M. Zone	East	North	Reg	Compt.	L
Grid					

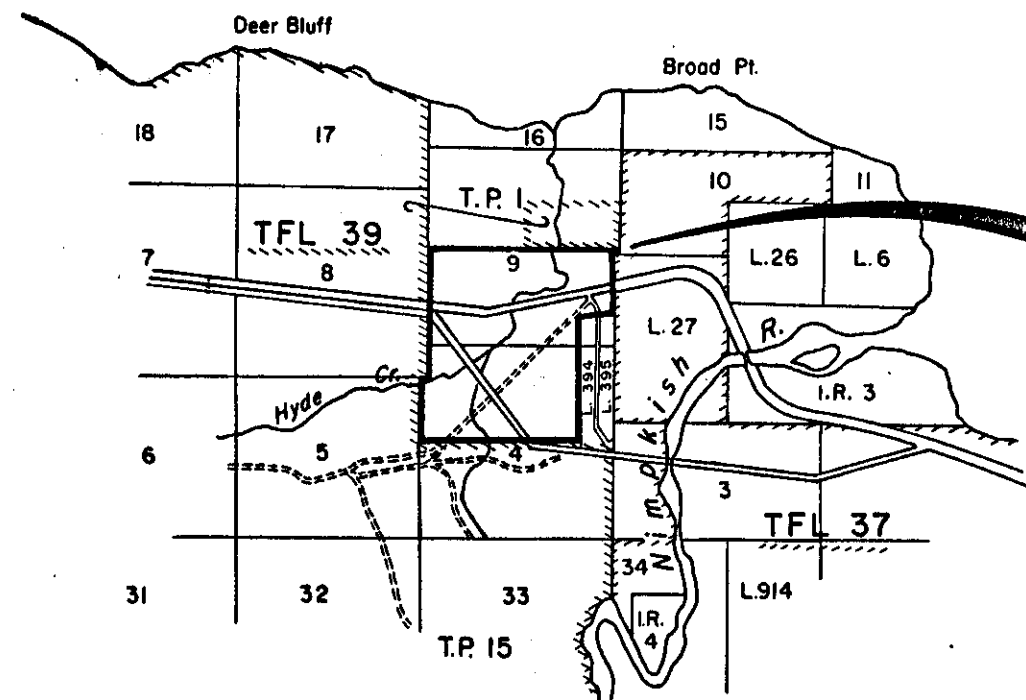
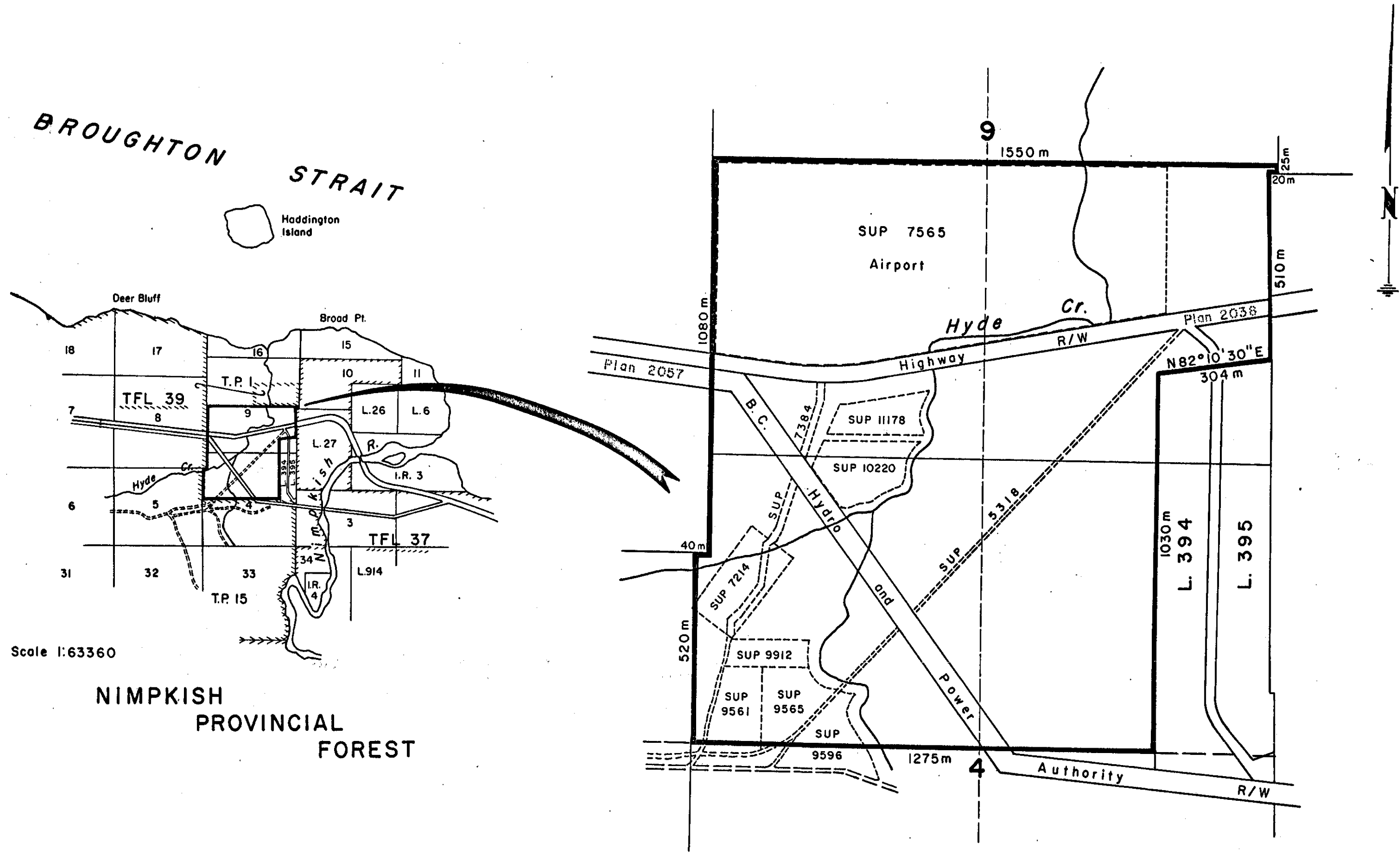

Scale 1:63360

Scale 1:10000