

PROVINCE OF BRITISH COLUMBIA

Ministry of Forests

IN THE MATTER OF TREE FARM LICENCE NUMBER 39

INSTRUMENT NUMBER 120

Amendment

COPY

Whereas the lands described hereinafter are within Tree Farm Licence Number 39 and are found to be suitable for a higher economic use than the growing of forest crops;

And whereas the Licensee has requested the withdrawal of the aforementioned lands from Schedule "A" of the said Tree Farm Licence;

Therefore pursuant to clause 1.04(a) of the said Tree Farm Licence, the following lands are herewith withdrawn from the lands described in Schedule "A" of the said Tree Farm Licence Number 39; namely, those parcels or tracts of land being more particularly shown in bold black on the plan attached hereto and described as follows:

"All that portion of the Fractional East Half of Section 18, Township 1, Rupert Land District, which may be more particularly described as follows:

Commencing at the southwesterly corner of the said Fractional East Half; thence northerly following the westerly boundary of the said Fractional East Half a distance of 175.752 metres more or less to the southeasterly limit of Mine Road, as the said road is shown on Plan 31167; thence northeasterly following the said southeasterly limits of said road a distance of 211.361 metres to a point; thence on a bearing of 181° 05' 05" a distance of 281.507 metres more or less to an intersection with the southerly boundary of the said Fractional East Half; thence westerly following the southerly boundary of the said Fractional East Half a distance 183.000 metres more or less to the point of commencement, the whole containing by admeasurement 4.184 hectares, be the same more or less",

and the said lands so withdrawn are and shall be henceforth no longer part of or subject to the said Tree Farm Licence Number 39.

Dated at the City of Victoria in the Province of British Columbia this 26th day of February , 1981.

Minister of Forests

Map Of **REMOVAL FROM TREE FARM LICENCE No 39 INSTRUMENT No 120**

Outlined Area 4.184 hectares ± Forest Region 01 Vancouver

U.T.M. Grid

Zone	East			North			Reg.	Compt.	L									
9	6	3	5	0	0	0	5	6	0	5	0	0	0	0	2	0	0	1

 District 15
Land District Rupert

MANAGEMENT UNIT		TIMBER SUPPLY AREA		Pulpwood Agreement	Cascades	
Type	T	Number	KINGCOME			East
Number	39	Block		West		✓
Block		Sub-B				

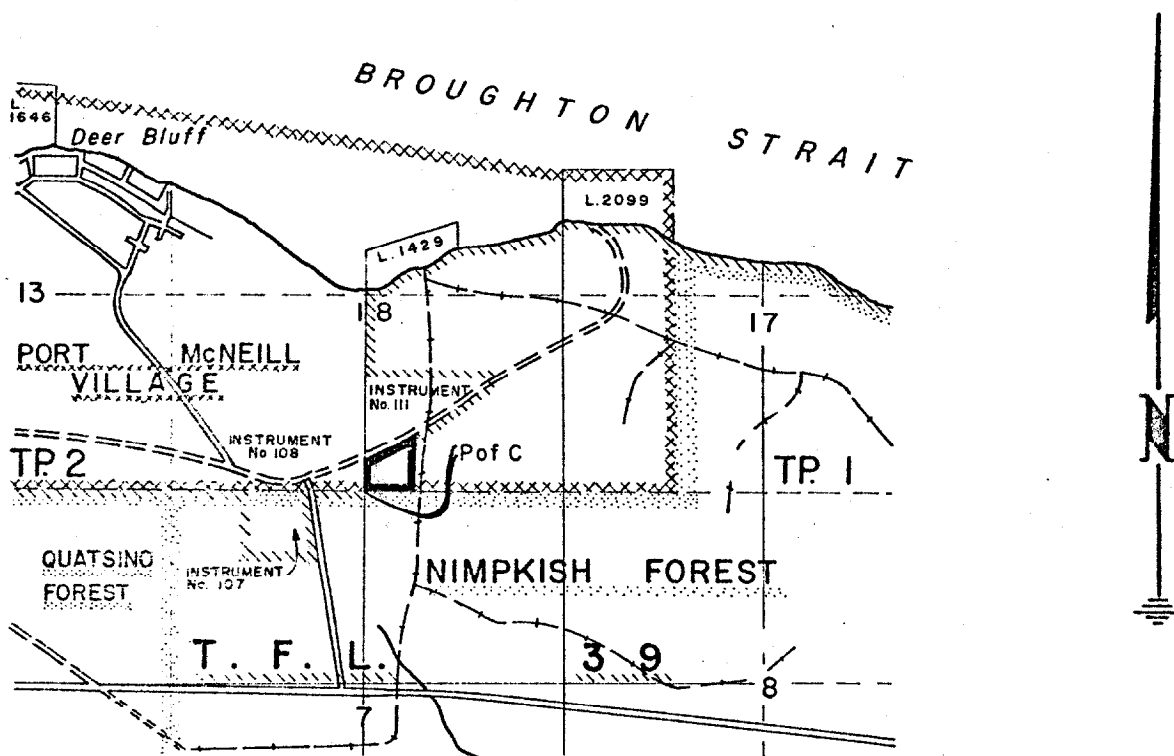

Scale : 1 : 15 840

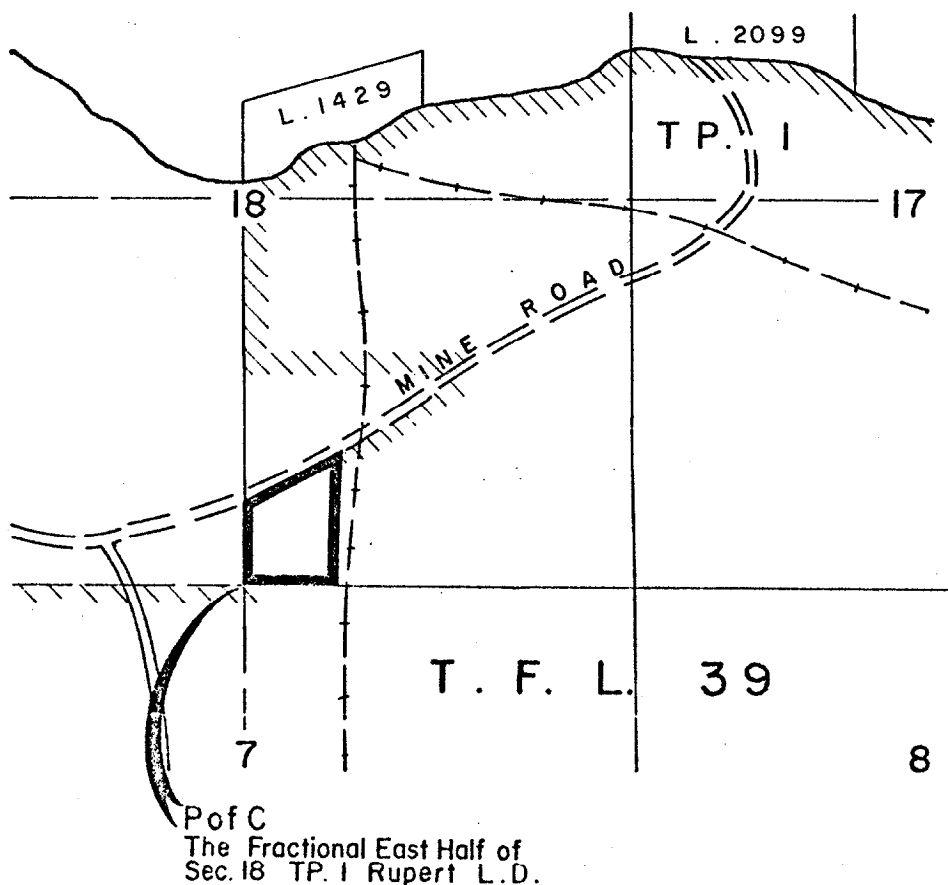

Pof C
The Fractional East Half of
Sec. 18 TP. 1 Rupert L.D.