

COPY

PROVINCE OF BRITISH COLUMBIA

Ministry of Forests

---

IN THE MATTER OF TREE FARM LICENCE NUMBER 39

INSTRUMENT NUMBER 113

Amendment

---

Whereas the lands described hereinafter are within Tree Farm Licence Number 39 and are found to be suitable for a higher economic use than the growing of forest crops;

And whereas the withdrawal of the aforementioned lands together with any lands previously withdrawn does not diminish the productive capacity of the licence area to the extent provided in Clause 11 of the Tree Farm Licence;

Therefore pursuant to subsection (14) of Section 36 of the Ministry of Forests Act being Chapter 153 of the Revised Statutes of British Columbia, 1960 and pursuant to Clause 11 and 12 of the said Tree Farm Licence the following lands are herewith withdrawn from the lands described in Schedule "B" of the said Tree Farm Licence Number 39; namely, all that parcel or tract of land being more particularly shown in bold black on the sketch attached hereto.

The said lands so withdrawn are and shall be henceforth no longer subject to or form any part of the said Tree Farm Licence Number 39.

Dated at the City of Victoria in the Province of British Columbia this . . . . . 21 . . . . . day of . . . Sept. . . . . , 1978.

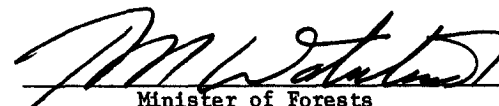
  
Minister of Forests

LAND DISTRICT RUPERT  
 Region No. 2 Compt. No. 1  
 Base ATLAS 92L/10-W, 11-E  
 SUDIVISION PLAN



Province of British Columbia  
 Ministry of Forests  
 FOREST SERVICE

EXHIBIT A  
 Date SEPTEMBER 14, 1978  
 Atlas Ref. 92L/11-E (a)

INSTRUMENT NO. 113 TO TREE FARM LICENCE 39

Shown \_\_\_\_\_ Area± 3.2 HA. R.D. 15 Scale as shown



Scale: 1 to 5000

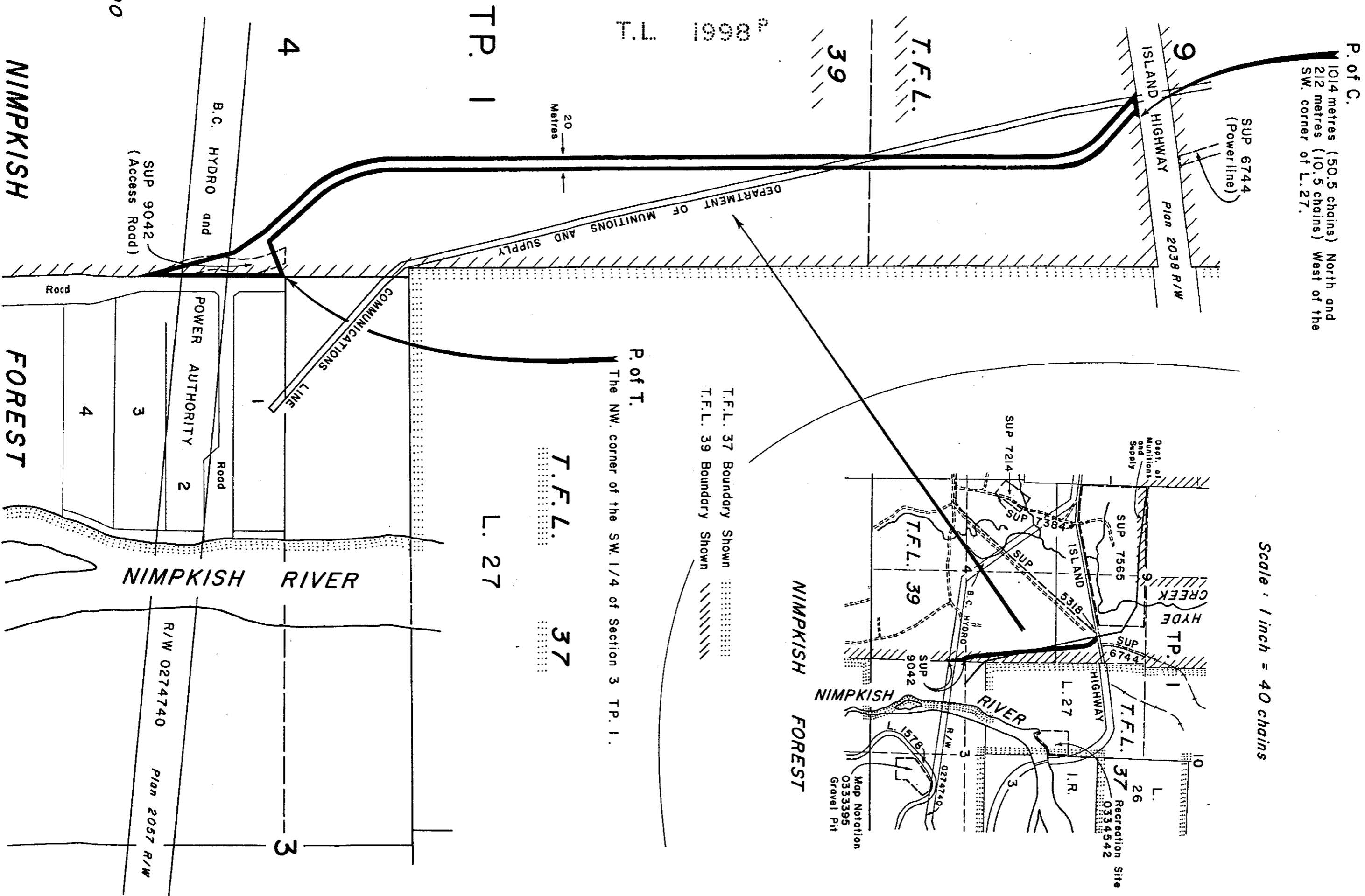

P. of C.  
 1014 metres (50.5 chains) North and  
 212 metres (10.5 chains) West of the  
 SW. corner of L. 27.

T.F.L. 37 Boundary Shown  
 T.F.L. 39 Boundary Shown

P. of T.  
 The NW. corner of the SW. 1/4 of Section 3 TP. 1.

T.F.L. 37

L. 27

NIMPKISH FOREST

Scale: 1 inch = 40 chains

