

PROVINCE OF BRITISH COLUMBIA

Department of Lands, Forests, and Water Resources

FOREST SERVICE

IN THE MATTER OF TREE FARM LICENCE NUMBER 39

INSTRUMENT NUMBER 107

AMENDMENT

Whereas by a notice in writing dated the 23rd day of September, 1968, and designated Amendment Number 77 in the matter of Tree Farm Licence Number 39, part of the lands hereinafter described were withdrawn from the said Tree Farm Licence, and;

Whereas it has now been found that additional lands are required and Amendment Number 77 is hereby cancelled;

Whereas the lands described hereinafter are within Tree Farm Licence Number 39 and are found to be suitable for a higher economic use than the growing of forest crops;

And whereas the withdrawal of the aforementioned lands together with any lands previously withdrawn does not diminish the productive capacity of the licence area to the extent provided in Clause 11 of the Tree Farm Licence;

Therefore pursuant to Subsection (14) of Section 36 of the "Forest Act" being Chapter 153 of the Revised Statutes of British Columbia, 1960, and pursuant to Clause 11 of the said Tree Farm Licence the following lands are herewith withdrawn from the lands described in Schedule "B" of the said Tree Farm Licence; namely, all that parcel or tract of land being more particularly shown in bold black on the sketch attached hereto and described as follows:

"Commencing at a point 995 feet East of the North West Corner of Section 7, Township 1, Rupert Land District, thence South 985 feet, thence East 995 feet, thence North Westerly along Port McNeill access road 1,000 feet, thence West 845 feet to point of commencement, containing 21 acres more or less."

and the said lands so withdrawn are and shall be henceforth no longer subject to or from any part of the said Tree Farm Licence Number 39.

Dated at the City of Victoria in the Province of British Columbia
this 13th day of . . . June , 1974.

Signed "RW"
Minister of Lands, Forests, and Water Resources

DISTRICT Rupert
Region No. Compt. No.
Case 92-L-11E, BCHydro + PA

BRITISH COLUMBIA
FOREST SERVICE

EXHIBIT A
Date May 9 1974
Atlas Ref. 92-L-11a

Instrument No. 107 to TFL 39

Acres 21 R.D. 15 Scale 40 chs = 1 inch

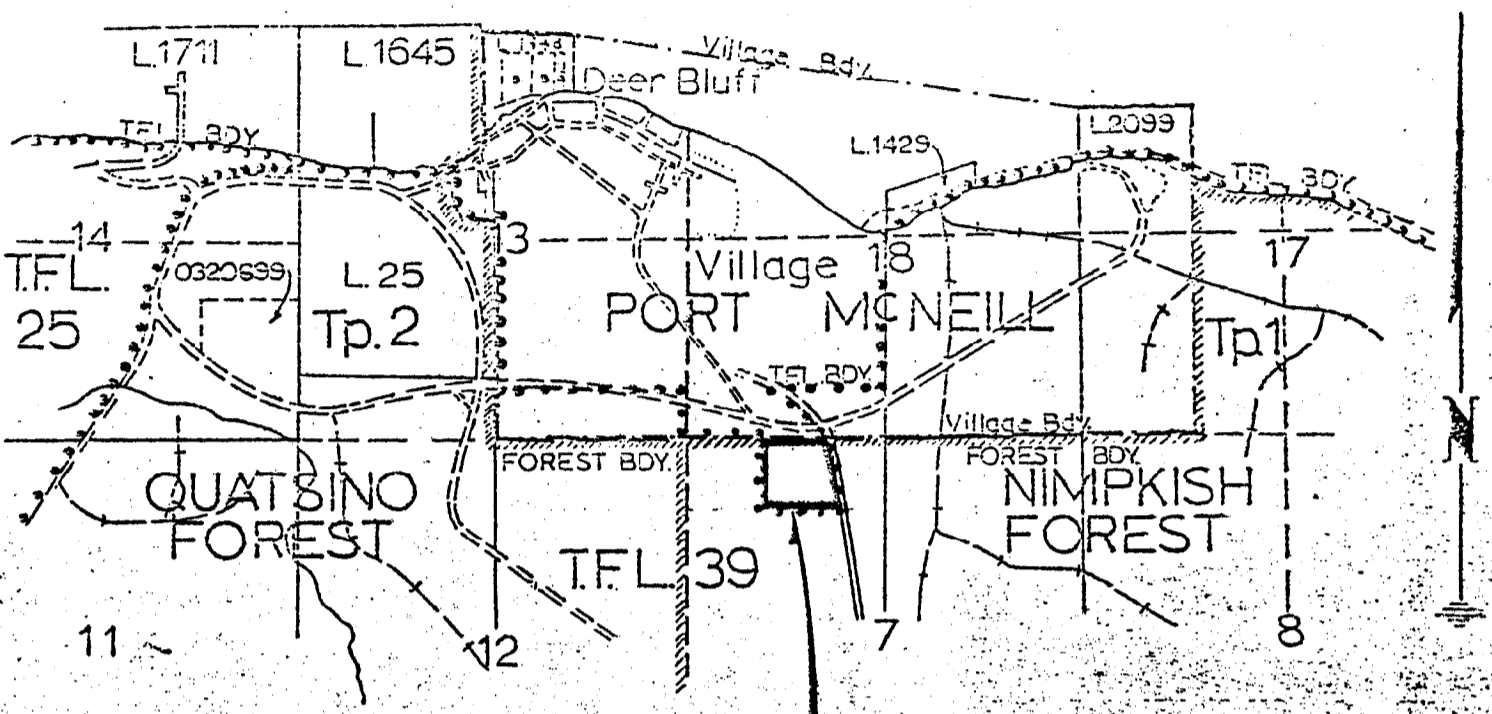

P of C. 995 ft. (15.1 ch.) E. of
NW cor. of Sec. 7. Tp. 1

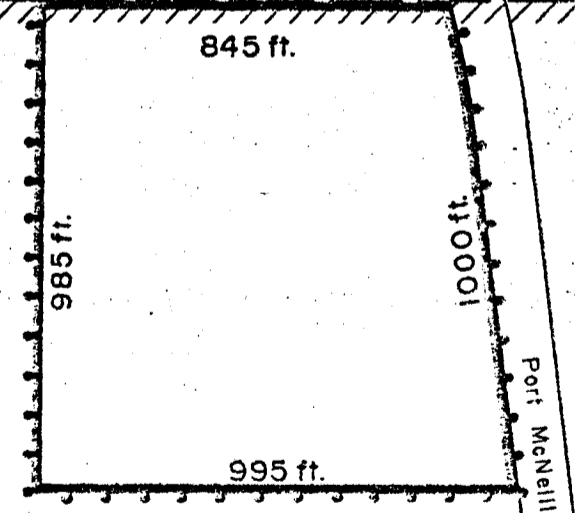

TFL 39

Tp. 1 Sec. 7

Inset Scale 400 ft = lin.

Drawn by G. Enquist