

PROVINCE OF BRITISH COLUMBIA
Department of Lands, Forests, and Water Resources
FOREST SERVICE

IN THE MATTER OF TREE FARM LICENCE NUMBER 39
AMENDMENT NUMBER 90

Whereas the lands described hereinafter are within Tree Farm Licence Number 39 and are found to be suitable for a higher economic use than the growing of forest crops;

And whereas the Licensee has agreed to the withdrawal of those parts of the lands which are included in Schedule "A" of the Tree Farm Licence;

Therefore pursuant to Subsection (14) of Section 36 of the "Forest Act" being Chapter 153 of the Revised Statutes of British Columbia, 1960 and Clause 14 of the said Tree Farm Licence, the Licensor hereby consents to the withdrawal from Schedule "A" of the said Tree Farm Licence of the following lands:

"Commencing at a point 23 chains south and 24 chains west of the northeast corner of Timber Licence 1978p, Rupert Land District; thence south 5 chains; thence west 5 chains to the point of commencement, containing 2.5 acres more or less."

as shown in bold black on the sketch attached hereto and the lands so withdrawn from Schedule "A" are and shall be henceforth no longer part of or subject to the said Tree Farm Licence Number 39 during the term of Special Use Permit 6746 issued in respect of the aforementioned area.

Dated at the City of Victoria in the Province of British Columbia this^{12th}..... day of^{January}....., 1971.

*Document
noted*

signed "Ray Williston"

Minister of Lands, Forests, and Water Resources

LAND DISTRICT **RUPERT**
Region No. **1** Compt. No. **15^B**
Base **92 L/11 W**



EXHIBIT A
Date **4/1/71**
Atlas Ref. **92 L/NW (a-9)**

Amendment N° 90 to T.F.L. 39

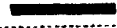
Shown  Acres ± **2.5** R.D. **15** Scale **20 chains = 1 inch**

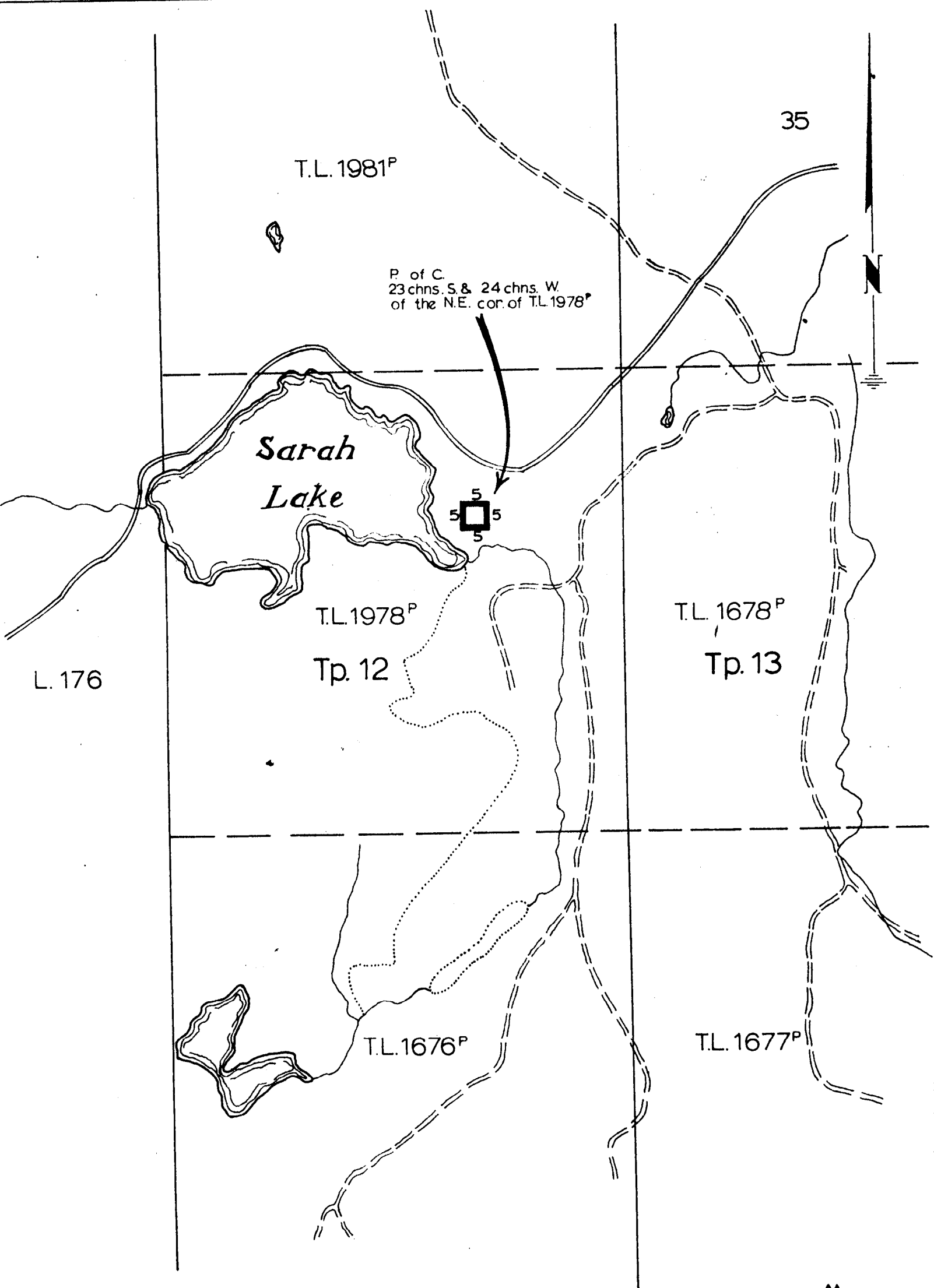

Drawn by **AA**