

PROVINCE OF BRITISH COLUMBIA
Department of Lands, Forests, and Water Resources
FOREST SERVICE

IN THE MATTER OF TREE FARM LICENCE NUMBER 39
AMENDMENT NUMBER 84

Whereas the lands described hereinafter are within Tree Farm Licence Number 39 and are found to be suitable for a higher economic use than the growing of forest crops;

And whereas the withdrawal of the aforementioned lands together with any lands previously withdrawn does not diminish the productive capacity of the licence area to the extent provided in Clause 11 of the Tree Farm Licence;

Therefore pursuant to subsection (14) of Section 36 of the *Forest Act* being Chapter 153 of the Revised Statutes of British Columbia, 1960 and pursuant to Clause 11 of the said Tree Farm Licence the following lands are herewith withdrawn from the lands described in Schedule "B" of the said Tree Farm Licence Number 39; namely, all that parcel or tract of land being more particularly shown in bold black on the sketch attached hereto and described as follows:

"Commencing at a point 6 chains East of the Northwest corner of Timber Licence 2362P; thence 4 chains North 34° West; thence 15 chains North 56° East; thence 4 chains South 34° East; thence 15 chains South 56° West to point of commencement, containing 6 acres, more or less, Rupert Land District."

and the said lands so withdrawn are and shall be henceforth no longer subject to or form any part of the said Tree Farm Licence Number 39 during the term of Special Use Permit Number 6569, issued in respect of the aforementioned area.

Dated at the City of Victoria in the Province of British Columbia
this 21st day of April , 1970.

Sup

signed "Ray Williston"

Minister of Lands, Forests, and Water Resources

W of Nimpkish River

SUP APP 6569

Shown Acres± P.S.Y.U. Photos Scale 20 Chs. 1 inch

AMENDMENT NO 84 TO T.F.L. 39

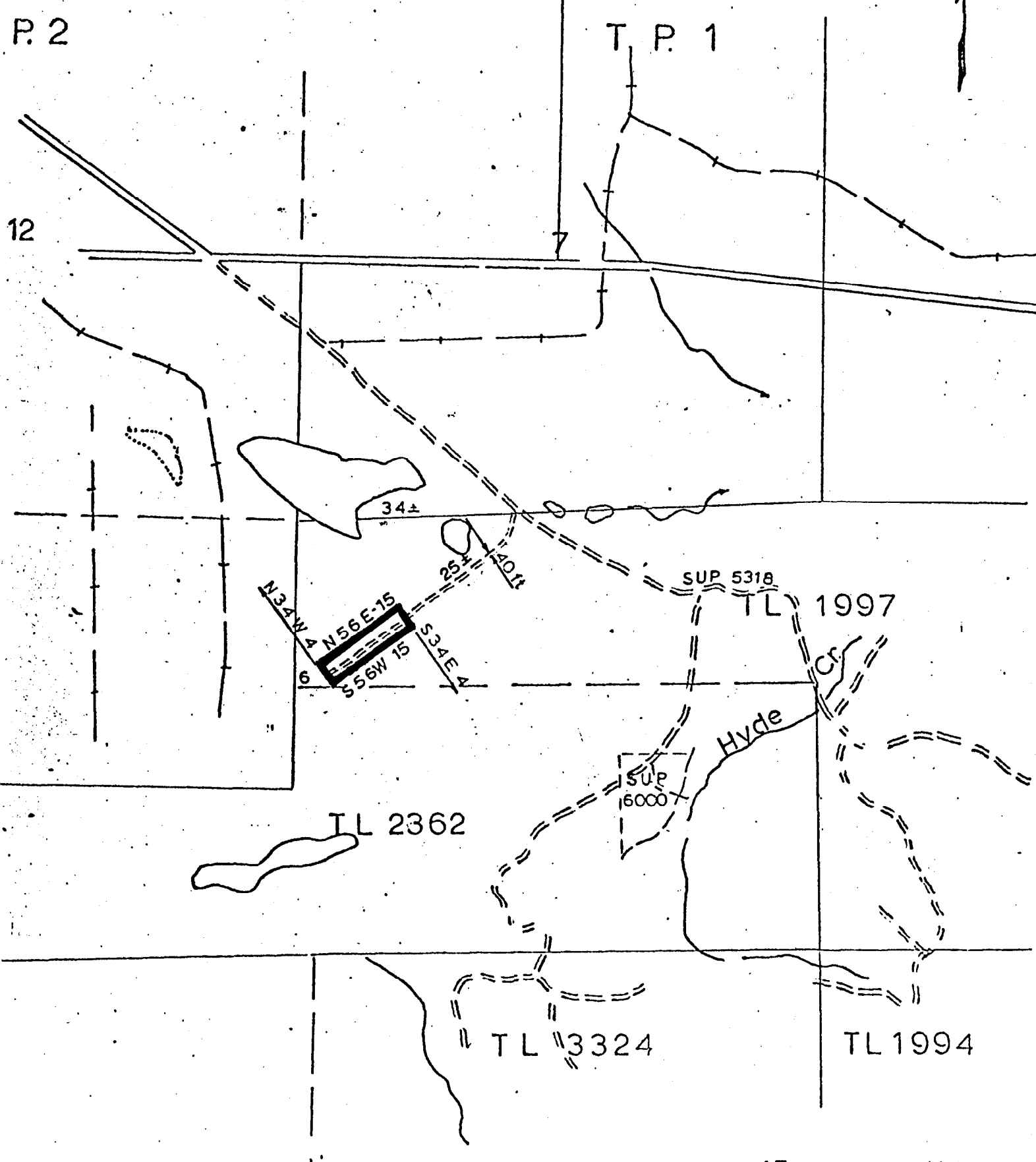

R.D. 15 Drawn by HM

Highway	Corner Flag	Blowdown	Mature (scattered)
Road	Iron Pin	Meadow	Immature
Skid Road	Post	Burn	Non Commercial Cover
Powerline	Bearing Tree	Scrub	Non Productive
Swamp	Cruise Plot	Swamp	Not Satisfactorily Restocked
Railway	Slope	Alder	Seed Blocks
Surveyed Line	Paint Line	Rock	Reserve Strip
Unsurveyed Line	Millsite	Height of Land	Single Seed Trees
15 Day Easement	Old Millsite	Type Line	Eliminated Area
			Approved For Logging
			Landing
			Felled & Bucked
			Sags
			Timber Type Description
			Type I
			Type II
			Type III