

PROVINCE OF BRITISH COLUMBIA
Department of Lands, Forests, and Water Resources
FOREST SERVICE

IN THE MATTER OF TREE FARM LICENCE NUMBER 39
AMENDMENT NUMBER 55

THIS AGREEMENT made in duplicate this^{9th}.....
day of September..... in the year of Our Lord one thousand nine
hundred and sixty-five,

BETWEEN;

THE MINISTER OF LANDS, FORESTS, AND WATER RESOURCES,
of the Province of British Columbia, who, with his
successors in office, is

hereinafter called "the Minister",

OF THE ONE PART

AND

MACMILLAN, BLOEDEL & POWELL RIVER LIMITED, a Corporation
duly incorporated under the laws of the Province of British
Columbia, and having its registered office in the City of
Vancouver, in the said Province,

hereinafter called "the Licensee",

OF THE OTHER PART.

WHEREAS by an Agreement dated the 27th day of October, 1961
the Minister did grant unto the Licensee a Tree Farm Licence which is
known and referred to as the "Haida Tree Farm Licence" and is numbered
thirty-nine (39) in the Forest Service register of Tree Farm Licences
and on the official atlas maps of the Department of Lands, Forests, and
Water Resources;

WHEREAS pursuant to Clause 49 of the said Tree Farm Licence
the said Indenture may be amended and the parties hereto have mutually
agreed to amend the said Indenture as hereinafter set forth;

AND WHEREAS it is desirable to amend Special Use Permit Number
3746 to accomodate a small change in the location of the logging road
right-of-way covered by the said Special Use Permit;

NOW THEREFORE THIS AGREEMENT WITNESSETH THAT in consideration of the premises and the sum of One Dollar (\$1.00) of lawful money of Canada now paid by the Licensee to the Minister, receipt whereof is hereby acknowledged, the parties hereto agree as follows:

(1) That the lands covered by Special Use Permit Number 3746 dated the 14th of April 1960 and being more particularly shown coloured green on sketch map number 1 attached hereto and described as follows:

"A logging road right-of-way, 40 feet in width, commencing at a point on the highwater mark of Powell Lake on the east shore of Goat Island, said point being 55 chains east more or less and 6 chains north more or less from an internal angle of Lot 2238 (T.L. 14150L), New Westminster District, said internal angle being 69.39 chains north and 40 chains east from the intersection of the most westerly boundary of said Lot 2238 with the highwater mark of Powell Lake on the south shore of Goat Island; thence in a general northwesterly direction 75 chains more or less to the most easterly boundary of Timber Sale X73531; together with the logging road right-of-way branching in a general northwesterly direction 75 chains more or less to the most southerly boundary of Timber Sale X73531 within the aforesaid Lot 2238."

are herewith incorporated in Block 1 of Schedule "B" of the said Tree Farm Licence Number 39 and subject as provided in (2) below the lands so incorporated are and shall be henceforth part of and subject to the said Tree Farm Licence.

(2) That the lands described hereinafter and being more particularly coloured red on sketch map number 2 attached hereto and being a part of the lands described in (1) above are herewith withdrawn from Block 1 of Schedule "B" of the said Tree Farm Licence for the purpose of a right-of-way under Part VI of the Forest Act for the period necessary for the removal of forest products from Timber Sale X73531 or any extension or resale thereof; namely,

"A logging road right-of-way, 40 feet in width, commencing at the point on the highwater mark of Powell Lake on the east shore of Goat Island described in (1) above; thence in a general northwesterly direction 78 chains more or less to the most easterly boundary of Timber Sale X73531; together with the logging road right-of-way branching in a general northwesterly direction 75 chains more or less to the most southerly boundary of Timber Sale X73531 within Lot 2238 (T.L. 14150L), New Westminster District."

and the lands so withdrawn are and shall be henceforth no longer part of or subject to the said Tree Farm Licence Number 39 during the lifetime of the amended Special Use Permit 3746 issued in respect of the aforescribed logging right-of-way.

(3) That subject to the terms of this Agreement the parties hereto confirm in all other respects the said Agreement dated the 27th day of October 1961 and amendments thereto.

IN WITNESS WHEREOF the Minister has executed these presents and the Licensee has hereunto affixed its corporate seal by the hands of its proper officers in that behalf.

SIGNED SEALED AND DELIVERED
in the presence of:

Charles Chalk
Witness

Roy Wilton
Minister of Lands, Forests, and Water Resources

THE CORPORATE SEAL OF THE LICENSEE
was hereunto affixed in the
presence of:

[Signature]

[Signature]

MAP OF S.U.P. 3746

Situated on Goat Island
LAND DISTRICT NEW WESTMINSTER

Area outlined in red.....Acres.±

Atlas Ref. R92 K/SE (a.4)

Inventory R. No.....C. No.....

SCALE.....10 Chains = 1 inch.

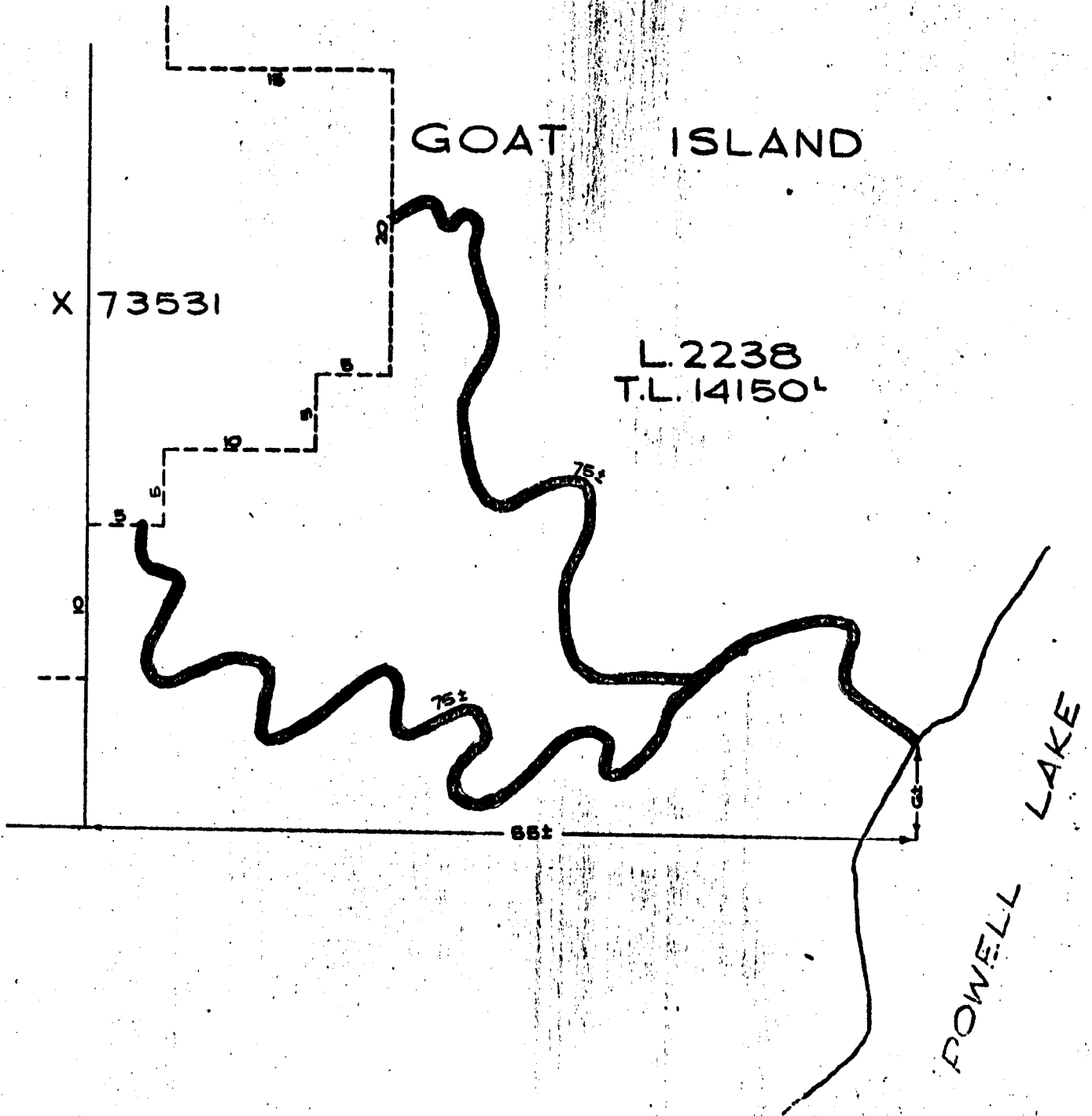

AMENDMENT NO. 55

MAP OF S.U.P. 3746

Situated on Goat Island
LAND DISTRICT. NEW WESTMINSTER

Atlas Ref. R92 K/SE (a.4)

Inventory R. No. 29 C. No. 15

SCALE 10 Chains = 1 inch.

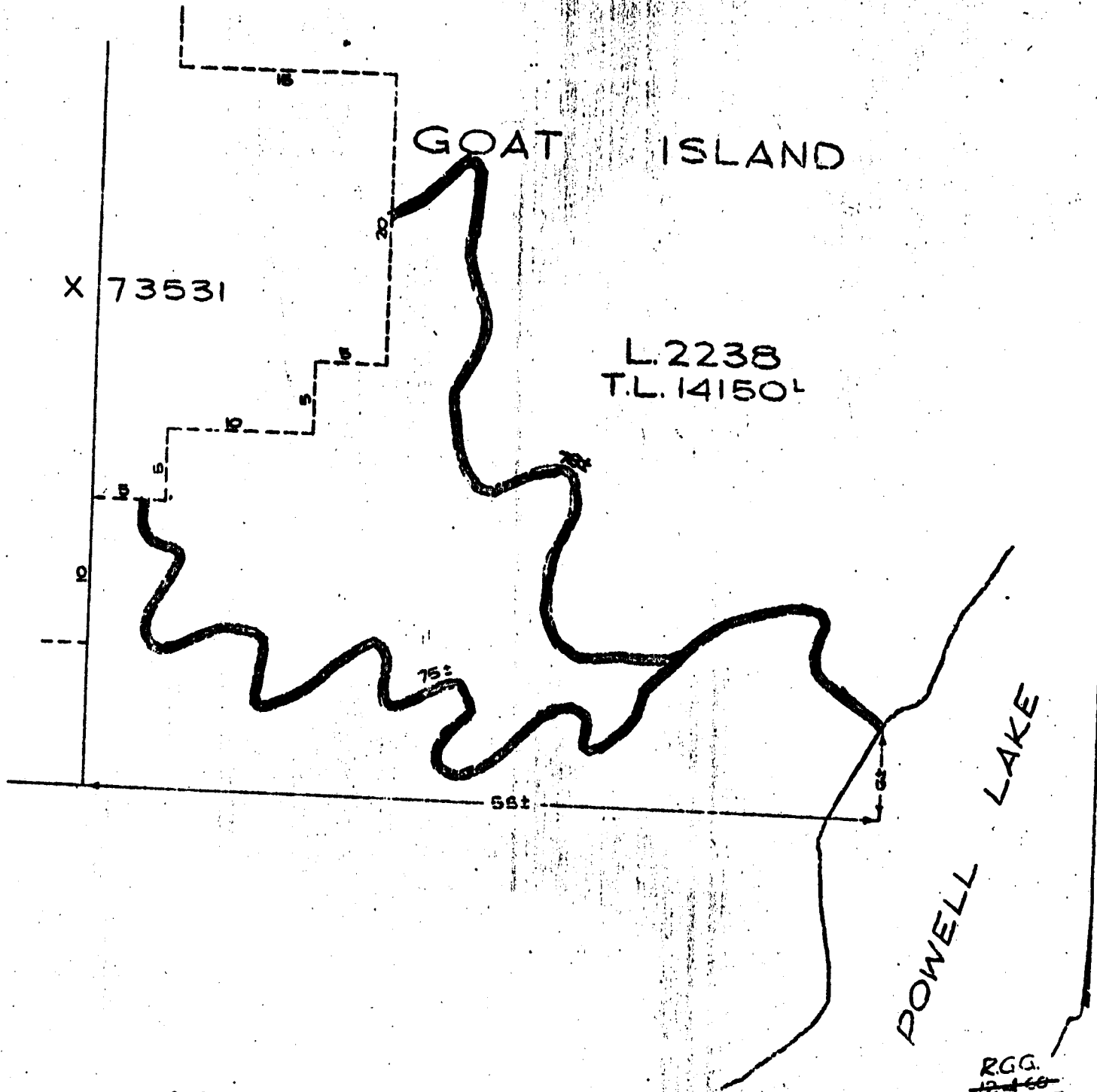

AMENDMENT NO. 55

T.F.L. NO. 39

R.G.G.
12-1-60
Amended 3-8-65.

Attached in duplicate is Amendment No. 55 to Tree Farm Licence No. 39 - M.B. & P.R. Ltd. - which accommodates a small change in the location of the logging road right-of-way covered by Special Use Permit No. 3746 by adding the old road to Schedule "B" and removing the new road for the life of S.U.P. 3746.

Your signature is recommended.



L.F. Swannell,
Chief Forester.