

PROVINCE OF BRITISH COLUMBIA

Department of Lands, Forests and Water Resources

FOREST SERVICE

IN THE MATTER OF TREE FARM LICENCE NUMBER 39

AMENDMENT NUMBER 50

Whereas a right-of-way for the purpose of removal of forest products is required over the lands described hereinafter which said lands are within Tree Farm Licence Number 39.

Therefore pursuant to Clause 12 of the said Tree Farm Licence Number 39 the following lands are hereby withdrawn from the lands described in Schedule "B" of the said Tree Farm Licence; that is to say the proposed logging road 40 feet in width situated north of Goat Lake, New Westminster Land District and being more particularly shown in red on the sketch map attached hereto, for the purpose of a right-of-way under the Forest Act for the period necessary for the removal of forest products from Timber Sale X 84123 and Timber Leases 1840p and 2793p or any extension or resale thereof and the said lands so withdrawn are not and shall not be subject to or form any part of the said Tree Farm Licence Number 39 during the lifetime of Special Use Permit Number 2855.

This amendment cancels and replaces Amendment Number 43 dated the 1st day of September, 1964.

Dated at the City of Victoria in the Province of British Columbia this...^{21st}.....day of...JANUARY.....1965.

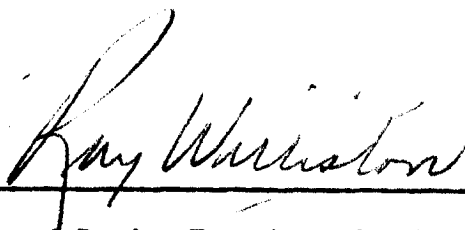

Minister of Lands, Forests and Water Resources

MAP OF SUP. 2855

Situated north of Goat Lake
LAND DISTRICT NEW WESTMINSTER

40 feet in width logging road system.

Atlas Ref. R92 K/SE (6-6)

Inventory R. No. 29 C. No. 17

SCALE 20 Chains = 1 inch.

X 84123
Blk. 1.

S.T.L. 1485^P

S.T.L. 1840^P

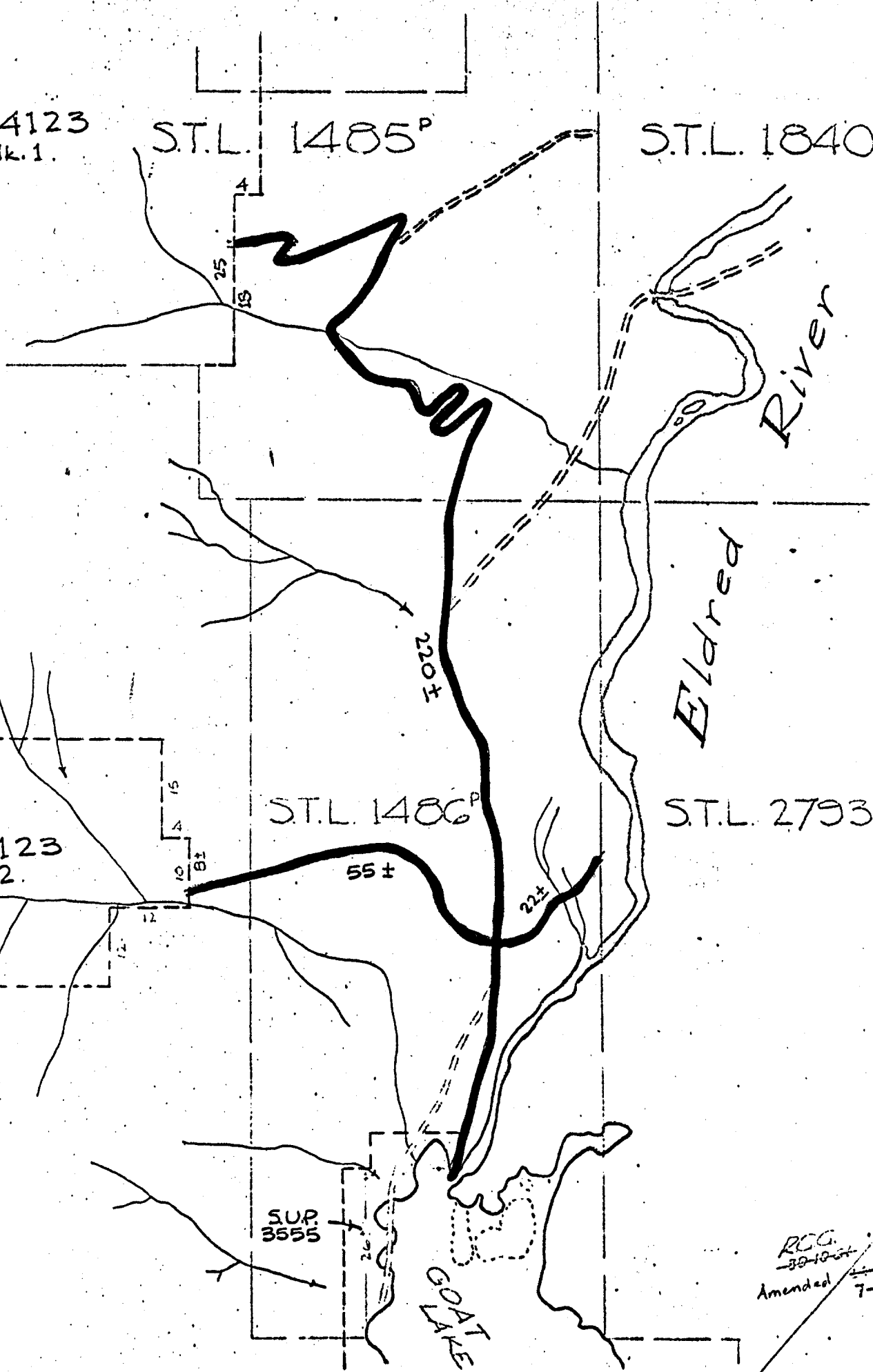

X 84123
Blk. 2.

S.T.L. 1486^P

S.T.L. 2793^P

SUP
3555

GOAT
LAKE

R.C.G.
30-10-64
Amended
7-8-64