

PROVINCE OF BRITISH COLUMBIA

Department of Lands, Forests, and Water Resources

FOREST SERVICE

IN THE MATTER OF TREE FARM LICENCE NUMBER 39

AMENDMENT NUMBER 49

Whereas the lands hereinafter described are within Tree Farm Licence Number 39 and are found to be suitable for a higher economic use than raising forest crops.

And whereas the withdrawal of the aforementioned lands will in no way affect the sustained yield management of the said Tree Farm Licence Number 39.

Therefore pursuant to Subsection (14) Section 36 of the Forest Act being Chapter 153 of the Revised Statutes of British Columbia 1960 and pursuant to Clause 11 of the said Tree Farm Licence Number 39 the following lands are hereby withdrawn from the lands described in Schedule "B" of the said Tree Farm Licence Number 39 that is to say all those lands situated within New Westminster Land District shown outlined in bold black on the sketch map attached hereto and being more particularly described as follows:

"Commencing at a point on the northerly shore of a small peninsula on the easterly shore of Powell Lake, situated opposite Inland Lake, New Westminster Land District; being 31.5 chains south and 5 chains west from the northwest corner of L. 2281 - T.L. 2436p, thence south 45° west 2 chains more or less to the southerly shore of said small peninsula, thence in general westerly, northerly and southeasterly directions along the shore of said small peninsula to the point of commencement."

And the said lands so withdrawn are not and shall not be part of or subject to the said Tree Farm Licence Number 39 during the lifetime of the Special Use Permit issued in respect of the said lands.

Dated at the City of Victoria in the Province of British Columbia this....^{21st}.....day of....JANUARY.....1965.

Minister of Lands, Forests, and Water Resources

SPECIAL USE PERMIT 5424

Outlined thus —

NEW WESTMINSTER DISTRICT

Scale: 10 chains = 1 inch

Ref. Map 92F/NE (F-4)

T.F.L. 39 BK.1

Powell Lake

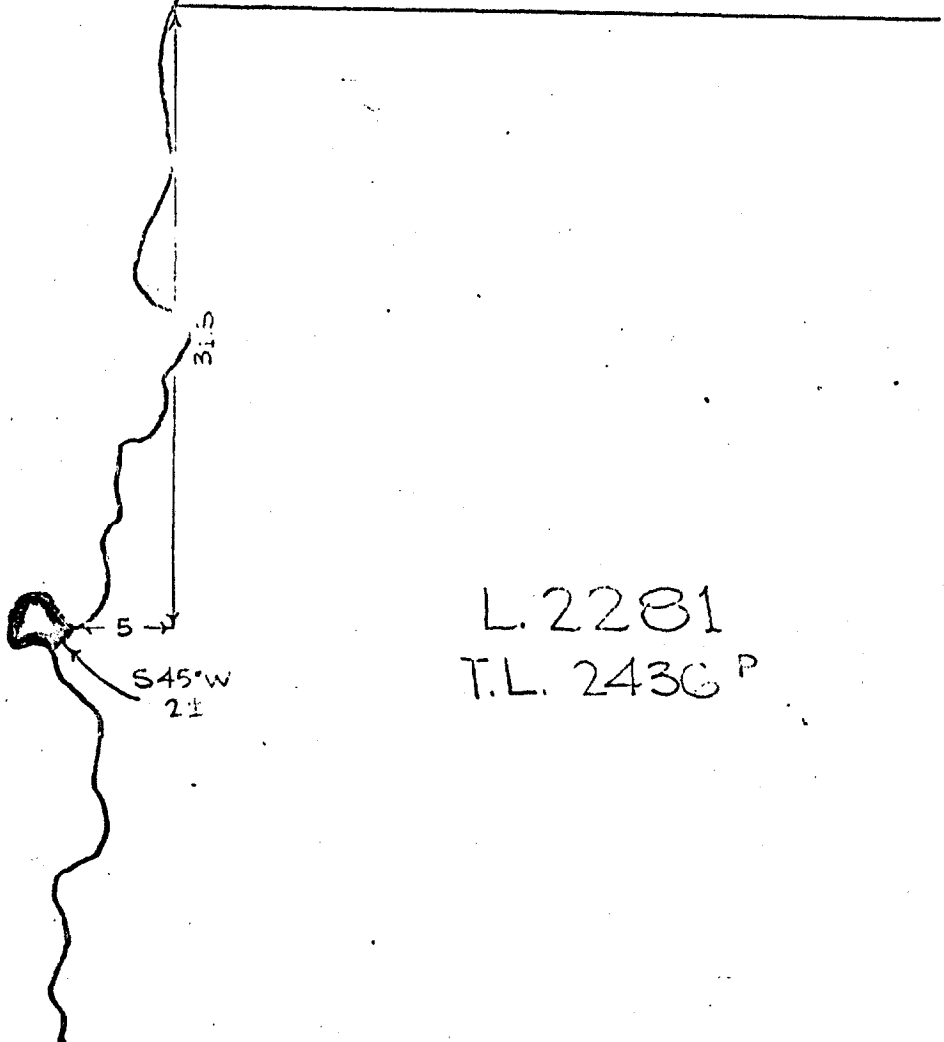

L. 2281
T.L. 2436 P