

PROVINCE OF BRITISH COLUMBIA
Department of Lands, Forests, and Water Resources
FOREST SERVICE

IN THE MATTER OF TREE FARM LICENCE NUMBER 39
AMENDMENT NUMBER 46

Whereas the lands hereinafter described are within Tree Farm Licence Number 39 and are found to be suitable for a higher economic use than raising forest crops.

And whereas the withdrawal of the aforementioned lands will in no way affect the sustained yield management of the said Tree Farm Licence Number 39.

Therefore pursuant to Subsection (14) Section 36 of the Forest Act being Chapter 153 of the Revised Statutes of British Columbia 1960 and pursuant to Clause 11 of the said Tree Farm Licence Number 39 the following lands are hereby withdrawn from the lands described in Schedule "B" of the said Tree Farm Licence Number 39 that is to say the existing logging road right-of-way 66' in width and the flume 13 chains in length and the logging campsite and the boathouse site all situated adjacent to Phillips Lake, Coast Range 1, Land District and being more particularly shown outlined in red on the sketch map attached hereto.

And the said lands so withdrawn are not and shall not be subject to or form any part of the said Tree Farm Licence Number 39 during the lifetime of Special Use Permits Numbered 5352 and 5353.

Dated at the City of Victoria in the Province of British Columbia this ..30th..... day of ..~~SEPTEMBER~~....., 1964.

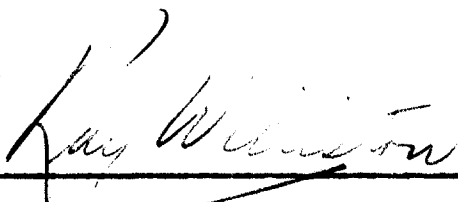

Minister of Lands, Forests, and Water Resources

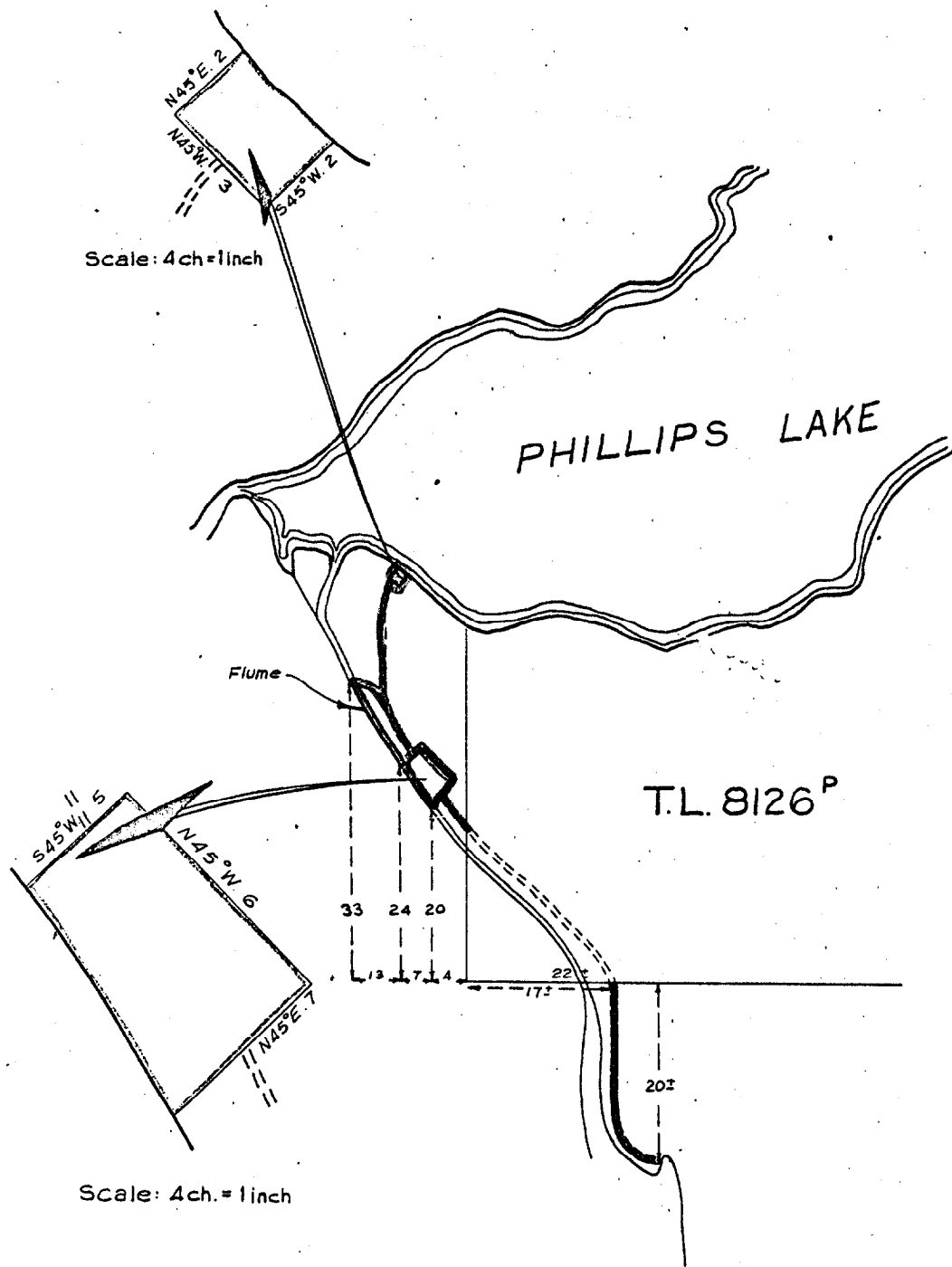

Ref. Map 92KNW a-5 Plan

File

Made by

M.B.

Dept. of Lands and Forests.

F.S. Draughting Room, Victoria, B.C.,

4-9-1964