

PROVINCE OF BRITISH COLUMBIA

Department of Lands, Forests, and Water Resources

FOREST SERVICE

---

IN THE MATTER OF TREE FARM LICENCE NUMBER 39

AMENDMENT NO. 35

---

Notice has been received from MacMillan, Bloedel and Powell River Limited, Licensee of Tree Farm Licence Number 39, to the effect that it has acquired the following Crown granted lands.

- "#1 - The SW $\frac{1}{4}$  of Sec. 35, Tp. 12, Rupert, 160 acs. C/T 337875-I.
- #2 - That part of the Fractional W $\frac{1}{2}$  of Sec. 18, Tp. 1, Rupert, lying to the South of a boundary parallel to the South boundary of said Frac. W $\frac{1}{2}$  and extending from a point on the Easterly boundary of said Frac. W $\frac{1}{2}$  distant three hundred and thirty three and ninety-six hundredths feet (333.96') southerly from the North East corner of said Frac. W $\frac{1}{2}$ , 144.7 acres, C/T 337873-I.
- #3 - Firstly: N $\frac{1}{2}$  of Sec. 1 as shown on plan deposited in D.D. 2717, 320 acres.  
Secondly: Section 12, 638 acres.  
Thirdly: The South part of the SW $\frac{1}{4}$  of Sec. 13 as shown on plan deposited in D.D. 2718.  
All in Tp. 2, Rupert, 50.0 acres.  
All under C/T 337871-I.
- #4 - That part of the N $\frac{1}{2}$  of Sec. 11, Tp. 2, Rupert, lying to the East of Plan 356 R/W, 219.9 acres, C/T 337870-I.
- #5 - That part of the Fractional E $\frac{1}{2}$  of Sec. 13, Tp. 2, Rupert, lying to the South of a boundary parallel to the Southerly boundary of said Frac. E $\frac{1}{2}$  and extending from a point on the Westerly boundary of said Frac. E $\frac{1}{2}$  distant sixteen hundred and fifty and seventy-five hundredths feet (1650.75') Southerly from the NW corner of said Fractional E $\frac{1}{2}$ , 144.7 acres, C/T 337874-I.
- #6 - All that part of the Fractional Sec. 11, Tp. 2, Rupert, lying to the South and East of Plan 356 R/W, 147.3 acres, C/T 337872-I."

all of which are located within the Watersheds and Drainage basins specified in Clause 9 of the said Tree Farm Licence; the lands described above are pursuant to Subsection 9 of Section 36 of the Forest Act being Chapter 153 of the revised statutes of British Columbia 1960 and Clause 8 of the said Tree Farm Licence hereby included in the said Tree Farm Licence Number 39,

and incorporated in Schedule "A" thereof, and all the said lands are subject to the said Tree Farm Licence.

Dated at the City of Victoria in the Province of British Columbia this <sup>26<sup>th</sup></sup>..... day of ...~~FEBRUARY~~....., 1964.

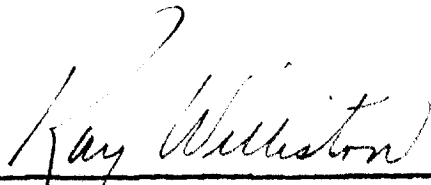

---

Minister of Lands, Forests, and Water Resources

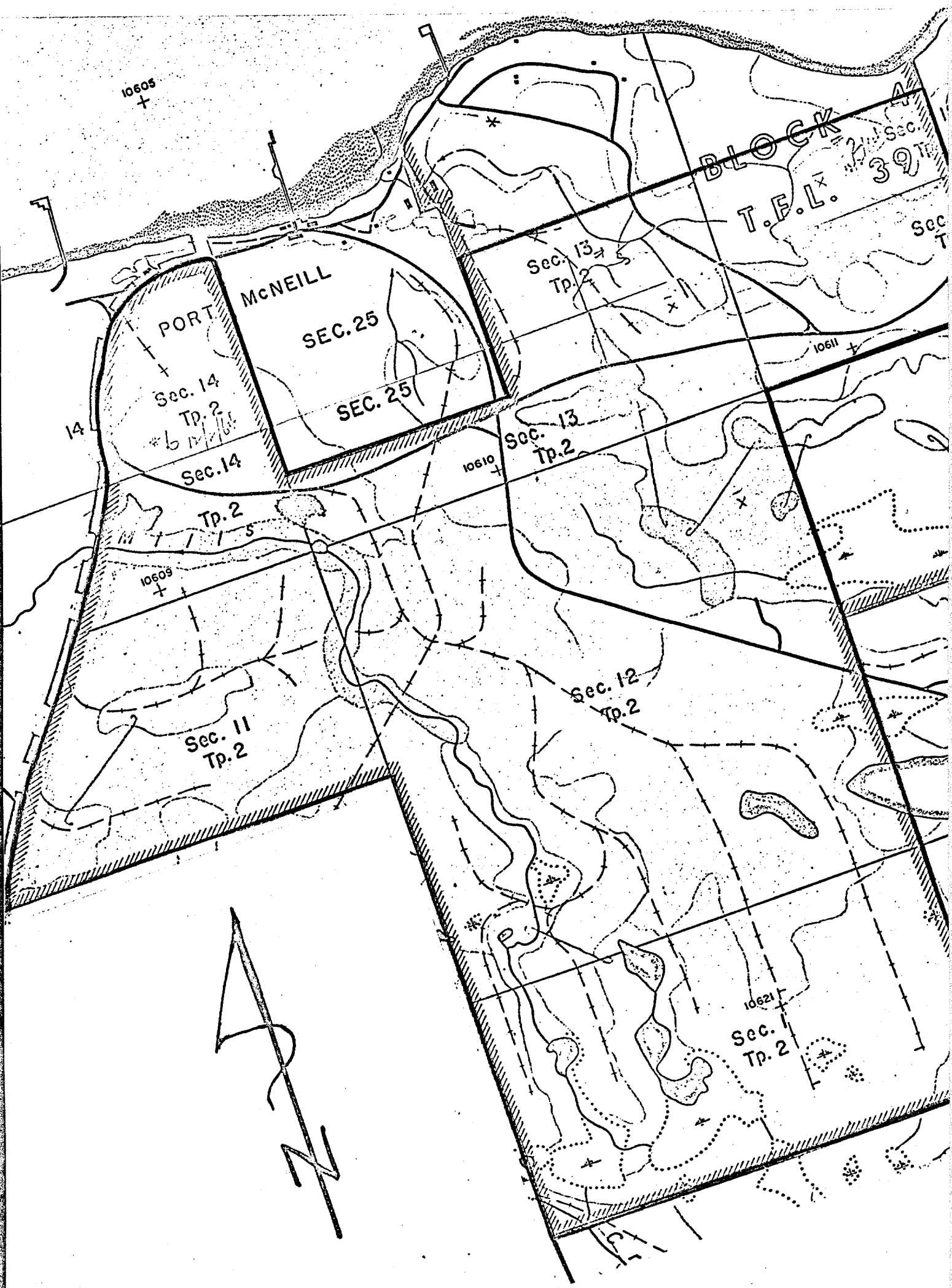

20 cks = 1 in.

RT

LAND

TL 1981  
DISTRICT  
BLOCK 4  
T.F.L. 39

Sec. 35  
Tp. 12

MARBLE  
LAKE

TL 1978

TL 1678

TL 1379  
(W 1/2)

10863

10864

10865

10740

10739

10738

10737

