

PROVINCE OF BRITISH COLUMBIA

Department of Lands, Forests, and Water Resources

FOREST SERVICE

IN THE MATTER OF TREE FARM LICENCE NUMBER 39

AMENDMENT NO. 16

Whereas a right-of-way for the purpose of removal of forest products is required over the lands described hereinafter which said lands are within Tree Farm Licence Number 39.

Therefore pursuant to Clause 12 of the said Tree Farm Licence Number 39 the following lands are herewith withdrawn from the lands described in Schedule "B" of the said Tree Farm Licence that is to say a logging road right-of-way 40 feet in width being more particularly shown in bold black on the attached sketch and described as follows:

"Commencing at a point on the west boundary of Special Use Permit 4656; being approximately 104.5 chains north and 9 chains east from the most northerly northwest corner of Lot 3526; situated west of Hotham Sound, Jervis Inlet, New Westminster Land District; thence in a general northwesterly direction approximately 30 chains in length to a point on the south boundary of Timber Sale X89289; being approximately 5 chains west from the southeast corner thereof."

for the purpose of a right-of-way under Part VI of the "Forest Act" for the period necessary for the removal of forest products from Timber Sale X89289 or any extension or resale thereof and the said lands so withdrawn are and shall be henceforth no longer subject to or form any part of the said Tree Farm Licence for the period hereinbefore stated.

Dated at Victoria in the Province of British Columbia

this 10th day of .SEPTEMBER....., 1962.

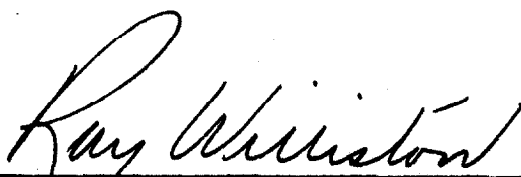

Minister of Lands, Forests, and Water Resources

LOGGING ROAD RIGHT-OF-WAY (40 FT. WIDE)

N.W.D.

Scale: 20 chains = 1 inch

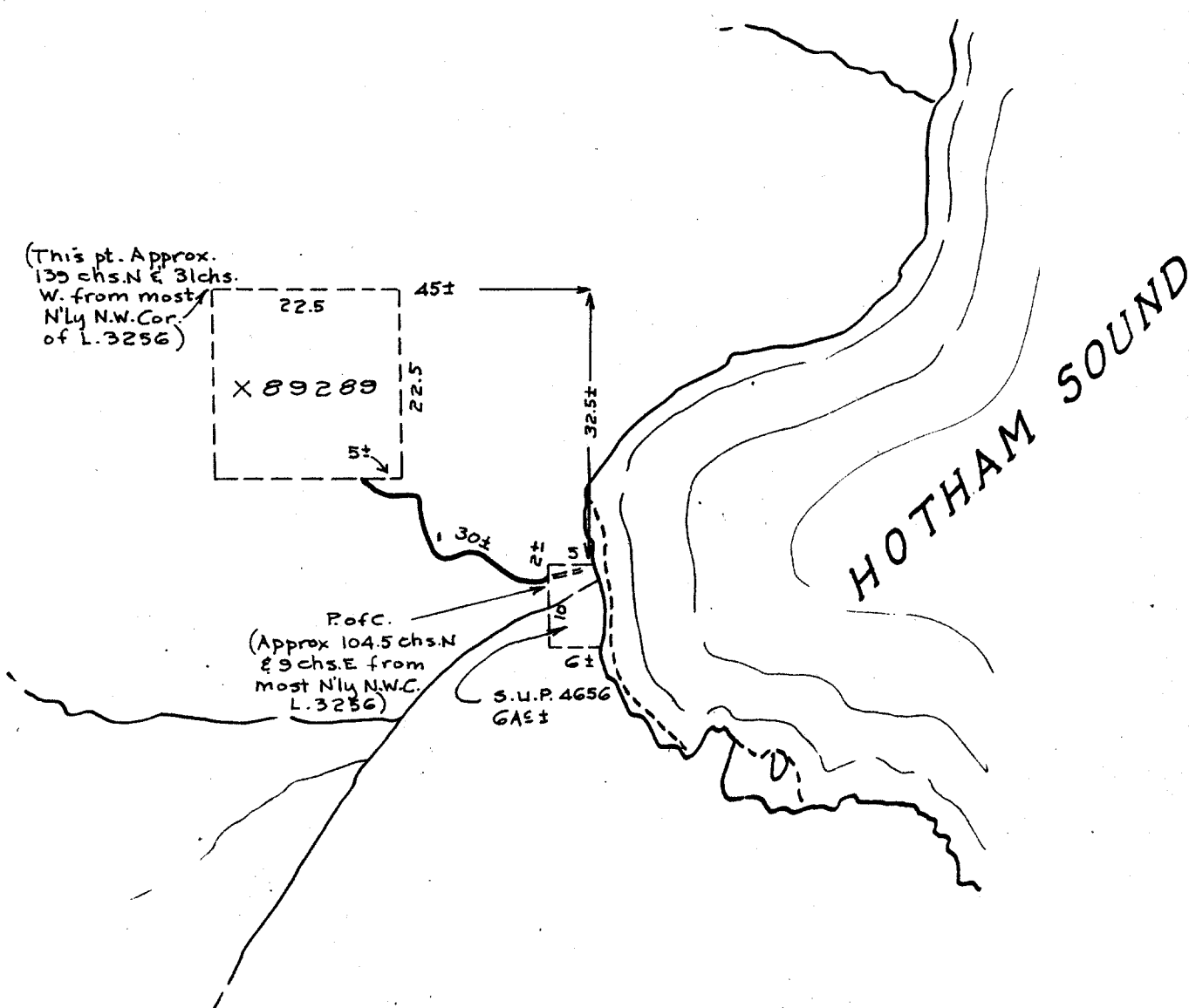
Sladey Logging, Ltd.



Road shown thus: —