

PROVINCE OF BRITISH COLUMBIA

Department of Lands, Forests, and Water Resources

FOREST SERVICE

IN THE MATTER OF TREE FARM LICENCE NUMBER 39

AMENDMENT NO. 11

Whereas a right-of-way for the purpose of removal of forest products is required over the lands described hereinafter which said lands are within Tree Farm Licence Number 39.

Therefore pursuant to Clause 12 of the said Tree Farm Licence Number 39 the following lands are herewith withdrawn from the lands described in Schedule "B" of the said Tree Farm Licence that is to say a logging road right-of-way 40 feet in width being more particularly shown in red on the attached sketch and described as follows:

"Commencing at a point on the northerly end of Goat Lake, New Westminster Land District; said point being approximately 26 chains north and 13 chains east from the intersection of the south boundary of S.T.L. 1186^P with the westerly shore of Goat Lake; thence in a general northerly direction to a point on the west boundary of S.T.L. 1840^P approximately 55 chains north from the southwest corner thereof, and totalling approximately 215 chains in length together with a branch road tributary to the main road branching in a general westerly direction approximately 55 chains in length to a point on the east boundary of Timber Sale X84123 Block 2, being approximately 8 chains south from the most easterly northeast corner thereof."

for the purpose of a right-of-way under Part VI of the "Forest Act" for the period necessary for the removal of forest products from Timber Licence 1840 and Timber Sale X84123 or any extension or resale thereof and the said lands so withdrawn are and shall be henceforth no longer subject to or form any part of the said Tree Farm Licence.

Dated at Victoria in the Province of British Columbia
this ... 17th day of ... JULY, 1962.

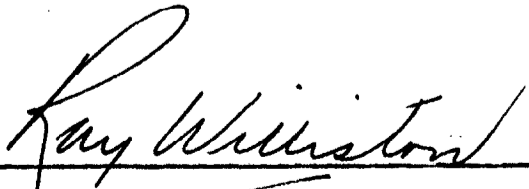

Minister of Lands, Forests, and Water Resources

MAP OF S.U.P. 2855

Situated north of Goat Lake
LAND DISTRICT NEW WESTMINSTER

Atlas Ref. R92 K/SE (6-6)

Inventory R. No. 29 C. No. 17

SCALE 20 Chains=1 inch.

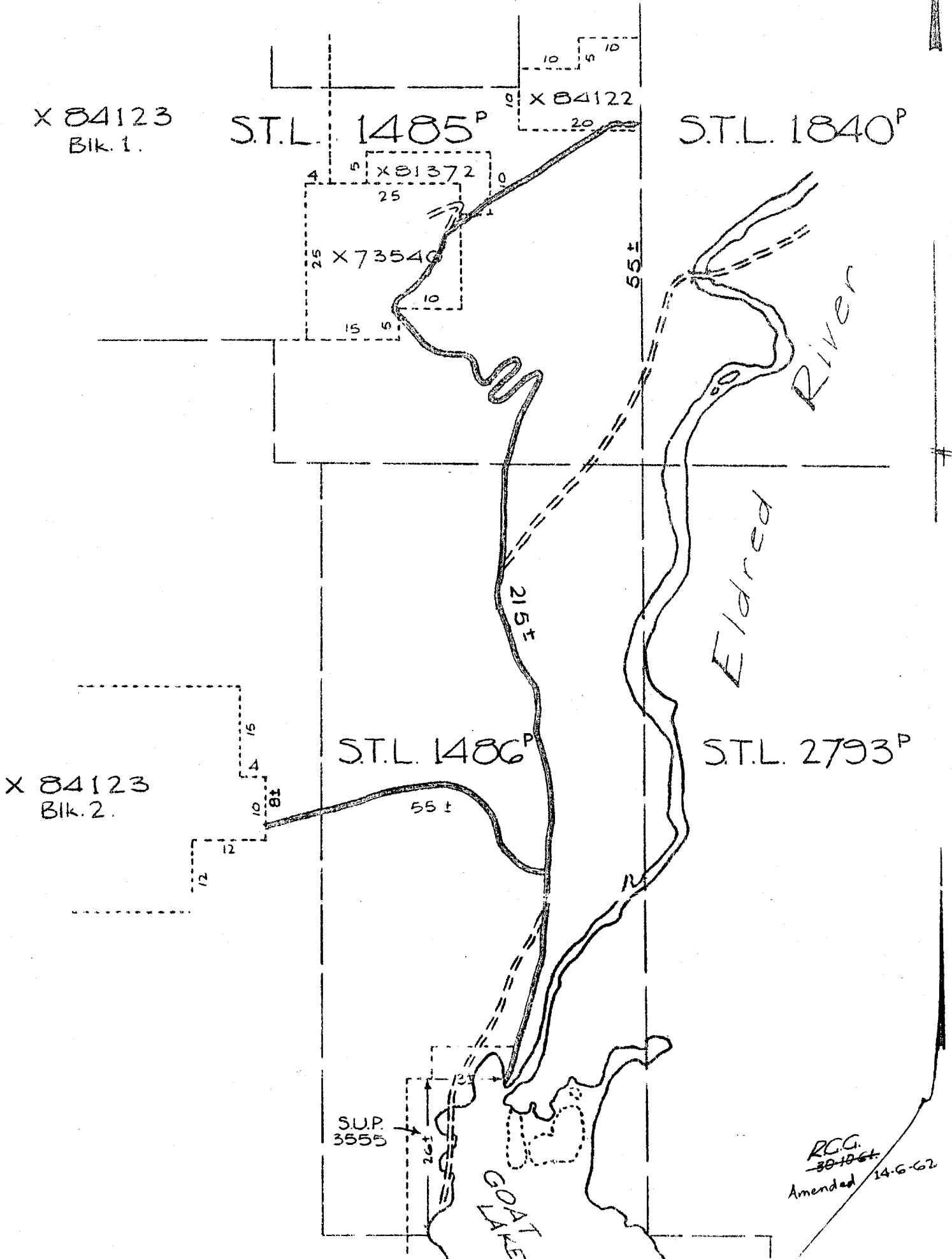

R.C.G.
~~30-10-61~~
Amended 14-6-62