

PROVINCE OF BRITISH COLUMBIA  
Department of Lands and Forests  
FOREST SERVICE

---

IN THE MATTER OF TREE FARM LICENCE NUMBER 39  
AMENDMENT NO. 3

---

Whereas a right-of-way for the purpose of removal of forest products is required over the lands described hereinafter which said lands are within Tree Farm Licence Number 39.

Therefore pursuant to Clause 12 of the said Tree Farm Licence Number 39 the following lands are herewith withdrawn from the lands described in Schedule "B" of the said Tree Farm Licence that is to say a logging road right-of-way 40 feet in width being more particularly shown outlined in red on the attached sketch and described as follows:

"Commencing at a point on the southerly boundary of the B.C. Electric transmission line right-of-way, being approximately 22 chains south and 4 chains west from the northeast corner of S.T.L. 37332; situated near Saltery Bay, Jervis Inlet, New Westminster Land District; thence in a general southerly direction a distance of 8 chains more or less to the north boundary of Timber Sale X81789, at a point approximately 8 chains west of the northeast corner of said X81789."

for the purpose of a right-of-way under Part VI of the "Forest Act" for the period necessary for the removal of forest products from Timber Sale X81789 or any extension or resale thereof and the said lands so withdrawn are and shall be henceforth no longer subject to or form any part of the said Tree Farm Licence for the period hereinbefore stated.

Dated at Victoria in the Province of British Columbia  
this .. *FIRST*..... day of ... *MARCH*....., 1962.

  
Minister of Lands and Forests



40 FT. WIDE LOGGING ROAD RIGHT-OF-WAY  
N.W.D.

Scale: 10 chains = 1 inch

N

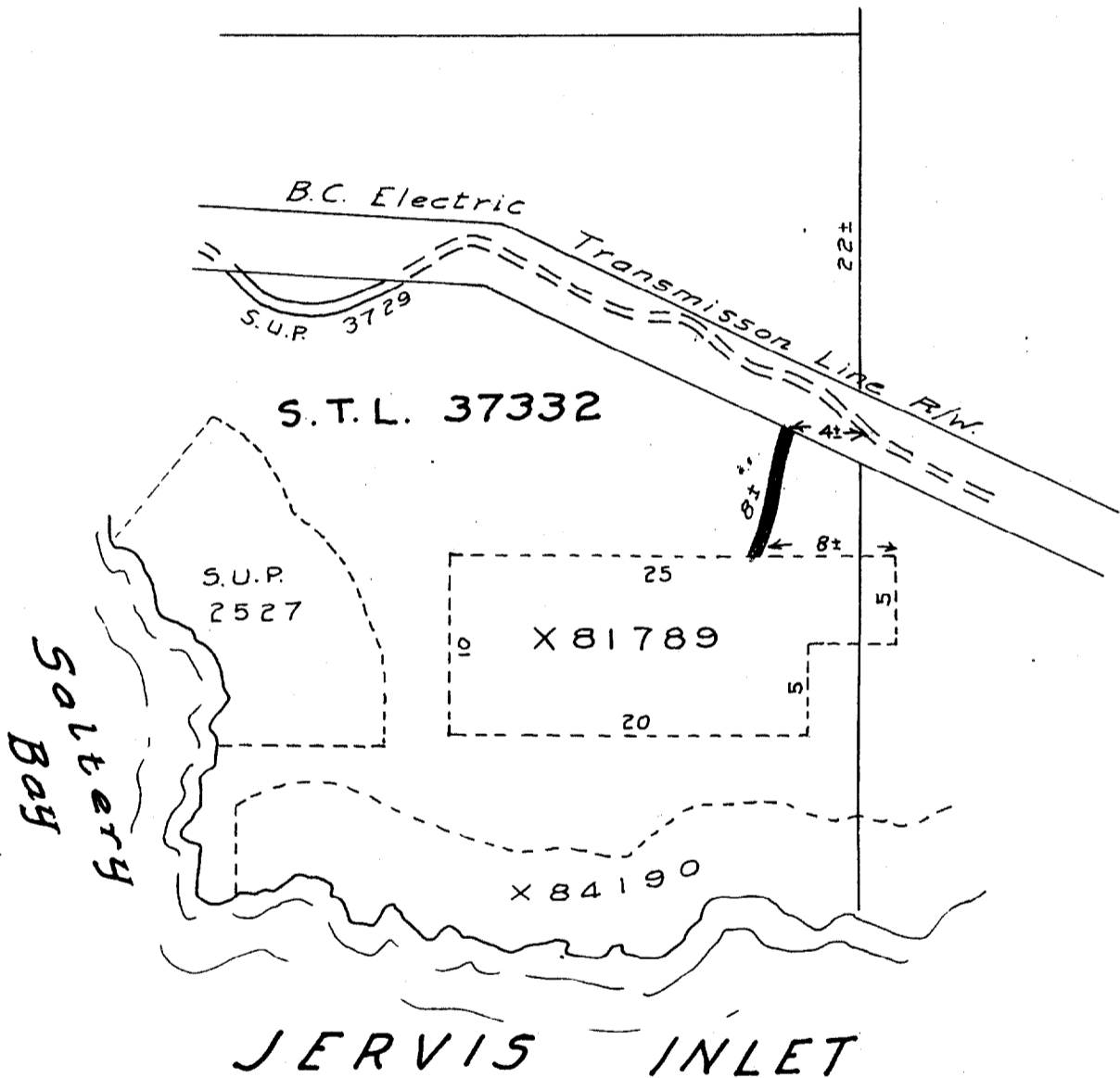

WITHIN T.F.L. #39 BLOCK 1B