

**PROVINCE OF BRITISH COLUMBIA**  
**Ministry of Forests and Range**

---

**IN THE MATTER OF TREE FARM LICENCE 38**  
**INSTRUMENT NUMBER 14**

**Amendment**

---

THIS AGREEMENT is dated the 16<sup>th</sup> day of Feb., 2006.

**BETWEEN:**

**THE MINISTER OF FORESTS AND RANGE**, on behalf of  
HER MAJESTY THE QUEEN IN RIGHT OF THE  
PROVINCE OF BRITISH COLUMBIA  
Parliament Buildings  
Victoria, British Columbia, V8V 1X4

(the "Licensor")

**AND:**

**NORTHWEST SQUAMISH FORESTRY LIMITED PARTNERSHIP**  
c/o Ratcliff & Co.  
SUITE 500, 221 W. ESPLANADE  
WEST VANCOUVER, BRITISH COLUMBIA  
V7M 3J3

(the "Licensee")

**WHEREAS:**

- A. The Licensee is the holder of Tree Farm Licence 38; and
- B. The Licensee has requested, and the Licensor has agreed, to change the area of Tree Farm Licence 38 by removing all of the private lands included in Schedule A of the Tree Farm Licence 38 agreement from the area of Tree Farm Licence 38; and
- C. The private lands to be removed from the area of Tree Farm Licence 38 are described in Appendix 1 to this instrument.

**THEREFORE:**

In accordance with Section 39.1(2)(b) of the Forest Act, the Licensor, with the consent of the Licensee, hereby changes the area of Tree Farm Licence 38 by removing the private lands described in Appendix 1 to this instrument from the area of Tree Farm Licence 38.

The Licensor and the Licensee agree that Schedule A to the Tree Farm Licence 38 agreement is hereby amended by deleting the private lands described in Appendix 1 to this instrument.

This instrument has been executed by the Licensor and Licensee on the day and year first written above.

SIGNED, SEALED AND DELIVERED )  
by the MINISTER OF FORESTS AND )  
RANGE on behalf of Her Majesty the )  
Queen in Right of the Province of British )  
Columbia in the presence of: )

Jobie Meyer )  
\_\_\_\_\_)  
\_\_\_\_\_)  
\_\_\_\_\_)

[Signature]  
\_\_\_\_\_  
MINISTER OF FORESTS AND RANGE

THE COMMON SEAL (C/S) of the )  
Licensee was affixed in the presence of: )

\_\_\_\_\_)  
Authorized Signatory )

C/S

\_\_\_\_\_)  
Authorized Signatory )

(OR)

SIGNED, SEALED AND DELIVERED )  
by the Licensee in the presence of: )

[Signature] )  
\_\_\_\_\_)  
\_\_\_\_\_)  
\_\_\_\_\_)

Chief Bill Wallace  
Authorized Signatory

\_\_\_\_\_  
Title

## Appendix 1

### **BLOCK 1**

<b>Crown Grants</b>	<b>Land District</b>	<b>Hectares (More or Less)</b>	<b>Certificate of Title</b>	<b>Parcel Identifier</b>
District Lot 984	New Westminster Group 1	63.940	BJ59736	006-610-064
District Lot 985	New Westminster Group 1	66.773	BJ59737	006-610-200
District Lot 986, except part; dedicated road on Plan LMP32891	New Westminster Group 1	62.302	BL149142	006-610-277
District Lot 3031	New Westminster Group 1	62.726	BJ59774	015-891-593
<b>Total</b>		<b>255.741</b>		



International Forest Products Limited

# EXHIBIT 'A'

1 OF 2

Map of Instrument Deletion To Tree Farm Licence 38  
D.L. 984, 985, 986

Date: 2004-06-02

Drawn by: MU

Checked by: \_\_\_\_\_

FOREST REGION: COAST FOREST REGION DISTRICT: SQUAMISH DSQ

Revised by \_\_\_\_\_  
Date/Ins. \_\_\_\_\_

Checked by \_\_\_\_\_  
Date/Ins. \_\_\_\_\_

LAND DISTRICT: NEW WESTMINSTER SHOWN AS A BOLD SOLID LINE

U.T.M. Zone East North Reg. Compt. L Planning NAD 27  
83 X

Grid 10 477900 5528200 27 10

MANAGEMENT UNIT TIMBER SUPPLY AREA PULDWOOD CASCADDES Base Map 92G094

Type T Number 31 SOO AGREEMENT East \_\_\_\_\_ Ref Map 92G/14

Number 38 Block \_\_\_\_\_ West X MDM Map ID ORCS#

Sub-B \_\_\_\_\_ Scale 1:10000 Area 255.741 Hectares

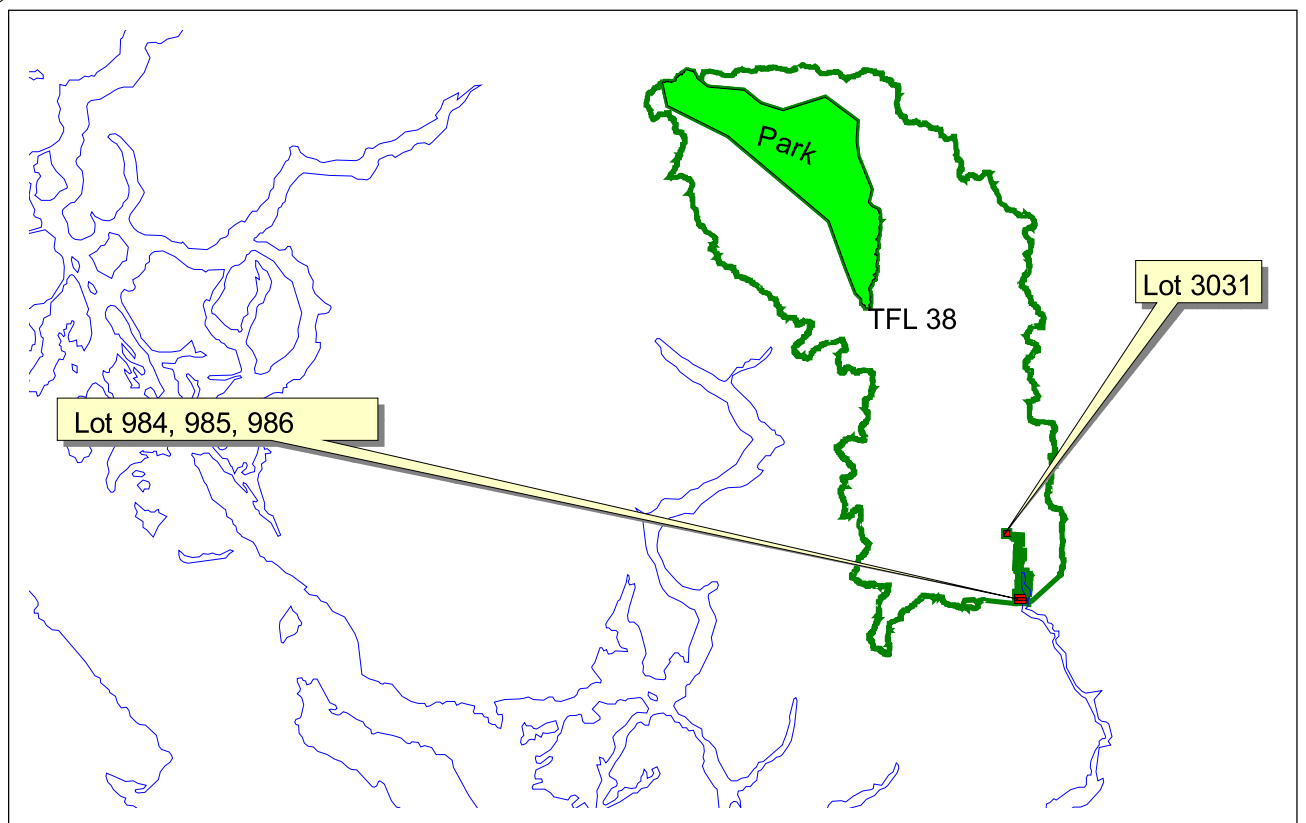
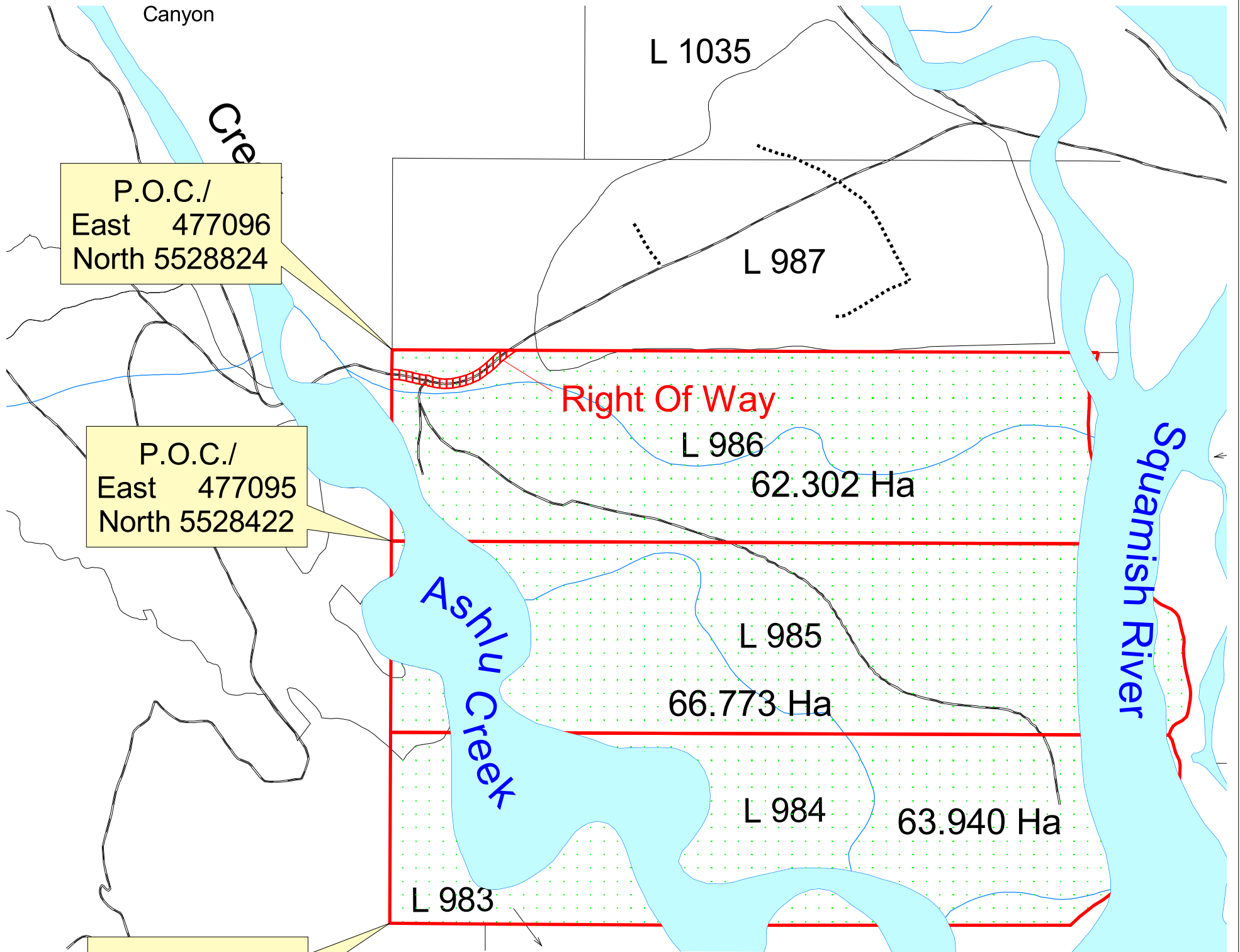



International Forest Products Limited

# EXHIBIT 'A'

2 OF 2

Map of Instrument Deletion To Tree Farm Licence 38  
D.L. 3031

Date: 2004-06-02

Drawn by: MU

FOREST REGION: COAST FOREST REGION DISTRICT: SQUAMISH DSQ

Checked by: \_\_\_\_\_

LAND DISTRICT: NEW WESTMINSTER SHOWN AS A BOLD SOLID LINE

Revised by \_\_\_\_\_  
Date/Ins. \_\_\_\_\_

Checked by \_\_\_\_\_  
Date/Ins. \_\_\_\_\_

U.T.M. Zone East North Reg. Compt. L Planning NAD 27  
83 X

Grid 10 476000 5537000 27 10

MANAGEMENT UNIT TIMBER SUPPLY AREA PULDWOOD CASCADDES Base Map 92G094

Type T Number 31 SOO AGREEMENT East \_\_\_\_\_ Ref Map 92G/14

Number 38 Block \_\_\_\_\_ West X MDM Map ID ORCS#

Sub-B \_\_\_\_\_ Scale 1:10000 Area 255.741Hectares

