

COPY

PROVINCE OF BRITISH COLUMBIA  
Department of Lands, Forests, and Water Resources  
FOREST SERVICE

---

IN THE MATTER OF TREE FARM LICENCE NUMBER 37  
AMENDMENT NUMBER 22

---

Whereas the lands described hereinafter are within Tree Farm Licence Number 37 and are found to be required for a higher economic use than the growing of forest crops;

And whereas the withdrawal of the aforementioned lands together with any lands previously withdrawn for park purposes does not exceed one percent of the licence area to the extent provided in Clause 9 of the Tree Farm Licence;

Therefore pursuant to Subsection (14) of Section 36 of the Forest Act being Chapter 153 of the Revised Statutes of British Columbia, 1960 and pursuant to Clause 9 of the said Tree Farm Licence Number 37 the following lands are hereby withdrawn from the lands described in Schedule "B" of the said Tree Farm Licence, that is to say all those parcels or tracts of land more particularly shown in bold black on the sketch attached hereto being unsurveyed land containing 40 acres more or less located within Lot 1352, Rupert Land District, and the said lands so withdrawn are and shall be henceforth no longer subject to or form any part of the said Tree Farm Licence Number 37.

Dated at the City of Victoria in the Province of British Columbia this . . . . 31st . . . . day of . . . . October . . . . . 1972.

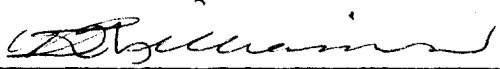
  
Minister of Lands, Forests, and Water Resources.

LAND DISTRICT Rupert  
Region No. 2 Compt. No. 19  
Base.....

BRITISH COLUMBIA  
FOREST SERVICE

DATE 6-7-72  
Atlas Ref. 92 L/SE (c-3)

Amendment #22 to T.F.L. 37

Shown..... Acres  $\pm$  43 RD. 15 Scale 2640 ft. or 40 chs - 1 inch

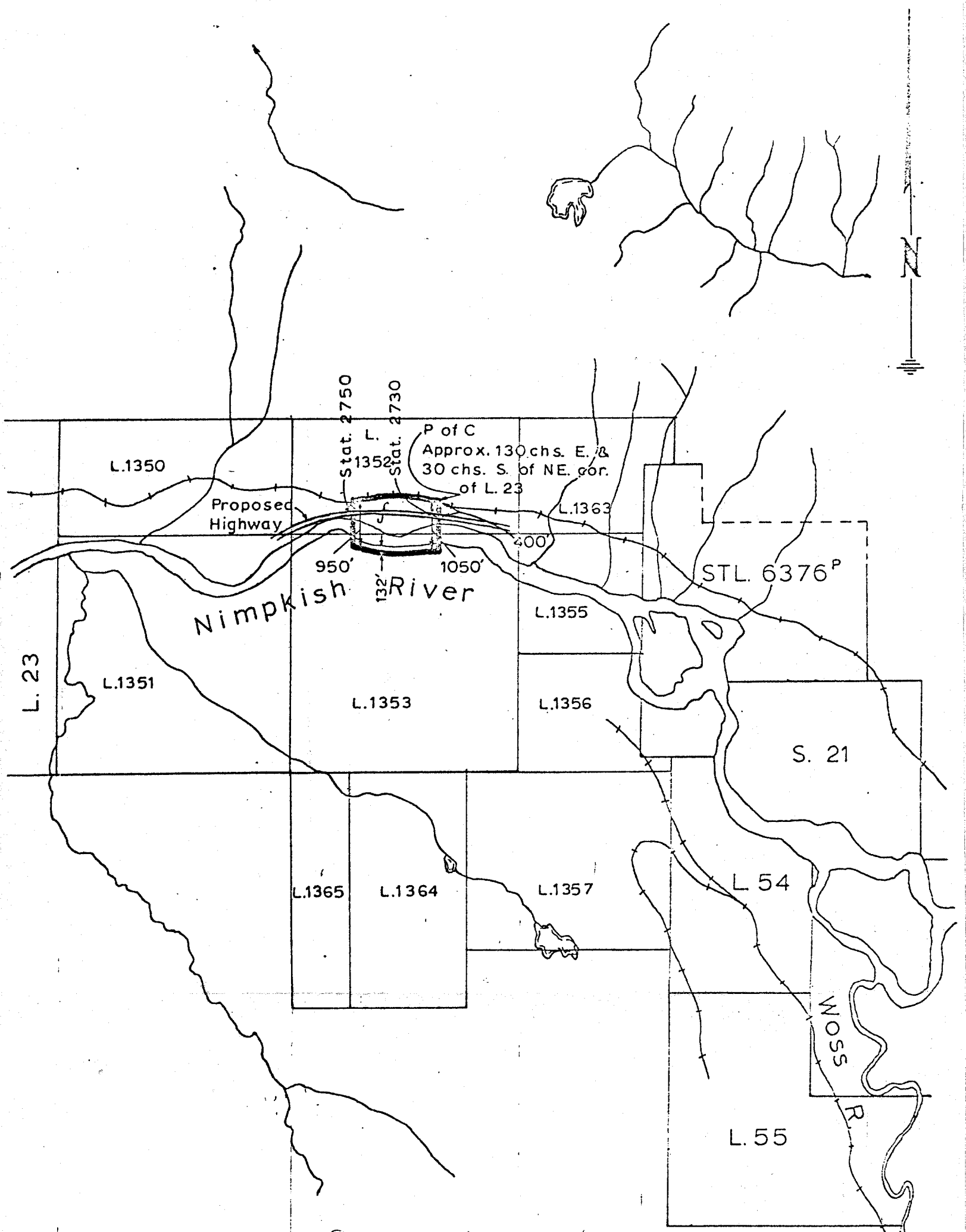

Save and excepting Public Highway