

COPY

PROVINCE OF BRITISH COLUMBIA

Department of Lands, Forests, and Water Resources

FOREST SERVICE

---

IN THE MATTER OF TREE FARM LICENCE NUMBER 37

AMENDMENT NUMBER 12

---

THIS AGREEMENT made in duplicate this . 29 . day of . October . .  
in the year of Our Lord one thousand nine hundred and sixty-nine,

BETWEEN:

THE MINISTER OF LANDS, FORESTS, AND WATER RESOURCES  
of the Province of British Columbia, who, with his  
successors in office, is

hereinafter called "the Licensor",

OF THE FIRST PART,

AND

CANADIAN FOREST PRODUCTS LTD., a Corporation duly incorporated  
under the laws of the Province of British Columbia, and having  
its registered office in the City of Vancouver in the said  
Province,

hereinafter called "the Licensee",

OF THE OTHER PART.

WHEREAS by an Agreement dated the 28th day of December 1960, the  
Licensor did grant unto the Licensee a Tree Farm Licence which is known and  
referred to as the "Nimpkish Tree Farm Licence" and is numbered thirty-seven  
(37) on the Forest Service register of Tree Farm Licences and on the official  
atlas maps of the Department of Lands, Forests, and Water Resources.

AND WHEREAS pursuant to Clause 47 of the said Tree Farm Licence the  
said Agreement may be amended and the parties hereto have mutually agreed to  
amend the said Agreement as hereinafter set forth.

NOW THEREFORE THIS AGREEMENT WITNESSETH that in consideration of the  
premises and the sum of One Dollar (\$1.00) of lawful money of Canada now paid  
by the Licensee to the Licensor, receipt whereof is hereby acknowledged, the  
parties hereto agree as follows:

(1) THAT the description of Schedule "B" of the said Agreement is hereby cancelled and the attached description marked Exhibit 'A' is and shall be henceforth the description of Schedule "B" Lands as if the said description had been originally attached to the said Tree Farm Licence Agreement.

(2) THAT the plan referred to in Clause 5 of the said Tree Farm Licence is amended in part to include the plans attached hereto and marked Exhibits 'B' and 'C'.

(3) THAT subject to the terms of this Agreement the parties hereto confirm in all other respects the said Agreement dated the 28th day of December, 1960 and amendments thereto to the date hereof.

(4) THIS AGREEMENT shall enure to the benefit of and be binding upon the parties hereto, their respective successors and the permitted assigns of the Licensee.

IN WITNESS WHEREOF the Licensor has executed these presents and the Licensee has hereunto affixed its corporate seal by the hands of its proper officers in that behalf.

SIGNED SEALED AND DELIVERED  
IN THE PRESENCE OF:

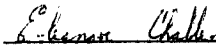
  
\_\_\_\_\_  
Witness

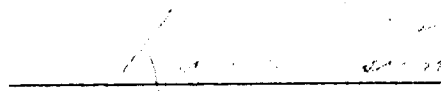
  
\_\_\_\_\_  
Minister of Lands, Forests, and Water Resources

THE CORPORATE SEAL OF THE LICENSEE, CANADIAN FOREST PRODUCTS LTD.,  
was hereunto affixed in the  
presence of:

  
\_\_\_\_\_  
Director

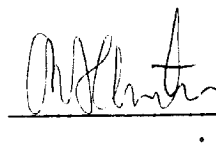
  
\_\_\_\_\_  
Secretary

NIMPISH TREE FARM LICENCE

TREE FARM LICENCE NO. 37

Crown lands not otherwise alienated enclosed within the following described boundaries in the Rupert and Nootka Land Districts.

Commencing at the northeast corner of Lot 2, Rupert Land District, being a point on the highwater mark of Beaver Cove; thence southerly along the easterly boundary of Lot 2 to the southeast corner thereof; thence westerly along the southerly boundaries of Lot 2 and Lot 348 to the southwest corner of said Lot 348; thence southerly and westerly along the easterly and southerly boundaries of Lot 134 to the southwest corner of said Lot 134; thence westerly along the southerly boundary of Lot 1 to the northeast corner of Lot 133; thence southerly along the easterly boundary of said Lot 133 to the southeast corner thereof; thence westerly along the southerly boundaries of Lot 133, and Lot 349 to the southwest corner of said Lot 349; thence due west to the easterly boundary of Lot 891, (T.L. 681<sup>P</sup>); thence southerly and westerly along the easterly and southerly boundaries of said Lot 891 (T.L. 681<sup>P</sup>) to the most northerly northwest corner of Lot 900 (T.L. 45<sup>P</sup>) thence southerly, westerly and southerly along the westerly boundary of said Lot 900 (T.L. 45<sup>P</sup>) to the southwest corner thereof; thence southerly along the westerly boundaries of Lots 903 (T.L. 75<sup>P</sup>), 905 (T.L. 77<sup>P</sup>), 907 (T.L. 79<sup>P</sup>), T.L. 5292<sup>P</sup> and T.L. 5293<sup>P</sup> to the southwest corner of said T.L. 5293<sup>P</sup>; thence easterly along the southerly boundaries of T.L. 5293<sup>P</sup> and T.L. 5294<sup>P</sup> to the southeast corner of said T.L. 5294<sup>P</sup>; thence northerly along the easterly boundary of said T.L. 5294<sup>P</sup> to the southwest corner of T.L. 1885<sup>P</sup>; thence easterly along the southerly boundary of said T.L. 1885<sup>P</sup> and the easterly prolongation thereof to the westerly boundary of the watershed of Bonanza River; thence in a general southerly direction along the said westerly boundary of the watershed of Bonanza River to the summit of Mount Kinman, being a point on the easterly boundary of the watershed of Kinman Creek; thence in a general southerly direction along the said easterly boundary of the watershed of Kinman Creek and the westerly boundary of the watershed of an unnamed tributary to Steel Creek, to a point on the northerly boundary of T.L. 6515<sup>P</sup>; thence easterly and southerly along the northerly and easterly boundaries of said T.L. 6515<sup>P</sup> to the northwest corner of T.L. 6516<sup>P</sup>; thence easterly along the northerly boundaries of

T.L.'s 6516<sup>P</sup> and 6517<sup>P</sup> to the northeast corner of said T.L. 6517<sup>P</sup>; thence southerly along the easterly boundary of said T.L. 6517<sup>P</sup> to the northerly boundary of T.L. 6518<sup>P</sup>; thence easterly and southerly along the northerly and easterly boundaries of said T.L. 6518<sup>P</sup> to the southerly boundary of the watershed of Bonanza River; thence in a general southerly, easterly and northerly direction along the southerly and easterly boundaries of the watershed of Bonanza River to the summit of Mount Ashwood, being a point on the westerly boundary of the watershed of an unnamed creek crossing T.L. 6462<sup>P</sup> and T.L. 6461<sup>P</sup> and flowing into Claude Elliott Lake; thence in a general northerly, easterly and southerly direction along the westerly, northerly and easterly boundaries of the watershed of the said unnamed creek to a point due north of the most northerly northeast corner of T.L. 6462<sup>P</sup>; thence south to the said northeast corner; thence southerly, easterly and southerly along the easterly, northerly and easterly boundaries of said T.L. 6462<sup>P</sup> to the northerly boundary of T.L. 6461<sup>P</sup>; thence easterly along the said northerly boundary of T.L. 6461<sup>P</sup> to the northeast corner thereof; thence due east to the highwater mark of an unnamed lake on the easterly shore thereof, the said lake lying  $\frac{1}{2}$  mile more or less northerly from Claude Elliott Lake; thence in a general southerly direction along the said highwater mark of the unnamed lake and the highwater mark of Claude Elliott Creek on the east bank thereof and the highwater mark of Claude Elliott Lake on the easterly shore thereof to the most northerly northwest corner of T.L. 6460<sup>P</sup>; thence easterly along the northerly boundary of said T.L. 6460<sup>P</sup> to the most northerly northeast corner thereof; thence due east to the easterly boundary of the watershed of said Claude Elliott Lake; thence in a general southerly direction along the said easterly boundary of the watershed of Claude Elliott Lake and the easterly boundary of the watershed of Lukwa Creek to a point due west of the northwest corner of T.L. 7212<sup>P</sup>; thence east to the said northwest corner; thence in a general easterly and southerly direction along the northerly and easterly boundaries of T.L.'s 7212<sup>P</sup>, 7213<sup>P</sup>, 7214<sup>P</sup> and 2915<sup>P</sup> to the northeast corner of said T.L. 2915<sup>P</sup>; thence due east to the westerly boundary of the watershed of Eve River; thence in a general southerly and easterly direction along the westerly and southerly boundaries of the said watershed of Eve River to the northerly boundary of the watershed of Schoen Lake; thence in a general westerly and southerly direction along the northerly and westerly boundaries of said watershed of Schoen Lake to a point due north of the most

westerly point on the highwater mark of Schoen Lake; thence due south to the said point; thence southerly and easterly along the highwater mark of said Schoen Lake on the westerly and southerly shores thereof to the highwater mark of Schoen Creek on the right bank thereof; thence easterly in a straight line to the summit of Mount Schoen, being a point on the easterly boundary of the watershed of Schoen Creek; thence in a general southerly direction following the said easterly boundary of the watershed of Schoen Creek, Nimpkish River and Oktwanch River to a point North 45 degrees East of the southeast corner of T.L. 7238<sup>P</sup>; thence South 45 degrees West to the said corner; thence westerly along the southerly boundaries of T.L. 7238<sup>P</sup> and T.L. 1909<sup>P</sup> to the southwest corner of said T.L. 1909<sup>P</sup>; thence southwesterly in a straight line to the northwest corner of T.L. 1920<sup>P</sup>; thence southerly along the westerly boundary of said T.L. 1920<sup>P</sup> to the northerly boundary of the watershed of Muchalat River; thence in a general northwesterly direction along the northerly boundaries of the watersheds of Muchalat River, Conuma River, and the northeasterly boundaries of the watershed of Leiner River, McKelvie Creek and Tahsis River to the southerly boundary of the watershed of Woss Lake; thence in a general westerly and northerly direction along the southerly and westerly boundaries of the watersheds of Woss Lake, Kaipit Creek, Pinder Creek and Atluck Lake, to an unnamed peak situated approximately 61 chains due west and 24 chains more or less due south of the northeast corner of Lot 262 (T.L. 4407<sup>P</sup>); thence on an approximate bearing of North 67 degrees East 65 chains more or less to a second unnamed peak, being a point on the aforesaid westerly boundary of the watershed of Atluck Lake; thence in a general northerly direction along the westerly boundaries of the watersheds of Atluck Lake, Huston Lake, and Nimpkish Lake to the southerly boundary of T.L. 1992<sup>P</sup>; thence easterly along the southerly boundary of said T.L. 1992<sup>P</sup> to the southeast corner thereof; thence northerly along the easterly boundary of said T.L. 1992<sup>P</sup> to the northeast corner thereof; thence easterly along the southerly boundaries of Section 19 and Section 20, Township 15, Rupert District to the southwest corner of the southeast quarter of said Section 20; thence northerly along the easterly boundary of the west halves of Sections 20 and 29 to the northeast corner of the west half of said Section 29; thence easterly along the southerly boundaries of Section 32 and Section 33 to the southeast corner of said Section 33, being a point on the highwater mark of Nimpkish River on the left bank thereof; thence in a

general northerly direction along the said highwater mark of Nimpkish River to the westerly boundary of fractional Section 34, Township 15; thence northerly and easterly along the westerly and northerly boundaries of said fractional Section 34 to the northeast corner thereof, said corner being a point on the aforesaid highwater mark of Nimpkish River on the left bank thereof; thence northerly along the said highwater mark to the southerly boundary of Lot 27; thence westerly, northerly and easterly along the southerly, westerly and northerly boundaries of said Lot 27 to the southwest corner of fractional Section 10, Township 1; thence northerly along the westerly boundary of said fractional Section 10 to the southwest corner of fractional Section 15; thence easterly along the southerly boundary of said Section 15 to the southeast corner of the fractional southwest quarter thereof; thence southerly in a straight line to the northwest corner of Lot 26; thence easterly, southerly and westerly along the northerly, easterly and southerly boundaries of said Lot 26 to the southwest corner thereof, being a point on the easterly boundary of aforesaid Lot 27; thence southerly along the easterly boundary of said Lot 27 to the highwater mark of Nimpkish River on the left bank thereof; thence due south to the highwater mark of said Nimpkish River on the right bank thereof; thence southerly and easterly along the westerly and southerly boundaries of Indian Reserve Number 3 to the southeast corner thereof, being a point on the southerly highwater mark of Broughton Strait; thence in a general easterly direction along the said southerly highwater mark of Broughton Strait to the northeast corner of Lot 911 (T.L. 479<sup>P</sup>); thence southerly along the easterly boundary of said Lot 911 to the southeast corner thereof; thence southerly, easterly and southerly along the boundaries of Lot 912 (T.L. 570<sup>P</sup>) to the southerly boundary of Lot 225; thence easterly along the said southerly boundary of Lot 225 to the most southerly southeast corner thereof; thence northerly, westerly, northerly and easterly along the boundaries of said Lot 225 to the westerly highwater mark of Beaver Cove; thence in a general southerly, northerly and easterly direction along the said highwater mark of Beaver Cove to the aforesaid northeast corner of Lot 2, being the point of commencement.

AMENDMENT NO. 12 TO T.F.L. 37

Boundary shown thus 

Scale: 20 chains

1 inch

Tp. 1

EXHIBIT 'B'

BROUGHTON STRAIT

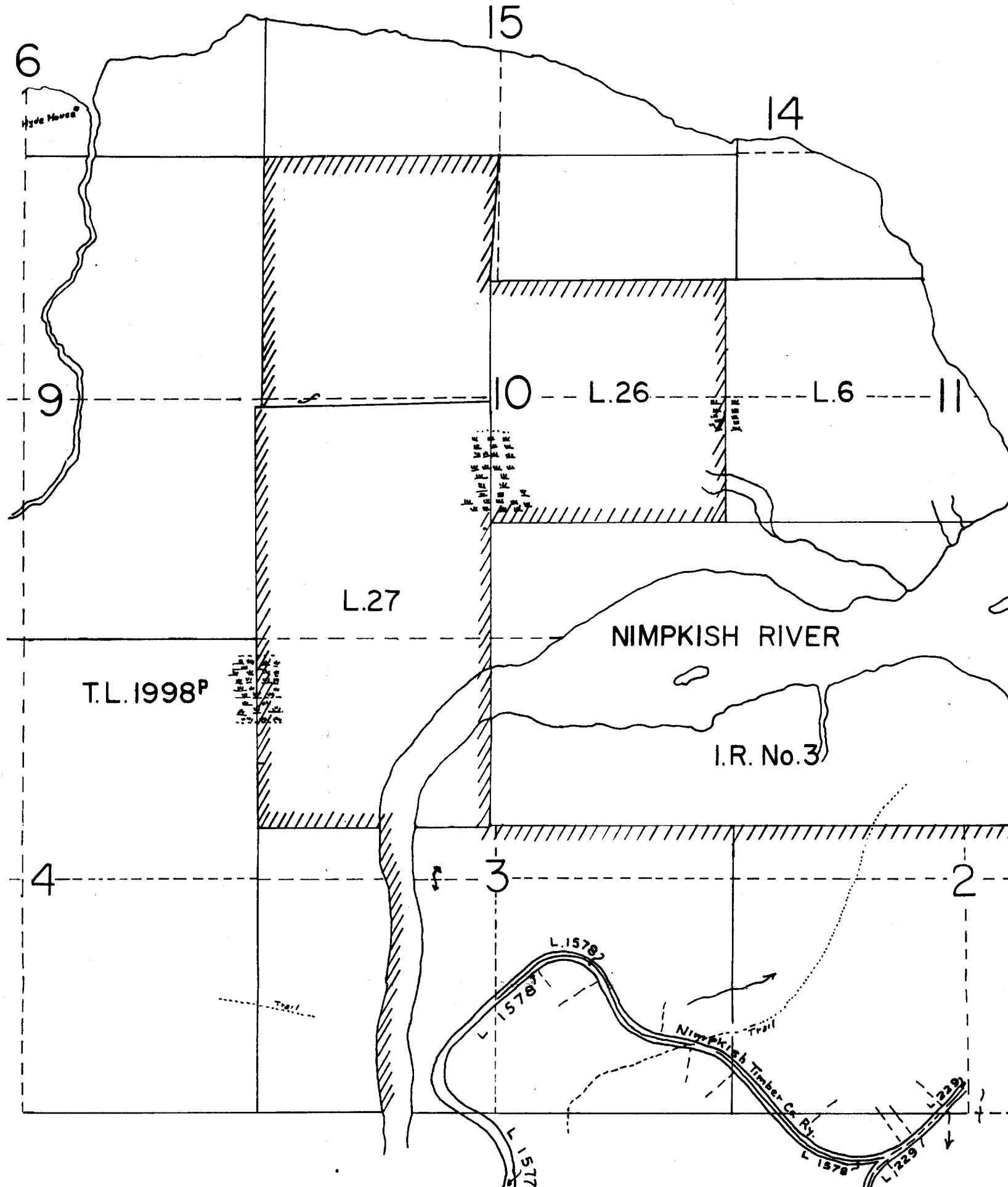

Lot No	Field Book	Pigeon hole	Date Surveyed	Reference Map
				92 L/NW&NE Plan 2 Tray 2, Rupert.
Sketch for				Made by J.E. Moody
Department of Lands, Forests, and Water Resources.				
Is. Draughting Room, Victoria, B.C.				19

**AMENDMENT NO. 12 TO T.F.L. 37**  
Boundary shown thus 

EXHIBIT 'C'

Scale: 20 chains = 1 inch

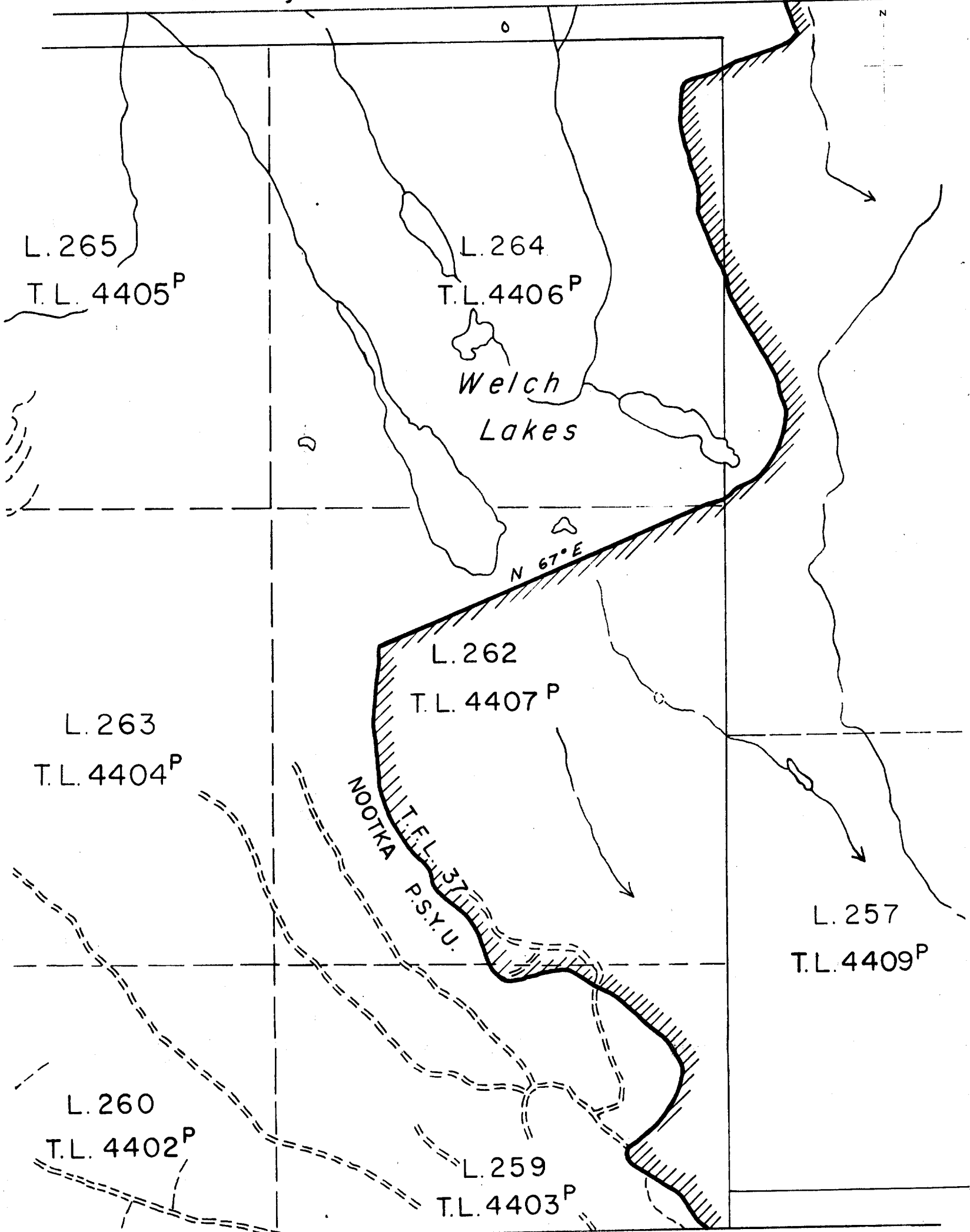

Lot No.	Field Book	Pigeon hole	Date Surveyed	Reference Map 92-L-3-h	Plan
				Sketch for	Made by J.E. Moody
				Department of Lands, Forests, and Water Resources,	
				F.S. Draughting Room, Victoria, B.C.	19



TO THE HONOURABLE THE MINISTER

Your signature is recommended on the attached Amendment Number 12 to Tree Farm Licence Number 37 - Canadian Forest Products Ltd.

This amendment redescribes for clarification purposes, the boundary of the Tree Farm Licence in two areas by mutual consent.



L. F. Swannell,  
Chief Forester.