

**PROVINCE OF BRITISH COLUMBIA**

**Ministry of Forests**

---

**IN THE MATTER OF TREE FARM LICENCE NUMBER 35**

**INSTRUMENT NUMBER 10**

**Amendment**

---

THIS AGREEMENT is dated the 15th day of February, 2001.

BETWEEN:

THE MINISTER OF FORESTS, on behalf of HER MAJESTY THE  
QUEEN IN RIGHT OF THE PROVINCE OF BRITISH COLUMBIA,  
Parliament Buildings, Victoria, British Columbia, V8V 1X4.

(the "Licensor")

AND:

WEYERHAEUSER COMPANY LIMITED  
P.O. Box 800  
1850 Mission Flats Road  
Kamloops, British Columbia  
V2C 5M7

(the "Licensee")

WHEREAS:

- A. Pursuant to the provisions of Section 36 of the *Forest Act*, the Licensor and the Licensee entered into a replacement agreement for Tree Farm Licence (TFL) 35, dated March 1, 2000.
- B. The Licensee has requested an amendment to the boundaries of the Schedule "B" lands for TFL 35.
- C. The Licensor and the Licensee have mutually agreed to amend TFL 35, such that the boundaries of TFL 35 will coincide with the boundaries of Porcupine Meadows Park.

**THEREFORE:**

Pursuant to Section 39(1)(e) of the *Forest Act*, the Licensor and the Licensee agree to amend the said Schedule "B" lands of TFL 35.

The lands depicted by vertical lines on Exhibit "A" dated July 18, 2000, are hereby deleted from Schedule "B" of TFL 35.

The lands depicted by horizontal lines on Exhibit "A" dated July 18, 2000, are hereby added to Schedule "B" of TFL 35.

This instrument shall be binding upon the Licensor and its successors in office and the Licensee, its successors and assignees.

This Agreement has been executed by the Licensor and Licensee on the day and year first written above.

SIGNED, SEALED AND DELIVERED )  
by the Minister of Forests on behalf of )  
Her Majesty the Queen in Right of the )  
Province of British Columbia in the )  
presence of: )

  
\_\_\_\_\_ )

\_\_\_\_\_ )  
THE COMMON SEAL C/S of the )

Licensee was affixed in the presence of: )

\_\_\_\_\_ )  
Authorized Signatory )

\_\_\_\_\_ )

Authorized Signatory )

(or)

SIGNED, SEALED AND DELIVERED )  
by the Licensee in the presence of: )

  
\_\_\_\_\_ )  
**D. Hugh MacInnes** )  
**Barrister & Solicitor** )

P.O. Box 800  
Kamloops, B.C.  
V2C 5M7

  
\_\_\_\_\_ )  
Minister of Forests

C/S

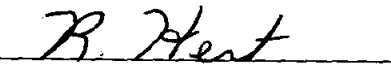
  
\_\_\_\_\_ )  
Authorized Signatory

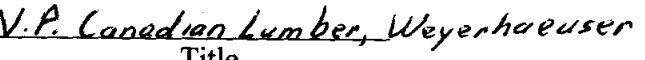
  
\_\_\_\_\_ )  
Title



Province of  
British Columbia  
Ministry of Forests

FOREST REGION : RKA Kamloops  
DISTRICT : DKA Kamloops

# Instrument No.10 to TFL 35

MAP OF:

| MANAGEMENT UNIT |   | TIMBER SUPPLY AREA |  | PULPWOOD AGREEMENT | CASCADES |
|-----------------|---|--------------------|--|--------------------|----------|
| Type            | T | Number             |  |                    |          |
| Block           |   | Block              |  | East               | X        |
| Block           |   | Sub-B              |  | West               |          |

**EXHIBIT 'A'**  
Date 00-07-18  
Ref. Map 921-15/E, 16/W  
Base 0921.098  
Scale 1: 20 000  
Area see legend

LAND DISTRICT : 26 K.D.Y.D. ODM Map D: In10\_T35.xbo  
OUTLINE : see legend OUTLINE : see legend

| U.T.M. Grid | Zone | East   | North   | Req | Comp. | L |
|-------------|------|--------|---------|-----|-------|---|
|             | 10   | 675900 | 5650000 | 0   | 465   | 7 |

**LEGEND:**

 ADDED TO TFL 35  
5.7075 HA +/- TOTAL

 DELETED FROM TFL 35  
12.30 HA +/- TOTAL

TFL 35 NET LOSS = 6.59 HA +/-

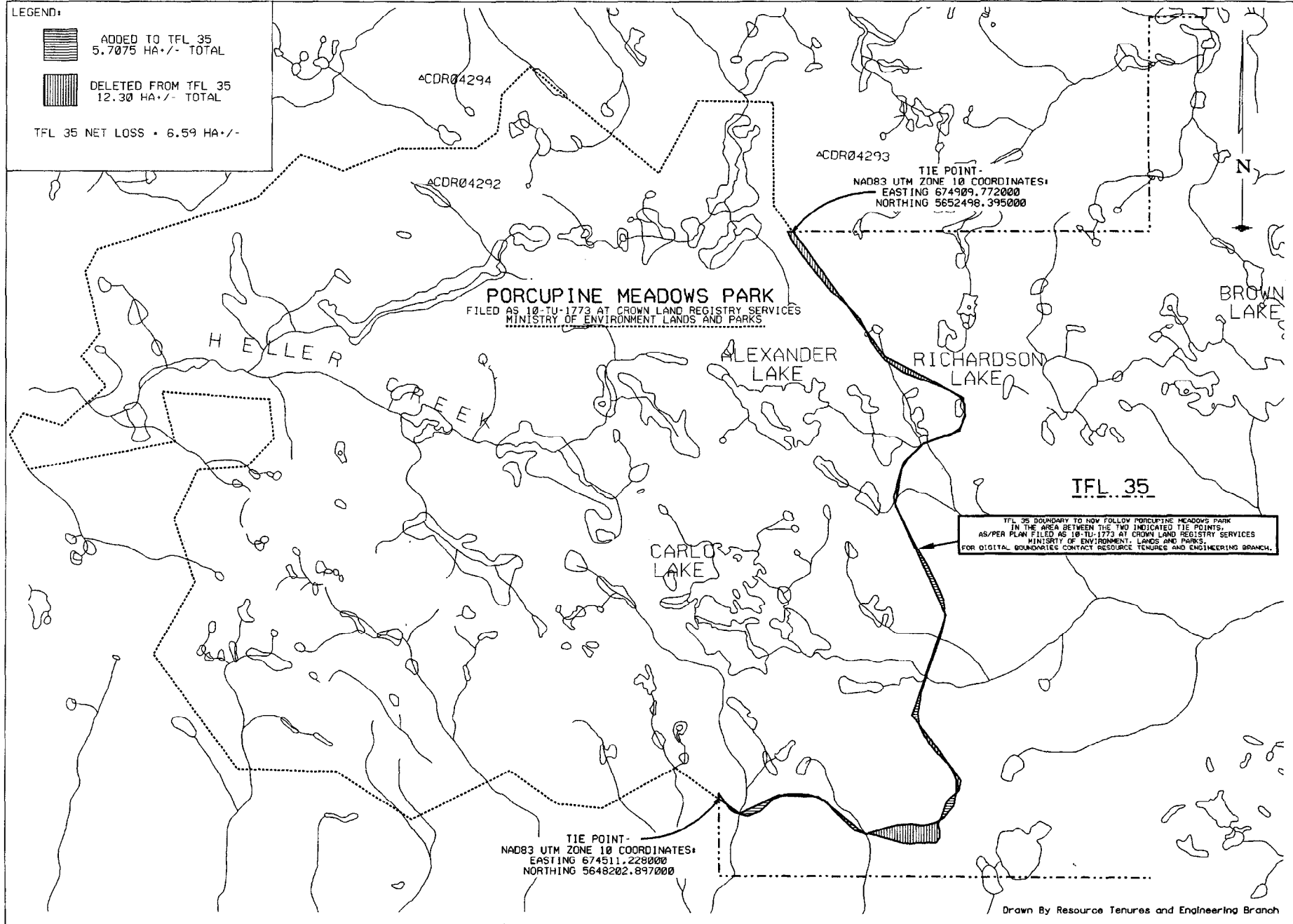

Drawn By Resource Tenures and Engineering Branch