

COPY

PROVINCE OF BRITISH COLUMBIA

Ministry of Forests

IN THE MATTER OF TREE FARM LICENCE NUMBER 26

INSTRUMENT NUMBER 26

Amendment

THIS AGREEMENT is made effective September 16, 1991.

BETWEEN:

THE MINISTER OF FORESTS OF BRITISH COLUMBIA on behalf of HER MAJESTY THE QUEEN IN RIGHT OF THE PROVINCE OF BRITISH COLUMBIA

(the "Licensor")

OF THE FIRST PART

AND:

THE CORPORATION OF THE DISTRICT OF MISSION, a British Columbia company of P.O. Box 20, 8645 Stave Lake Street Mission, British Columbia V2V 4L9

(the "Licensee")

OF THE SECOND PART

WHEREAS:

- A. The Licensor and Licensee have entered into Tree Farm Licence Number 26 (the "TFL"), dated July 22, 1979, pursuant to Section 33 of the Forest Act of British Columbia; and
- B. The parties have mutually agreed to amend the said Agreement, pursuant to Section 31(2) of the Forest Act.

THIS AGREEMENT WITNESSES that, in consideration of the One Dollar (\$1) and other good and valuable consideration paid by the Licensee to the Licensor (the receipt and sufficiency of which the Licensor acknowledges), the parties agree as follows:

The lands described below are hereby incorporated in Schedule "B" of Tree Farm Licence Number 26 and the said lands so incorporated are and shall be henceforth part of and subject to the said Tree Farm Licence Number 26;

Block 1 described as follows: Commencing at a point, said point being 1.610 kilometres north and 2.487 kilometres east of the southwest corner of the southeast quarter of Section 12, Township 4, Range 4, W7M, New Westminster Land District, also being a point on the northerly boundary of Timber Berth 79; thence south 500 metres; thence west 500 metres; thence north 500 metres, more or less, to the northerly boundary of aforesaid Timber Berth 79; thence easterly along the northerly boundary of said Timber Berth 79, to the point of commencement.

Block 2 described as follows: Commencing at the southwest corner of Timber Berth 346, New Westminster Land District; thence northerly along the westerly boundary of said Timber Berth 346 402 metres; thence east 750 metres; thence north 684 metres; thence west 483 metres; thence north 161 metres; thence east 141 metres; thence due north to the northerly boundary of aforesaid Timber Berth 346; thence easterly, northerly, easterly, southerly, westerly and southerly along the northerly, westerly, northerly, easterly, southerly and easterly boundaries of said Timber Berth 346 to a point, said being 388 metres north and 2.349 kilometres east of the southwest corner of said Timber Berth 346; thence west 1.140 kilometres; thence south 375 metres, more or less, to the southerly boundary of said Timber Berth 346; thence westerly along the southerly boundary of said Timber Berth 346 to the southwest corner thereof, being the point of commencement.

Block 3 described as follows: Commencing at the northeast corner of Timber Berth 33, Block 2, New Westminster Land District, also being a point on the natural boundary of Stave Lake on the westerly shore thereof; thence in a general southwesterly direction along the natural boundary of said Stave Lake on the westerly shore thereof to the southerly boundary of said Timber Berth 33, Block 2; thence westerly, northerly, westerly, northeasterly along the southerly, westerly, southerly and northwesterly boundaries of said Timber Berth 33, Block 2 to a point, said point being 1.431 kilometres south and 113 metres west of the southwest corner of Timber Berth 346; thence east 295 metres; thence north 302 metres; thence east 694 metres; thence south 201 metres; thence east 408 metres; thence north 164 metres; thence west 181 metres; thence north 252 metres; thence west 210 metres; thence north 99 metres; thence west 192 metres; thence north 50 metres; thence east 570 metres, more or less, to the northwesterly boundary of aforesaid Timber Berth 33, Block 2; thence northeasterly and easterly along the northwesterly and northerly boundaries of said Timber Berth 33, Block 2 to a point said point being 393 metres south and 1.218 kilometres east of the southwest corner of Timber Berth 346; thence south 628 metres; thence east 1.400 kilometres; thence north 628 metres, more or less, to the northerly boundary of aforesaid Timber Berth 33, Block 2; thence easterly along the northerly boundary of said Timber Berth 33, Block 2 to the northeast corner thereof, being the point of commencement.

IN WITNESS to this licence, it has been signed on behalf of the Crown and it has been executed by the Licensee.

SIGNED, SEALED AND )  
DELIVERED by the )  
HONOURABLE MINISTER )  
OF FORESTS on )  
behalf of the Crown, )  
in the presence of: )  
..... )  
..... )

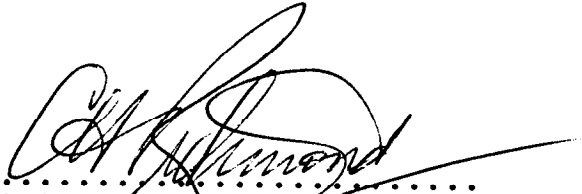
  
.....  
Minister of Forests

THE COMMON SEAL of the )  
Licensee was affixed in )  
the presence of: )  
..... )  
Authorized Signatory )  
..... )  
Title

c/s

(or)

SIGNED, SEALED AND )  
DELIVERED by the )  
Licensee in the )  
presence of: )  
..... )  
..... )  
..... )  
..... )

  
.....  
MAYOR

.....  
Authorized Signatory  
..CLERK (Acting)   
Title



# INSTRUMENT NO. 26 TO TFL 26

Province of  
British Columbia

MAP OF

MAP 1 of 3

U.T.M.

GRID

Zone	East			North			Reg	Compt	L										
1	0	5	4	4	0	0	0	5	4	5	9	0	0	0	0	9	0	1	8

## EXHIBIT 'A'

Date 91-09-12

Ref. Map 92G.028,029

Base 92G.028,029 THB

Scale 1: 20 000

Total Area 1215.00 ha ±

FOREST REGION 01 VANCOUVER

LAND DISTRICT 61 NEW WESTMINSTER

DISTRICT 11 CHILLIWACK

OUTLINE

MANAGEMENT UNIT		TIMBER SUPPLY AREA		PULPWOOD AGREEMENT	CASCADES
Type	OT	Number			
Number		Block			East
Block		Sub-B			West C

KEY MAP ONLY-TO BE USED IN CONJUNCTION WITH THE LEGAL DESCRIPTION

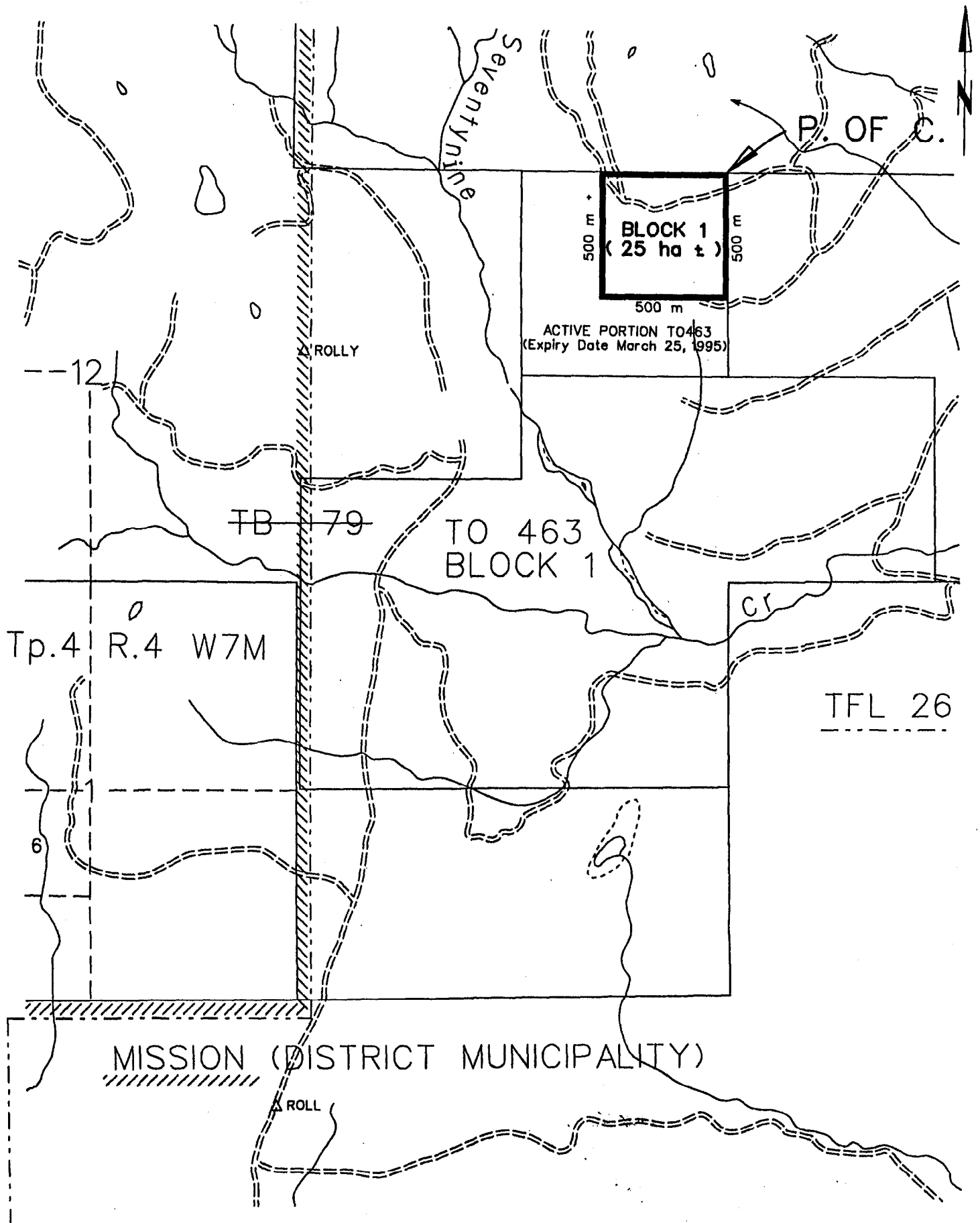



Province of  
British Columbia  
Ministry of  
Forests

INSTRUMENT NO. 26 TO TFL  
MAP 2 of 3

MAP OF

U.T.M.

GRID

Zone	East			North			Reg	Compt	L										
1	0	5	4	8	0	0	0	5	4	6	5	0	0	0	0	9	0	1	1

FOREST REGION 01 VANCOUVER

LAND DISTRICT 61 NEW WESTMINSTER

DISTRICT 11 CHILLIWACK

OUTLINE

EXHIBIT 'A'

Date 91-09-12

Ref. Map 92G.039

Base 92G.039 THB

Scale 1: 20 000

Total Area 1215.00 ha ±

MANAGEMENT UNIT		TIMBER SUPPLY AREA		PULPWOOD AGREEMENT	CASCADES
Type	OZ	Number			
Number		Block			East
Block		Sub-B			West C

KEY MAP ONLY-TO BE USED IN CONJUNCTION WITH THE LEGAL DESCRIPTION.

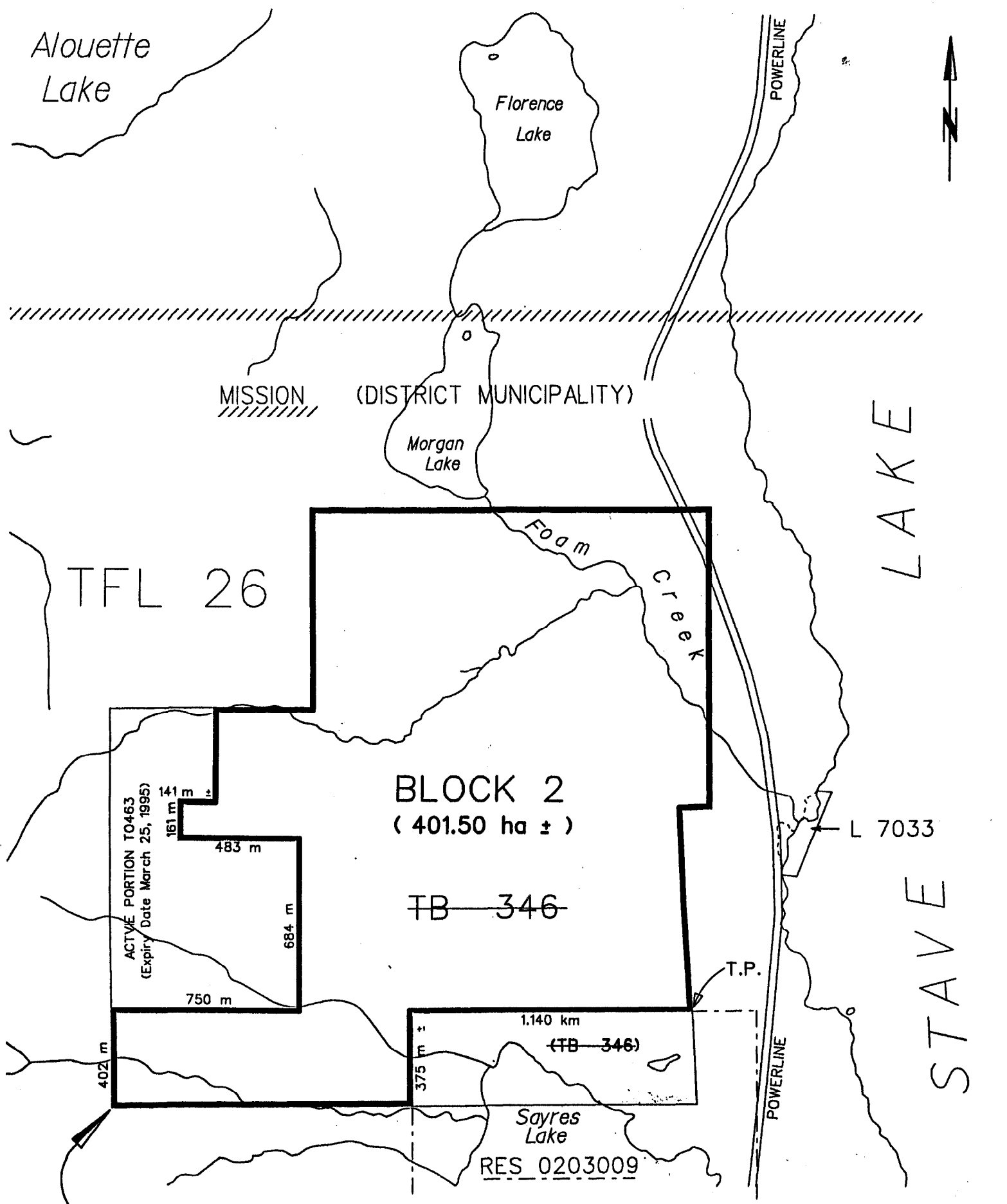

P. of C.

Drawn By Timber Harvesting Branch: KBC



Province of  
British Columbia  
Ministry of  
Forests

INSTRUMENT NO. 26 TO TFL 26  
MAP 3 of 3

MAP OF

U.T.M.

GRID

Zone	East			North			Reg	Compt	L	
10	54	90	00	05	46	10	00	09	01	1

FOREST REGION 01 VANCOUVER

LAND DISTRICT 61 NEW WESTMINSTER

DISTRICT 11 CHILLIWACK

OUTLINE

EXHIBIT 'A'

Date 91-09-12

Ref. Map 92G.029,.039

Base 92G.029,.039 THB

Scale 1: 20 000

Total Area 1215.00 ha ±

MANAGEMENT UNIT		TIMBER SUPPLY AREA		PULPWOOD AGREEMENT	CASCADES
Type	OT	Number			
Number		Block			East
Block		Sub-B			West C

KEY MAP ONLY - TO BE USED IN CONJUNCTION WITH THE LEGAL DESCRIPTION

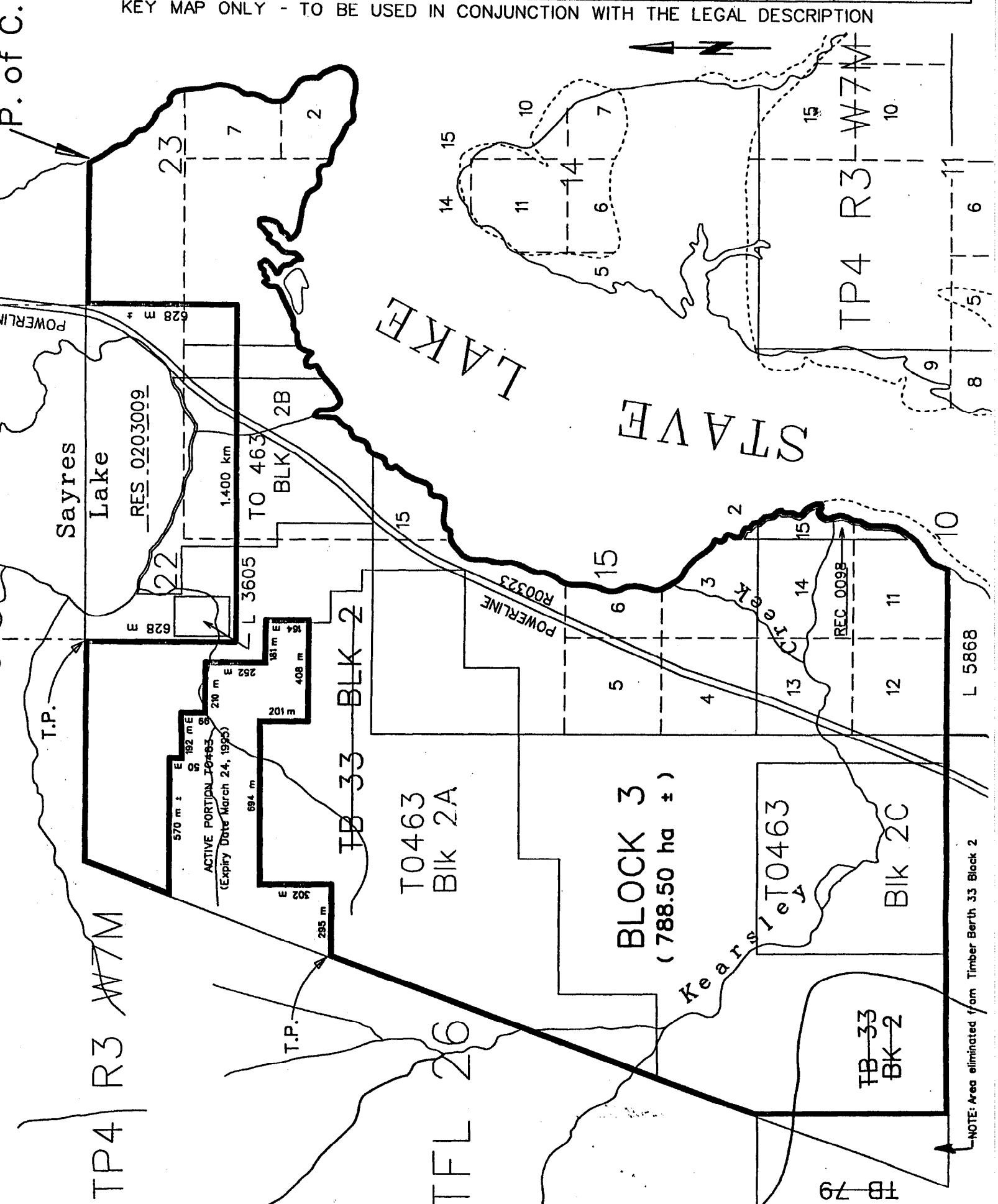

Drawn By Timber Harvesting Branch: KBC