

COPY

PROVINCE OF BRITISH COLUMBIA

Ministry of Forest

IN THE MATTER OF TREE FARM LICENCE NUMBER 25

INSTRUMENT NUMBER 48

Amendment

Whereas the lands described hereinafter are within Tree Farm Licence Number 25 and are found to be suitable for a higher economic use than the growing of forest crops;

And whereas the Licensee has requested the withdrawal of the aforementioned lands from Schedule "A" of the said Tree Farm Licence;

Therefore pursuant to clause 1.04(a) of the said Tree Farm Licence, the following lands are herewith withdrawn from the lands described in Schedule "A" of the said Tree Farm Licence Number 25; namely, those parcels or tracts of land being more particularly shown in bold black on the plan attached hereto and described as follows:

"That portion of Section 3, Renfrew Land District, adjacent to the southwest corner and lying west of the left bank of the Jordan River, containing 2.0335 ha",

and the said lands so withdrawn are and shall be henceforth no longer part of or subject to the said Tree Farm Licence Number 25.

Dated at the City of Victoria in the Province of British Columbia this 11th day of July , 1983.

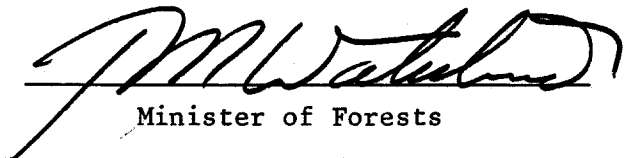
Minister of Forests



Province of British Columbia
 Ministry of Forests
 FOREST SERVICE

EXHIBIT A

Date JUNE 10, 1983
 Ref. Map 92C/SE
 Base 92C/8h
 Scale 1 : 31,680

Map Of **INSTRUMENT NO.48 DELETION FROM TREE FARM LICENCE NO.25**

Outlined Area 2.034 hectares ± Forest Region VANCOUVER

U.T.M. Zone	East	North	Reg.	Compt.	L	District
104223000	5364500	006001	C			DUNCAN
Grid						Land District <u>RENFREW</u>

MANAGEMENT UNIT		TIMBER SUPPLY AREA		Pulpwood Agreement	Cascades	
Type	T	Number			East	West
Number	25	Block				
Block		Sub-B				

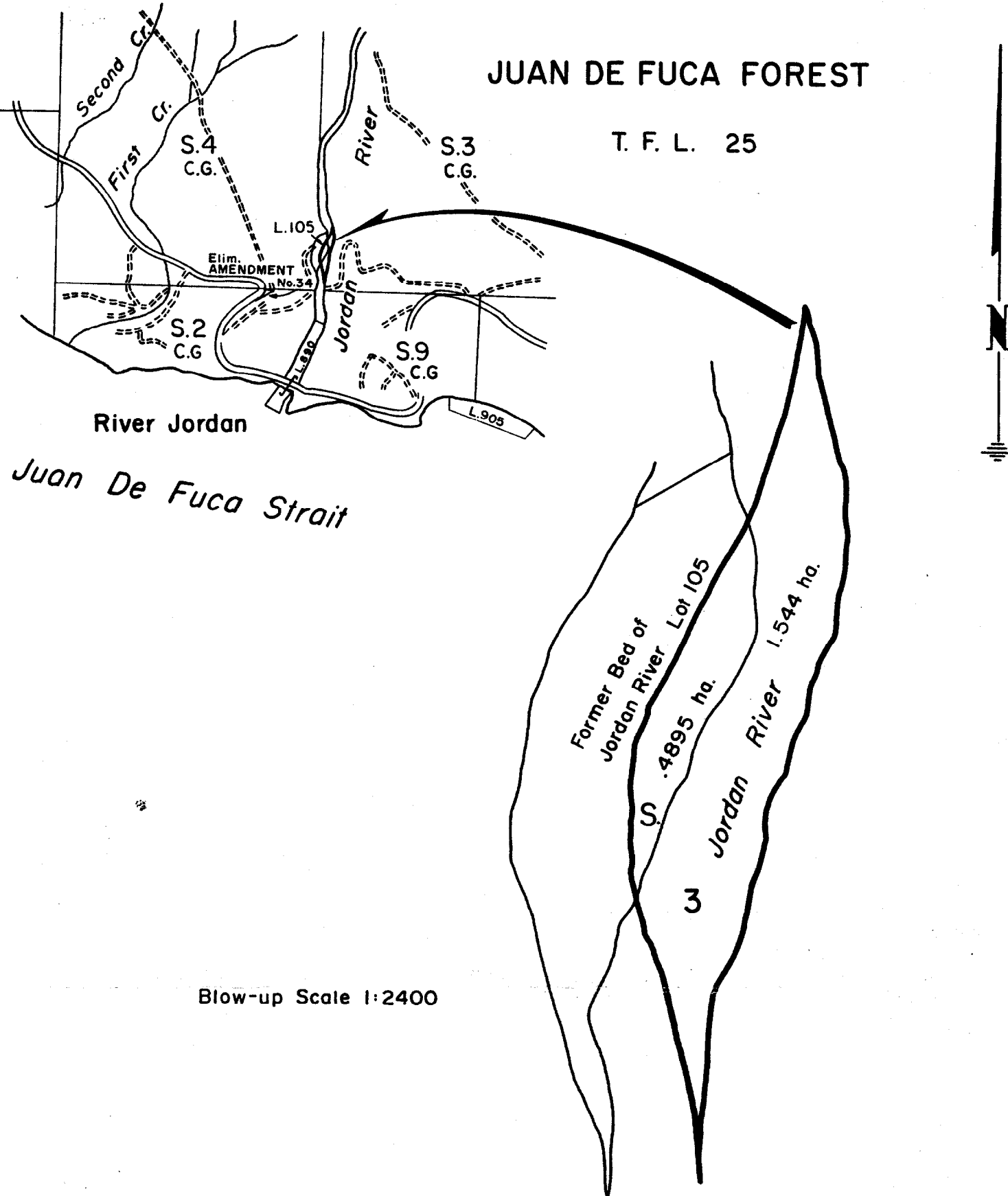

Blow-up Scale 1:2400