

GOLF 4

PROVINCE OF BRITISH COLUMBIA  
Department of Lands, Forests, and Water Resources  
FOREST SERVICE

IN THE MATTER OF TREE FARM LICENCE NUMBER 25  
AMENDMENT NO. 24

Whereas notice has been received from Rayonier Canada (B.C.)  
Limited, Licensee of Tree Farm Licence Number 25, that it has acquired  
title to the following lands:

<u>Description</u>	<u>Land District</u>	<u>Certificate of Title No.</u>	<u>Acreage</u>
Block 1172	Malahat	331715-I	16.0
Block 1173	Malahat	331715-I	94.0 +
Block 909	Malahat	343126-I	249.0 -
Block 977	Malahat	343127-I	500.8
Block 980	Malahat	343128-I	482.6
Block 1027	Malahat	343129-I	60.3+
Block 1143	Malahat	343130-I	167.2 +
Block 1184	Malahat	343131-I	548.9 +
Block 984	Malahat	345706-I	50.0 -
Block "B" of Lot 102 & Block "A" of Sec. 91	Renfrew	349150-I	156.5

and whereas the said lands are situated within the watersheds and drainage  
basins specified in Clause 8 of the said Tree Farm Licence.

Therefore pursuant to Subsection (9) Section 36 of the Forest  
Act being Chapter 153 of the Revised Statutes of British Columbia 1960  
and pursuant to Clause 7 of the said Tree Farm Licence Number 25 the  
lands described above are hereby incorporated in Schedule "A" of the  
said Tree Farm Licence Number 25 and the said lands so incorporated are  
and shall be henceforth part of and subject to the said Tree Farm  
Licence Number 25.

Dated at the City of Victoria in the Province of British  
Columbia this 16<sup>th</sup> day of NOVEMBER, 1964.

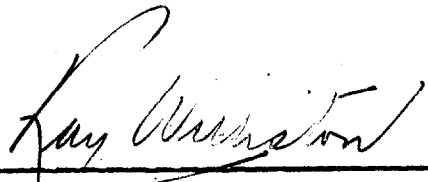

Minister of Lands, Forests, and Water Resources

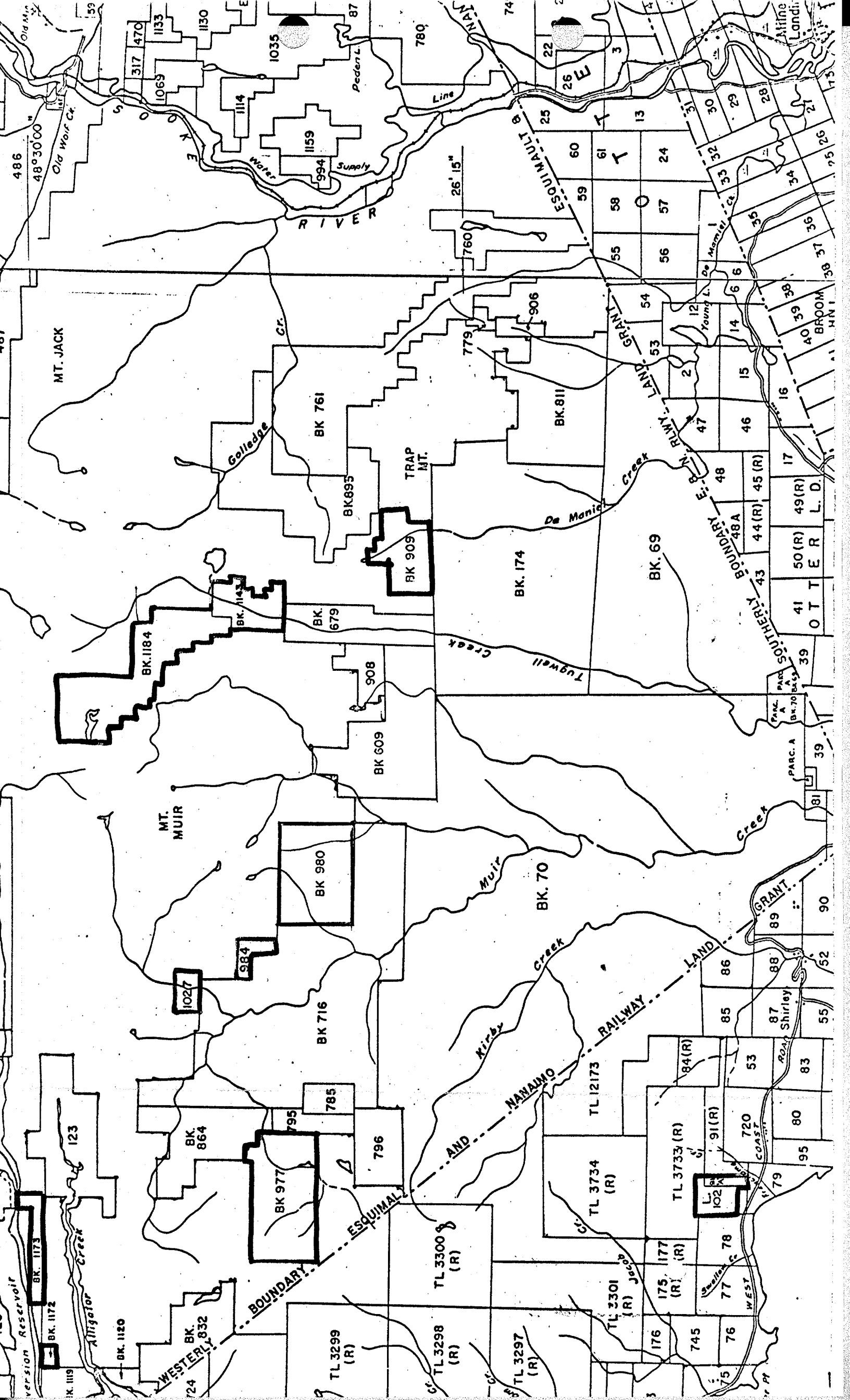

486  
48°30'00"  
Old Wolf Cr.  
317 470  
1069  
1133  
1130

MT. JACK

Colledge Cr.

BK. 1184  
BK. 1143

BK. 609  
908

MT. MUIR

1027  
9184

BK. 980

BK. 716

BK. 1173  
BK. 1172  
BK. 1119  
BK. 1120  
BK. 864  
BK. 832

1035  
1159  
994  
Water Supply  
Pedon L. 87  
780

BK. 761  
BK. 895  
TRAP MT.  
BK. 909

BK. 174  
BK. 811

BK. 70  
Muir Creek  
Kirby Creek

BK. 977  
795  
785  
796

TL 3299 (R)  
TL 3298 (R)  
TL 3297 (R)

ESQUIMALT RIVER  
Line  
26' 15"

ESQUIMALT BOUNDARY  
779  
760

De Manick Creek  
Tugwell Creek

ESQUIMALT AND NANAIMO RAILWAY

TL 12173  
TL 3734 (R)  
TL 3733 (R)

TL 2301 (R)  
TL 175 177 (R)  
TL 745  
TL 76  
TL 77  
TL 78  
TL 79

ESQUIMALT B  
25  
26  
E  
3  
13

LAND GRANT  
53  
54  
55  
56  
57  
58  
59  
60  
61  
T

BK. 69  
44 (R)  
45 (R)  
48  
49 (R)  
50 (R)  
51

GRANT  
85  
86  
87  
88  
89  
90

TL 102  
78  
77  
76  
75  
74  
73  
72  
71  
70  
69  
68  
67  
66  
65  
64  
63  
62  
61  
60  
59  
58  
57  
56  
55  
54  
53  
52  
51  
50  
49  
48  
47  
46  
45  
44  
43  
42  
41  
40  
39  
38  
37  
36  
35  
34  
33  
32  
31  
30  
29  
28  
27  
26  
25  
24  
23  
22  
21  
20  
19  
18  
17  
16  
15  
14  
13  
12  
11  
10  
9  
8  
7  
6  
5  
4  
3  
2  
1

WEST COAST  
SHIRLEY ROAD  
PARC. A  
PARC. B  
BROOM HILL

ESQUIMALT BOUNDARY  
De Manick Cr.  
Young L.

ESQUIMALT BOUNDARY  
SOUTHERLY BOUNDARY

ESQUIMALT BOUNDARY  
SOUTHERLY BOUNDARY

ESQUIMALT BOUNDARY  
SOUTHERLY BOUNDARY

ESQUIMALT BOUNDARY  
SOUTHERLY BOUNDARY

ESQUIMALT BOUNDARY  
SOUTHERLY BOUNDARY

ESQUIMALT BOUNDARY  
SOUTHERLY BOUNDARY

ESQUIMALT BOUNDARY  
SOUTHERLY BOUNDARY

ESQUIMALT BOUNDARY  
SOUTHERLY BOUNDARY

ESQUIMALT BOUNDARY  
SOUTHERLY BOUNDARY

ESQUIMALT BOUNDARY  
SOUTHERLY BOUNDARY

ESQUIMALT BOUNDARY  
SOUTHERLY BOUNDARY