

COPY

PROVINCE OF BRITISH COLUMBIA

Department of Lands, Forests, and Water Resources

FOREST SERVICE

IN THE MATTER OF TREE FARM LICENCE NUMBER 25

AMENDMENT NO. 22

Notice has been received to the effect that Rayonier Canada (B.C.) Limited Licensee of Tree Farm Licence Number 25, has acquired title to the following lands:

"Block 1114, Malahat District, 92.5 acres.	C. of T. 333637-I
Block 1130, Malahat District, 194.0 acres.	C. of T. 337509-I
Block 1133, Malahat District, 68.9 acres.	C. of T. 337509-I
Block 1156, Malahat District, 68.7 acres.	C. of T. 337509-I
Block 1159, Malahat District, 185.0 acres.	C. of T. 333638-I
Section 16, Township 3, Rupert District, 640 acres.	C. of T. 338249-I
Section 21, Township 2, Rupert District, 638 acres.	C. of T. 338250-I
North half of Section 16, Township 2, Rupert District,	C. of T. 338251-I"

which are located within the Watersheds or Drainage basins specified in Clause 8 of the said Tree Farm Licence Number 25, the lands described above are pursuant to Subsection (9) of Section 36 of the Forest Act being Chapter 153 of the Revised Statutes of British Columbia and Clause 7 of the said Tree Farm Licence Number 25, and incorporated in Schedule "A" thereof, and all the said lands are subject to the said Tree Farm Licence.

Dated at the City of Victoria in the Province of British Columbia this... 17TH.....day of.... APRIL....., 1964.

Ray Allison

Minister of Lands, Forests, and Water Resources

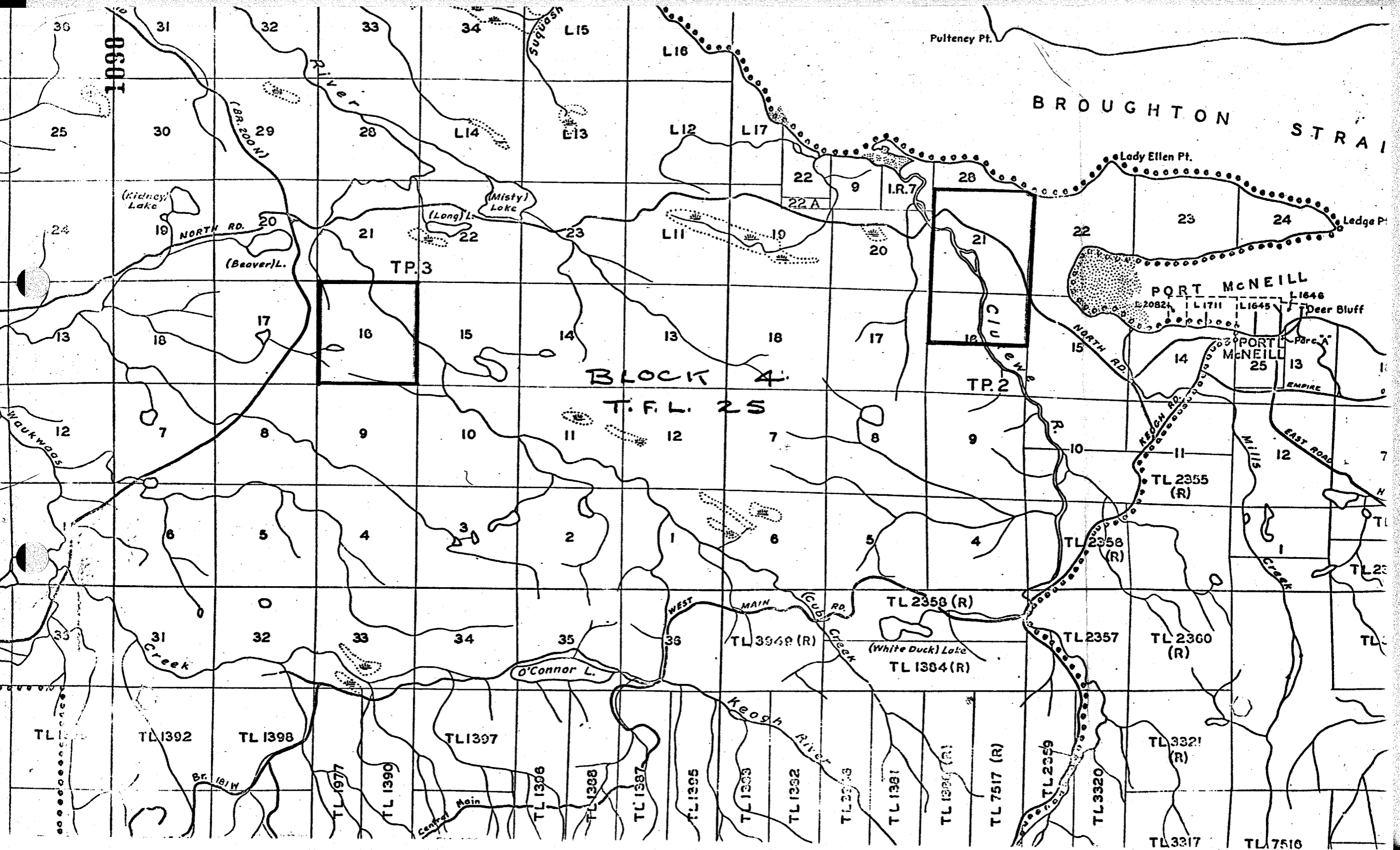

1898

BROUGHTON STRAIT

BLOCK 4
T.F.L. 25

TP.3

TP.2

PORT McNEILL

PORT McNEILL

Pultency Pt.

Lady Ellen Pt.

Ledge Pt.

Deer Bluff

EMPIRE

EAST ROAD

CLARK

TL 3321 (R)

TL 3321 (R)

TL 3320

TL 7517 (R)

TL 1390 (R)

TL 1391

TL 1393

TL 1392

TL 1393

TL 1395

TL 1387

TL 1398

TL 1396

TL 1397

TL 1398

TL 1392

TL 1392

TL 3317

TL 7510

TL 2358 (R)

TL 3948 (R)

TL 1384 (R)

TL 2358 (R)

TL 2357

TL 2360 (R)

TL 3321 (R)

TL 3317

TL 7510

NORTH RD.

(Beaver)L.

(Kidney) Lake

(Long)L.

(Misty) Lake

L15

L16

L12

L17

L14

L13

22

9

I.R.7

28

22A

L11

19

20

22

23

24

17

21

15

14

13

18

17

15

14

13

18

16

15

14

13

18

17

10

9

11

11

12

13

18

16

15

14

13

18

17

10

9

11

11

12

7

8

9

10

11

12

7

8

9

10

11

12

6

5

4

3

2

1

6

5

4

3

2

1

31

32

33

34

35

36

TL 3948 (R)

TL 2358 (R)

TL 1384 (R)

TL 2357

TL 2360 (R)

TL 3321 (R)

TL 1392

TL 1398

TL 1399

TL 1397

TL 1396

TL 1398

TL 1387

TL 1395

TL 1393

TL 1392

TL 1393

TL 1391

TL 1390 (R)

TL 1977

TL 1399

TL 1397

TL 1396

TL 1398

TL 1387

TL 1395

TL 1393

TL 1392

TL 1393

TL 1391

TL 1390 (R)

TL 1977

TL 1399

TL 1397

TL 1396

TL 1398

TL 1387

TL 1395

TL 1393

TL 1392

TL 1393

TL 1391

TL 1390 (R)

TL 1977

TL 1399

TL 1397

TL 1396

TL 1398

TL 1387

TL 1395

TL 1393

TL 1392

TL 1393

TL 1391

TL 1390 (R)

TL 1977

TL 1399

TL 1397

TL 1396

TL 1398

TL 1387

TL 1395

TL 1393

TL 1392

TL 1393

TL 1391

TL 1390 (R)

TL 1977

TL 1399

TL 1397

TL 1396

TL 1398

TL 1387

TL 1395

TL 1393

TL 1392

TL 1393

TL 1391

TL 1390 (R)

TL 1977

TL 1399

TL 1397

TL 1396

TL 1398

TL 1387

TL 1395

TL 1393

TL 1392

TL 1393

TL 1391

TL 1390 (R)

TL 1977

TL 1399

TL 1397

TL 1396

TL 1398

TL 1387

TL 1395

TL 1393

TL 1392

TL 1393

TL 1391

TL 1390 (R)

TL 1977

TL 1399

TL 1397

TL 1396

TL 1398

TL 1387

TL 1395

TL 1393

TL 1392

TL 1393

TL 1391

TL 1390 (R)

TL 1977

TL 1399

TL 1397

TL 1396

TL 1398

TL 1387

TL 1395

TL 1393

TL 1392

TL 1393

TL 1391

TL 1390 (R)

TL 1977

TL 1399

TL 1397

TL 1396

TL 1398

TL 1387

TL 1395

TL 1393

TL 1392

TL 1393

TL 1391

TL 1390 (R)

TL 1977

TL 1399

TL 1397

TL 1396

TL 1398

TL 1387

TL 1395

TL 1393

TL 1392

TL 1393

TL 1391

TL 1390 (R)

TL 1977

TL 1399

TL 1397

TL 1396

TL 1398

TL 1387

TL 1395

TL 1393

TL 1392

TL 1393

TL 1391

TL 1390 (R)

TL 1977

TL 1399

TL 1397

TL 1396

TL 1398

TL 1387