

COPY

PROVINCE OF BRITISH COLUMBIA

Department of Lands and Forests

FOREST SERVICE

IN THE MATTER OF TREE FARM LICENCE NUMBER 23

AMENDMENT NO. 34

Whereas a small parcel of Crown land adjacent to Staubert Lake, Kootenay Land District containing 14 acres, more or less is found to be suitable for a higher economic use than the growing of forest products and whereas the withdrawal of the aforementioned lands in no way affects the sustained yield management of the said Tree Farm Licence.

Therefore pursuant to Subsection (14) of Section 36 of the "Forest Act" being Chapter 153 of the Revised Statutes of British Columbia 1960 and Clause 10 of the said Tree Farm Licence the following lands are herewith withdrawn from the lands described in Schedule "B" of the said Tree Farm Licence being more particularly shown outlined in red on the attached sketch and described as follows:

"Commencing at a point on the edge-of-the-bed of Staubert Lake, said point being 4 chains south and 4 chains east of the southeast corner of Lot 12899 Kootenay Land District; thence due east a distance of 1 chain more or less to the south boundary of the Beaton-Trout Lake highway; thence southeasterly along the said south boundary of the highway to a point 21 chains south and 34 chains east of aforesaid southeast corner of Lot 12899; thence due south a distance of 1 chain more or less to the northerly edge-of-the-bed of Staubert Lake; thence in a general northwesterly direction along the said northerly edge-of-the-bed of Staubert Lake to the point of commencement and containing 14 acres more or less."

and the said lands so withdrawn are and shall be henceforth no longer subject to or form any part of the said Tree Farm Licence.

Dated at Victoria in the Province of British Columbia thisth day of ...*MAY*....., 1961.

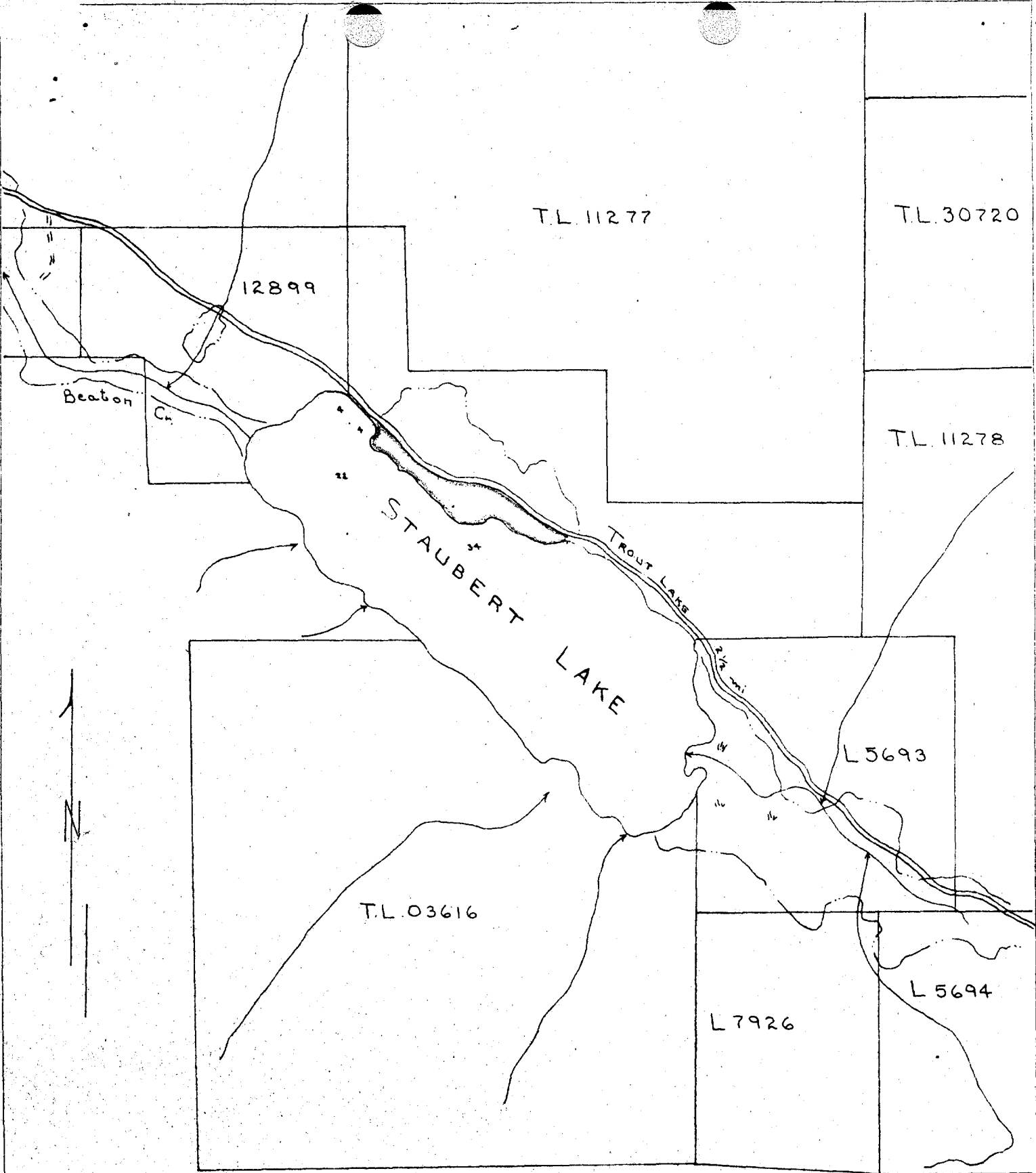

* * B.C. PROVINCIAL PARKS BRANCH * * DEPARTMENT OF RECREATION AND CONSERVATION			
STAUBERT LAKE		P512J	
L.D.: KOOTENAY		Scale: 1 IN = 20 CHS	
Date: 17-12-60	R.M.: 82K/12 E	Mapper: <i>[Signature]</i>	
Source: Int Base: 82K/12 E		Map. No.:	
Photos: - 1342 - 110 - 111			