

COPY

PROVINCE OF BRITISH COLUMBIA
Department of Lands and Forests
FOREST SERVICE

IN THE MATTER OF TREE FARM LICENCE NUMBER 23

AMENDMENT NO. 12

Whereas part of Lot 5817, Kootenay Land District, is within Tree Farm Licence Numbered 23 and is found to be suitable for a higher economic use and whereas the withdrawal of the aforementioned lands in no way affects the sustained yield management of the said Tree Farm Licence.

Therefore pursuant to Subsection (14) of Section 33 of the "Forest Act" being Chapter 128 of the Revised Statutes of British Columbia 1948 and Clause 10 of the said Tree Farm Licence, the following lands are herewith withdrawn from the lands described in Schedule "B" of the said Tree Farm Licence, more particularly described as follows:

"Commencing at a point 5 chains north and 5 chains west of Latitude 49° 23' 26.55" North and Longitude 118° 05' 08.2" West; thence south 10 chains; thence east 10 chains; thence north 10 chains; thence west 10 chains, more or less, to the point of commencement."

and the lands so withdrawn are and shall be henceforth no longer subject to or form any part of the said Tree Farm Licence.

Dated at Victoria in the Province of British Columbia this^{24th}..... day of^{April}....., 1958.

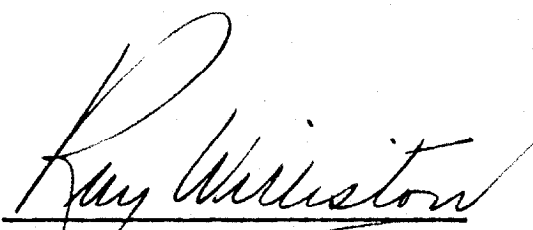
Minister of Lands and Forests

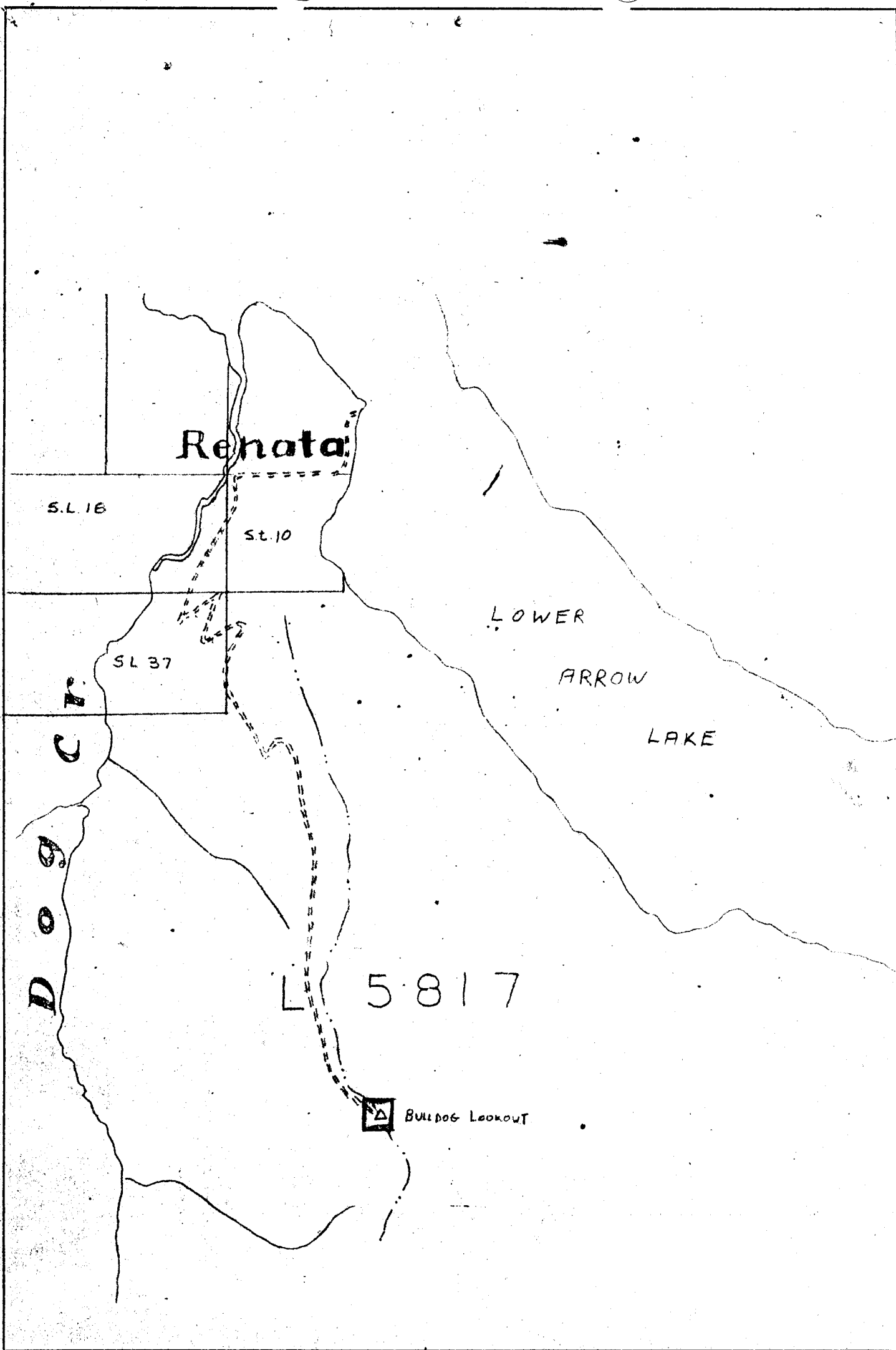

PROVINCE OF BRITISH COLUMBIA—DEPARTMENT OF LANDS AND FORESTS
 FOREST SERVICE, VICTORIA, B.C.—ENGINEERING SERVICES DIVISION

Bulldog Lookout & Access

FILE No.: 0142636	DRAWN BY:	DRAWING No.
PROJECT: 3206	APPROVED:	
SCALE: 40 chs = 1 inch	APPROVED:	

Chief Forester. DATE: May 23/58 SIZE: AA