

PROVINCE OF BRITISH COLUMBIA

Department of Lands, Forests, and Water Resources

FOREST SERVICE

---

IN THE MATTER OF TREE FARM LICENCE NUMBER 19

AMENDMENT NUMBER 40

---

Whereas the lands described hereinafter are within Tree Farm Licence Number 19 and are found to be suitable for a higher economic use than the growing of forest crops;

And whereas the withdrawal of the aforementioned lands together with any lands previously withdrawn does not diminish the productive capacity of the licence area to the extent provided in Clause 9 of the Tree Farm Licence;

Therefore pursuant to Subsection (14) of Section 36 of the Forest Act being Chapter 153 of the Revised Statutes of British Columbia, 1960, and pursuant to Clause 9 of the said Tree Farm Licence the following lands are herewith withdrawn from the lands described in Schedule "B" of the said Tree Farm Licence; namely, all that parcel or tract of land being more particularly shown in bold black on the sketch attached hereto and described as follows:

"Commencing at a point 15 chains East of the Northwest corner of Lot 82 Timber Licence 217p Nootka Land District; thence East 20 chains; thence South 60 chains; thence West 20 chains; thence North 60 chains to point of commencement containing 120 acres more or less."

and the said lands so withdrawn are and shall be henceforth no longer subject to or form any part of the said Tree Farm Licence Number 19.

Dated at the City of Victoria in the Province of British Columbia  
this . . . . . 8<sup>th</sup> . . . . . day of . . . . . MARCH . . . . . 1972.



---

Minister of Lands, Forests, and Water Resources.

Section No. 3 Compt. No. 11<sup>B</sup>  
92E/15W

BRITISH COLUMBIA  
FOREST SERVICE

EXHIBIT A  
Date 18/12/70  
Atlas Ref. 92E/NE(1-6)

### Amendment No. 40 to T.F.L. 19

Acres ± 120 R.D. 28 Scale 20 chains — 1 inch

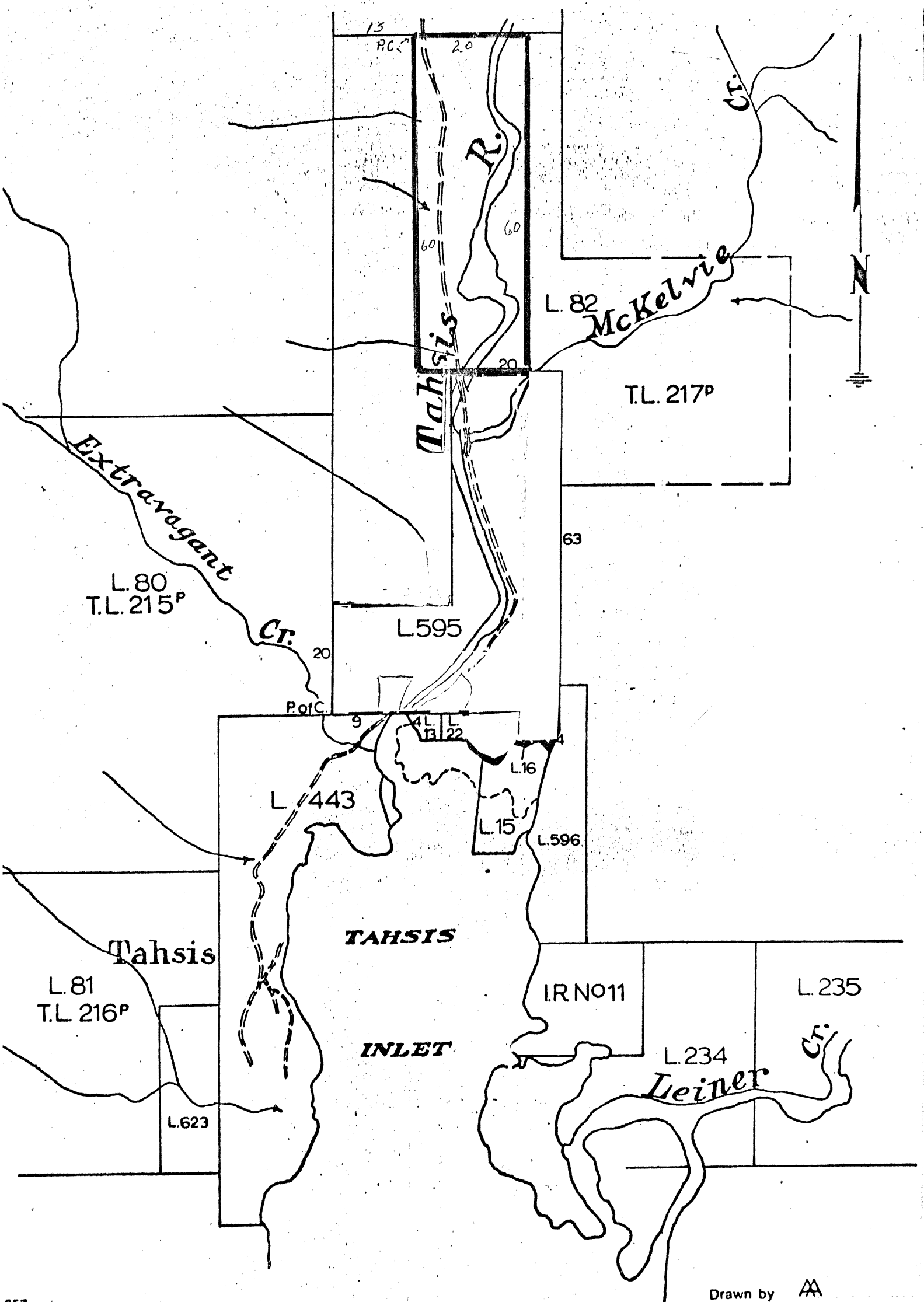

Drawn by AA