



MINISTER OF LANDS, FORESTS, AND WATER RESOURCES

VICTORIA

March 24, 1966.

Tahsis Company Ltd.,
East Asiatic House,
1201 West Pender Street,
Vancouver 1, B. C.

Attention D. Rasmussen, Chief Forester

Dear Sir:

It has come to my attention that Amendment Number 19 to Tree Farm Licence Number 19 contains an incorrect bearing in the description of lands being withdrawn from the Licence.

Therefore, the description of lands being withdrawn is hereby amended by deleting the bearing "North 89° 47' 38" East" in lines 2, 3 and 4 thereof and substituting therefor the bearing "South 89° 47' 38" West".

This letter forms an integral part of Amendment Number 19 to Tree Farm Licence Number 19 and should be attached to it.

Yours truly,

Ray Williston,
Minister.



PROVINCE OF BRITISH COLUMBIA

Department of Lands, Forests, and Water Resources

FOREST SERVICE

IN THE MATTER OF TREE FARM LICENCE NUMBER 19

AMENDMENT NUMBER 19

Whereas the lands described hereinafter are within Tree Farm Licence Number 19 and are found to be suitable for a higher economic use than the growing of forest crops (road right-of-way);

And whereas the Licensee has requested the withdrawal of the aforementioned lands from Schedule "A" of the said Tree Farm Licence;

Therefore pursuant to Subsection (14) of Section 36 of the Forest Act being Chapter 153 of the Revised Statutes of British Columbia, 1960, and pursuant to Clause 12 of the said Tree Farm Licence, the Licensor hereby consents to the withdrawal from Schedule "A" of the said Tree Farm Licence of the following lands; that part of Lot 175, Nootka Land District, shown outlined in red on the sketch attached hereto and being more particularly described as follows:

"Commencing at a point on the southerly boundary of Lot 175, Nootka Land District, said point being North $89^{\circ} 47' 38''$ East 2,832.70 feet from the northeast corner of Lot 637; thence North $89^{\circ} 47' 38''$ East along the said southerly boundary of Lot 175 a distance of 376.90 feet to the third most southerly southwest corner thereof; thence North $0^{\circ} 33' 36''$ East along the westerly boundary of said Lot 175 a distance of 333.71 feet; thence South $48^{\circ} 20' 50''$ East 500.03 feet to the point of commencement, the whole containing 2.9 acres more or less."

and the lands so withdrawn are and shall be henceforth no longer part of or subject to the said Tree Farm Licence Number 19.

Dated at the City of Victoria in the Province of British Columbia this 1st day of March 1966.



Minister of Lands, Forests, and Water Resources

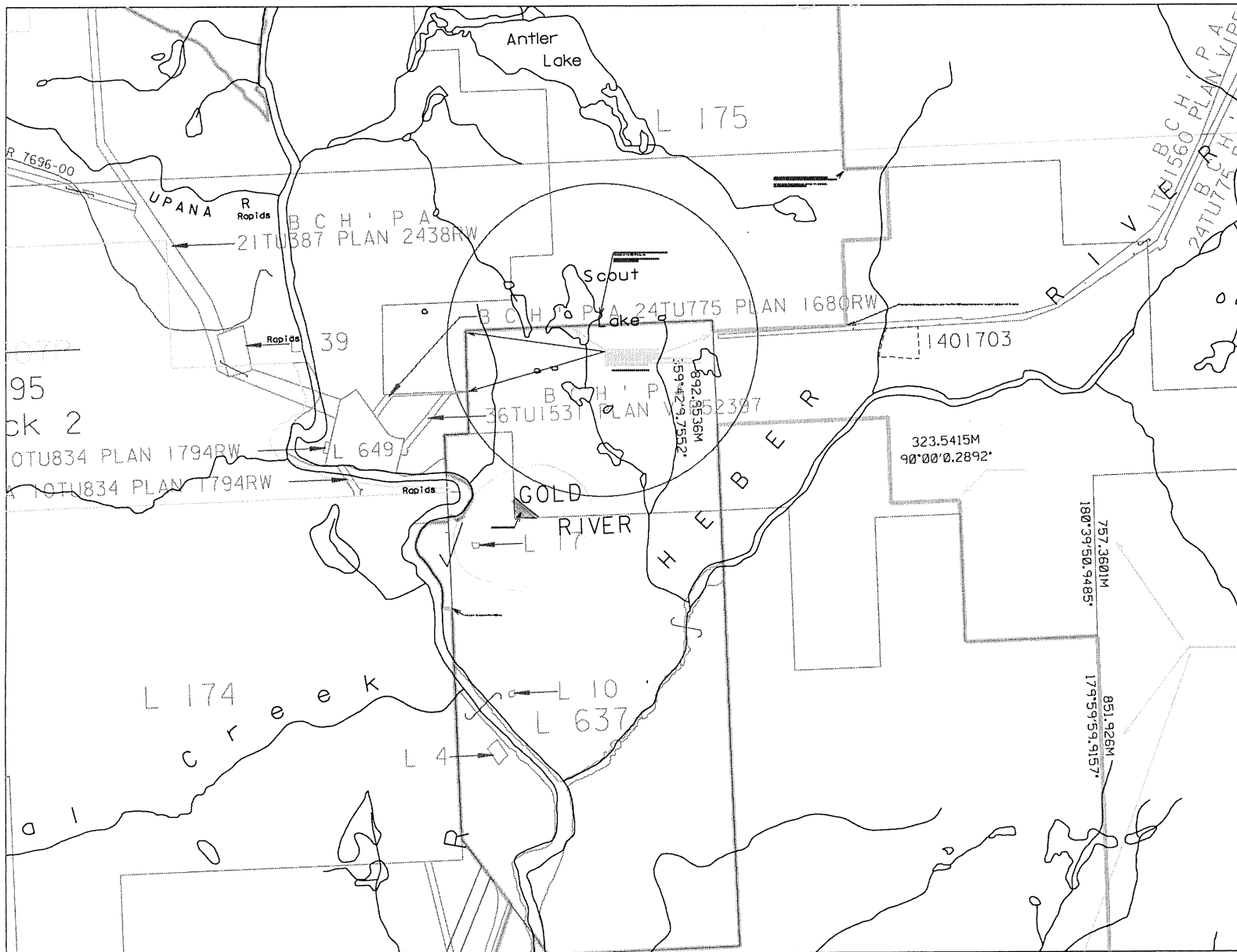

INST # 19/66

Loc. 30-36-03 R/W

