

PROVINCE OF BRITISH COLUMBIA

Department of Lands, Forests, and Water Resources

FOREST SERVICE

IN THE MATTER OF TREE FARM LICENCE NUMBER 19

AMENDMENT NUMBER 16

Whereas the lands described hereinafter are within Tree Farm Licence Number 19 and are found to be suitable for a higher economic use than the growing of forest crops;

And whereas the withdrawal of the aforementioned lands will in no way affect the sustained yield management of the said Tree Farm Licence;

Therefore pursuant to Subsection (14) of Section 36 of the Forest Act being Chapter 153 of the Revised Statutes of British Columbia, 1960, and pursuant to Clause 9 of the said Tree Farm Licence Number 19, the following lands are herewith withdrawn from the lands described in Schedule "B" of the said Tree Farm Licence; namely, all that parcel or tract of land situated in Nootka Land District being more particularly shown outlined in red on the sketch attached hereto and described as follows:-

"Commencing at a point on the westerly boundary of a road, said point being 15 chains west and 23 chains south from the southwest corner of S.T.L. 7501P; thence north 60 degrees west 12 chains more or less to the easterly boundary of a road; thence in a general northeasterly direction along the said easterly boundary of the road to the westerly boundary of the first mentioned road; thence in a general southerly direction along the said westerly boundary of the road to the point of commencement".

and the lands so withdrawn are and shall be henceforth no longer part of or subject to the said Tree Farm Licence Number 19 during the lifetime of Special Use Permit Number 5583 issued in respect of the aforementioned lands.

Dated at the City of Victoria in the Province of British Columbia this ^{27th}..... day of ^{JULY}....., 1965.

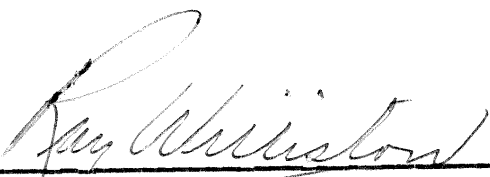

Minister of Lands, Forests, and Water Resources

Special Use Permit 5583

Situated: west of Gold River, south of Heber River

Land District: Nootka

Atlas Reference: R92 E/NE (c-10)

Scale: 10 chains = 1 inch

R.D. # 26

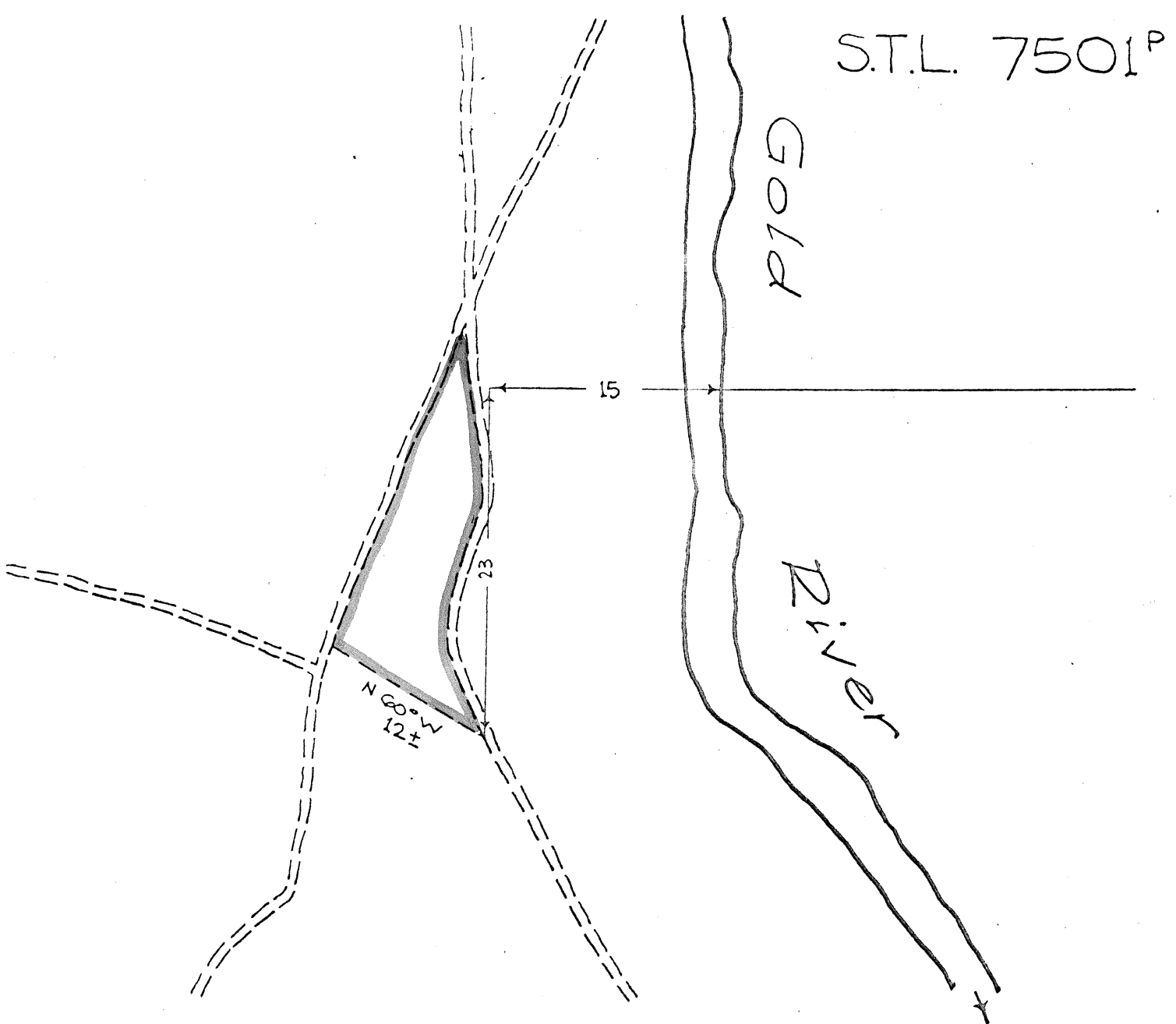

AMENDMENT NO. 16

T.F.L. NO. 19