

COPY

PROVINCE OF BRITISH COLUMBIA

Department of Lands, Forests, and Water Resources

FOREST SERVICE

IN THE MATTER OF TREE FARM LICENCE NUMBER 8

AMENDMENT NUMBER 9

Whereas Clause 5 of Tree Farm Licence Number 8 provides for any re-allocation or exchange of lands pursuant to subsection (14) of Section 36 of the Forest Act.

And whereas it is found to be beneficial to amend the description of Schedule "B" Lands as hereinafter set forth.

Therefore pursuant to Subsection (14) of Section 36 of the Forest Act being Chapter 153 of the Revised Statutes of British Columbia, 1960 and pursuant to Clause 5 of the said Tree Farm Licence Number 8 the following lands shown in bold black on the sketch marked "EXHIBIT A" attached hereto and described as follows:

"Commencing at a point on the southeast corner of Block B of Lot 4109s, Similkameen Division of Yale District; thence south 12 chains; thence west 8 chains; thence south 18 chains; thence west 42 chains; thence north 30 chains; thence east 50 chains to the point of commencement containing 136 acres more or less."

are hereby withdrawn from Schedule "B" and shall henceforth no longer be subject to or form any part of the Tree Farm Licence during the term of Special Use Permit Number 4469 issued in respect of the aforementioned area.

And the following lands shown in bold black on the sketch marked "EXHIBIT B" attached hereto and described as follows:

"Commencing at a point 5 chains east and 13 chains north of the southeast corner of Block B of Lot 4109s, Similkameen Division of Yale District being a point on the northerly boundary of Tree Farm Licence Number 8; thence north 60° east 35 chains; thence north 21 chains; thence east 14 chains; thence north 60° east 15 chains to a point on the said boundary of Tree Farm Licence Number 8; thence south 65 chains; thence west 40 chains along said Tree Farm Licence boundary to the point of commencement, containing 145 acres more or less."

are hereby added to Schedule "B" and shall henceforth be subject to and form part of said Tree Farm Licence Number 8.

Dated at the City of Victoria in the Province of British Columbia this 18<sup>th</sup> day of AUGUST, 1971.

*Ray Alliston*

Minister of Lands, Forests, and Water Resources

LAND DISTRICT S.D.Y.D.

BRITISH COLUMBIA

EXHIBIT A

Region No. Compt. No.

Date July 29 1971

Base 82 E/10e

FOREST SERVICE

Atlas Ref. 82 E/NE(c-1)

AMENDMENT NO. 9 T.F.L. NO. 8

Shown \_\_\_\_\_ Acres 136 R.D. 15 Scale 20 chains = 1 inch

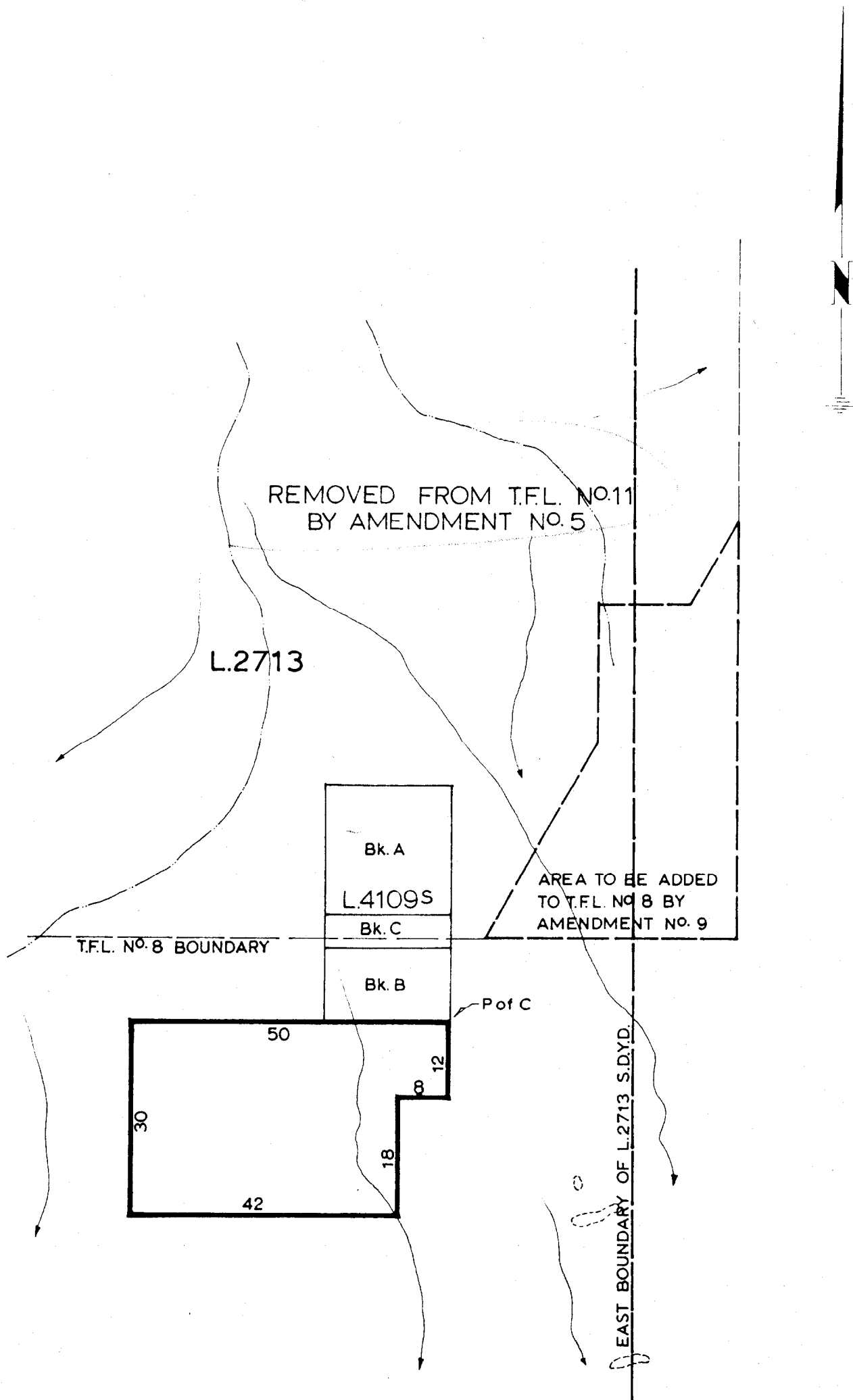

LAND DISTRICT SDYD

BRITISH COLUMBIA

EXHIBIT B

Region No. Compt. No.

Date July 29 1971

Base 82 E/10e

FOREST SERVICE

Atlas Ref. 82 E/NE(c-1)

AMENDMENT NO. 9 T.F.L. NO. 8

shown 

Acres 145

R.D. 15

Scale 20 chains = 1 inch

