

COPY

PROVINCE OF BRITISH COLUMBIA

Department of Lands, Forests, and Water Resources

FOREST SERVICE

IN THE MATTER OF TREE FARM LICENCE NUMBER 8

AMENDMENT NUMBER 8

Whereas the lands described hereinafter are within Tree Farm Licence Number 8 and are found to be required for a higher economic use than the growing of forest crops;

And whereas the withdrawal of the aforementioned lands together with any lands previously withdrawn does not diminish the productive capacity of the licence area to the extent provided in Clause 10 of the Tree Farm Licence;

Therefore pursuant to Subsection (14) of Section 36 of the Forest Act being Chapter 153 of the Revised Statutes of British Columbia, 1960 and pursuant to Clause 10 of the said Tree Farm Licence Number 8 the following lands are hereby withdrawn from the lands described in Schedule "B" of the said Tree Farm Licence, that is to say all that parcel or tract of land being more particularly shown in bold black on the sketch attached hereto marked Exhibit "A" and located on Hall Creek and part of S.L. 10 of Lot 3638, S.D.Y.D., containing 5 acres, more or less, and the said lands so withdrawn are and shall be henceforth no longer subject to or form any part of the said Tree Farm Licence Number 8.

Dated at the City of Victoria in the Province of British Columbia this 24th day of JUNE , 1971.

Kay Alliston

Minister of Lands, Forests, and Water Resources

AND DISTRICT SDYD
Region No. 24 Compt. No. 7
Case 82E 11E File



EXHIBIT A
Date June 14th 1971
Atlas Ref. 82E/NW (a-6)

AMENDMENT # 8 to T.F.L. 8.

shown _____ Acres 5 R.D. 20 Scale 40 chs 1 inch

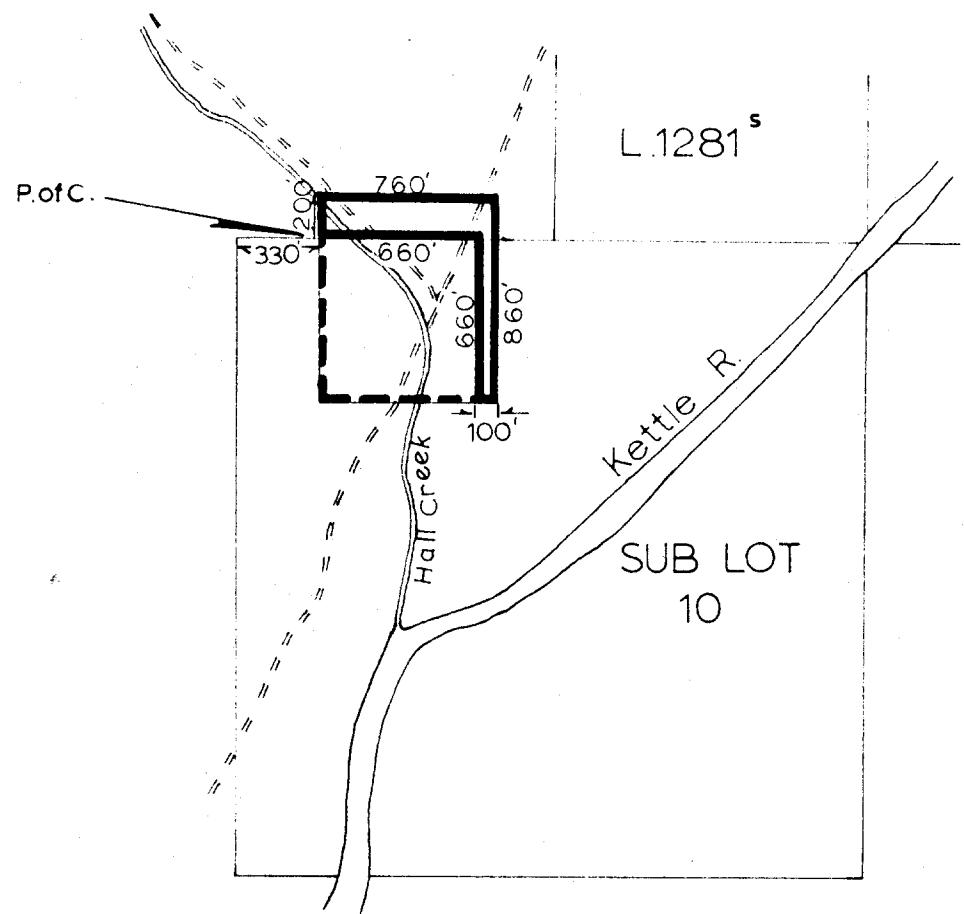
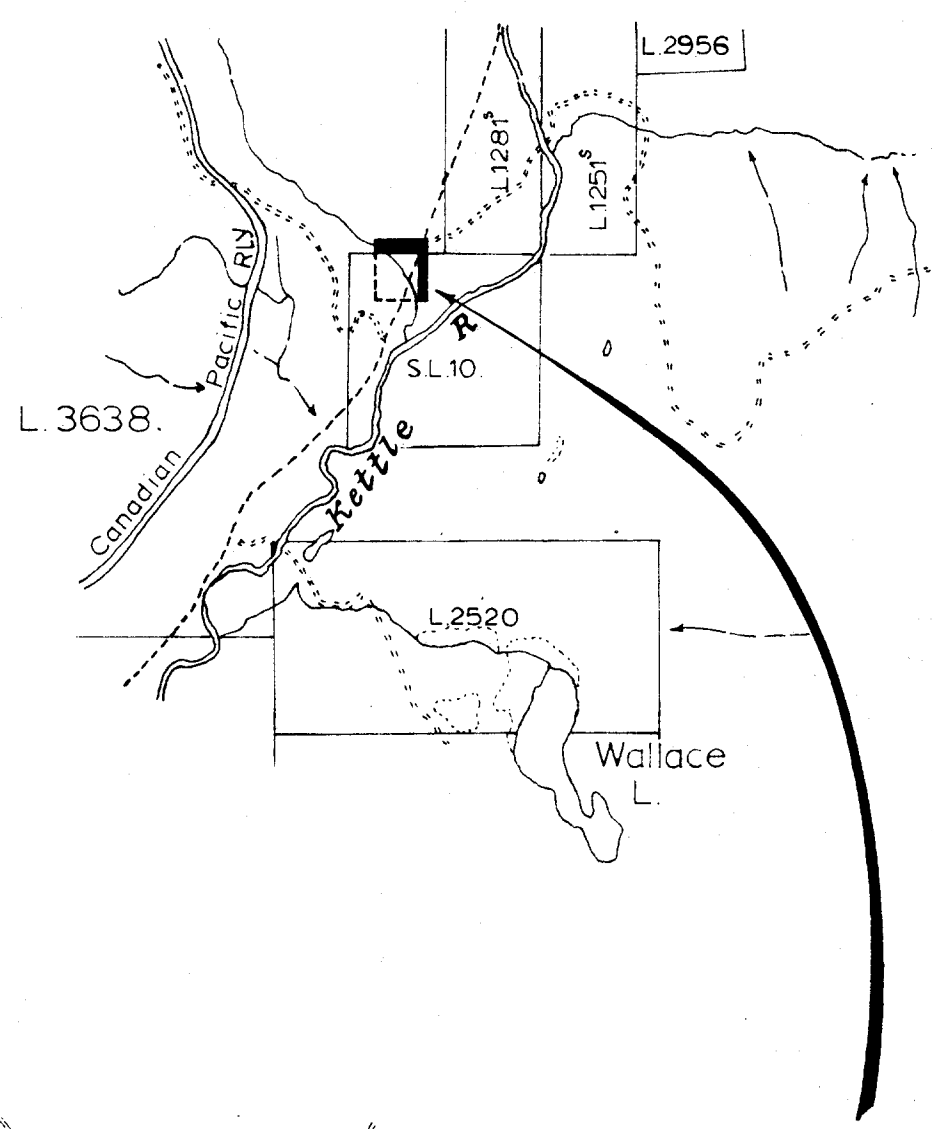

L. 3638

SCALE: 1" = 800 ft.