

PROVINCE OF BRITISH COLUMBIA
Department of Lands, Forests, and Water Resources
FOREST SERVICE

IN THE MATTER OF TREE FARM LICENCE NUMBER 6
AMENDMENT NUMBER 48

Whereas the lands described hereinafter are within Tree Farm Licence Number 6 and are found to be suitable for a higher economic use than the growing of forest crops.

And whereas the withdrawal of the aforementioned lands will in no way affect the sustained yield management of the said Tree Farm Licence.

Therefore pursuant to Subsection (14) of Section 36 of the Forest Act being Chapter 153 of the Revised Statutes of British Columbia 1960 and pursuant to Clause 14 of the said Tree Farm Licence Number 6 the following lands are hereby withdrawn from the lands described in Schedule "B" of the said Tree Farm Licence that is to say all those lands shown hatched on the sketch attached hereto and described as follows:

"That part of "Rainbow" Mineral Claim, Record Number 16975, Nanaimo Mining Division, comprising an unsurveyed area adjoining the Southwest corner of Section 1 (Formerly Quatsino District) Township 10, Rupert District, containing 12 acres, more or less."

and the said lands so withdrawn are and shall be no longer subject to or form any part of the said Tree Farm Licence.

Dated at the City of Victoria in the Province of British Columbia
this 30th day of JANUARY , 1968.

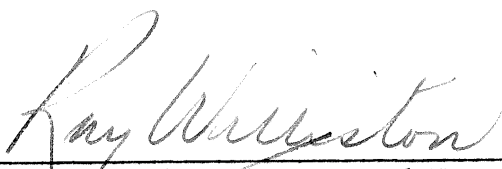

Minister of Lands, Forests, and Water Resources

BRITISH COLUMBIA
FOREST SERVICE

MAP OF AMENDMENT No 48 TO T.F.L. No 6

Situated Holberg Inlet, west of Apple Bay

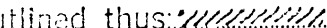
RUPERT LAND DISTRICT

Area outlined thus:  12 Acres ±

Atlas Ref. R. 924/NW (A-7) R.D. No. 16

Inventory Reg. No. 1 Compt. No. 14-D

Scale: 400 feet chains = 1 inch

Date: Dec 4th 1967

926 062

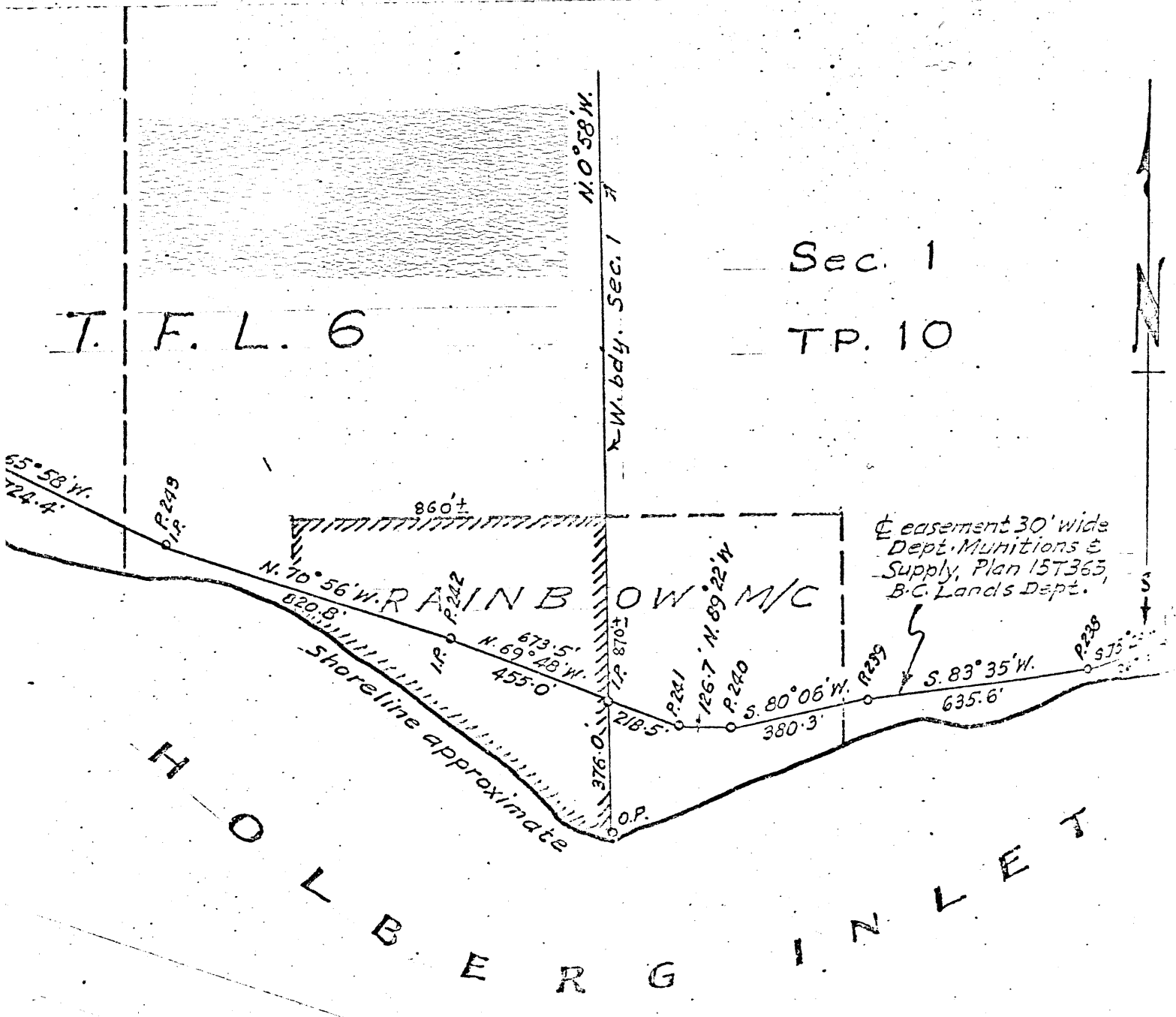

BASE: Plan 15T365
and plans on file.