

PROVINCE OF BRITISH COLUMBIA

Department of Lands, Forests, and Water Resources

FOREST SERVICE

IN THE MATTER OF TREE FARM LICENCE NUMBER 6

AMENDMENT NUMBER 41

Whereas the lands described hereinafter are within Tree Farm Licence Number 6 and are found to be suitable for a higher economic use than the growing of forest crops;

And whereas the Licensee has requested the withdrawal of the aforementioned lands from Schedule "A" of the said Tree Farm Licence;

Therefore pursuant to Subsection (14) of Section 36 of the Forest Act being Chapter 153 of the Revised Statutes of British Columbia, 1960, and pursuant to Clause 17 of the said Tree Farm Licence Number 6, the Licensor hereby consents to the withdrawal from Schedule "A" of the said Tree Farm Licence of that part of Lot 2, Section 1, Township 10, Rupert Land District, (formerly Quatsino District), Plan 11638, lying south of the southerly highwater mark of Coal Harbour, containing 0.98 acres more or less, as shown outlined in red on the sketch attached hereto and being more particularly described as follows:

"That portion of Lot 2, Section 1, Township 10, Rupert Land District, (formerly Quatsino District), Plan 11638, shown outlined in red on plan of subdivision drawn up by R.J. Durling, B.C.L.S. and sworn to on March 30th, 1963 and attached to an Indenture executed 27th day of June 1963 between Rayonier Canada (B.C.) Limited and British Columbia Telephone Company."

and the lands so withdrawn are and shall be henceforth no longer part of or subject to the said Tree Farm Licence Number 6.

Dated at the City of Victoria in the Province of British Columbia thisTH12.....day of ...~~OCTOBER~~....., 1965.

Minister of Lands, Forests, and Water Resources

PL 198

PL 289

PL 290

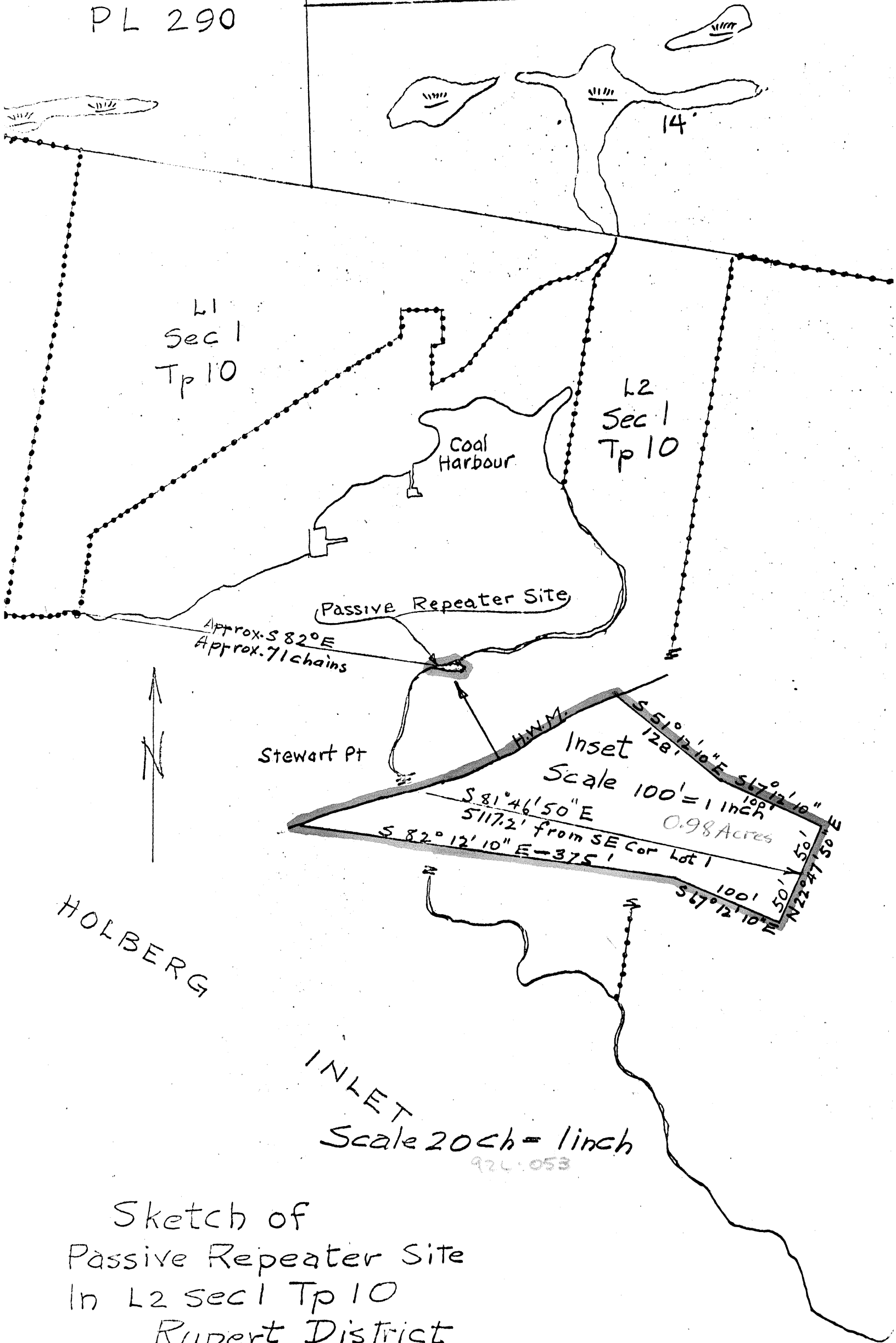

L1
Sec 1
Tp 10

L2
Sec 1
Tp 10

Coal Harbour

Passive Repeater Site

Approx. S 82° E
Approx. 71 chains



Stewart Pt

HWM

Inset

Scale 100' = 1 inch

S 81° 46' 50" E

5117.2' from SE Cor Lot 1

S 82° 12' 10" E - 375'

0.98 Acres

100'

50'

50'

50'

50'

50'

50'

50'

50'

50'

50'

50'

50'

50'

50'

50'

50'

HOLBERG

INLET

Scale 20 ch = 1 inch

924-053

Sketch of
Passive Repeater Site
In L2 sec 1 Tp 10
Rupert District