

PROVINCE OF BRITISH COLUMBIA  
Department of Lands, Forests, and Water Resources  
FOREST SERVICE

---

IN THE MATTER OF TREE FARM LICENCE NUMBER 6  
AMENDMENT NO. 28

---

Whereas a right-of-way for the purpose of removal of forest products is required over the lands described hereinafter which said lands are within Tree Farm Licence Number 6.

Therefore pursuant to Clause 15 of the said Tree Farm Licence Number 6 the following lands are herewith withdrawn from the lands described in Schedule "B" of the said Tree Farm Licence that is to say a road right-of-way being more particularly shown outlined in red on the attached sketch and described as follows:

"Commencing at a point on the south boundary of T.L. 10282<sup>P</sup> Rupert Land District, said point being approximately 500 feet west of the southeast corner of said T.L. 10282<sup>P</sup>; thence in a general southeasterly direction a distance of 2,000 feet more or less to the boundary of Tree Farm Licence Number 6."

and the said lands so withdrawn are and shall be henceforth no longer subject to or form any part of the said Tree Farm Licence.

Dated at Victoria in the Province of British Columbia  
this .....<sup>12</sup> <sup>TH</sup>..... day of ..DECEMBER....., 1962.

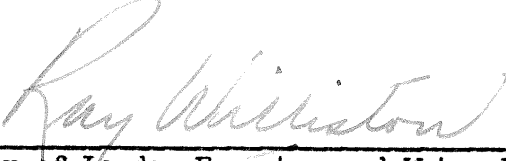
  
Minister of Lands, Forests, and Water Resources

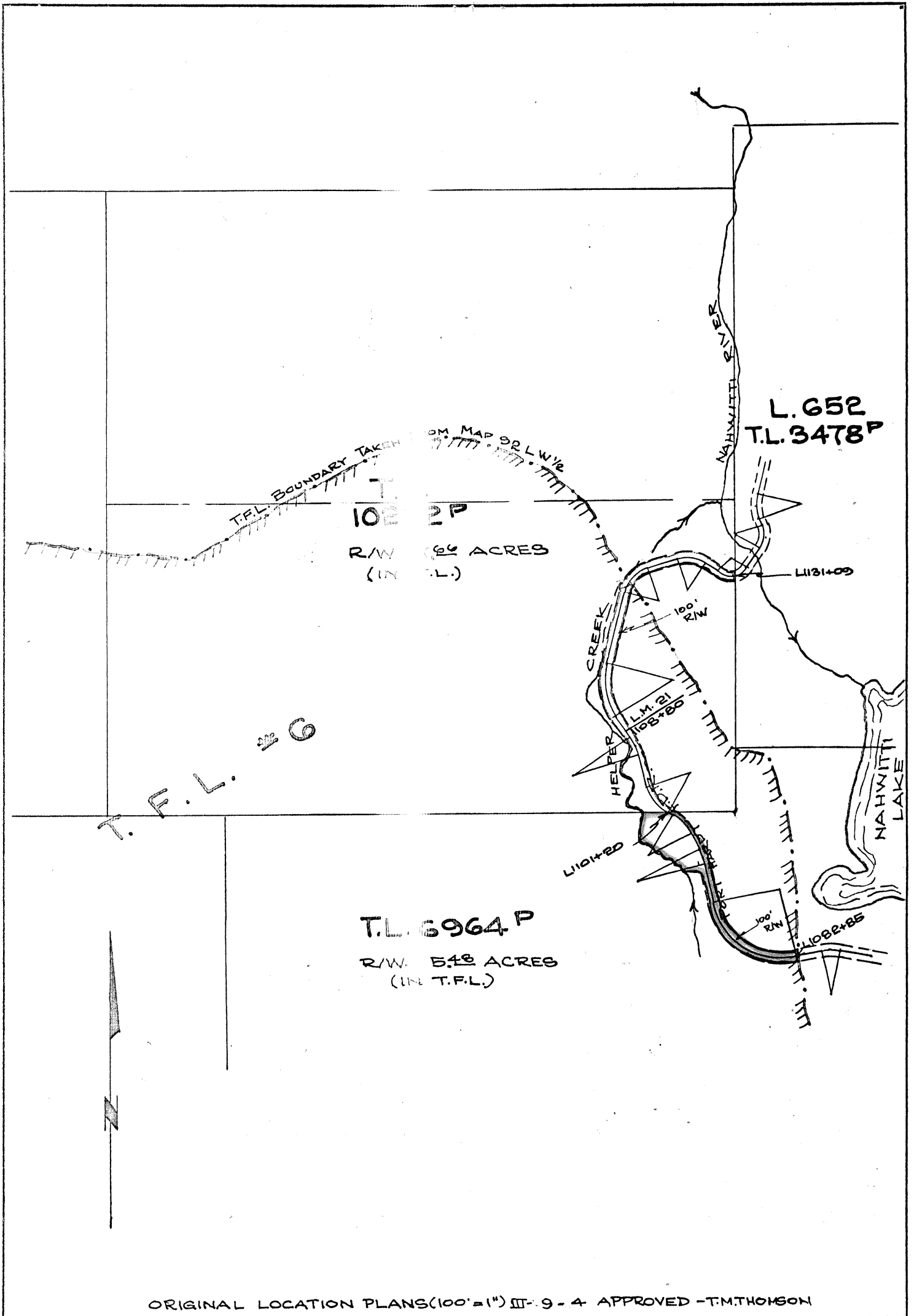

PROVINCE OF BRITISH COLUMBIA — DEPARTMENT OF LANDS AND FORESTS  
 FOREST SERVICE, VICTORIA, B.C. — ENGINEERING SERVICES DIVISION

PORT HARDY F.D.R. RUPERT L.D.  
 IN T.F.L. G

FILE NO.: 0215790	DRAWN BY: <i>BFE</i>	DRAWING NO.
PROJECT: 5490	APPROVED:	
SCALE: 1" TO 1000'	APPROVED:	DATE: NOV. 1962 SIZE: AA