

COPY

PROVINCE OF BRITISH COLUMBIA

Department of Lands, Forests, and Water Resources

FOREST SERVICE

IN THE MATTER OF TREE FARM LICENCE NUMBER 1

AMENDMENT NUMBER 60

Whereas the lands described hereinafter are within Tree Farm Licence Number 1 and are found to be suitable for a higher economic use than the growing of forest crops;

And whereas the withdrawal of the aforementioned lands together with any lands previously withdrawn does not diminish the productive capacity of the licence area to the extent provided in Clause 10 of the Tree Farm Licence;

Therefore pursuant to Subsection (14) of Section 36 of the Forest Act being Chapter 153 of the Revised Statutes of British Columbia, 1960 and pursuant to Clause 10 of the said Tree Farm Licence the following lands are herewith withdrawn from the lands described in Schedule "B" of the said Tree Farm Licence; namely, all that parcel or tract of land being more particularly shown in bold black on the sketch attached hereto and described as follows:

"All that part of the eliminated portion of Timber Licence 9504p containing 66 acres more or less lying North of the Canadian National Railway right-of-way save and except a logging road right-of-way issued under Clause 12 of the Tree Farm Licence file 0298885."

and the said lands so withdrawn are and shall be henceforth no longer subject to or form any part of the said Tree Farm Licence Number 1 for the duration of the Map Reserve established in respect of the aforementioned area.

Dated at the City of Victoria in the Province of British Columbia this day of 1972.

Ray Williston

Minister of Lands, Forests, and Water Resources.

LAND DISTRICT Coast Range 5
Region No. 64 Compt. No. 25
Base 103 I/SW



EXHIBIT A
Date AUG 1, 1972
Atlas Ref. 103 I/SW (e-6)

Amendment # 60 to T.F.L. 1

Shown _____ Acres ± 66 R.D. 4 Scale 80 chains = 1 inch

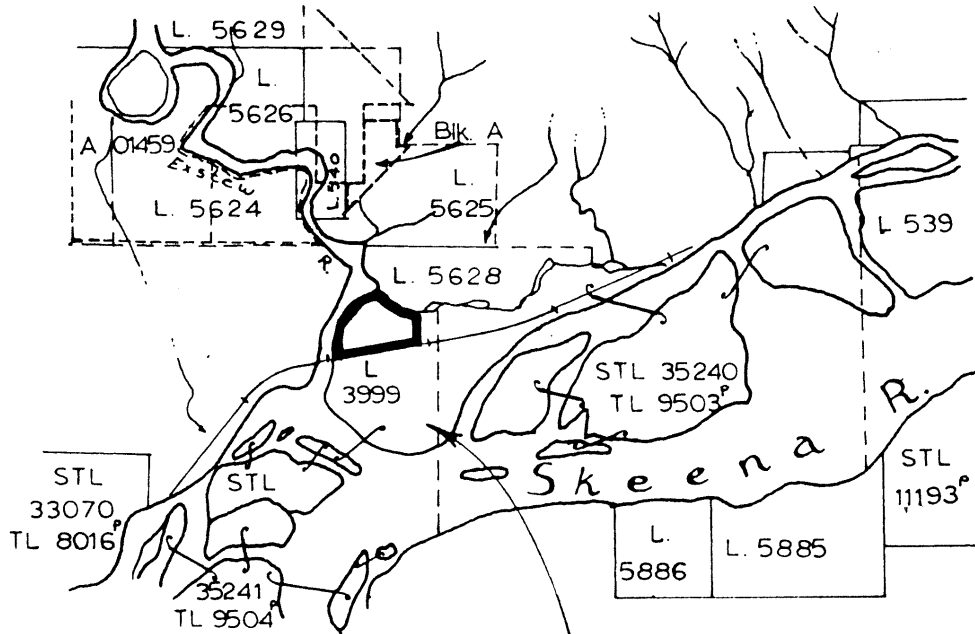

Save & Excepting Hwy 16, CNR,
& R/W 0298885

L. 5624

L. 5625

Inset scale: 20 chs = 1 in

L. 5628

P.O.C. - The junction of the CNR.
& Exstew R. on the west
boundary of L. 3999.

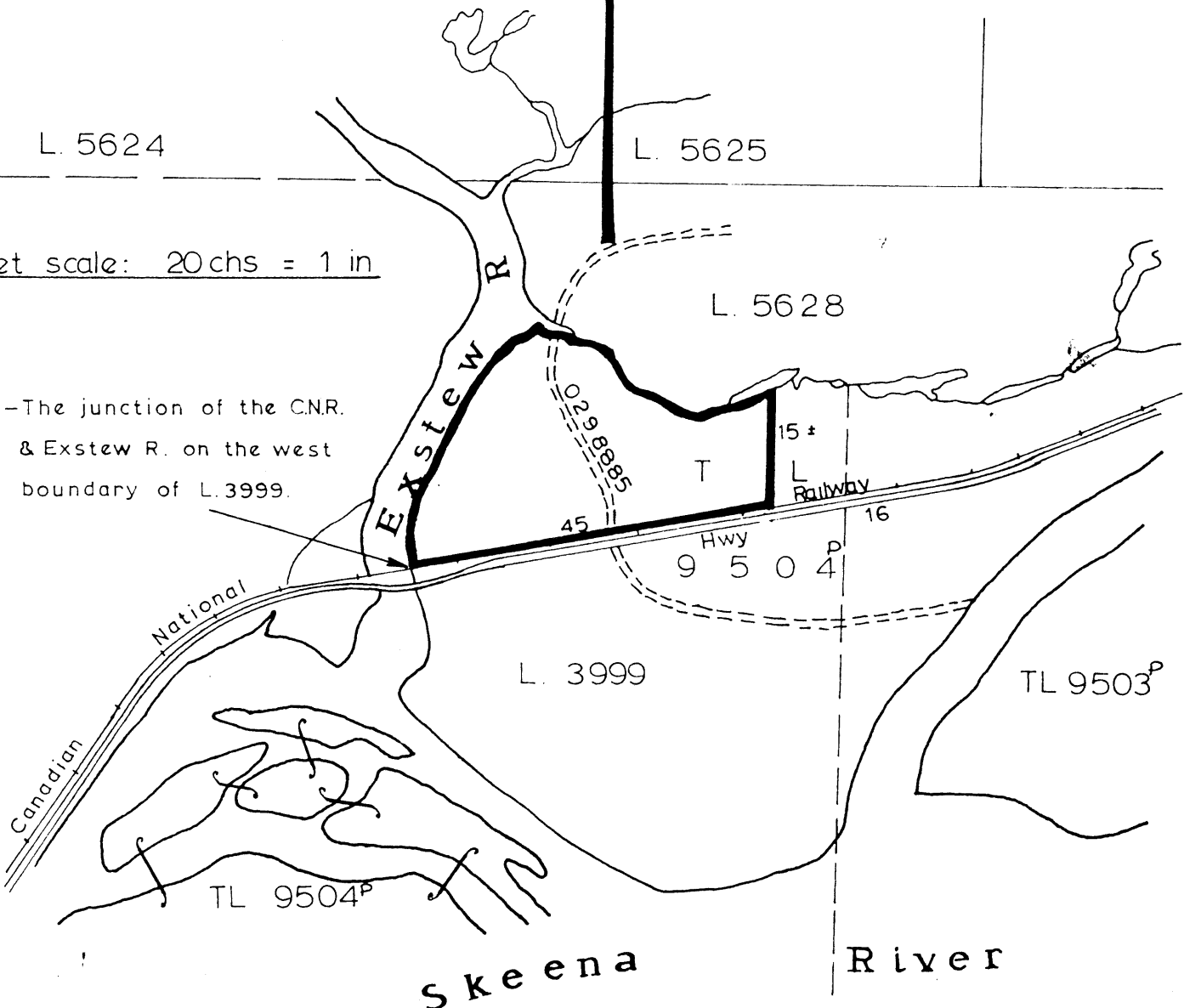

TL 9504^P

L. 3999

Hwy
9 5 0 4

TL 9503^P

Skeena River

MEMO

TO THE HONORABLE THE MINISTER

Your signature is recommended on the attached Amendment Number 60 to Tree Farm Licence Number 1.

This amendment provides for a gravel pit reserve in favour of the Dept. of Highways.

for L.F. Swannell,
Chief Forester.