

NOTE
 For the width of the highway Right of Way, this bank, below Elev. 350 shall be left undisturbed and no vegetation shall be removed or disturbed, except to be cut off sufficiently to carry out the work.

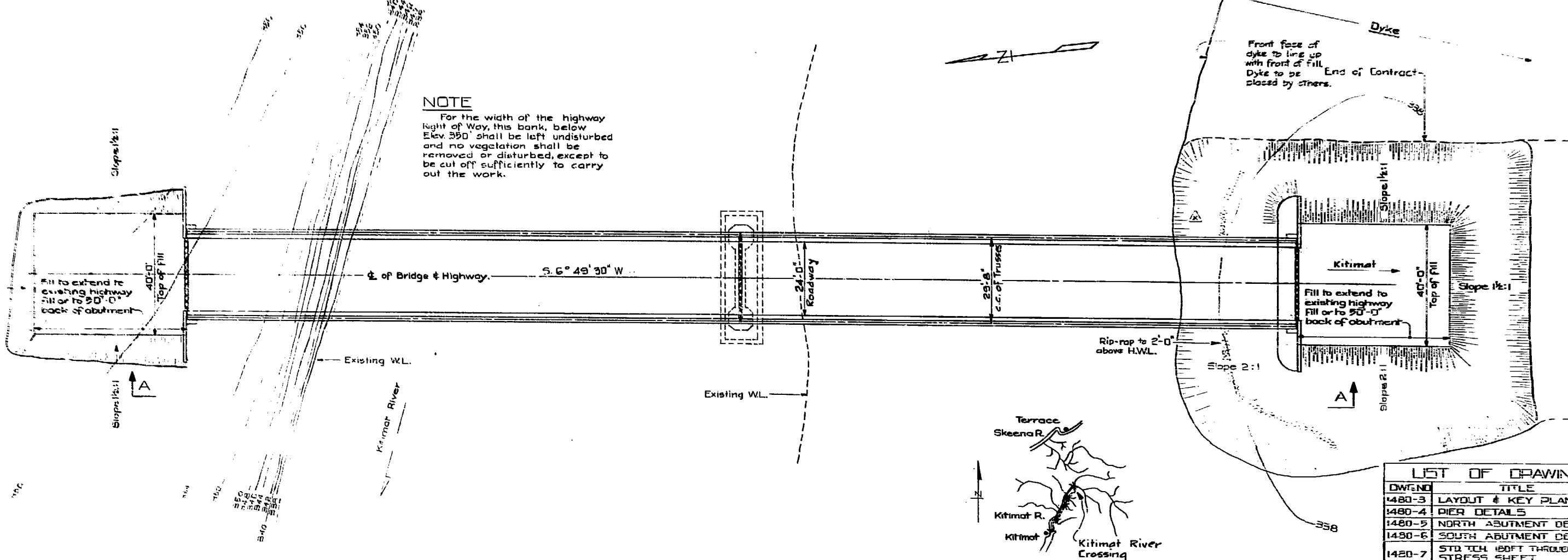

KEY PLAN
 Scale: 1" = 1/16 MI (approx.)

LIST OF DRAWINGS	
DWG NO	TITLE
1480-3	LAYOUT & KEY PLAN
1480-4	PIER DETAILS
1480-5	NORTH ABUTMENT DETAILS
1480-6	SOUTH ABUTMENT DETAILS
1420-7	STD T.C.H. 180FT THROUGH SPAN STRESS SHEET
1480-8	STD T.C.H. 180 FT THROUGH SPAN MISCELLANEOUS DETAILS
1480-9	STD T.C.H. 180 FT THROUGH SPAN FLOOR PLATE & PROT. ANGLE
1480-10	STD T.C.H. 180 FT THROUGH SPAN DECK DETAILS
208A-1	FALSEWORK FOR STANDARD THROUGH TRUSS SPANS.

NOTES
 Design: Provincial Government of B.C. Department of Highways. Highway Bridge Design Specification 1955.
 Loading: A.A.S.H.O. H20-51G
 Surveys: Department of Highways Drawings No. 236-3, 1480-1.

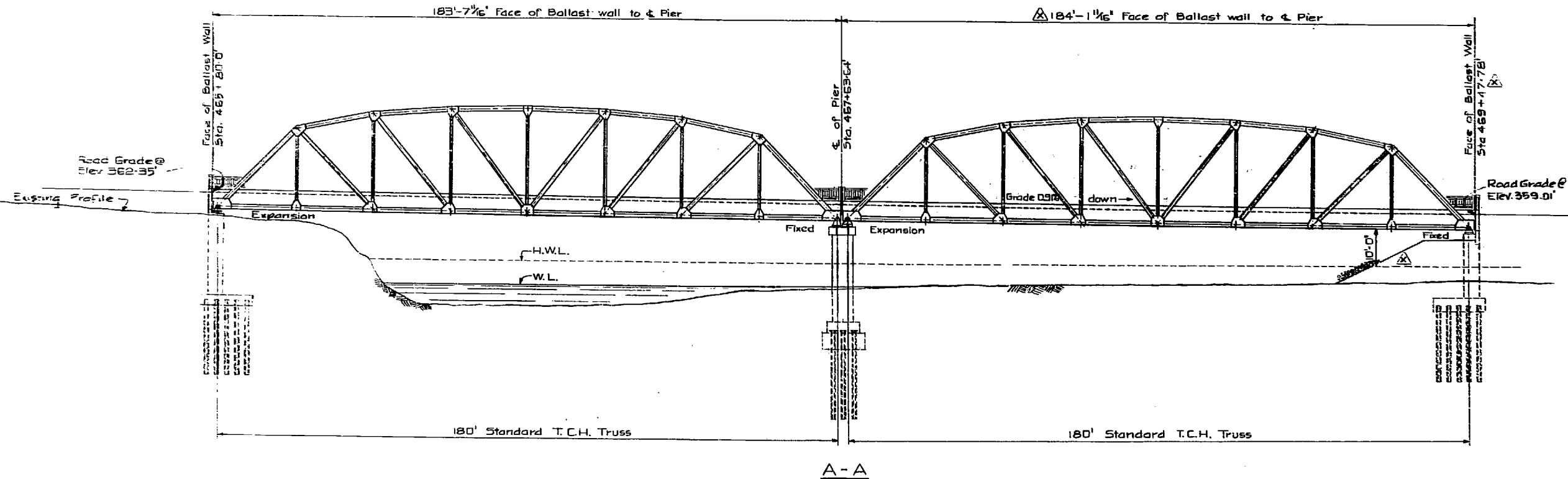

GOVT. OF BRITISH COLUMBIA
 DEPT. OF HIGHWAYS

TERRACE-KITIMAT HIGHWAY
 KITIMAT RIVER CROSSING
 LAYOUT & KEY PLAN

CHOUKALOS, WOODBURN, HOOLEY & MCKENZIE LTD
 CONSULTING ENGINEERS
 VANCOUVER, B.C.

DRAWN E.L.H.	SCALE 1/8" = 1'-0"	REVISIONS	DATE
CHECKED D.D.		As built	Nov 53
APPROVED			
DATE			

BRIDGES
 1480-3X