

PLAN **B**

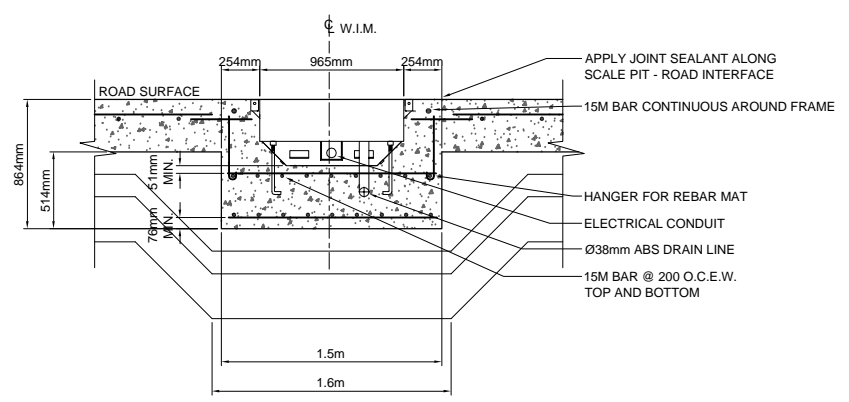

SECTION C-C **B**  
1:25

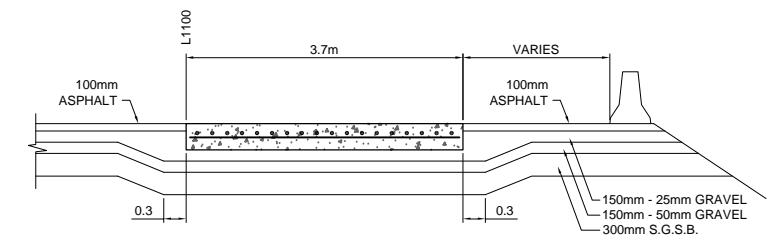

SECTION B-B  
L1100 STA. 1123+45 TO 1124+35 WB  
L100 STA. 102+40 TO 103+30 EB

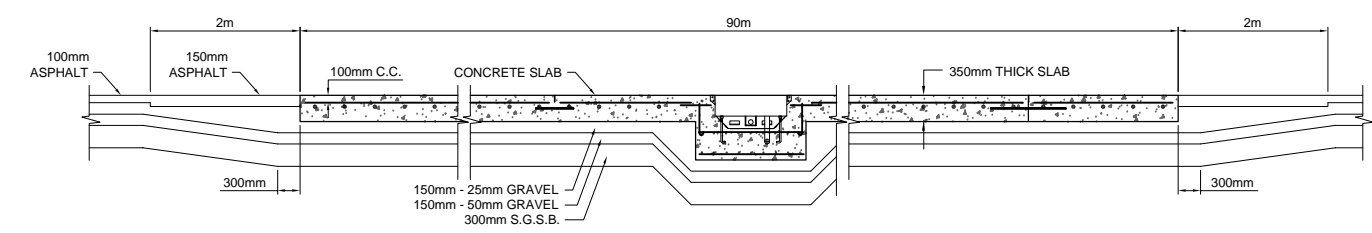

SECTION A-A **B**

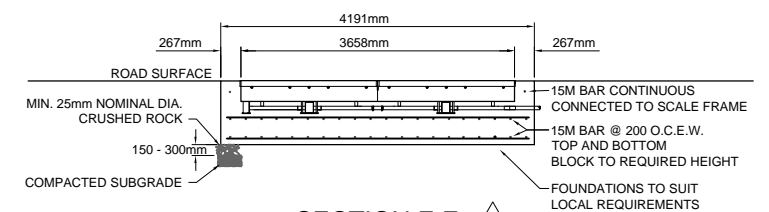

SECTION F-F **B**  
DRAIN AND J-BARS OMITTED FOR CLARITY

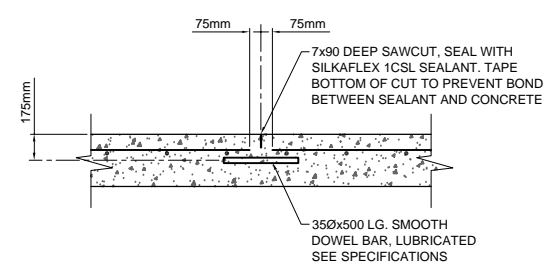

SECTION D-D - CONTRACTION JOINT  
1:25

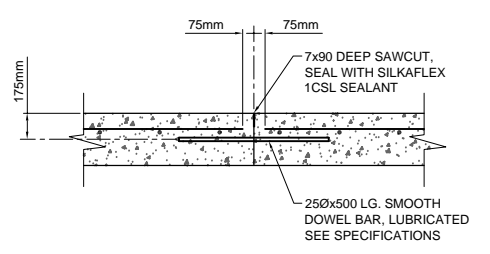

SECTION E-E - CONSTRUCTION JOINT  
1:25

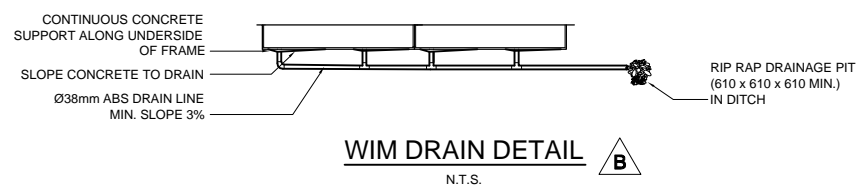

WIM DRAIN DETAIL **B**  
N.T.S.

- NOTES:**
- CONCRETE PAVEMENT LOCATIONS AS FOLLOWS:  
STA. 102+40 TO STA. 103+30 - DWG. 401 & 402  
STA. 1123+45 TO STA. 1124+35 - DWG. 407
  - CONCRETE SLAB DETAILS SUBJECT TO CHANGE -  
-DEPENDENT UPON W.I.M. SUPPLIER
  - FOR CONCRETE PROPERTIES, SEE SPECIFICATIONS.
  - REFER TO IRD DRAWING 10014701 **B**
  - WIM SCALE FRAME SUPPLIED BY IRD **B**
  - WIM SCALE INSTALLED BY IRD **B**

DRAWING CROSS REFERENCE		
KEY PLAN		R2-625-001
PLAN	R2-625-101 TO R2-625-108	
PROFILES	R2-625-201 TO R2-625-207	
TYPICAL SECTIONS	R2-625-301 TO R2-625-308	
GEOMETRICS & LANING	R2-625-401 TO R2-625-411	
SIGNING & PAVEMENT MARKINGS	R2-625-501 TO R2-625-508	
SITE SERVICING PLANS	R2-625-601 TO R2-625-605	
SITE GRADING	R2-625-701 TO R2-625-702	
DRAINAGE DETAILS	R2-625-751 TO R2-625-753	
LANDSCAPING	R2-625-801	
CONSTRUCTION STAGING	R2-625-901 TO R2-625-903	
ELECTRICAL	TE-04056-1 TO TE-04056-13	

Rev	Date	REVISIONS	Signature
A	FEB/05	Minor Updates To Drawing	
B	AUG/05	Updated to suit WIM installation	

DESIGNED KY DATE SEPT/04  
DRAWN DCD DATE SEPT/04

Province of British Columbia  
MINISTRY OF TRANSPORTATION  
SOUTHERN INTERIOR REGION

DESIGN CONSULTANT  
**CH2MHILL**

PREPARED UNDER THE DIRECTION OF  
CONSULTANT  
DATE

REINFORCED CONCRETE STEEL DETAILS			
TRANS CANADA HIGHWAY No. 1 JOINT USE VEHICLE INSPECTION STATION			
FILE No.	PROJECT No.	REQ.	DRAWING No.
1432	11755.0501	2	R2-625-306

CANCEL PRINTS BEARING PREVIOUS LETTER