

PLOT DATE: 2024-03-05 2:14:41 PM eproux U:\Projects_SUR\1961\0480\13\0-Design\CAD\DrawingProduction\100_Plans_Traffic_Management\Gough Stage 1 - Road Cut.dwg

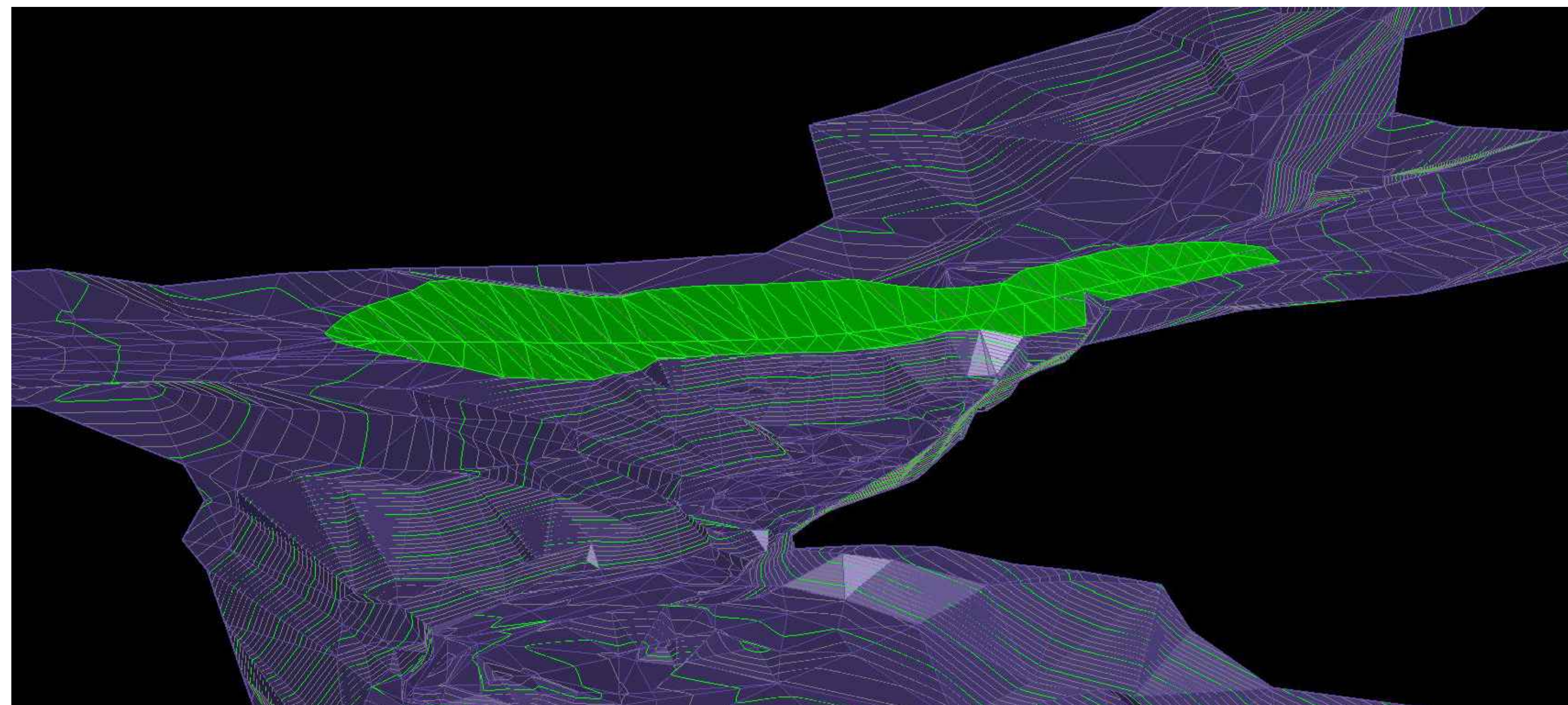

ISOMETRIC VIEW

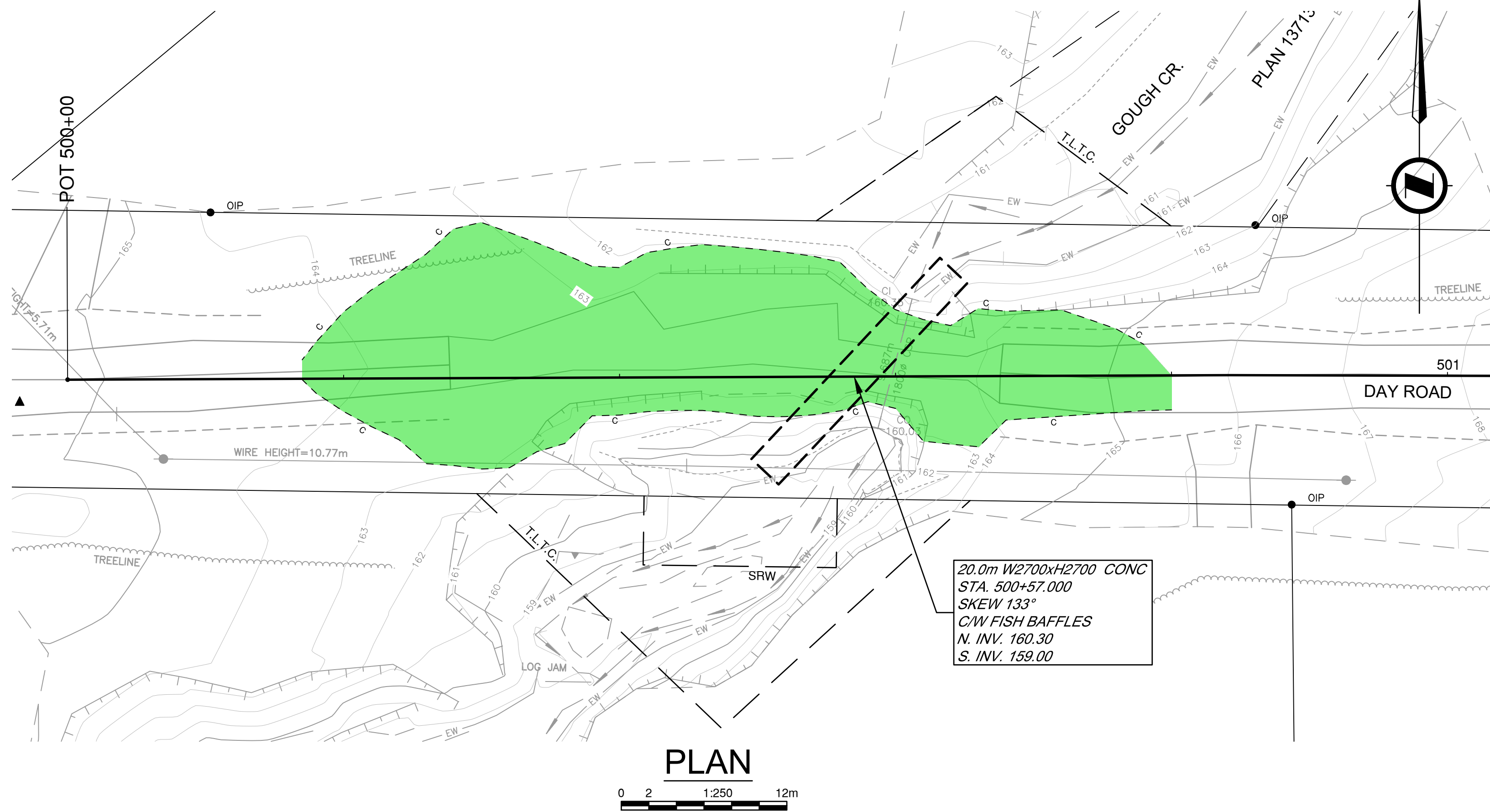
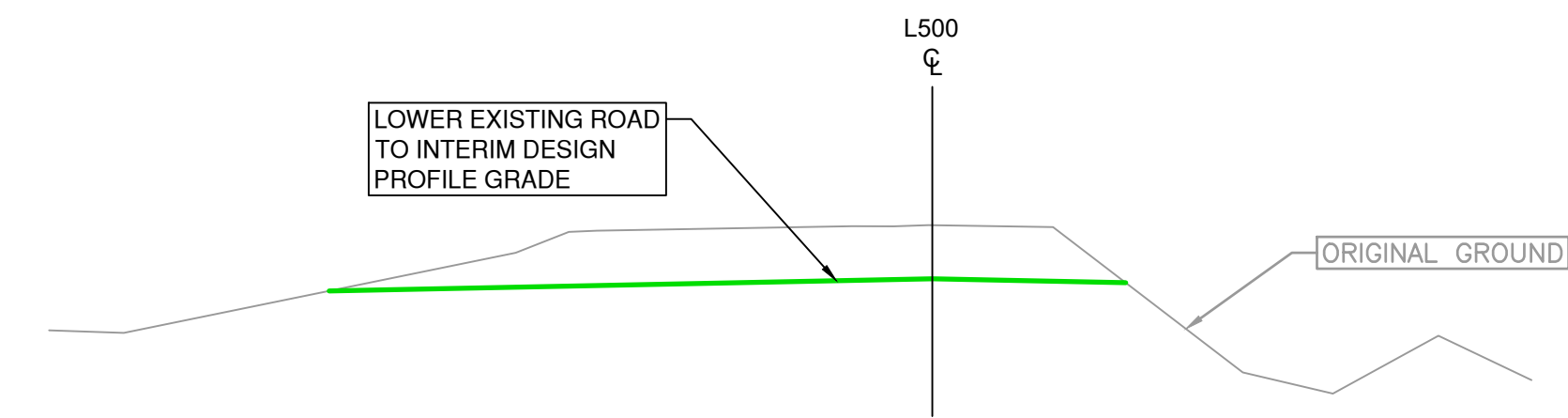

TYPICAL SECTION

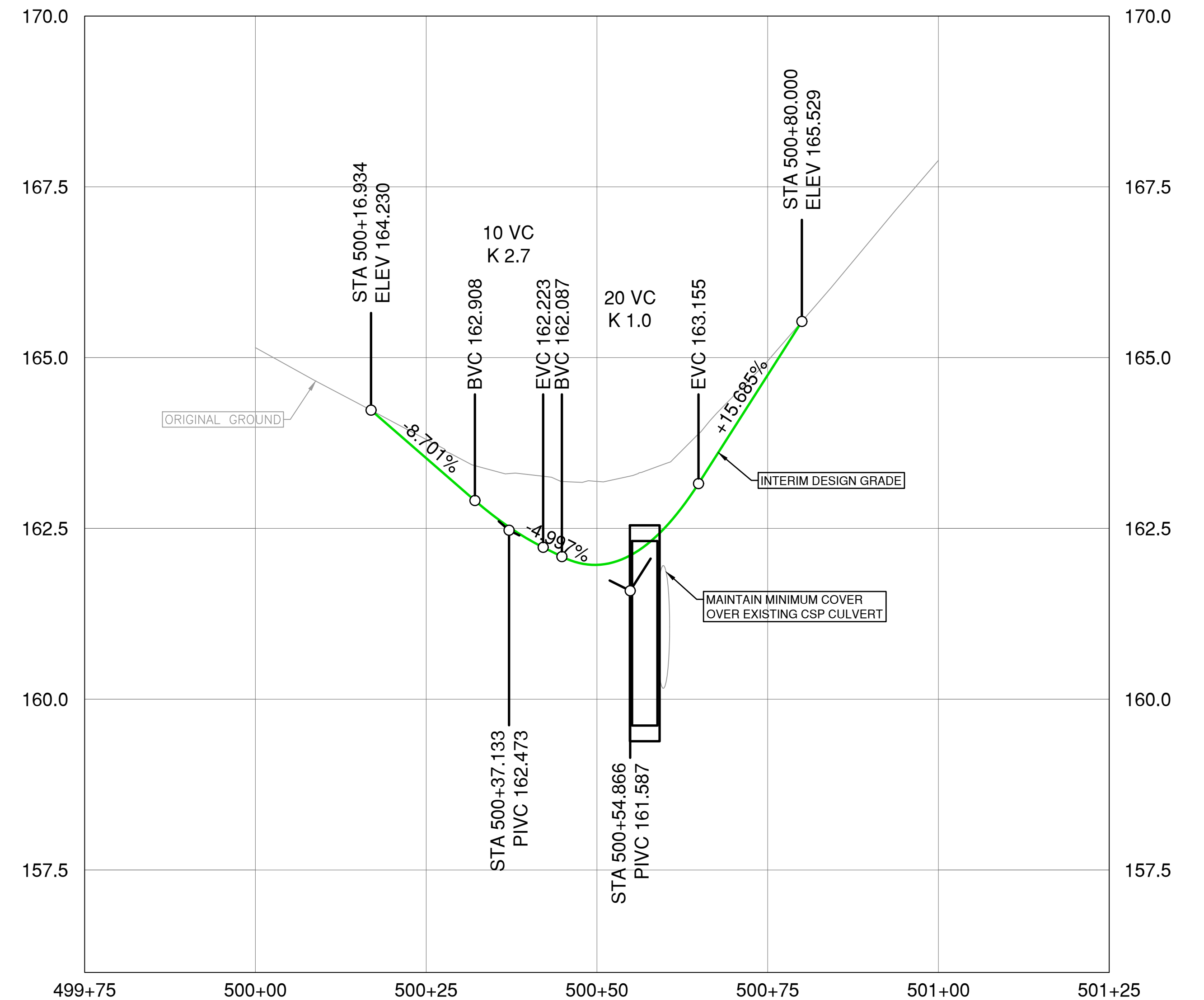

PROFILE

FOR INFORMATIONAL PURPOSES ONLY

2024-03-05
urbansystems.ca

LEGEND

CUT

SUGGESTED STAGING PROCEDURE:

1. LOWER DAY ROAD TO INTERIM DESIGN PROFILE GRADE.
2. MAINTAINING LOCAL TRAFFIC AND INSTALL DIVERSION PIPE.



REV	DATE	REVISIONS	NAME	PROFESSIONAL SEALS



MINISTRY OF TRANSPORTATION AND INFRASTRUCTURE
SOUTH COAST REGION
HIGHWAY ENGINEERING AND GEOMATICS



CAD FILENAME: Gough Stage 1 - Road Cut	DESIGNED: S.FUOCO DATE: 2024-03-05
FILE NUMBER: 872CS1714	QUALITY CONTROL: S.FUOCO DATE: 2024-03-05
PLOT DATE: 2024-03-05	QUALITY ASSURANCE: C.BAGG DATE: 2024-03-05
	DRAWN: E.PROULX DATE: 2024-03-05

SCALE: AS SHOWN	PROJECT NUMBER: 14005-0001	REG: 1	DRAWING NUMBER: STAGE 1	REV:
-----------------	----------------------------	--------	-------------------------	------

CONCEPTUAL CONSTRUCTION STAGE 1

DAY ROAD - GOUGH CREEK

PLOT DATE: 2024-03-05 2:15:02 PM eproux U:\Projects_SUR\1961\0480\13\0-Design\CAD\DrawingProduction\100_Plans_Traffic_Management\Cough Stage 2 - DownStream Detour.dwg

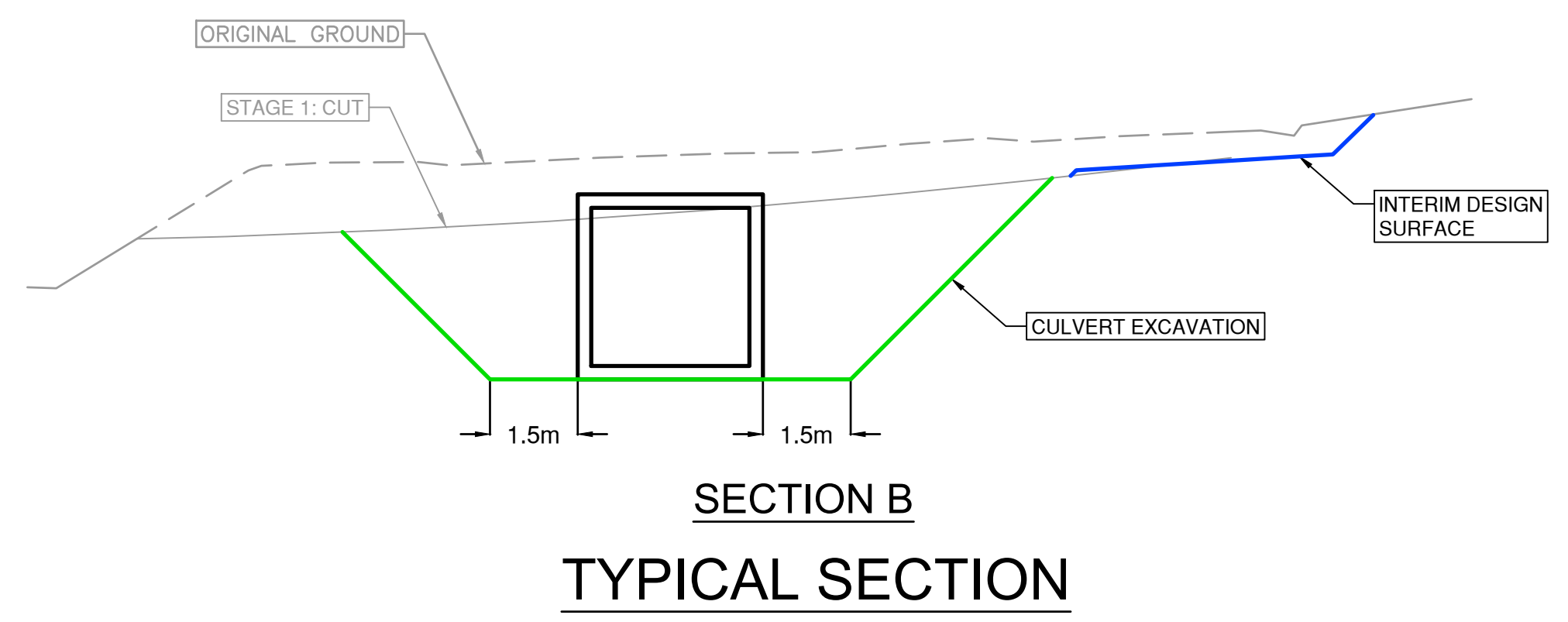
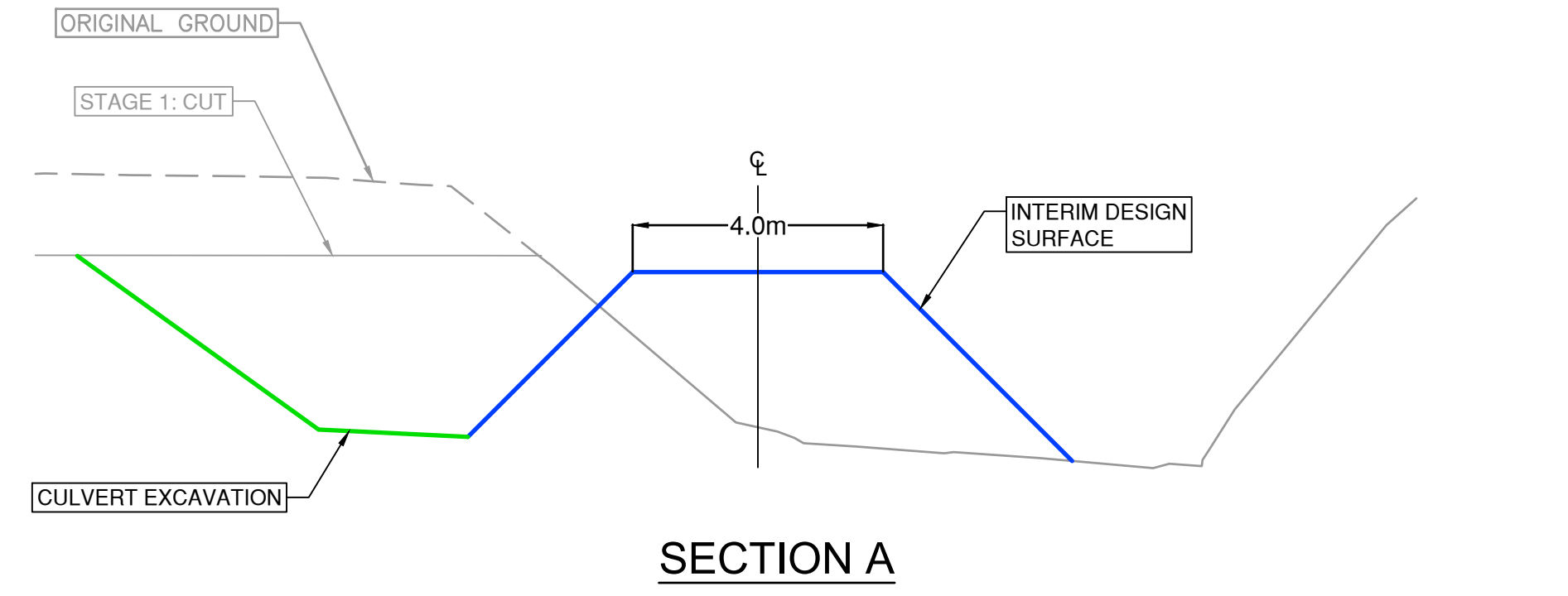

TYPICAL SECTION

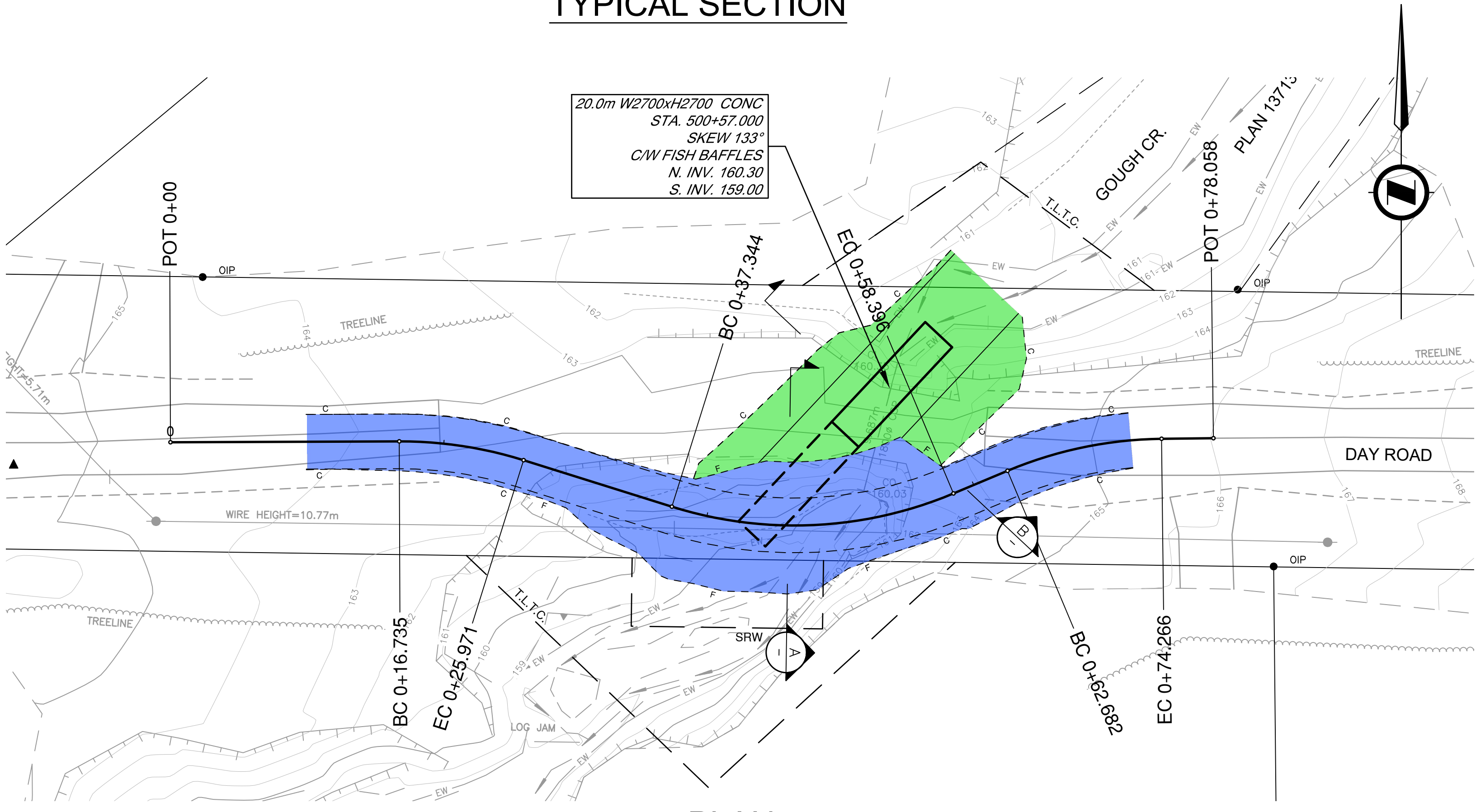

20.0m W2700xH2700 CONC
STA. 500+57.000
SKEW 133°
C/W FISH BAFFLES
N. INV. 160.30
S. INV. 159.00

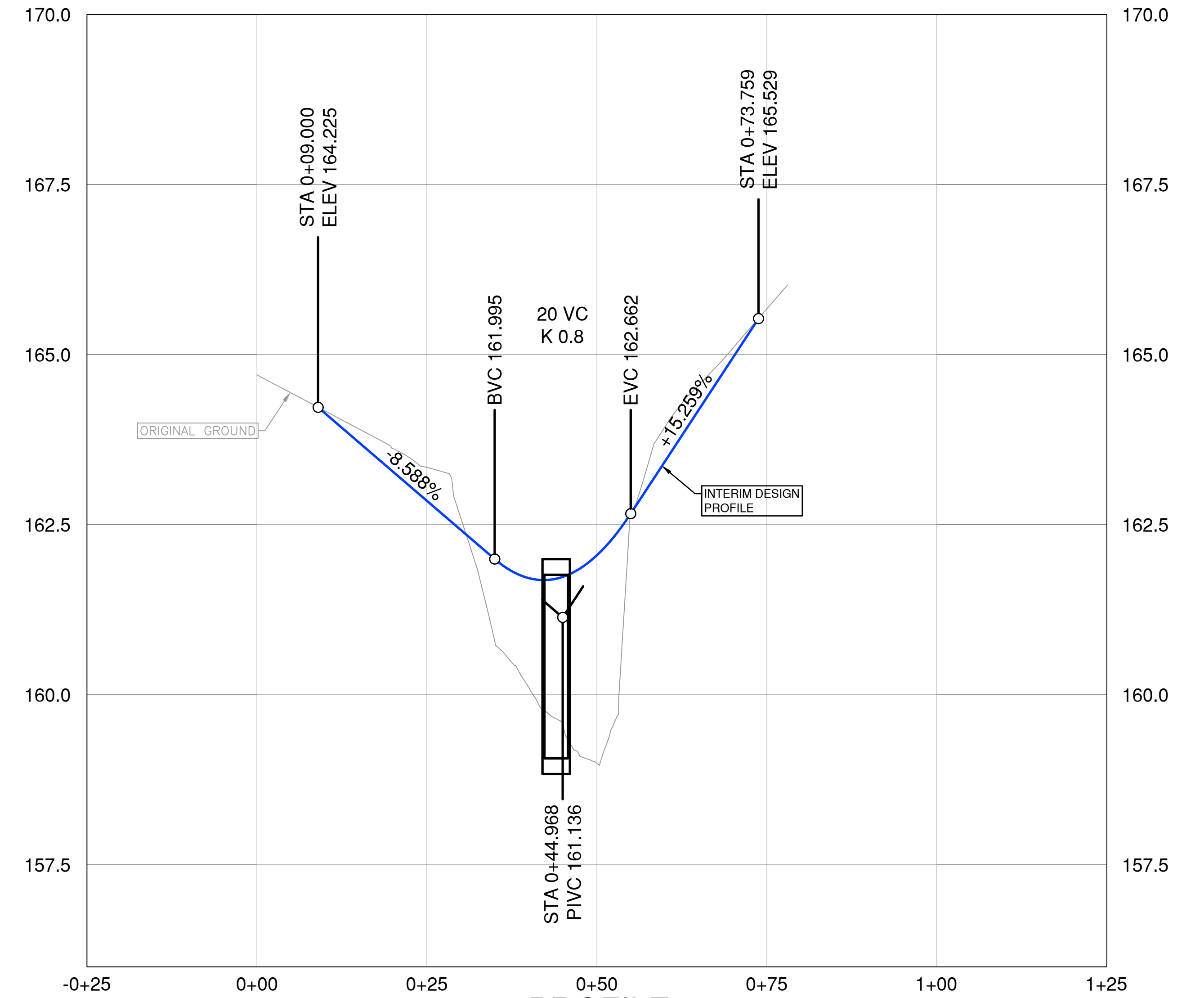
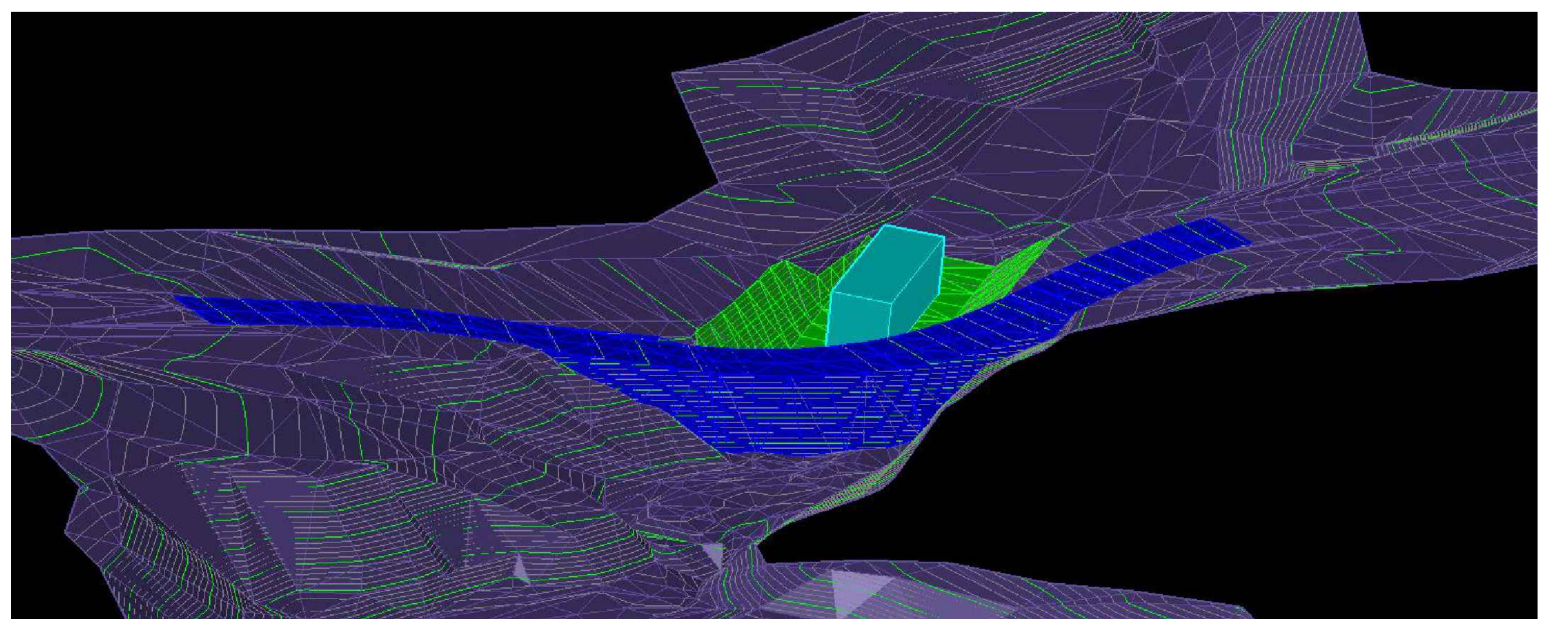

LEGEND

CULVERT EXCAVATION	
INTERIM DESIGN ALIGNMENT	

FOR INFORMATIONAL PURPOSES ONLY
2024-03-05
urbansystems.ca

- SUGGESTED STAGING PROCEDURE:**
1. CONSTRUCT TRAFFIC DIVERSION ALIGNMENT
 2. MOVE VEHICLES TO DIVERTED VEHICLE ALIGNMENT
 3. EXCAVATE AND INSTALL NORTH HALF OF CULVERT



REV	DATE	REVISIONS	NAME	PROFESSIONAL SEALS

BRITISH COLUMBIA MINISTRY OF TRANSPORTATION AND INFRASTRUCTURE
SOUTH COAST REGION
HIGHWAY ENGINEERING AND GEOMATICS

DESIGNED: S.FUOCO DATE: 2024-03-05
QUALITY CONTROL: S.FUOCO DATE: 2024-03-05
FILE NUMBER: 872CS1714 QUALITY ASSURANCE: C.BAGG DATE: 2024-03-05
PLOT DATE: 2024-03-05 DRAWN: E.PROULX DATE: 2024-03-05

CONCEPTUAL CONSTRUCTION STAGE 2
DAY ROAD - GOUGH CREEK

SCALE	AS SHOWN	PROJECT NUMBER	14005-0001	REG	1	DRAWING NUMBER	STAGE 2	REV	
-------	----------	----------------	------------	-----	---	----------------	---------	-----	--

PLOT DATE: 2024-03-05 2:15:20 PM eproux U:\Projects_SUR\1961\13\0-Design\CAD\DrawingProduction\100_Plans_Traffic_Management\Cough Stage 3 - UpStream Detour.dwg

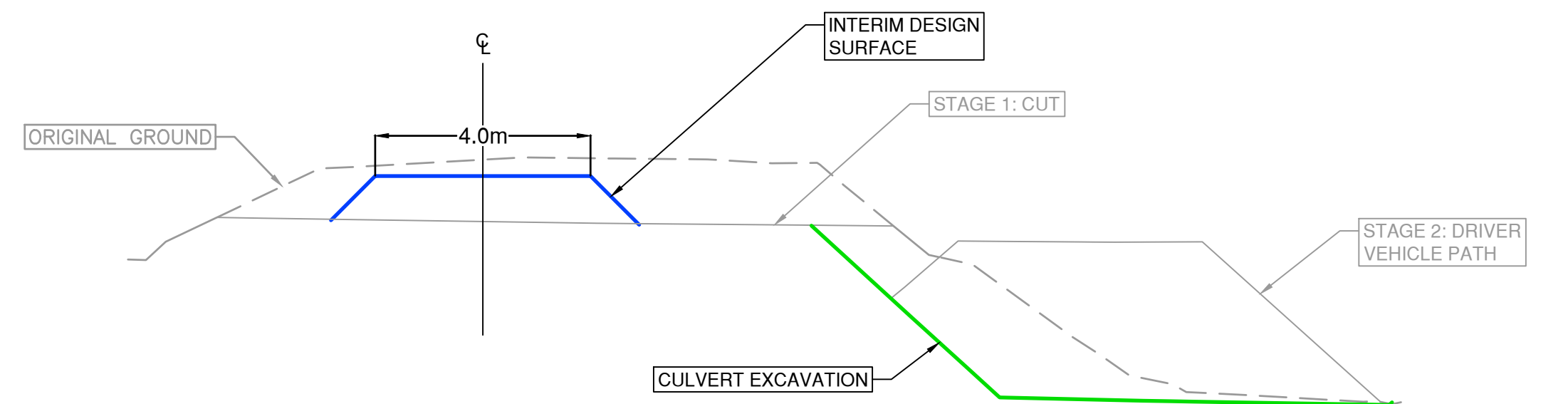

SECTION A

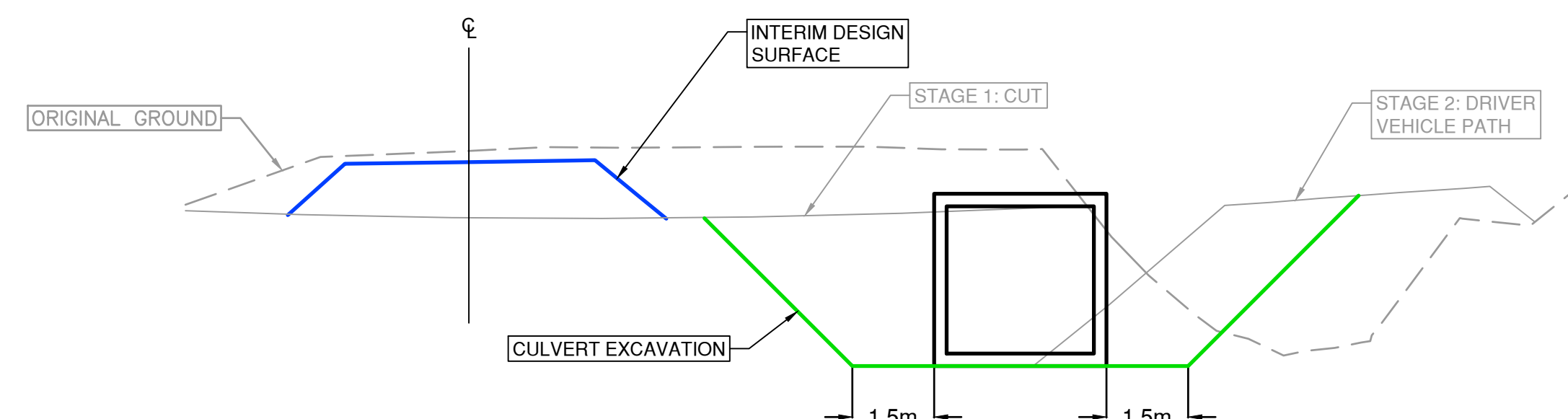

SECTION B

TYPICAL SECTION

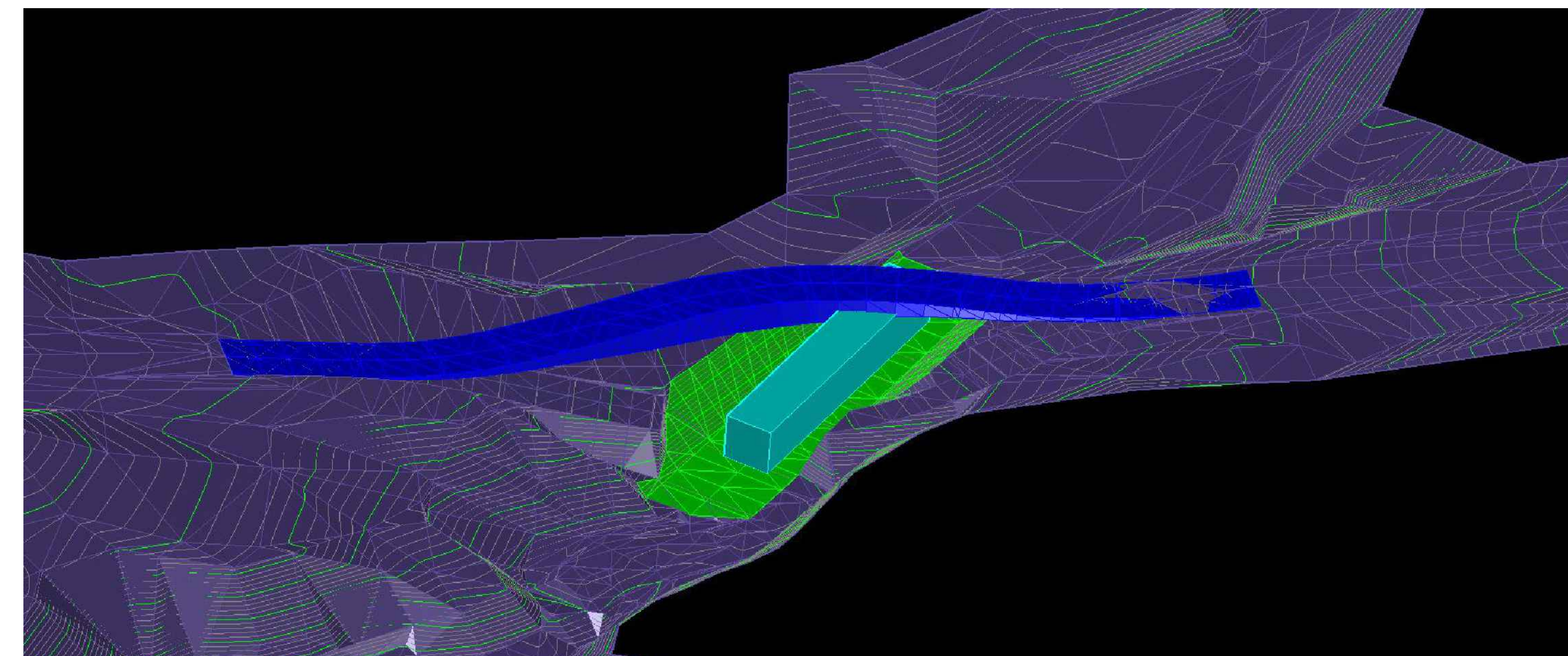

ISOMETRIC VIEW

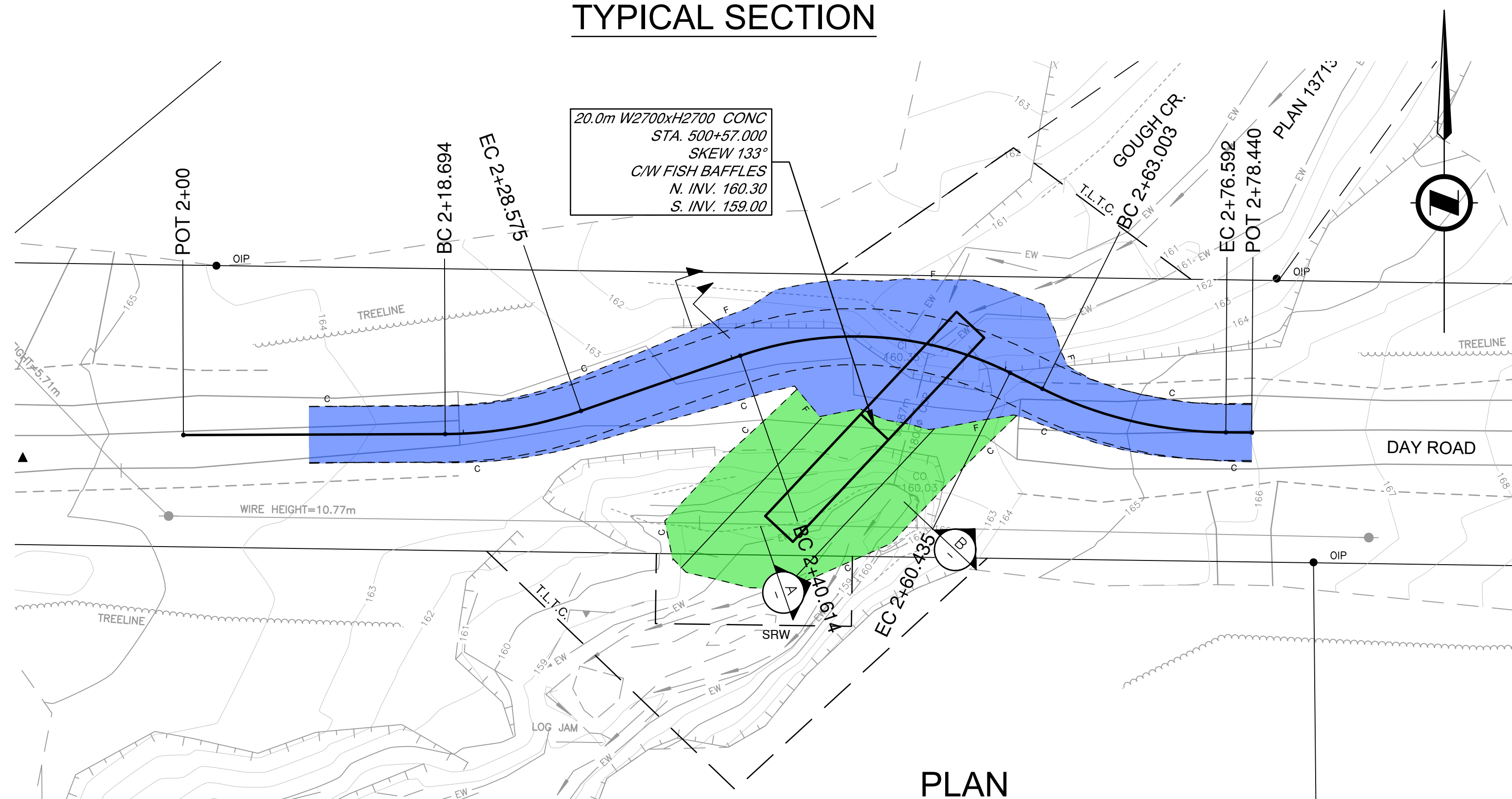

PLAN

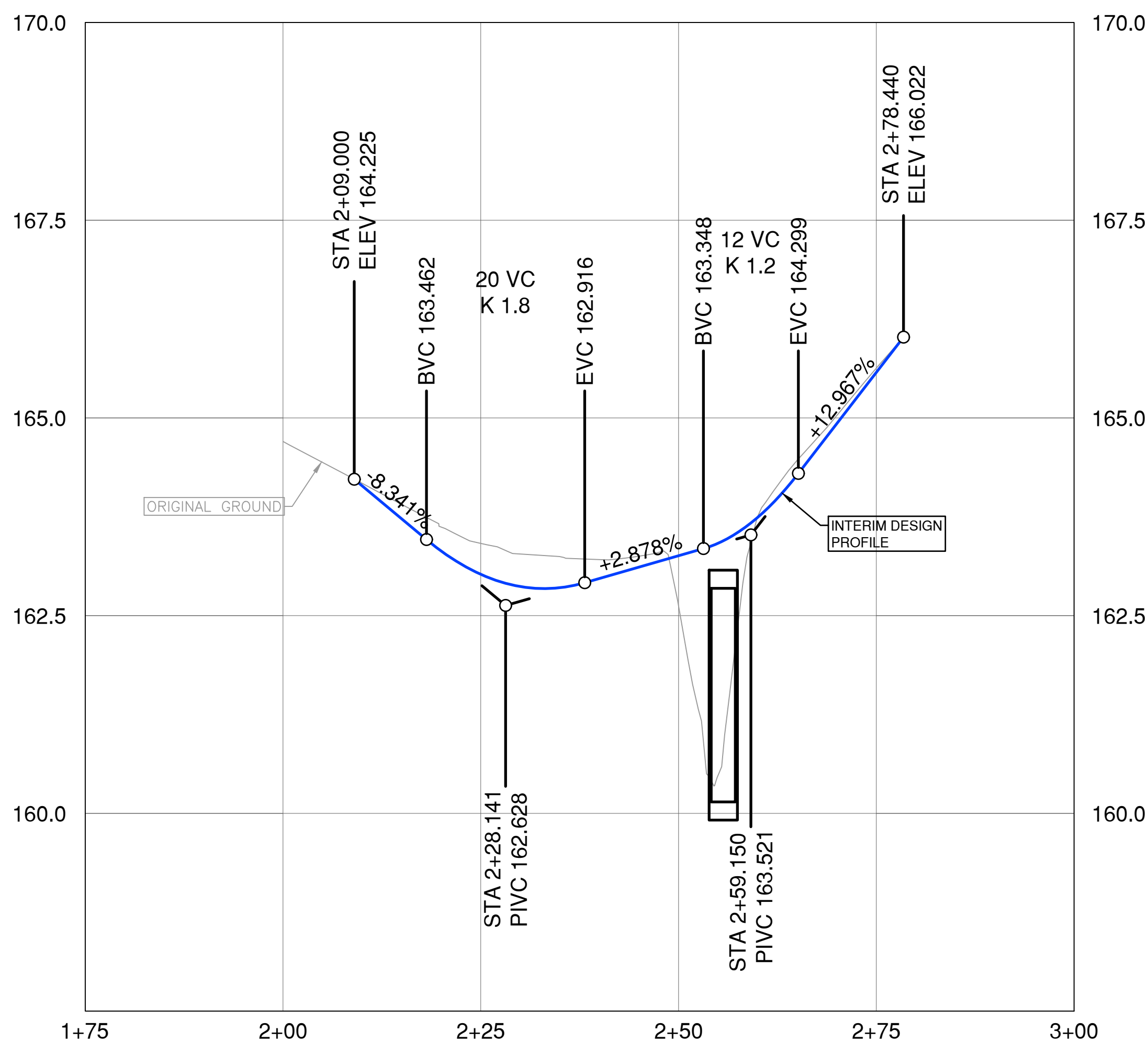

PROFILE

LEGEND

CULVERT EXCAVATION	
INTERIM DESIGN ALIGNMENT	

FOR INFORMATIONAL PURPOSES ONLY

2024-03-05

urbansystems.ca

- SUGGESTED STAGING PROCEDURE:**
- BLOCK INLET OF NEW CULVERT AND CONSTRUCT TRAFFIC DIVERSION ALIGNMENT
 - MOVE VEHICLES TO DIVERTED VEHICLE ALIGNMENT
 - EXCAVATE AND COMPLETE CULVERT INSTALLATION
 - REMOVE TEMPORARY CULVERT AND COMPLETE PERMANENT ROAD WORKS



REV	DATE	REVISIONS	NAME	PROFESSIONAL SEALS



MINISTRY OF TRANSPORTATION AND INFRASTRUCTURE
SOUTH COAST REGION
HIGHWAY ENGINEERING AND GEOMATICS

CAD FILENAME: Cough Stage 3 - UpStream Detour
FILE NUMBER: 872CS1714
PLOT DATE: 2024-03-05

DESIGNED: S.FUOCO DATE: 2024-03-05
QUALITY CONTROL: S.FUOCO DATE: 2024-03-05
QUALITY ASSURANCE: C.BAGG DATE: 2024-03-05
DRAWN: E.PROULX DATE: 2024-03-05

SCALE: AS SHOWN	PROJECT NUMBER: 14005-0001	REG: 1	DRAWING NUMBER: STAGE 3	REV:
-----------------	----------------------------	--------	-------------------------	------

PLOT DATE: 2024-03-05 2:15:39 PM eproux U:\Projects_SUR\1961\0480\13\1D-Design\CAD\DrawingProduction\100_Plans_Traffic_Management\Clack Stage 1 - Road Cut.dwg

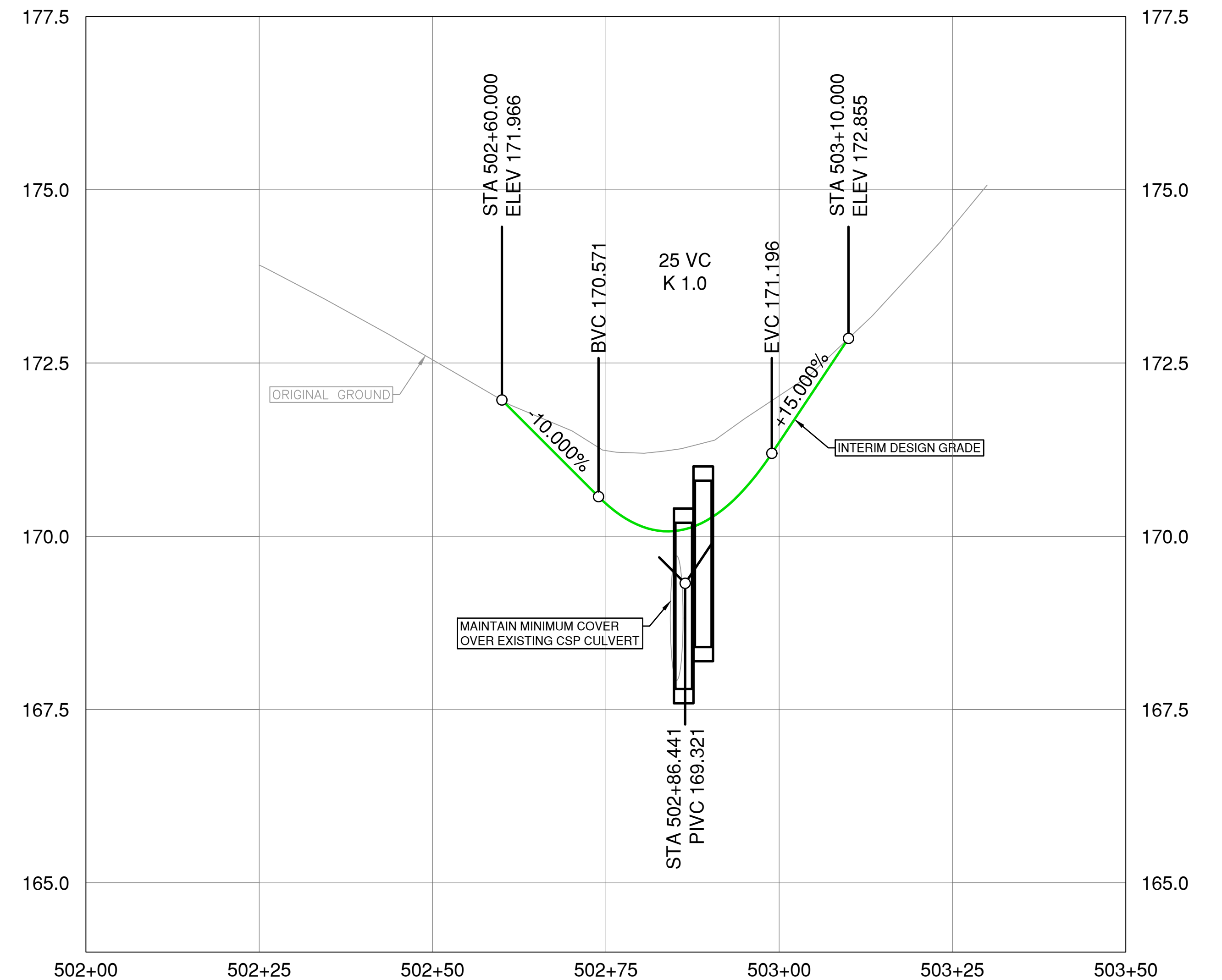
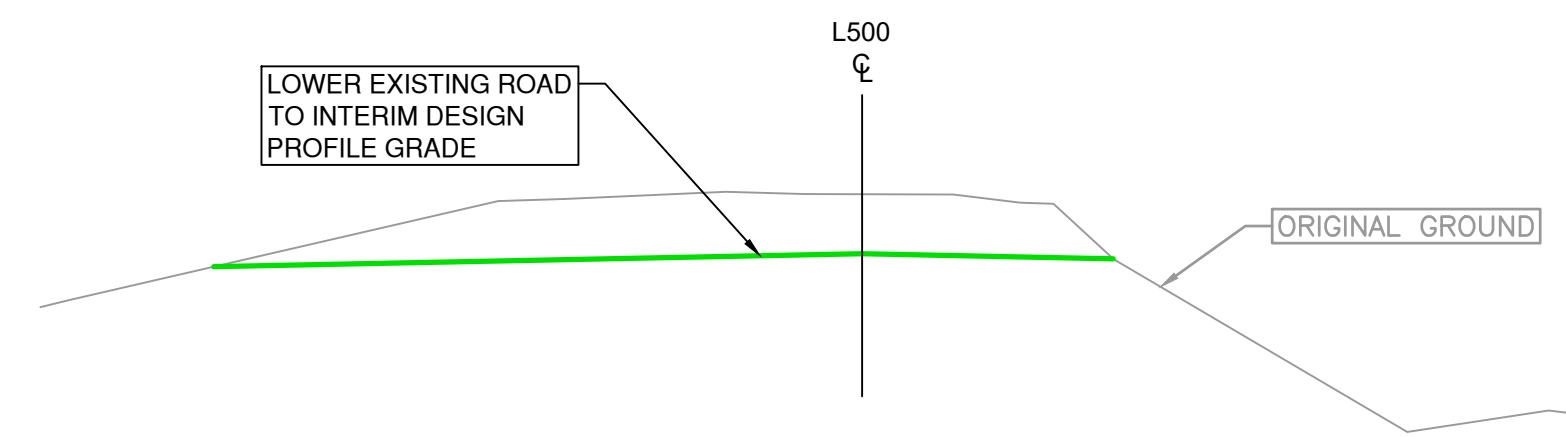
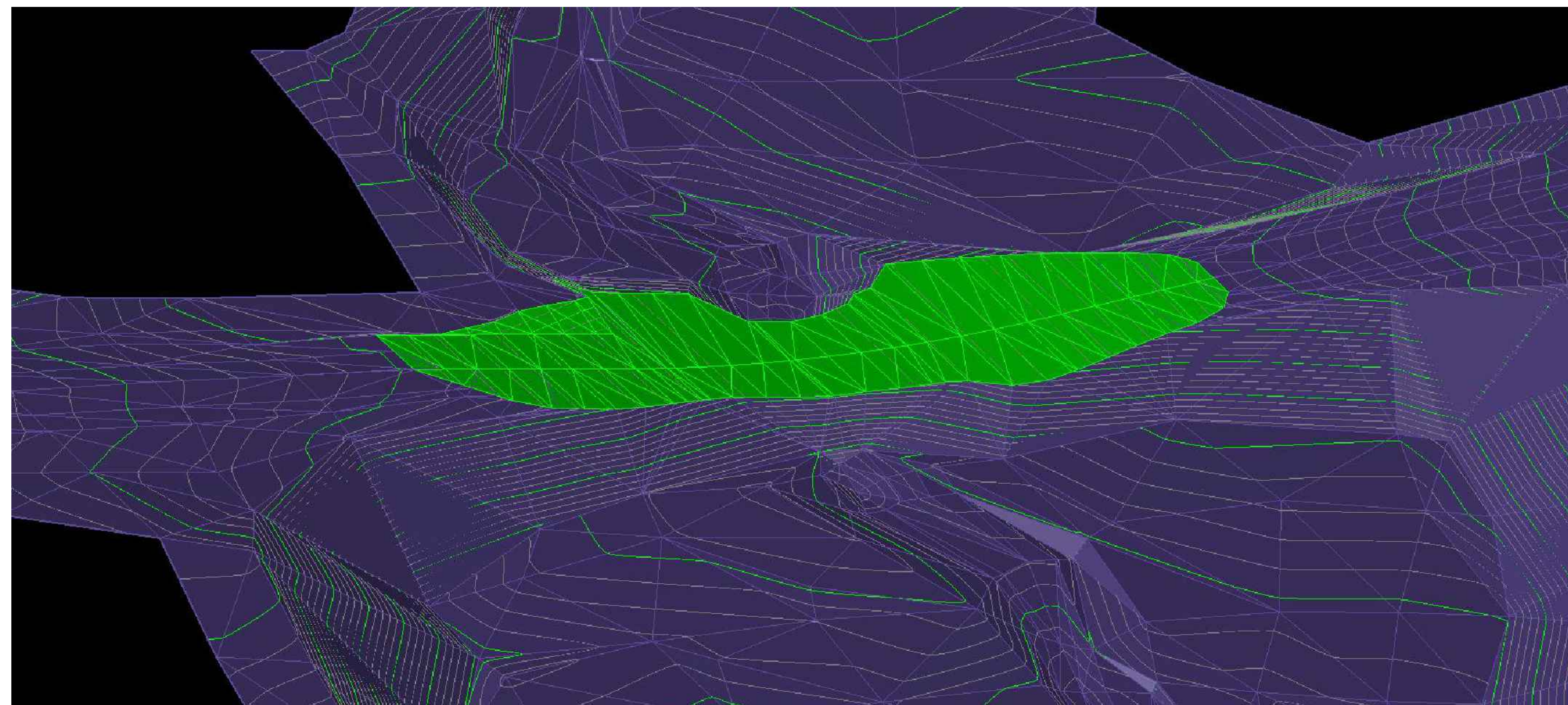
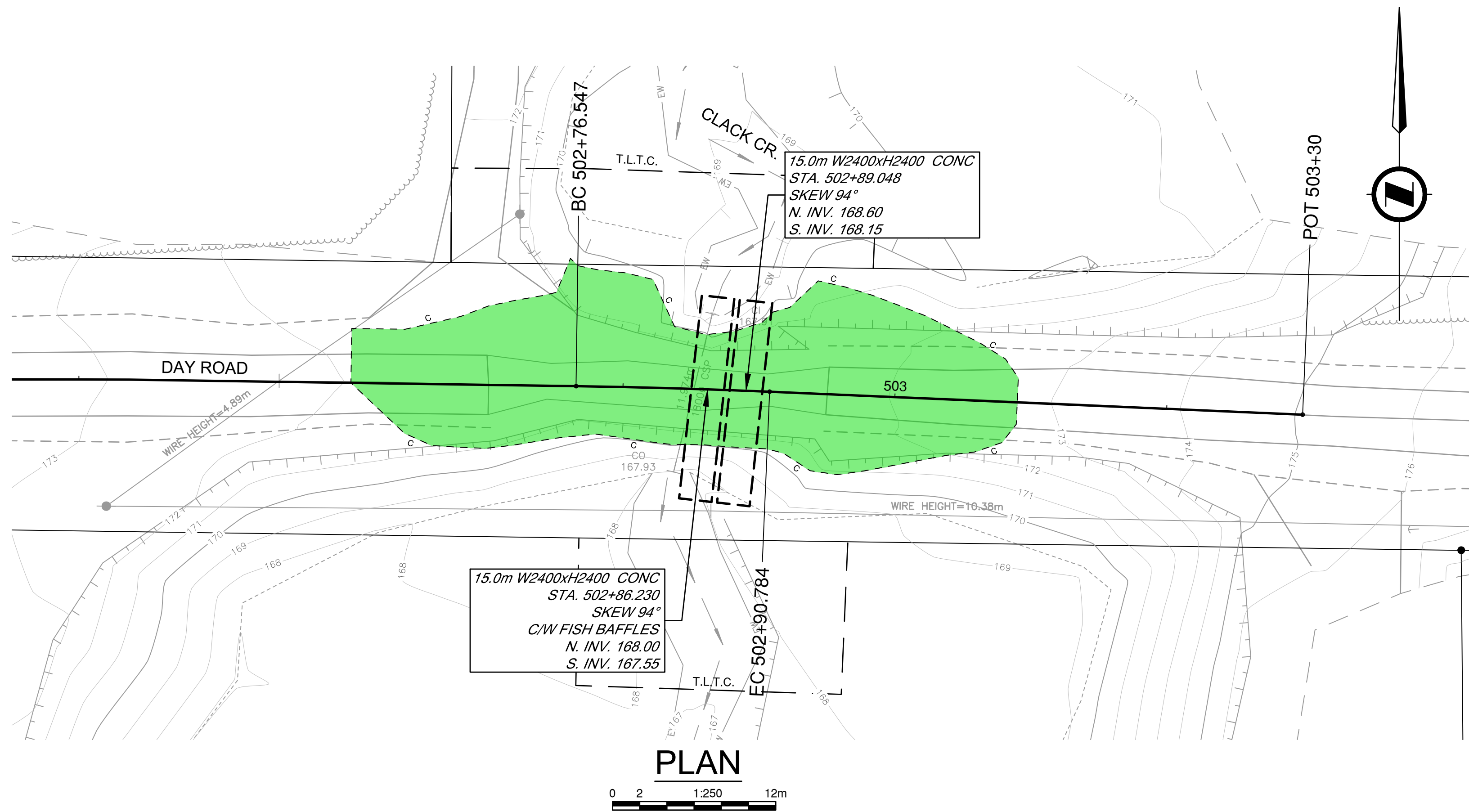

FOR INFORMATIONAL PURPOSES ONLY

2024-03-05
urbansystems.ca

LEGEND

CUT

SUGGESTED STAGING PROCEDURE:

1. LOWER DAY ROAD TO INTERIM DESIGN PROFILE GRADE.
2. MAINTAINING LOCAL TRAFFIC AND INSTALL DIVERSION PIPE.



REV	DATE	REVISIONS	NAME	PROFESSIONAL SEALS



MINISTRY OF TRANSPORTATION AND INFRASTRUCTURE
SOUTH COAST REGION
HIGHWAY ENGINEERING AND GEOMATICS



CAD FILENAME	Clack Stage 1 - Road Cut	DESIGNED	S.FUOCO	DATE	2024-03-05
FILE NUMBER	872CS1714	QUALITY CONTROL	S.FUOCO	DATE	2024-03-05
PLOT DATE	2024-03-05	QUALITY ASSURANCE	C.BAGG	DATE	2024-03-05
		DRAWN	E.PROULX	DATE	2024-03-05

CONCEPTUAL CONSTRUCTION STAGE 1

DAY ROAD - CLACK CREEK

SCALE	AS SHOWN	PROJECT NUMBER	14005-0001	REG	1	DRAWING NUMBER	STAGE 1	REV	
-------	----------	----------------	------------	-----	---	----------------	---------	-----	--

PLOT DATE: 2024-03-05 2:15:59 PM eproux U:\Projects_SUR\1961\0480\13\Design\CAD\DrawingProduction\100_Plans_Traffic_Management\Clack Stage 2 - DownStream Detour.dwg

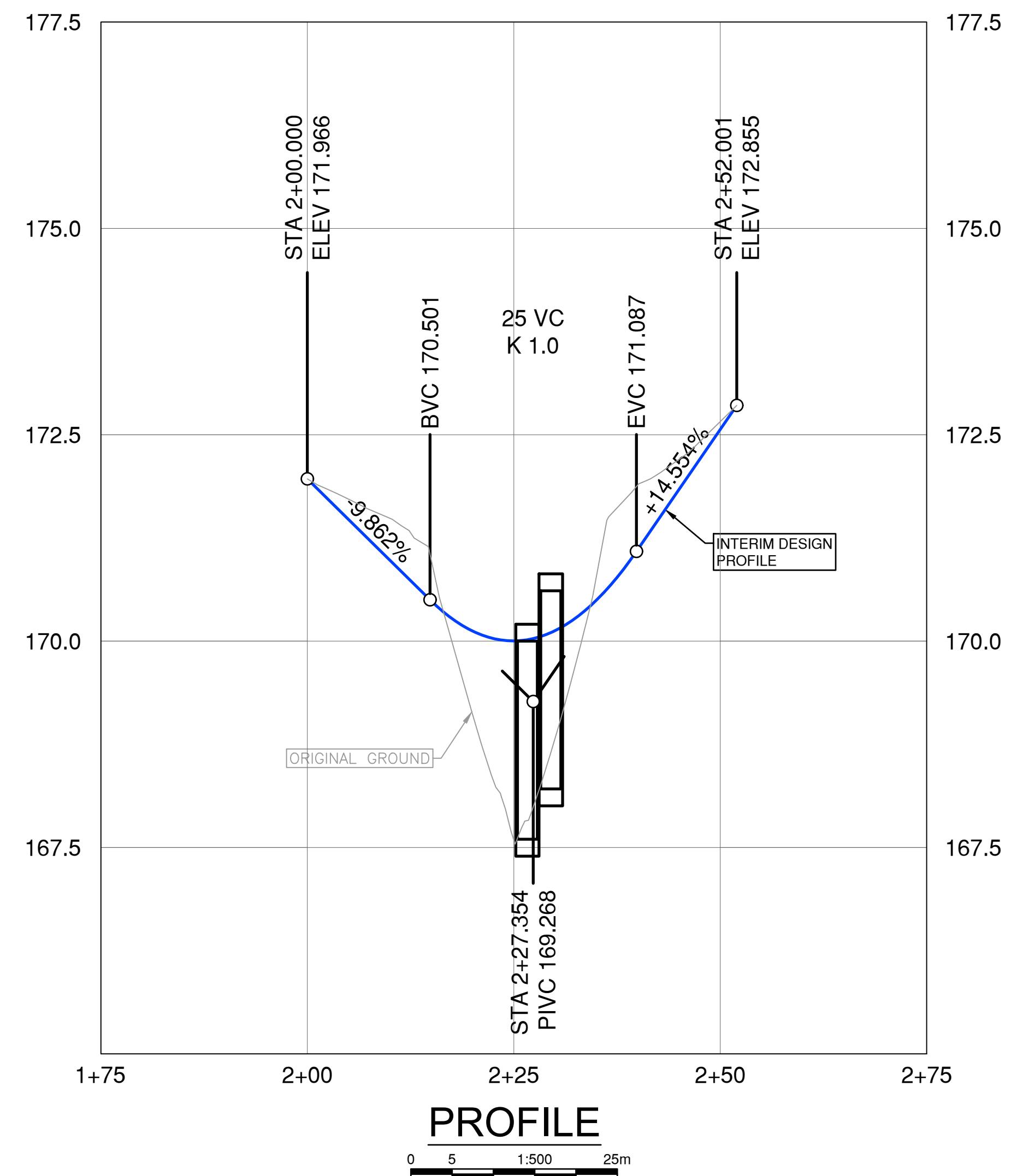
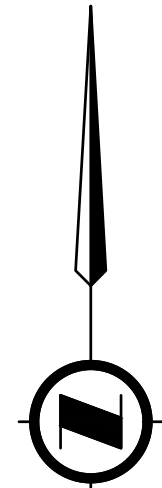
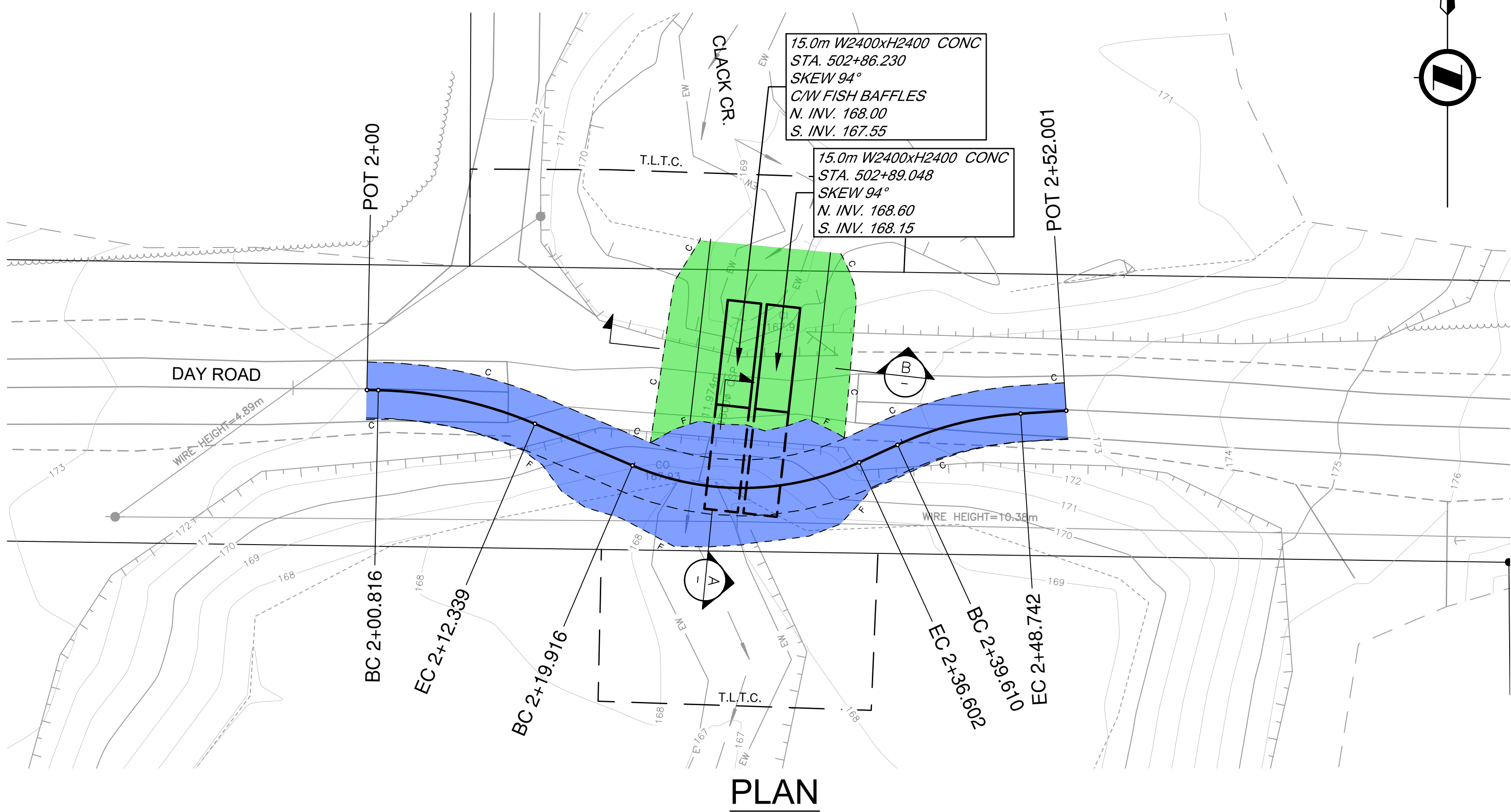
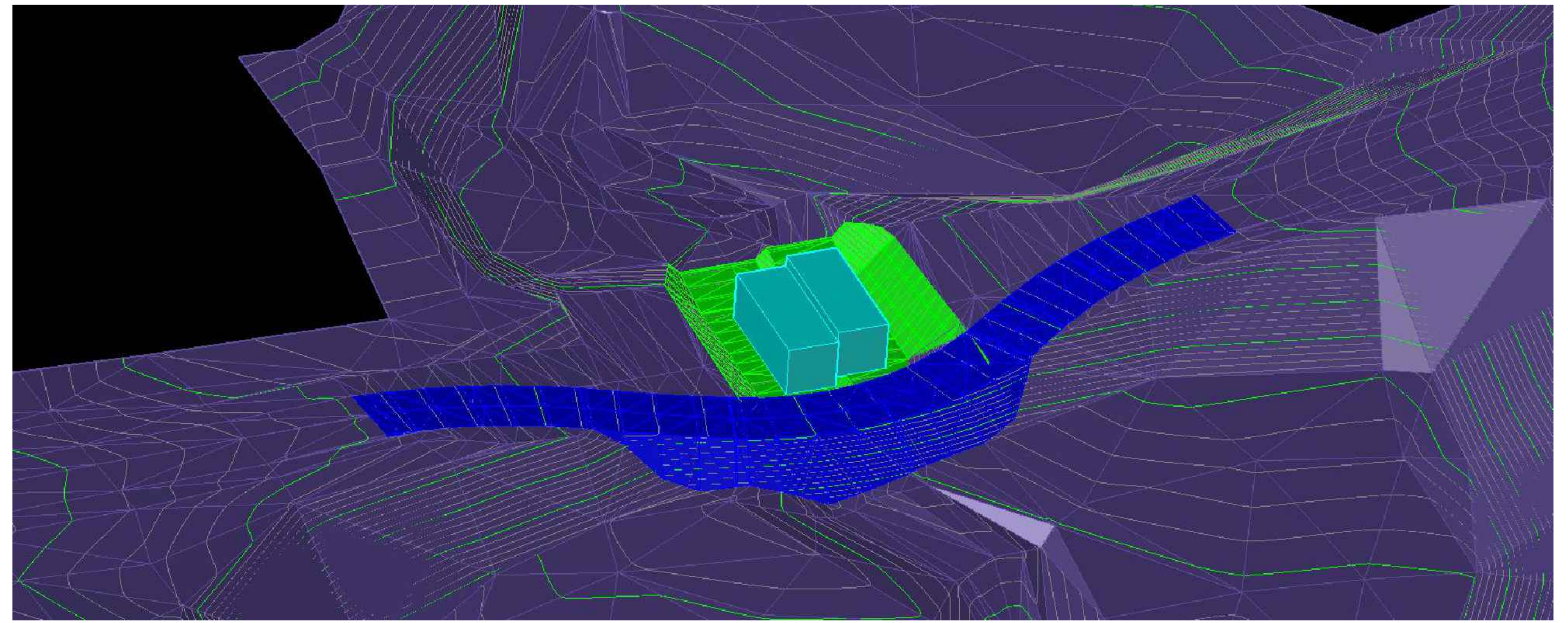
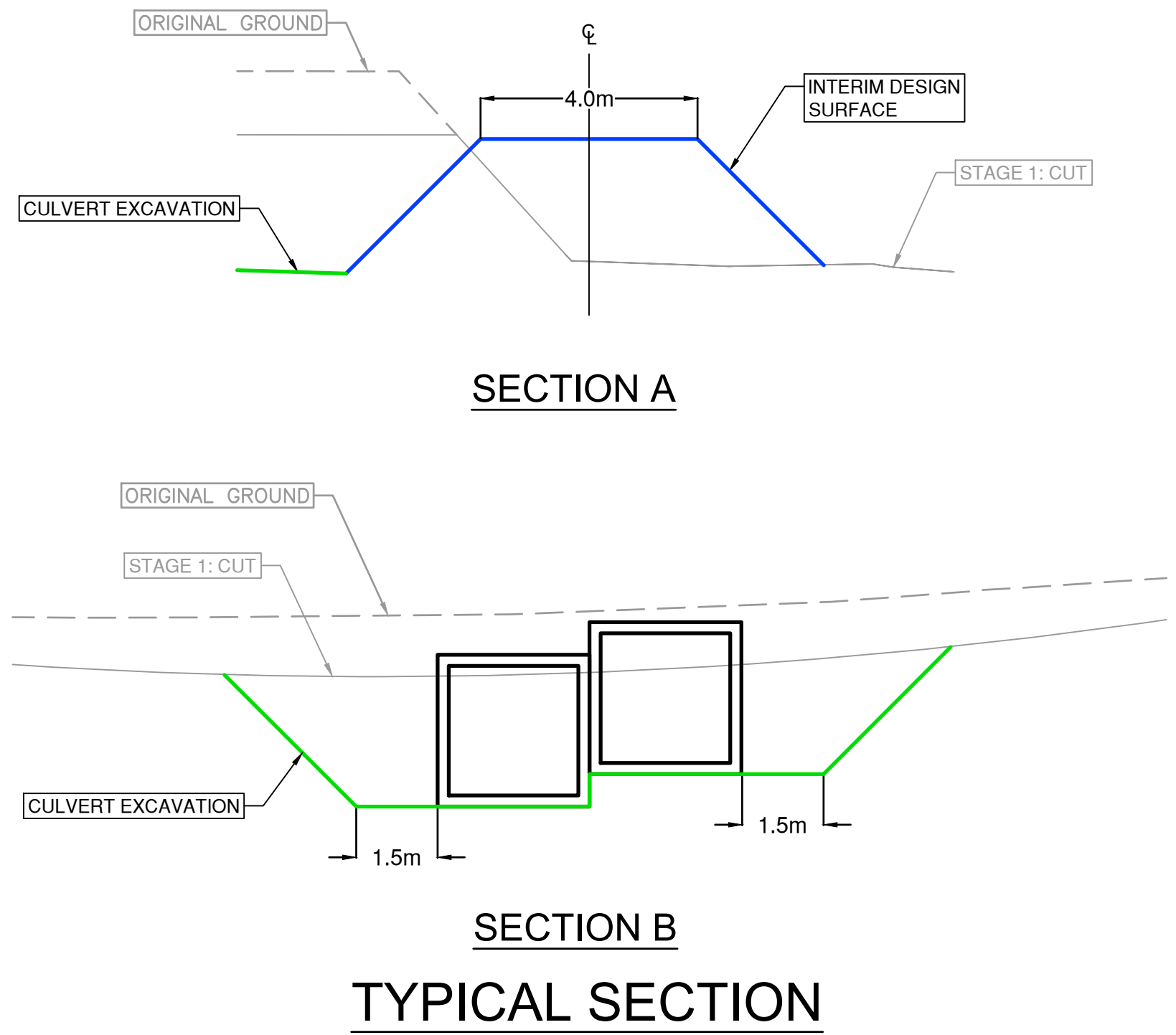

LEGEND

CULVERT EXCAVATION	
INTERIM DESIGN ALIGNMENT	

- SUGGESTED STAGING PROCEDURE:**
1. CONSTRUCT TRAFFIC DIVERSION ALIGNMENT
 2. MOVE VEHICLES TO DIVERTED VEHICLE ALIGNMENT
 3. EXCAVATE AND INSTALL NORTH HALF OF CULVERT

FOR INFORMATIONAL PURPOSES ONLY
2024-03-05
urbansystems.ca



REV	DATE	REVISIONS	NAME	PROFESSIONAL SEALS

BRITISH COLUMBIA
MINISTRY OF TRANSPORTATION AND INFRASTRUCTURE
SOUTH COAST REGION
HIGHWAY ENGINEERING AND GEOMATICS

DESIGNED: S.FUOCO DATE: 2024-03-05
QUALITY CONTROL: S.FUOCO DATE: 2024-03-05
FILE NUMBER: 872CS1714 QUALITY ASSURANCE: C.BAGG DATE: 2024-03-05
PLOT DATE: 2024-03-05 DRAWN: E.PROULX DATE: 2024-03-05

CONCEPTUAL CONSTRUCTION STAGE 2
DAY ROAD - CLACK CREEK

SCALE: AS SHOWN

PROJECT NUMBER	REG	DRAWING NUMBER	REV
14005-0001	1	STAGE 2	

PLOT DATE: 2024-03-05 2:16:17 PM eproux U:\Projects_SUR\1961\0480\13\0-Design\CAD\DrawingProduction\100_Plans\Traffic_Management\Clack_Stage_3 - UpStream Detour.dwg

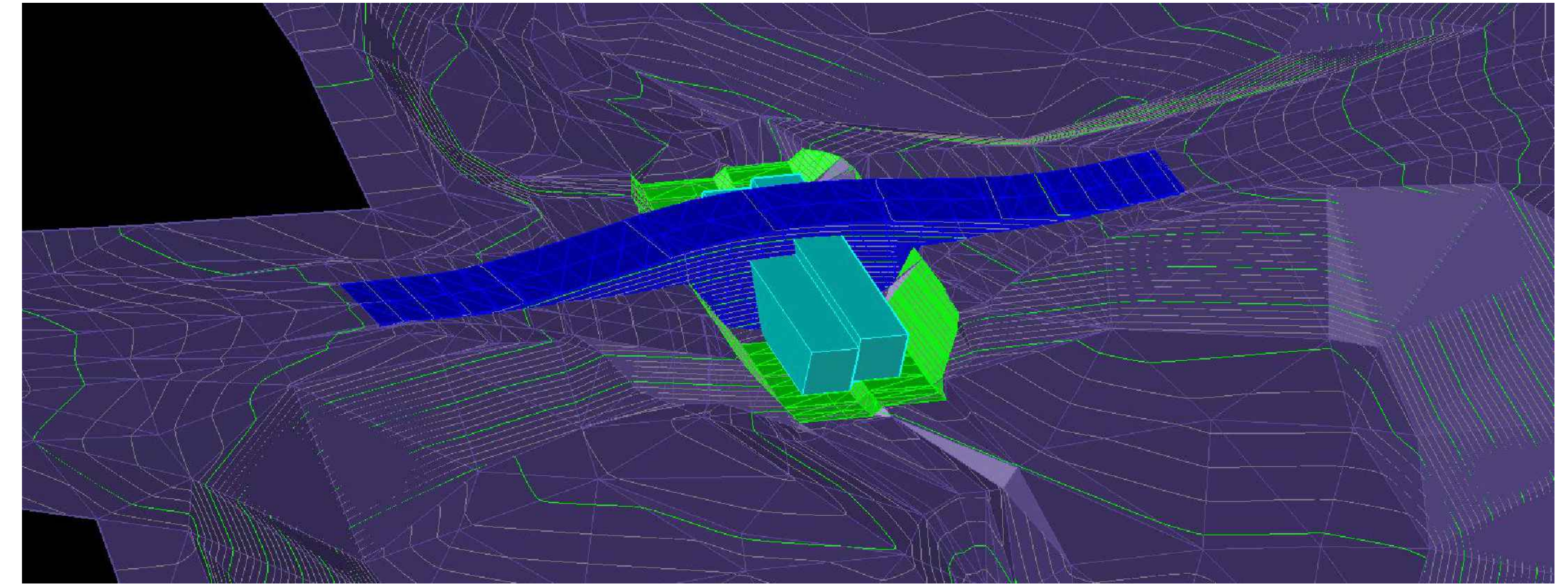
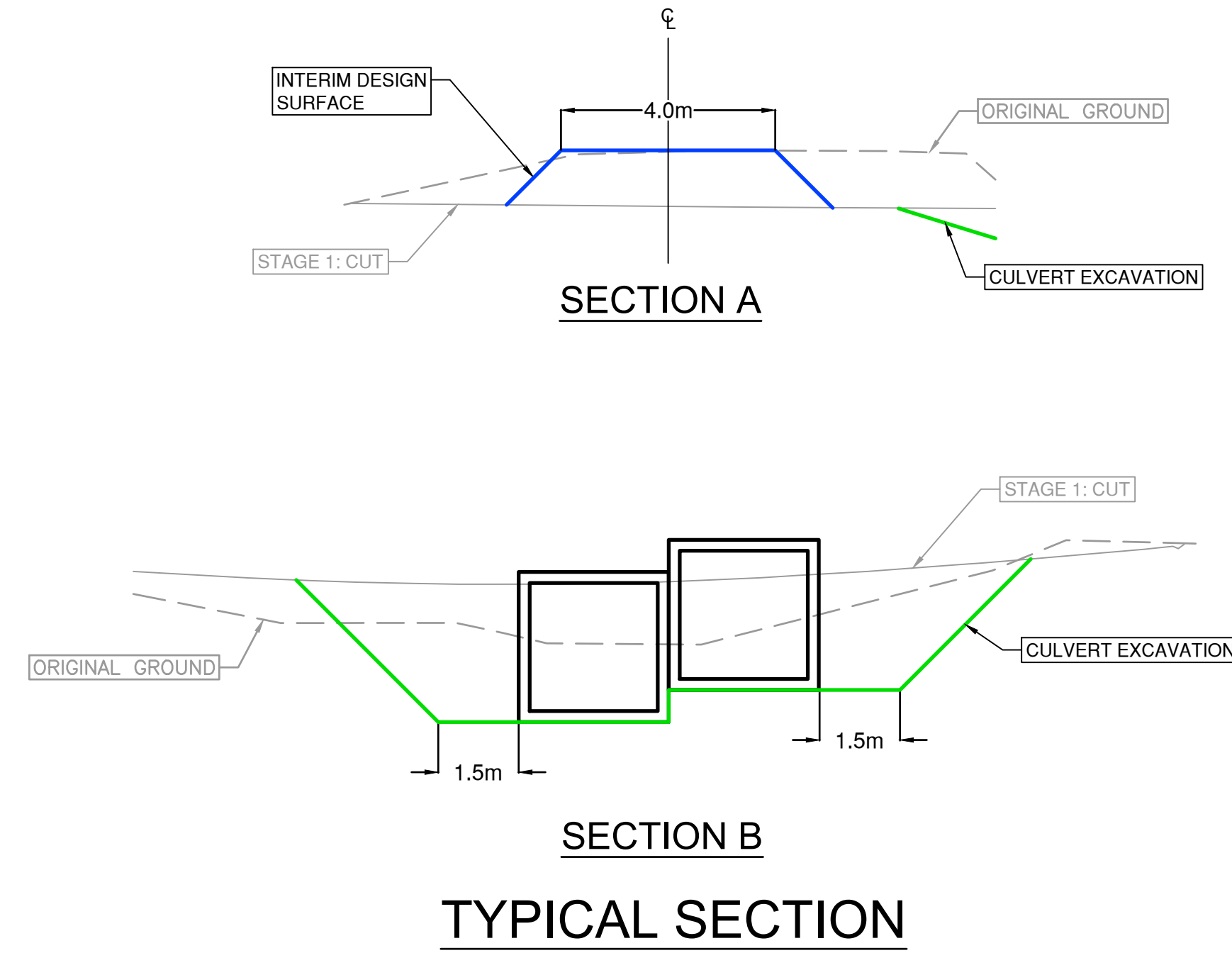

ISOMETRIC VIEW

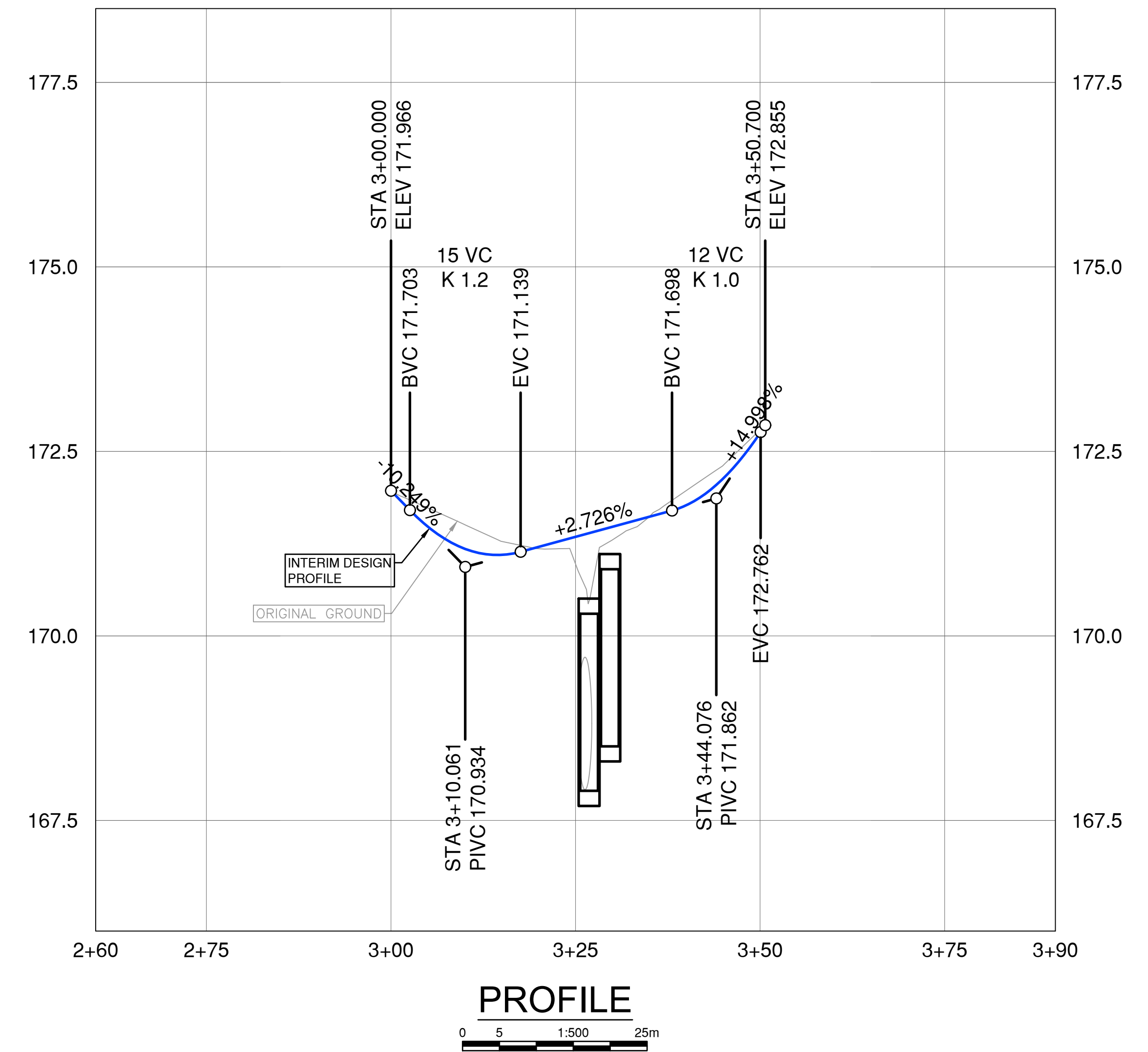
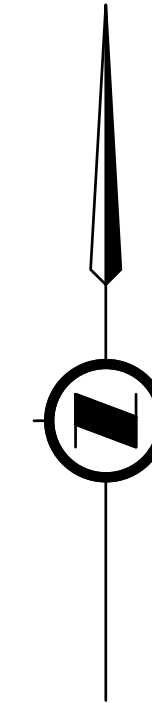
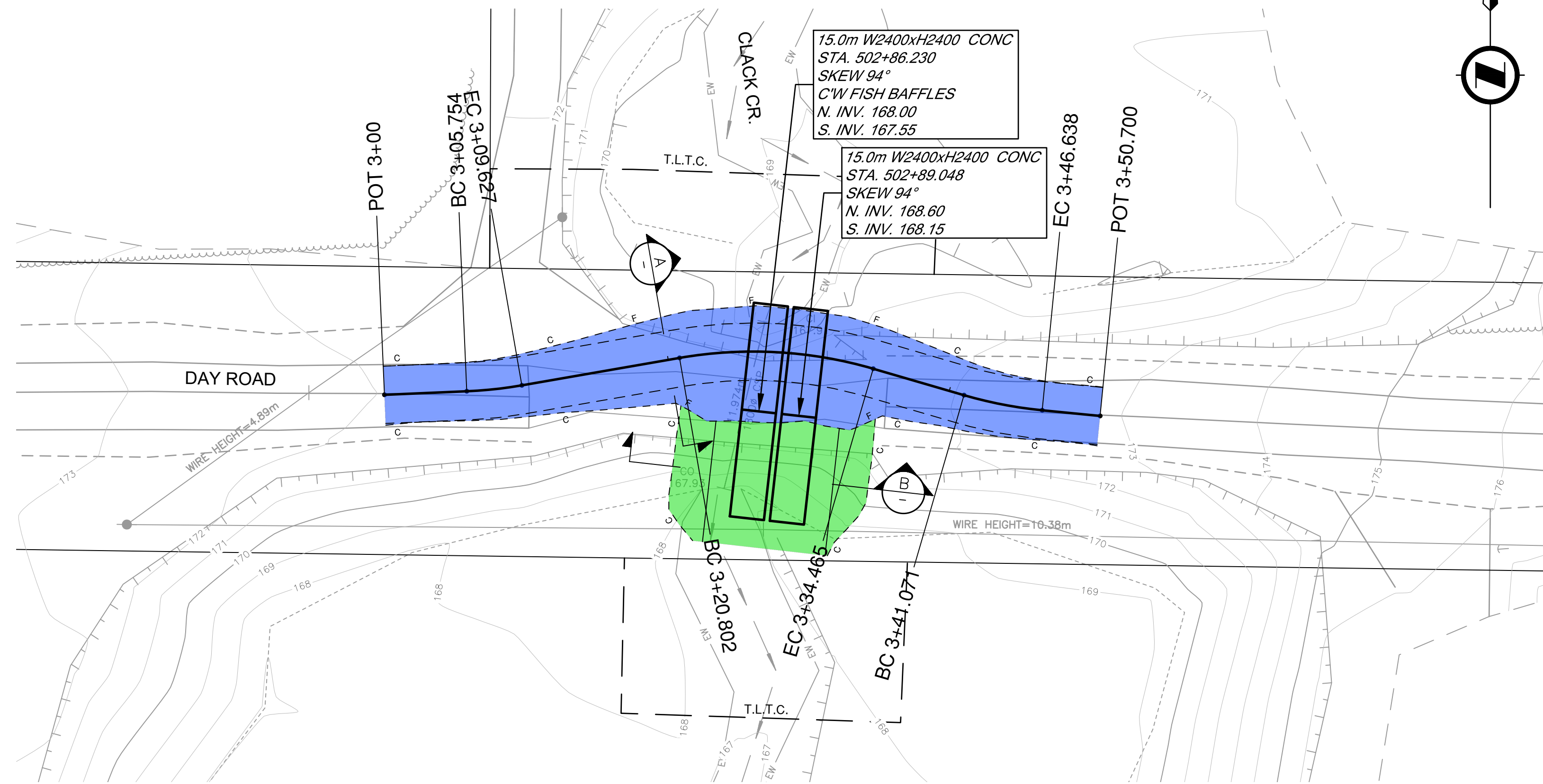

LEGEND

CULVERT EXCAVATION	
INTERIM DESIGN ALIGNMENT	

FOR INFORMATIONAL PURPOSES ONLY

2024-03-05
urbansystems.ca



- SUGGESTED STAGING PROCEDURE:**
1. CONSTRUCT TRAFFIC DIVERSION ALIGNMENT
 2. MOVE VEHICLES TO DIVERTED VEHICLE ALIGNMENT
 3. EXCAVATE AND COMPLETE CULVERT INSTALLATION
 4. REMOVE TEMPORARY CULVERT AND COMPLETE PERMANENT ROAD WORKS



REV	DATE	REVISIONS	NAME	PROFESSIONAL SEALS



MINISTRY OF TRANSPORTATION AND INFRASTRUCTURE
SOUTH COAST REGION
HIGHWAY ENGINEERING AND GEOMATICS



CAD FILENAME: Clack Stage 3 - UpStream Detour
FILE NUMBER: 872CS1714
PLOT DATE: 2024-03-05

DESIGNED: S.FUOCO DATE: 2024-03-05
QUALITY CONTROL: S.FUOCO DATE: 2024-03-05
QUALITY ASSURANCE: C.BAGG DATE: 2024-03-05
DRAWN: E.PROULX DATE: 2024-03-05

SCALE	AS SHOWN	PROJECT NUMBER	14005-0001	REG	1	DRAWING NUMBER	STAGE 3	REV	
-------	----------	----------------	------------	-----	---	----------------	---------	-----	--

CONCEPTUAL CONSTRUCTION STAGE 3
DAY ROAD - CLACK CREEK