

LOCATION MAP

DISCLAIMER:

1. THE DRAWING IS PROJECT SPECIFIC AND PROPERTY OF TELUS, THE DRAWING SHALL NOT BE USED WITHOUT THE CONSENT OF TELUS.
2. LTS DOES NOT ASSUME RESPONSIBILITY FOR THE ACCURACY OF THE CONTENTS WHETHER SHOWN OR OMITTED FROM THIS DRAWING BEYOND THE REQUIREMENTS LISTED IN APPROVING AUTHORITY REQUIREMENTS.
3. THIS DRAWING SHALL BE USED IN CONJUNCTION WITH IFC DRAWINGS. CONSTRUCTION SHALL VERIFY COMPLETENESS OF ALL POWER UTILITY AND TELUS MAKE READY BEFORE LASHING NEW CABLES.

CONSTRUCTION NOTES:

1. ALL WORKMANSHIP MUST BE IN ACCORDANCE WITH THE APPLICABLE EDITION OF THE TELUS OUTSIDE PLANT PRACTICE & STANDARDS (TOPPS).
2. ALL STRANDS TO CONFORM TO CSA GRADE 1300.
3. ALL STRANDS INSTALLED MUST BE SIZE 8 (8.4MM DIAMETER) UNLESS NOTED.
4. ALL DOWN GUYS INSTALLED MUST BE SIZE 10 (10.7MM DIAMETER) W/ JOHNNY BALL STRAIN INSULATOR UNLESS NOTED.
5. ALL ANCHORS INSTALLED MUST BE 25MM (1 IN) ROD, 0.25 SQ-M (400 SQ IN) CROSS-PLATE WITH MINIMUM SHAFT CAPACITY OF 160 KN (36M) UNLESS NOTED.
6. FOR SINGLE GUY ATTACHMENTS ONLY, CROSS-PLATE ANCHORS MAY BE SUBSTITUTED WITH PISA 25MM (1 IN) ROD, (10 IN) DOUBLE HELIX ANCHOR WITH MINIMUM SHAFT CAPACITY OF 138 KN (31 M).
7. YELLOW DOWNHAUL GUARDS SHALL BE INSTALLED AS PER TOPPS 1.1.1.11, JUB024.
8. POLE LINE EXTENSION BOLT STRAP TO CONFORM TO TOPPS 1.1.2.4.5
9. ATTACHING GUYS (POLE AND RODS) TO CONFORM TO TOPPS 1.1.1.4

LEGEND

	PROPOSED SERVICE BOX / FDH
	PROPOSED MANHOLE
	PROPOSED SERVICE VAULT
	PROPOSED PEDESTAL
	PROPOSED CONDUIT (OPEN TRENCH)
	PROPOSED CONDUIT (DIRECTIONAL DRILL)
	PROPOSED DROP CONDUIT
	WATER MAIN
	SEWER MAIN
	SANITARY MAIN
	STORM MAIN
	GAS MAIN
	TEL DUCTS
	CATV DUCTS
	POWER DUCTS
	PIPELINE
	STREETLIGHT
	ABANDONED UTILITY
	EDGE OF PAVEMENT
	BACK OF CURB
	POLE (W/ ANCHOR)

CONSTRUCTION NOTES

1. ELEVATIONS REFER TO _____ DATUM.
2. CONDUIT GRADE ON PROFILE IS APPROXIMATE ONLY. FINISHED GRADE WILL BE SUBJECT TO LOCATION OF EXISTING UNDERGROUND UTILITIES.
3. MINIMUM COVER CONDUIT **0.91m** ALL SECTIONS EXCEPT WHERE OTHERWISE NOTED. MANHOLE ROOF **0.46m**
4. ALL DUCTS TO BE 100mm P.V.C. DB II (ORANGE) UNLESS OTHERWISE NOTED.
5. ALL MANUFACTURED BENDS TO BE **0.91m** RADIUS UNLESS OTHERWISE NOTED.
6. ALL CONCRETE PILASTERS TO BE **0.30m** ABOVE GRADE UNLESS OTHERWISE NOTED.
7. CONTRACTOR IS TO PROVE THE LOCATIONS OF ALL EXISTING UNDERGROUND UTILITIES AND SERVICES AFFECTED BY CONSTRUCTION BY M-SCOPE, HAND EXCAVATION OR BC ONE CALL.
8. FOR CABLE TROUBLE OR REPAIR INFORMATION, CONTACT TELUS AT 611.
9. TEMPORARY/PERMANENT RESTORATION IN ALL PAVED/SIDEWALK AREAS TO BE DONE IN ACCORDANCE WITH ALL APPROVING AUTHORITIES SPECIFICATIONS AND APPROVAL.
10. PERMANENT SIDEWALK AND CURB REPAIRS TO BE DONE BY **CONTRACTOR**. PERMANENT ROAD REPAIRS TO BE DONE BY **CONTRACTOR**.
11. PERMANENT BOULEVARD RESTORATION TO BE DONE BY CONTRACTOR.
12. ALL LANDSCAPE RESTORATION IN LAWN BOULEVARDS MUST BE DONE BY USING SUITABLE GRASS SOD.
13. CONTRACTOR TO CONTACT THE APPROPRIATE GAS COMPANY RECORDS DEPARTMENT 24 HOURS PRIOR TO STARTING WORK.
14. CONTRACTOR TO CONTACT THE CITY/MUNICIPAL WORKS INSPECTOR 48 HOURS PRIOR TO STARTING WORK.
15. CONTRACTOR TO CALL BC ONE CALL (FOR BC) OR AB ONE CALL (FOR ALBERTA) 48 HOURS PRIOR TO DIGGING.
16. ALL BACKFILL MATERIAL AND COMPACTION TO BE IN ACCORDANCE WITH ALL APPROVING AUTHORITIES SPECIFICATIONS.
17. ALL DIRECT BURIED SYSTEMS 2-WAY AND LARGER TO BE BUNDLED AND STRAPPED.
18. TELUS CONTRACTOR TO SUPPLY AND PLACE AN ENCLOSED PLYWOOD BOX OVER SAC PAD DUCTS AND SECURED TO FRAME.
19. BREAK OUT EXISTING CONCRETE ENCASED DUCTS: ANY JACK-HAMMERING OR USE OF POWER TOOLS TO BE CARRIED OUT BY CONTRACTOR. ALL HAND STRIPPING OF DUCTS, BREAKING OF DUCTS AND/OR HANDLING OF CABLES TO BE DONE BY TELUS FORCES.
20. EXISTING CONDUIT TO BE RELOCATED IF REQUIRED TO ENSURE SPECIFIED ENTRANCE LOCATIONS INTO MANHOLE/VAULT. CONTRACTOR TO PROVIDE EXCAVATION, BACK-FILLING AND RESTORATION IF RELOCATION BECOMES NECESSARY.
21. ORANGE TELUS MARKER TAPE TO BE PLACED ON CENTERLINE OF DUCT BANK @ 300mm BELOW FINAL GRADE.
22. CONTACT TELUS 10 DAYS BEFORE PROJECT START TO ARRANGE PICKUP LOCATION OF TELUS SUPPLIED MATERIAL. BC: KATHY MIDWOOD (Kathy.Midwood@Telus.com) at 604-453-2037
23. SUBGRADE & DIRECT BURIED MATERIAL WHERE APPLICABLE SHALL BE 20mm MINUS CRUSHED AGGREGATE.
24. BACKFILL MATERIAL SHALL BE:
IN ROADWAYS/TRAVELLED AREAS **20mm MINUS**
IN SIDEWALK/TRAVELLED AREAS **20mm MINUS**
IN BOULEVARD/UNTRAVELLED AREAS **20mm MINUS**
25. CONTRACTOR TO PULL IN A TELUS SUPPLIED MEASURING TAPE THRU ONE DUCT IN EACH RUN AFTER MANDRELLING, LOCATION TO BE DETERMINED BY TELUS.
26. MINIMUM SEPARATION FROM ALL UTILITIES TO BE 300mm.
27. ALL DIMENSIONS IN mm UNLESS OTHERWISE NOTED

ONECALL TICKET NO: 20230603816

GENERAL NOTES	REFERENCE DRAWINGS		REVISIONS				DES	CHK
	DRAWING #	TITLE	REV	DATE	DESCRIPTION			
ALL HYDROVAC SLURRY MUST BE PROPERLY DISPOSED AT A PROVINCIALLY APPROVED FACILITY. RECORD KEEPING, INCLUDING THE HYDROVAC OPERATOR NAME, DATE, LOCATION WHERE THE MATERIAL WAS EXTRACTED AND DISPOSED AND AMOUNT AND CONTENT OF SLURRY, MUST BE MAINTAINED AND MADE AVAILABLE ON REQUEST.			0	2023-10-19	ISSUED FOR CONSTRUCTION	ER	FLD	
			1	2024-03-19	REVISED POLE LOCATION	ER	JB	
			2	2024-04-18	REVISED GRADE CHANGE NOTE	ER	JB	

BC ONE CALL
CALL BEFORE YOU DIG
1-800-464-6886
OR BY CELLULAR *6886
VANCOUVER AREA
257-1940

CALL AT LEAST 2 FULL DAYS BEFORE YOU PLAN TO DIG

CONSTRUCTION NOTE:
- ALL EXISTING UTILITIES TO BE LOCATED PRIOR TO CONSTRUCTION
- CONTACT LTS ENGINEERING FOR CHANGES TO THE APPROVED DRAWING.
(LTS@TELUSADESIGN@LEDCOR.COM)

CONTACT INFORMATION		
TELUS DESIGN SPECIALIST	SITE CONTACT	
JASON NG 236 989-7065 JASON.NG2@TELUS.COM	JACK CHEN 250-889-1638 JACK.CHEN@GOV.BC.CA	
DESIGNER	SENIOR DESIGNER	
EZEKIEL RAI 778-945-3384 EZEKIEL.RAI@LEDCOR.COM	FAYE LIMBO DE JESUS 604-699-2730 FAYE.LIMBODEJESUS@LEDCOR.COM	
PREPARED FOR	PREPARED BY	IN PARTNERSHIP WITH
TELUS	LEDCOR	

BC GROWTH AND SUSTAINMENT

PERMIT DESIGN FOR POLE RELOCATION
TRANS-CANADA HWY AND ROSS RD, CITY OF ABBOTSFORD
MINISTRY OF TRANSPORTATION AND INFRASTRUCTURE

NTS

DRAWING #	2897429_P1	JIRA ID	GS-102178	SHEET: 1	DATE: 2024-04-18
PROJECT #	P-2023290.01	COID	LNGL	TOTAL SHEETS: 2	REVISION: 2

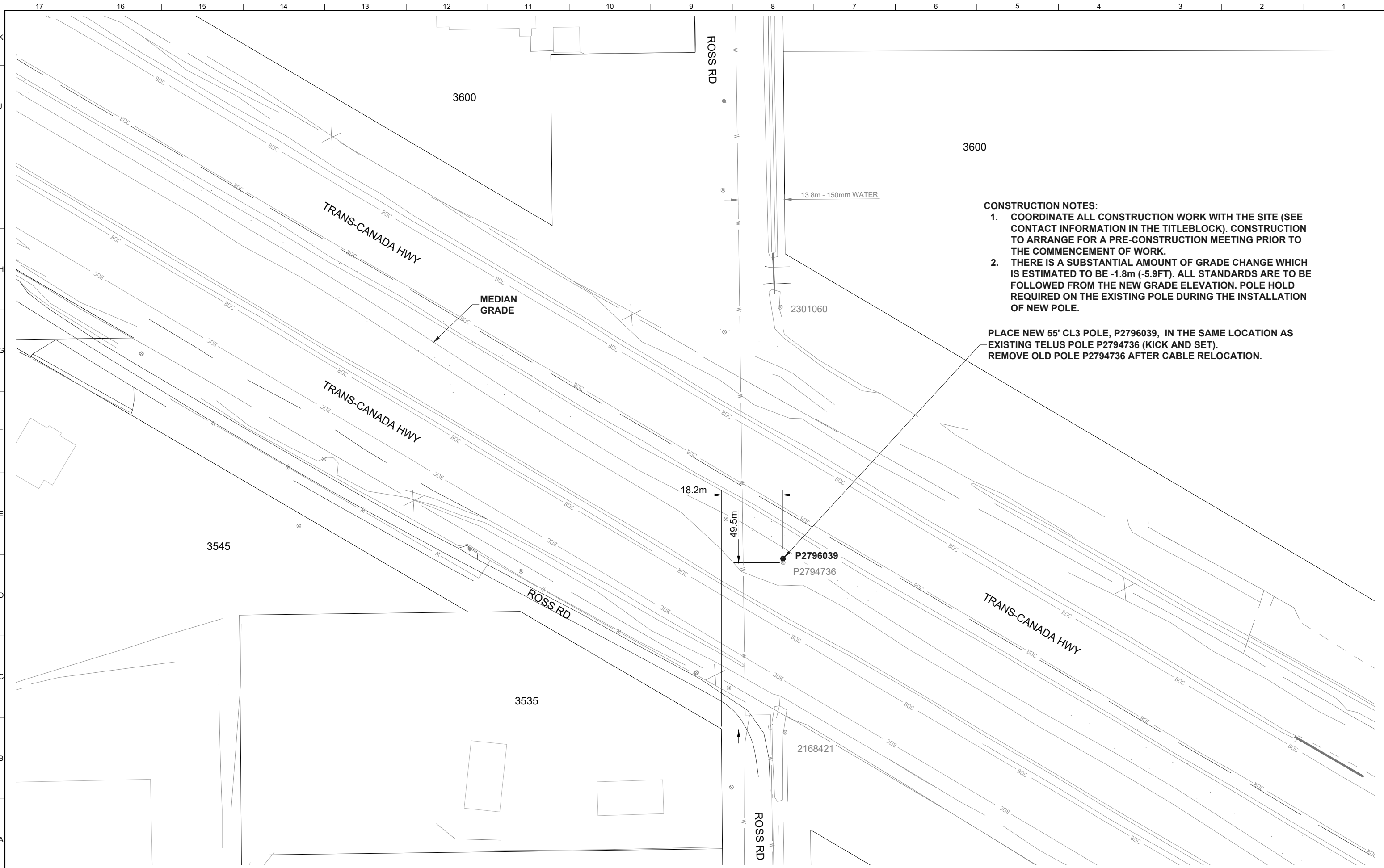

- CONSTRUCTION NOTES:**
- COORDINATE ALL CONSTRUCTION WORK WITH THE SITE (SEE CONTACT INFORMATION IN THE TITLEBLOCK). CONSTRUCTION TO ARRANGE FOR A PRE-CONSTRUCTION MEETING PRIOR TO THE COMMENCEMENT OF WORK.
 - THERE IS A SUBSTANTIAL AMOUNT OF GRADE CHANGE WHICH IS ESTIMATED TO BE -1.8m (-5.9FT). ALL STANDARDS ARE TO BE FOLLOWED FROM THE NEW GRADE ELEVATION. POLE HOLD REQUIRED ON THE EXISTING POLE DURING THE INSTALLATION OF NEW POLE.

PLACE NEW 55' CL3 POLE, P2796039, IN THE SAME LOCATION AS EXISTING TELUS POLE P2794736 (KICK AND SET). REMOVE OLD POLE P2794736 AFTER CABLE RELOCATION.

GENERAL NOTES

ALL HYDROVAC SLURRY MUST BE PROPERLY DISPOSED AT A PROVINCIALLY APPROVED FACILITY. RECORD KEEPING, INCLUDING THE HYDROVAC OPERATOR NAME, DATE, LOCATION WHERE THE MATERIAL WAS EXTRACTED AND DISPOSED AND AMOUNT AND CONTENT OF SLURRY, MUST BE MAINTAINED AND MADE AVAILABLE ON REQUEST.

DRAWING #	TITLE

REV	DATE	DESCRIPTION	DES	CHK
0	2023-10-19	ISSUED FOR CONSTRUCTION	ER	FLD
1	2024-03-19	REVISED POLE LOCATION	ER	JB
2	2024-04-18	REVISED GRADE CHANGE NOTE	ER	JB

BC ONE CALL
 CALL BEFORE YOU DIG
 1-800-464-8888
 OR BY CELLULAR 9888
 VANCOUVER AREA
 257-1940

CALL AT LEAST 2 FULL DAYS BEFORE YOU PLAN TO DIG

CONSTRUCTION NOTE:
 * ALL EXISTING UTILITIES TO BE LOCATED PRIOR TO CONSTRUCTION
 * CONTACT LTS ENGINEERING FOR CHANGES TO THE APPROVED DRAWING (LTS@TELUSBAUDSIGN@LEDCOR.COM)

CONTACT INFORMATION		SITE CONTACT	
TELUS DESIGN SPECIALIST		JACK CHEN	
JASON NG 236 989-7065 JASON.NG2@TELUS.COM		250-889-1638 JACK.CHEN@GOV.BC.CA	
DESIGNER		SENIOR DESIGNER	
EZEKIEL RAI 778-945-3384 EZEKIEL.RAI@LEDCOR.COM		FAYE LIMBO DE JESUS 604-699-2730 FAYELIMBODEJESUS@LEDCOR.COM	
PREPARED FOR	PREPARED BY	IN PARTNERSHIP WITH	
TELUS	LEDCOR		

BC GROWTH AND SUSTAINMENT				
PERMIT DESIGN FOR POLE RELOCATION				
TRANS-CANADA HWY AND ROSS RD, CITY OF ABBOTSFORD				
MINISTRY OF TRANSPORTATION AND INFRASTRUCTURE				
1:1000 (m)				
0 10 20 30 40				
DRAWING #	2897429_P1	JIRA ID	GS-102178	SHEET: 2
PROJECT #	P-2023290.01	COID	LNGL	TOTAL SHEETS: 2
				REVISION: 2
				DATE: 2024-04-18