

PLOT DATE: 2024/05/02 H:\DATA\689993 - hwy 3 snass creek bridge\drawingproduction\100_Plan\Staging\SK-06 TO SK-09 - 100%DD_STAGING.dwg

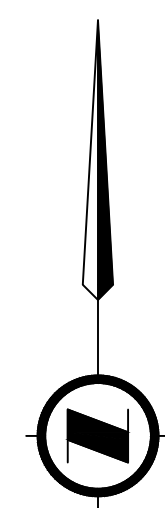

HIGHWAY #3

MAINTAIN EXISTING 2 LANES OF TRAFFIC

EX. HIGHWAY ROW

DETOUR BRIDGE

STAGE 1:
INSTREAM WORKS

STAGE 1: CONSTRUCT DETOUR

EX. HIGHWAY ROW
PROPOSED HIGHWAY ROW

N 641200
E 454600

N 641200
E 454700

N 641200
E 454600

N 641200
E 454600

N 641200
E 454700

N 641200
E 454600

STAGE 1

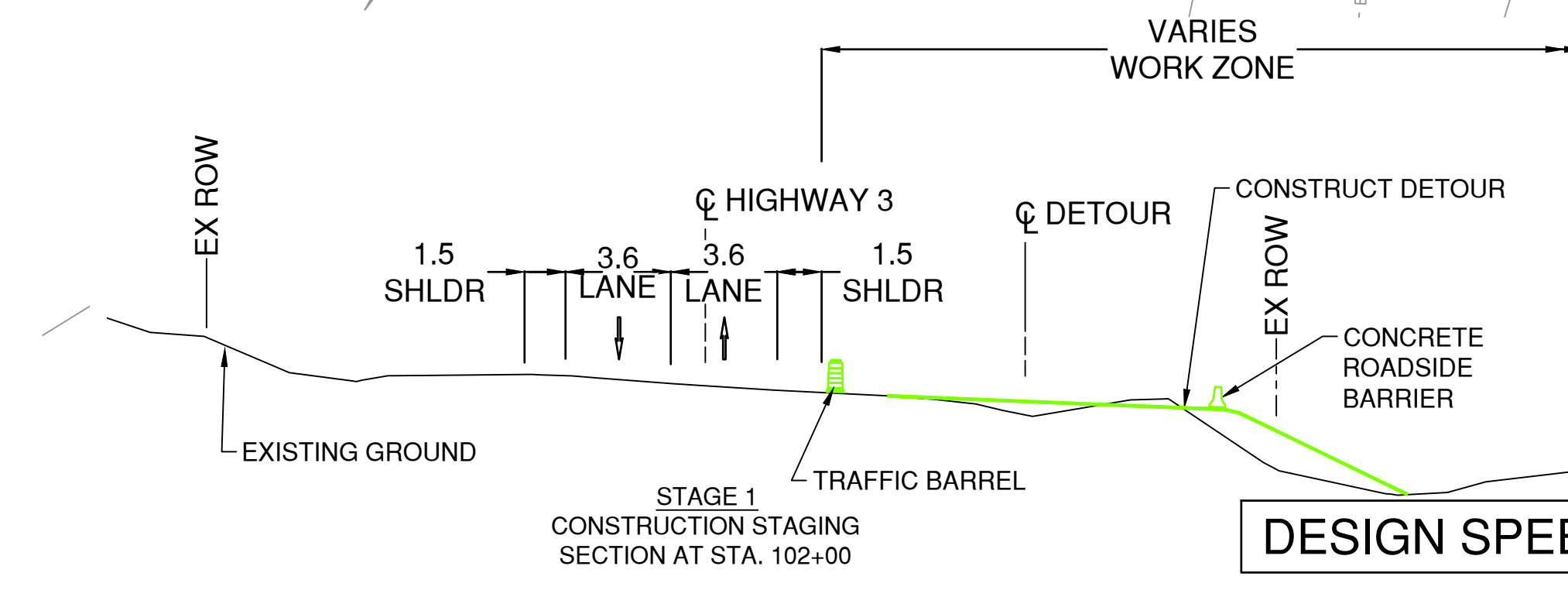

		SNC-Lavalin Inc. Suite 1100 - 745 Thurlow St. Vancouver British Columbia V6E 0C5 Canada			
SCALE 0 5 1:500 25m		SK-06 TO SK-09 - 100%DD STAGING		CAD FILENAME	
		PLOT DATE 2024-05-02			
REV	DATE	REVISIONS	NAME		
-	2024-05-03	ISSUED FOR REFERENCE	M. TROST		

		MINISTRY OF TRANSPORTATION AND INFRASTRUCTURE SOUTH COAST REGION HIGHWAY ENGINEERING AND GEOMATICS			
SUGGESTED CONSTRUCTION STAGING					
HIGHWAY 3 SNASS CREEK BRIDGE No. 1214					
DESIGNED <u>G. CHOW</u> DATE <u>2024-05-03</u>		QUALITY CONTROL <u>M. TROST</u> DATE <u>2024-05-03</u>		QUALITY ASSURANCE <u>R. WONG</u> DATE <u>2024-05-03</u>	
ENGINEER OF RECORD		DRAWN <u>D. MANDIC</u> DATE <u>2024-05-03</u>		DATE	
FILE NUMBER 689993	PROJECT NUMBER 12712-0001	REG 1	DRAWING NUMBER SK-06	REV -	

PLOT DATE: 2024/05/03 H:\DATA\689993 - Hwy 3 Snass Creek Bridge\DrawingProduction\100_Plans\Staging\SK-06 TO SK-09 - 100%DD STAGING.dwg

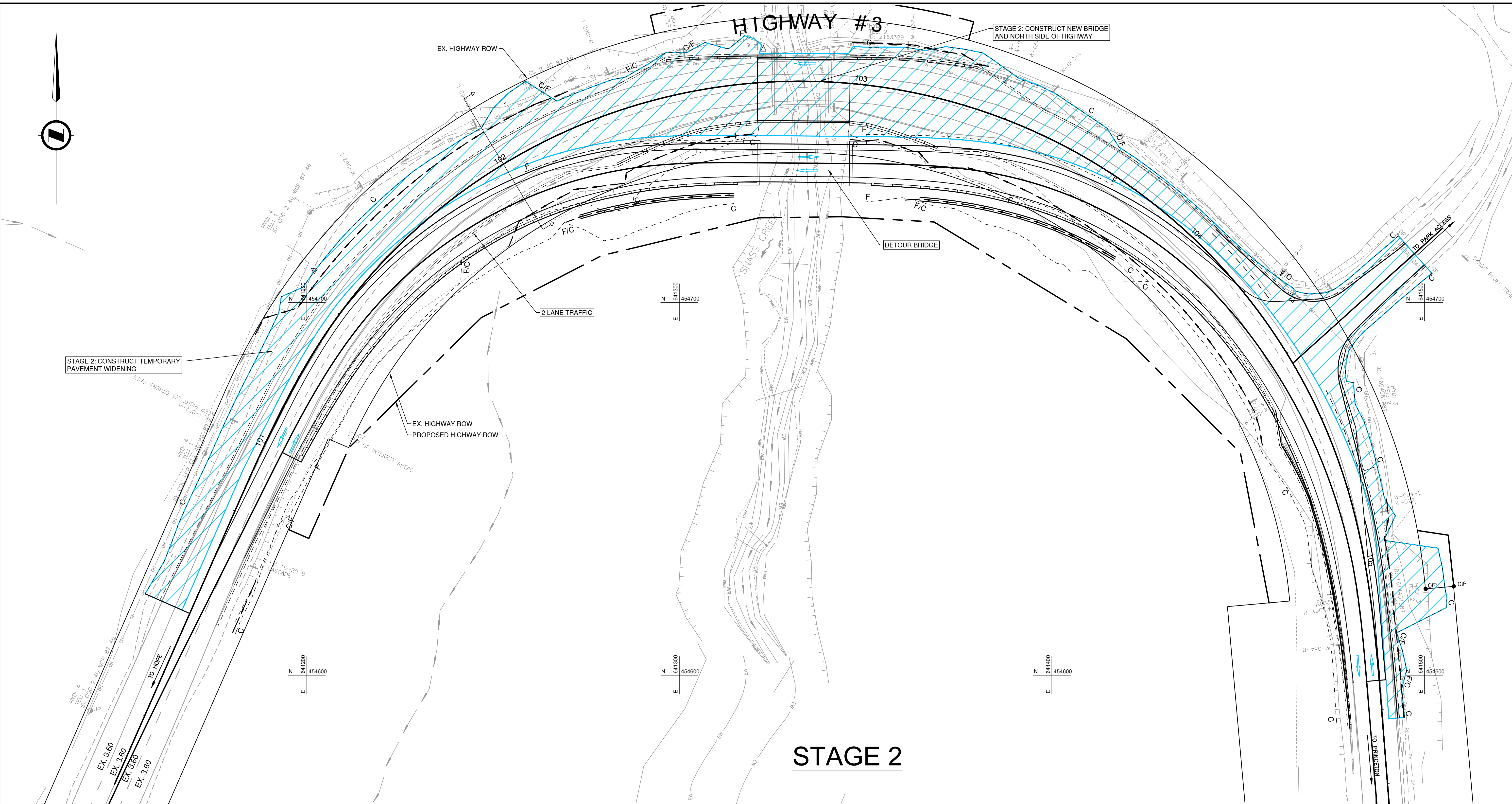
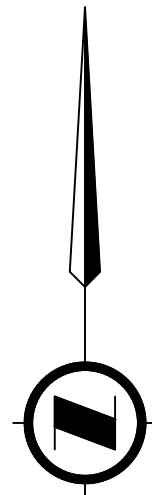

STAGE 2

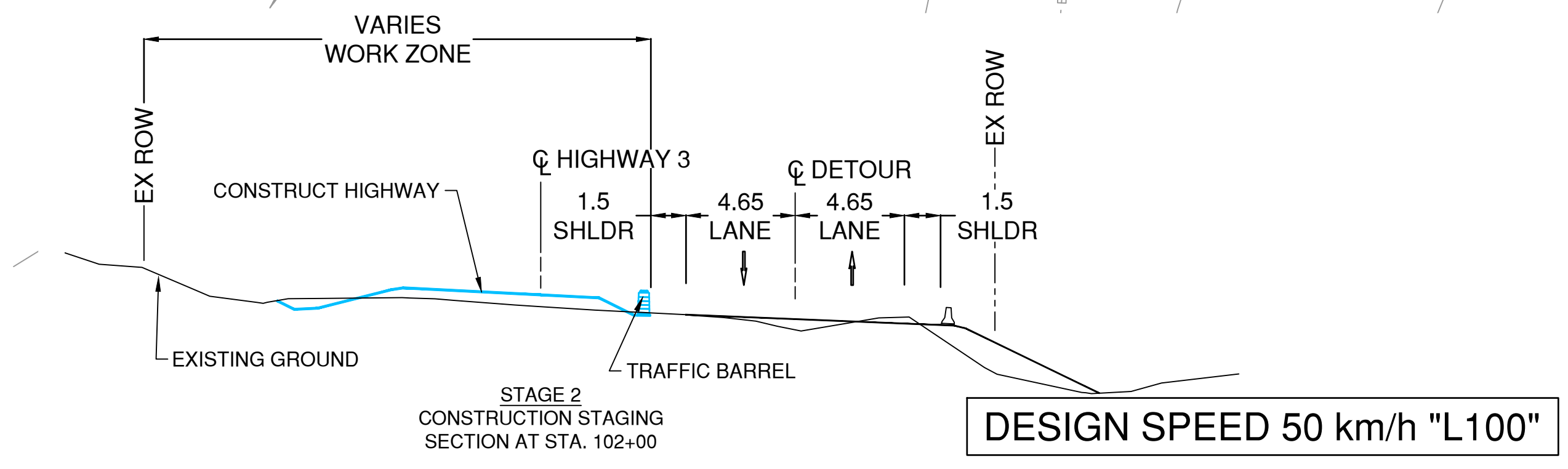

SNC-LAVALIN

SNC-Lavalin Inc.
Suite 1100 - 745 Thurlow St.
Vancouver | British Columbia
V6E 0C5 | Canada

SK-06 TO SK-09 -
100%DD STAGING

CAD FILENAME: _____
PLOT DATE: 2024-05-03

REV	DATE	REVISIONS	NAME
-	2024-05-03	ISSUED FOR REFERENCE	M. TROST

BRITISH COLUMBIA

MINISTRY OF TRANSPORTATION AND INFRASTRUCTURE
SOUTH COAST REGION
HIGHWAY ENGINEERING AND GEOMATICS

SUGGESTED CONSTRUCTION STAGING

HIGHWAY 3
SNASS CREEK BRIDGE No. 1214

DESIGNED: G. CHOW	DATE: 2024-05-03
QUALITY CONTROL: M. TROST	DATE: 2024-05-03
QUALITY ASSURANCE: R. WONG	DATE: 2024-05-03
DRAWN: D. MANDIC	DATE: 2024-05-03

ENGINEER OF RECORD	PERMIT TO PRACTICE NUMBER	REG	DRAWING NUMBER	REV
DATE	FILE NUMBER	PROJECT NUMBER	1	SK-07
	689993	12712-0001		-

PLOT DATE: 2024/05/03 H:\DATA\689993 - Hwy 3 Snass Creek Bridge\DrawingProduction\100_Plans\Staging\SK-06 TO SK-09 - 100%DD STAGING.dwg

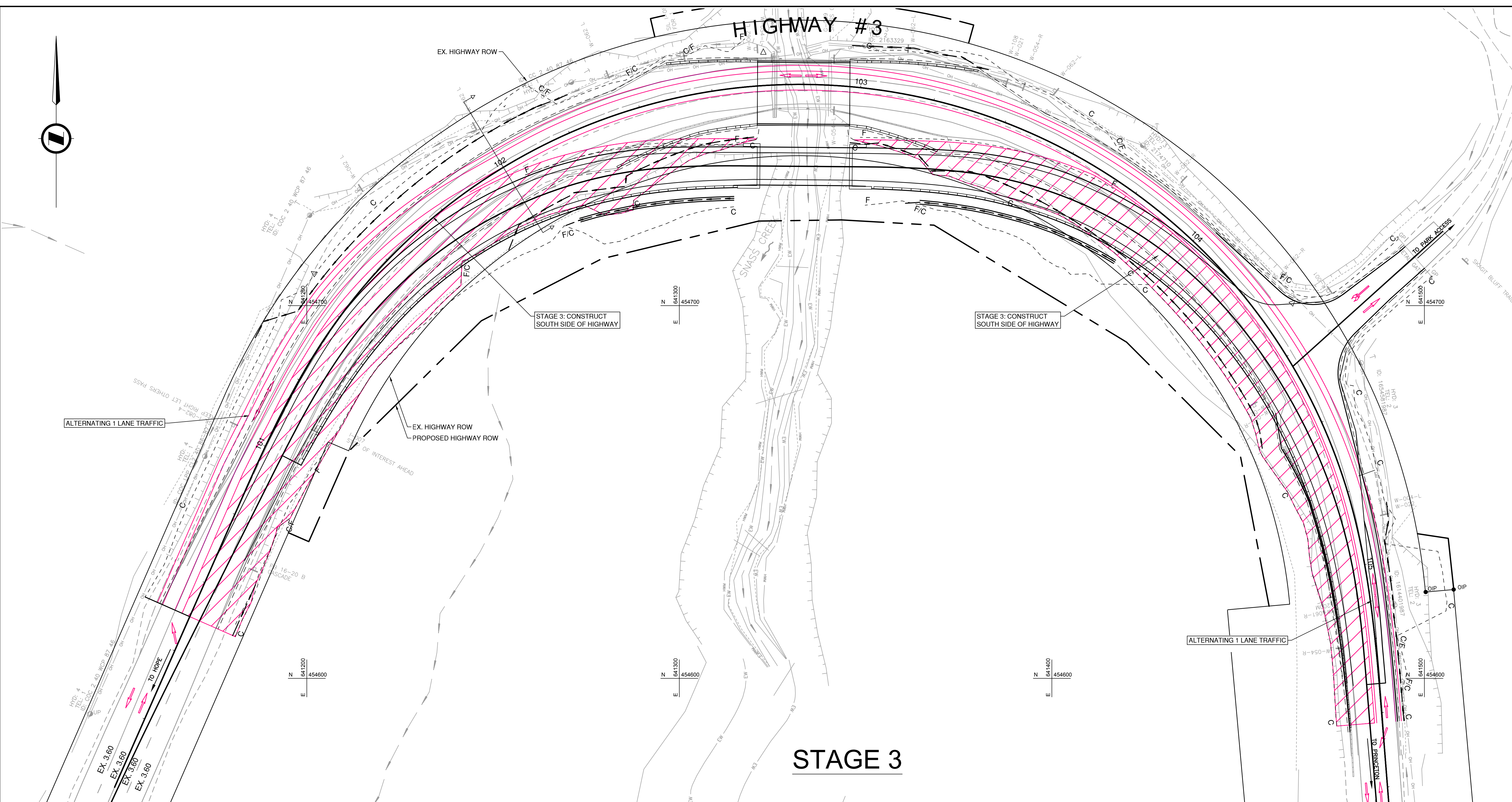
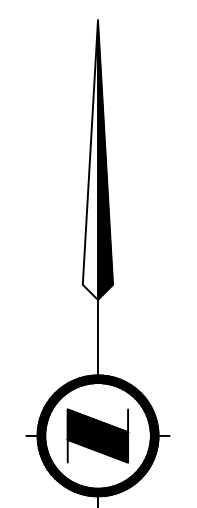

STAGE 3

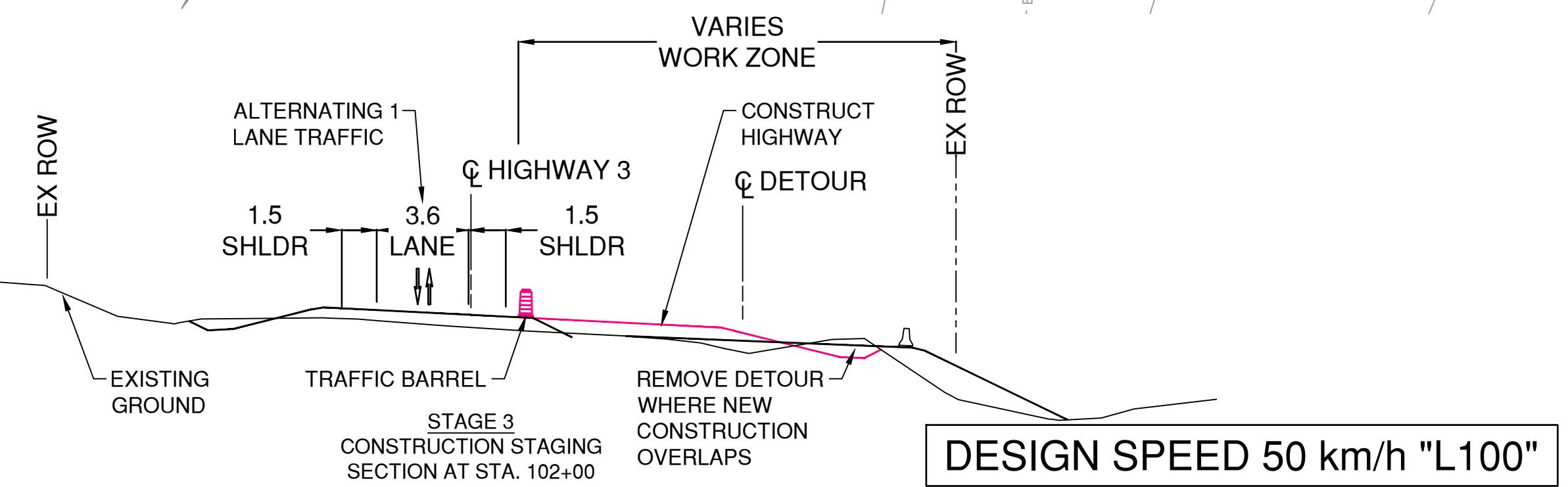

SNC-LAVALIN

SNC-Lavalin Inc.
Suite 1100 - 745 Thurlow St.
Vancouver | British Columbia
V6E 0C5 | Canada

BRITISH COLUMBIA
MINISTRY OF TRANSPORTATION
AND INFRASTRUCTURE
SOUTH COAST REGION
HIGHWAY ENGINEERING AND GEOMATICS

SCALE: 0 5 1:500 25m

SK-06 TO SK-09 - 100%DD STAGING
CAD FILENAME: _____
PLOT DATE: 2024-05-03

REV	DATE	REVISIONS	NAME
-	2024-05-03	ISSUED FOR REFERENCE	M. TROST

SUGGESTED CONSTRUCTION STAGING

HIGHWAY 3

SNASS CREEK BRIDGE No. 1214

DESIGNED: <u>G. CHOW</u> DATE: <u>2024-05-03</u>	QUALITY CONTROL: <u>M. TROST</u> DATE: <u>2024-05-03</u>	QUALITY ASSURANCE: <u>R. WONG</u> DATE: <u>2024-05-03</u>
ENGINEER OF RECORD: _____	DATE: _____	PERMIT TO PRACTICE NUMBER: _____
FILE NUMBER: 689993	PROJECT NUMBER: 12712-0001	REG: 1
DRAWING NUMBER: SK-08	REV: -	

PLOT DATE: 2024/05/03 H:\DATA\689993 - Hwy 3 Snass Creek Bridge\DrawingProduction\100_Plans\Staging\SK-06 TO SK-09 - 100%DD STAGING.dwg

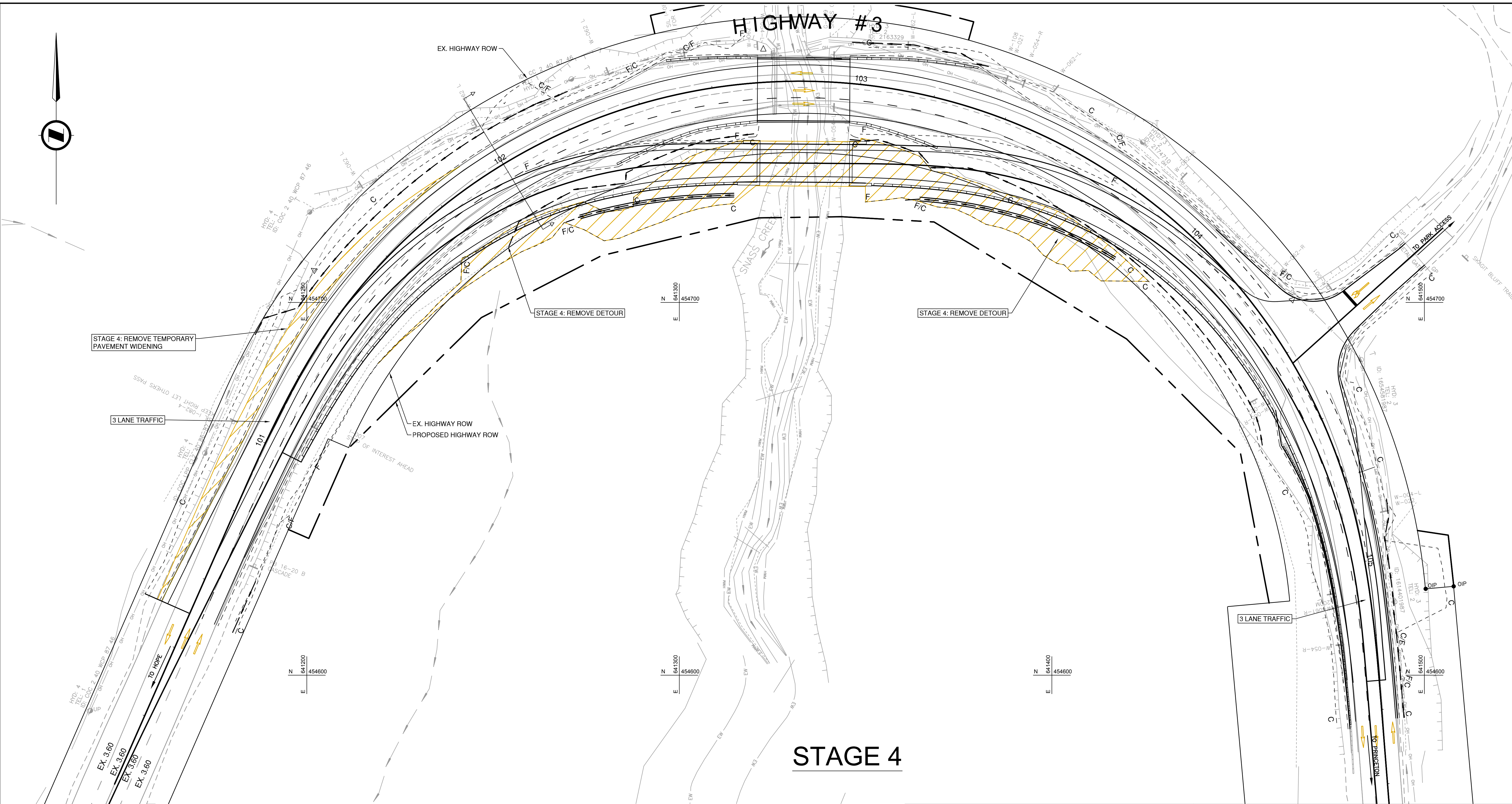
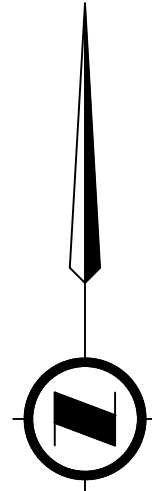

STAGE 4

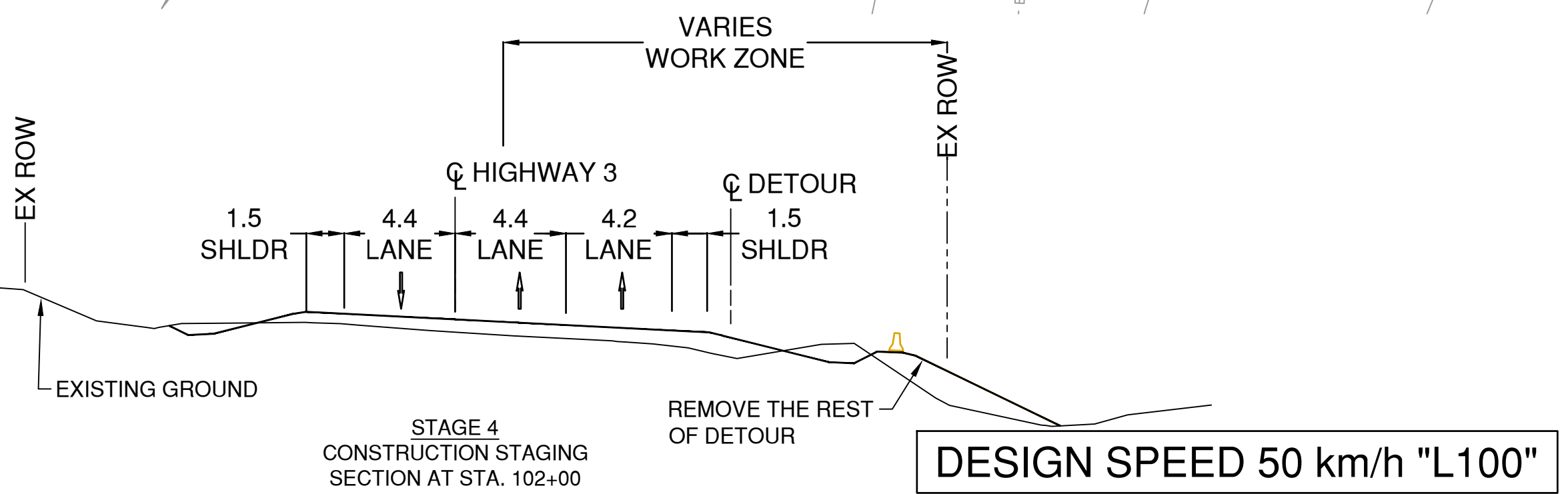

		SNC-Lavalin Inc. Suite 1100 - 745 Thurlow St. Vancouver British Columbia V6E 0C5 Canada				MINISTRY OF TRANSPORTATION AND INFRASTRUCTURE SOUTH COAST REGION HIGHWAY ENGINEERING AND GEOMATICS	
SCALE 0 5 1:500 25m		SK-06 TO SK-09 - 100%DD STAGING CAD FILENAME _____ PLOT DATE: 2024-05-03		SUGGESTED CONSTRUCTION STAGING HIGHWAY 3 SNASS CREEK BRIDGE No. 1214 100% DETAILED DESIGN			
REV	DATE	REVISIONS	NAME				
-	2024-05-03	ISSUED FOR REFERENCE	M. TROST				
				DESIGNED <u>G. CHOW</u> DATE <u>2024-05-03</u> QUALITY CONTROL <u>M. TROST</u> DATE <u>2024-05-03</u> QUALITY ASSURANCE <u>R. WONG</u> DATE <u>2024-05-03</u> ENGINEER OF RECORD _____ DATE _____ PERMIT TO PRACTICE NUMBER _____ DRAWN <u>D. MANDIC</u> DATE <u>2024-05-03</u>			
FILE NUMBER		PROJECT NUMBER		REG	DRAWING NUMBER		REV
689993		12712-0001		1	SK-09		-