

PLAN
HORZ 1:500

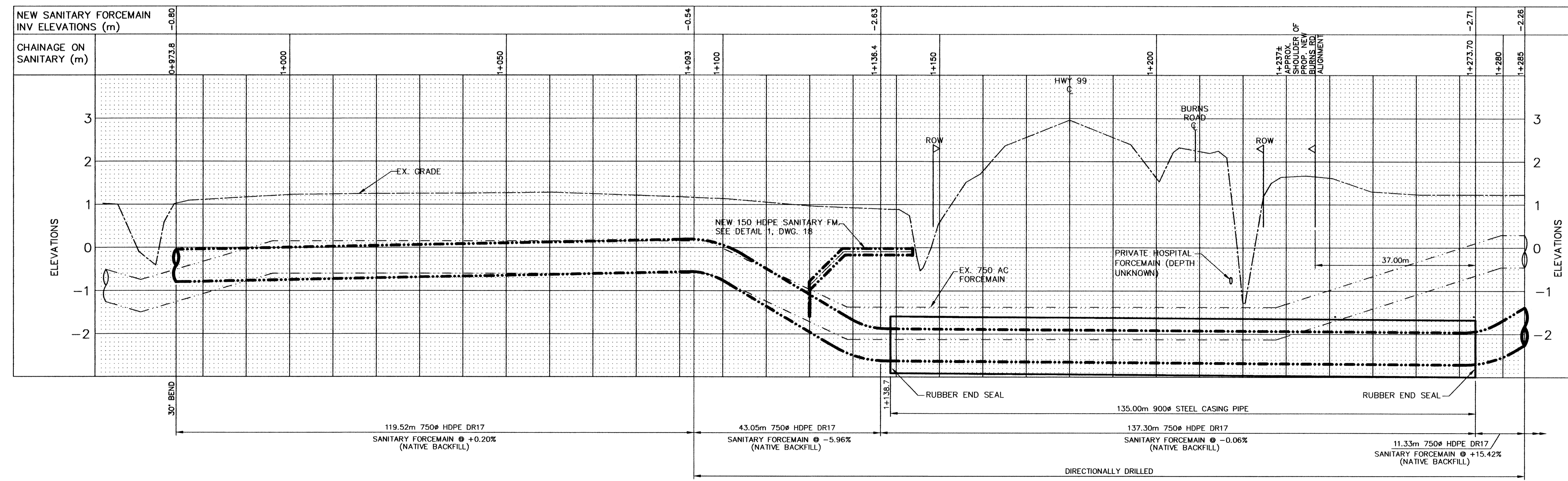

PROFILE
HORZ 1:500 : VERT 1:50

No	DATE	BY	CK	REVISIONS DESCRIPTION
5	09-10-15	CD	KW	ISSUED FOR RECORD SERVICES
4	09-10-06	CD	KW	ISSUED FOR RECORD SERVICES REVIEW
3	08-07-17	CD	KW	ISSUED FOR CONSTRUCTION
2	08-07-07	CD	KW	ISSUED FOR HIGHWAY PERMIT
1	08-05-27	CD	KW	ISSUED FOR TENDER

The Corporation of Delta
 4500 CLARENCE TAYLOR CRESCENT, DELTA, B.C., CANADA V4K-3E2
 ENGINEERING DEPARTMENT
 TEL : (604)946-3260 FAX : (604)946-7492

OMNI ENGINEERING INC.
 # 101 - 1861 Welch St.
 North Vancouver, B.C.
 V7P 1B7 604-985-0508

DESIGN BY: KW DATE: 08-02-28
 DRAWN BY: CD DATE: 08-02-28
 CHECKED BY: DC DATE: 08-02-28
 APPRVD BY: PM DATE: 08-02-28
 SCALE: HORZ: 1:500 VERT: 1:50

CONTRACT No.
ENG 08-310

PROJECT: 2008 LADNER TRUNK SANITARY SEWER FORCEMAIN TWINNING - PLAN & PROFILE
 LOCATION: LADNER TRUNK PUMP STATION TO R/W 58986 STA. 0+973.8 TO STA. 1+285

1882-SHT. 5
 D-08310
 S-18
 5

S-1445

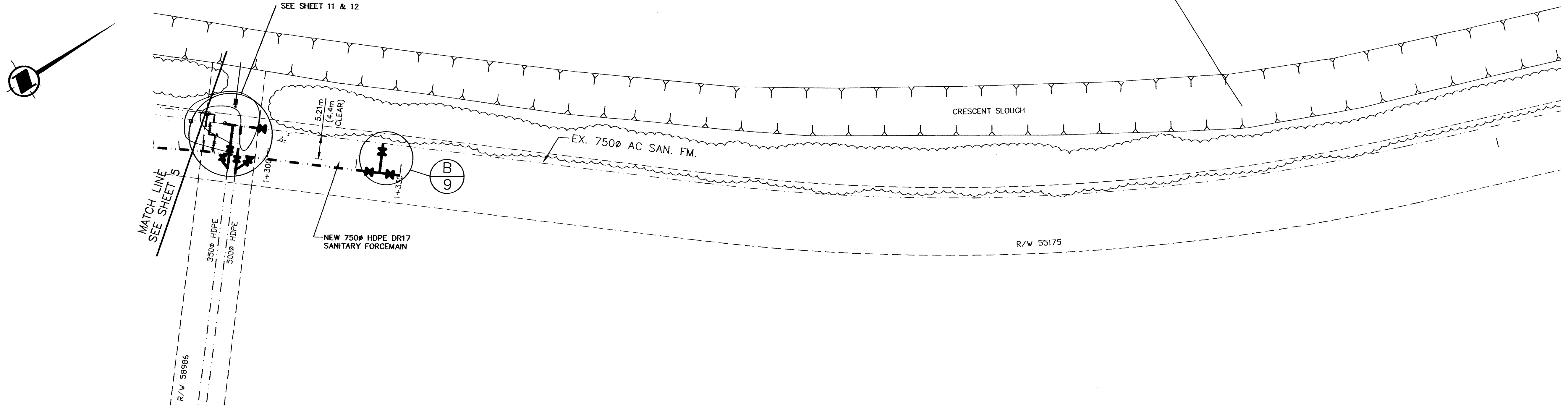

PLAN
HORZ 1:500

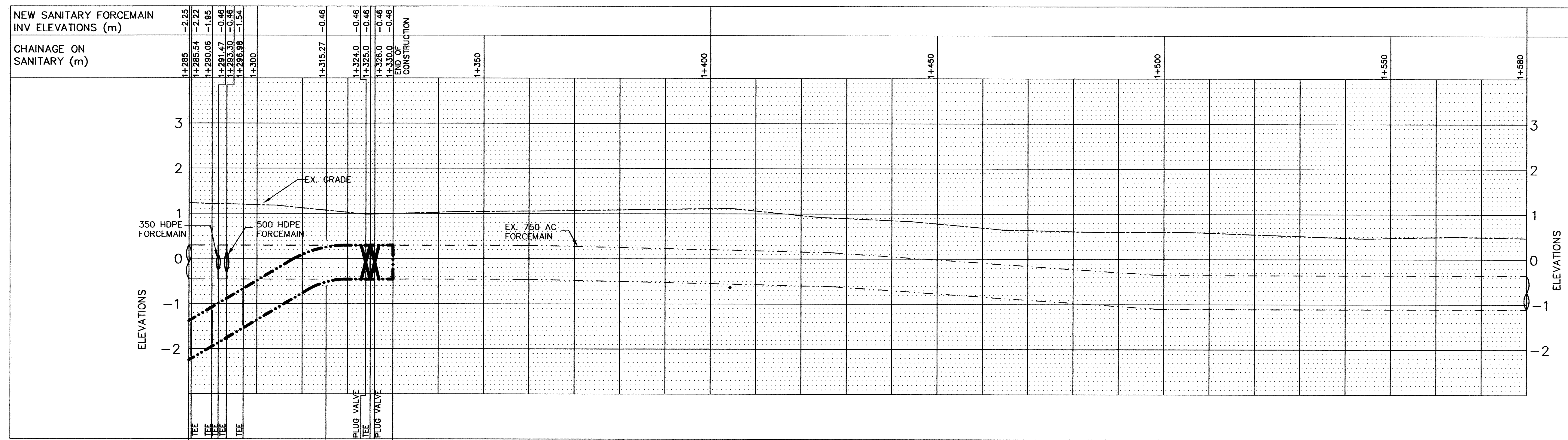

PROFILE
HORZ 1:500 : VERT 1:50

No	DATE	BY	CK	REVISIONS DESCRIPTION
5	09-10-15	CD	KW	ISSUED FOR RECORD SERVICES
4	09-10-06	CD	KW	ISSUED FOR RECORD SERVICES REVIEW
3	08-07-17	CD	KW	ISSUED FOR CONSTRUCTION
2	08-07-07	CD	KW	ISSUED FOR HIGHWAY PERMIT
1	08-05-27	CD	KW	ISSUED FOR TENDER

The Corporation of Delta
 4500 CLARENCE TAYLOR CRESCENT, DELTA, B.C., CANADA V4K-3E2
 ENGINEERING DEPARTMENT
 TEL : (604)946-3260 FAX : (604)946-7492

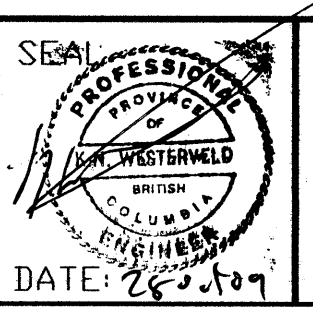

OMNI ENGINEERING INC.
 # 101 - 1081 Welch St.
 North Vancouver, B.C.
 V7P 1R7 604-985-0508

DESIGN BY: KW DATE: 08-02-28
 DRAWN BY: CD DATE: 08-02-28
 CHECKED BY: BC DATE: 08-02-28
 APPRVD BY: PM DATE: 08-02-28
 SCALE: HORZ: 1:500, VERT: 1:50

CONTRACT No. ENG 08-310

PROJECT: 2008 LADNER TRUNK SANITARY SEWER FORCEMAIN TWINNING - PLAN & PROFILE
 LOCATION: LADNER TRUNK PUMP STATION TO R/W 56536 STA. 1+285 TO STA. 1+330

1882-SHT. 6
 D-08310
 6 OF 18
 5

5445